

Site/Project Name: **Abingdon St Helen's Church**

Site Code: ABHLN 12

Site/Project Type: Watching brief

Year(s): 2012

Accession Number: OXCMS:2012.12

Record Group	Contents	Comments	Box/File Number
	INTRODUCTION Brief	2 sheets	Box 1 file 1
A	REPORT see http://library.thehumanjourney.net/1009		
B	SITE DIARY Watching brief record sheets	4 sheets	Box 1 file 2
B	PRIMARY CONTEXT DATA Levels register Context checklist nos. 1-12 Context sheets	1 sheet 1 sheet as numbered	Box 1 file 2
B	CATALOGUE OF DRAWINGS Plan list Section list	1 sheet 1 sheet	Box 1 file 3
B	PRIMARY DRAWINGS Plans Sections	2 sheets 2 sheets	Box 1 file 3
D	CATALOGUE OF PHOTOGRAPHS Index to images JPG printouts	1 sheet 2 sheets	Box 1 file 4

PDF/A SCAN

FILMING INSTRUCTIONS

Submitter OASouth
 No. of copies: 2

Headings

Site information

Line 1: [OASouth] County[Oxon] Parish:[Abingdon]

Site[St Helen's Church] Site code[ABHLN 12]

Line 2: Excavators name[D Score]

Line 3:

Classification of material

Tick if present

Classification of material	Tick if present
Index to archive	<input checked="" type="checkbox"/>
Introduction	<input type="checkbox"/>
A:Final Report	<input type="checkbox"/>
A:Publication Report	<input type="checkbox"/>
B:Site Data – Text: Diary/Daybook/Fieldnotes	<input type="checkbox"/>
B: Site Data – Text: General Summaries	<input type="checkbox"/>
B: Site Data – Text: Primary Context Records	<input type="checkbox"/>
B: Site Data – Text: Synthesised Context Records	<input type="checkbox"/>
B: Site Data – Text: Survey Reports	<input type="checkbox"/>
B: Site Data – Text: Catalogue of Drawings	<input type="checkbox"/>
B: Site Data – Text: Primary Drawings	<input type="checkbox"/>
B: Site Data – Text: Synthesised Drawings	<input type="checkbox"/>
C: Finds Data – Text: Primary Finds Data	<input type="checkbox"/>
C: Finds Data – Text: Synthesised Finds Data	<input type="checkbox"/>
C: Finds Data – Text: Specialist Reports	<input type="checkbox"/>
C: Finds Data – Text: Box/Bag List	<input type="checkbox"/>
D: Catalogue of Photos/Slides/Videos/X--rays	<input type="checkbox"/>
E: Environmental/Ecofact Data: Primary Records	<input type="checkbox"/>
E: Environmental/Ecofact Data: Synthesised Records	<input type="checkbox"/>
E: Environmental/Ecofact Data: Specialist Reports	<input type="checkbox"/>
F: Documentary	<input type="checkbox"/>
F: Press and Publicity	<input type="checkbox"/>
G: Correspondence	<input type="checkbox"/>
H: Miscellaneous	<input type="checkbox"/>

OASIS DATA COLLECTION FORM: England

[List of Projects](#) | [Manage Projects](#) | [Search Projects](#) | [New project](#) | [Change your details](#) | [HER coverage](#) | [Change country](#) | [Log out](#)

Printable version

OASIS ID: oxfordar1-144239

Project details

Project name	St Helen's Church Abingdon Oxfordshire
Short description of the project	From 30th January to 2nd February 2012 Oxford Archaeology conducted a watching brief during the construction of a new foul drain connection at St Helen's Church, Abingdon, Oxfordshire. The watching brief recorded the remains of three parallel north-south aligned stone walls within the garden of the present Church Centre, two of which were dated to the post-medieval period. Within the present graveyard a backfilled vaulted brick tomb was recorded. No extant inhumations were disturbed along the route of the new service trench although the presence of human remains in the form of chamel was noted at several locations.
Project dates	Start: 30-01-2012 End: 02-02-2012
Previous/future work	Yes / Not known
Any associated project reference codes	AB HLN 12 - Sitecode
Any associated project reference codes	OXCMS:2012.12 - Museum accession ID
Type of project	Recording project
Site status	None
Current Land use	Other 2 - In use as a building
Monument type	CHURCH Post Medieval
Significant Finds	CBM Post Medieval
Investigation type	"Watching Brief"
Prompt	Specification from Deanery of Abingdon

Project location

Country	England
Site location	OXFORDSHIRE VALE OF WHITE HORSE ABINGDON St Helen's Church
Study area	19.00 Square metres
Site coordinates	SU 4985 9608 51 -1 51 39 38 N 001 16 45 W Point

Project creators

Name of Organisation	Oxford Archaeology
Project brief originator	Archdeaconry of Berkshire:Deanary of Abingdon
Project design originator	Oxford Archaeology
Project director/manager	D. Score
Project supervisor	D Sykes
Type of sponsor/funding body	Deanary
Name of sponsor/funding body	St Helen's Church

Project archives

Physical Archive Exists?	No
Digital Archive recipient	Oxford Archaeology
Digital Archive ID	ABHLN 12
Digital Contents	"other"
Digital Media available	"Images raster / digital photography", "Text"
Paper Archive recipient	Oxford Archaeology
Paper Archive ID	OXCMS:2012.12
Paper Contents	"Stratigraphic", "other"
Paper Media available	"Context sheet", "Diary", "Photograph", "Plan", "Section"

Project bibliography 1

Publication type	Grey literature (unpublished document/manuscript)
Title	St Helen's Church Abingdon Oxfordshire
Author(s)/Editor(s)	Sykes D
Date	2012
Issuer or publisher	Oxford Archaeology South
Place of issue or publication	Oxford
Description	Client report
URL	http://library.thehumanjourney.net/1009
Entered by	Nicola Scott (n.scott@oxfordarch.co.uk)

Entered on 20 February 2013

OASIS:

Please e-mail English Heritage for OASIS help and advice

© ADS 1996-2012 Created by Jo Gilham and Jen Mitcham, email Last modified Wednesday 9 May 2012

Cite only: <http://www.oasis.ac.uk/form/print.cfm> for this page

OXCMS: 2012.12

ABINGDON
ST HELENS CHURCH
ABTLN 12

INTRODUCTION

PDF/A SCAN

FILMING INSTRUCTIONS

Submitter OASouth

No. of copies: 2

Headings

Site information

Line 1: [OASouth] County[Oxon] Parish:[Abingdon]

Site[St Helen's Church] Site code[ABHLN 12]

Line 2: Excavators name[D Score]

Line 3:

Classification of material

Tick if present

Classification of material	Tick if present
Index to archive	
Introduction	✓
A:Final Report	
A:Publication Report	
B:Site Data – Text: Diary/Daybook/Fieldnotes	
B: Site Data – Text: General Summaries	
B: Site Data – Text: Primary Context Records	
B: Site Data – Text: Synthesised Context Records	
B: Site Data – Text: Survey Reports	
B: Site Data – Text: Catalogue of Drawings	
B: Site Data – Text: Primary Drawings	
B: Site Data – Text: Synthesised Drawings	
C: Finds Data – Text: Primary Finds Data	
C: Finds Data – Text: Synthesised Finds Data	
C: Finds Data – Text: Specialist Reports	
C: Finds Data – Text: Box/Bag List	
D: Catalogue of Photos/Slides/Videos/X--rays	
E: Environmental/Ecofact Data: Primary Records	
E: Environmental/Ecofact Data: Synthesised Records	
E: Environmental/Ecofact Data: Specialist Reports	
F: Documentary	
F: Press and Publicity	
G: Correspondence	
H: Miscellaneous	

Church of St Helen, Abingdon

[Archdeaconry of Berkshire: Deanery of Abingdon]

Archaeological Recording Specification

1. Summary of Specification

- 1.1 This specification provides the outline for an archaeological contractor to provide a cost for the archaeological recording arising from improvement to services for new foul drains following installation of a WC and associated works at the Church of St Helen.
- 1.2 The aim of the programme of archaeological recording is to mitigate the impact of the proposed works on the fabric and buried archaeology of the church and its immediate vicinity.
- 1.2 The objectives of the archaeological recording will be as follows:
 - to observe and record any exposed remains of the earlier church
 - to determine the extent to which human remains survive in the affected area
 - to generally to observe the presence of burial vaults and graves
 - to signal, before work proceeds, the discovery of an archaeological find for which further action is required
 - to provide a report and ordered archive on the investigation.

2. Background

- 2.1 St Helen's is a medieval church, of pre-Conquest origin, and possibly pre-dating Abingdon Abbey. It lies within an area settled during the prehistoric and Roman periods, and is close to the river on what may be a primary route through Abingdon. The earliest observable church occupied the site of its present two north aisles. It was rebuilt in the 13th century, and the tower and some features in the east wall date to this period. Further rebuilding took place during the 14th and 15th centuries and the northern four aisles date mainly to this period. During the 16th century the outer south aisle, vestry and south porch were added.
- 2.2 The topography of the area suggests that some terracing might have been necessary when the church was extended (OAU 1999, 9). Below-ground disturbance took place when heating ducts, organ power and drainage were installed during the 19th century. The font was also repositioned. Recent observations have found cavities below the pew platforms and an absence of walling adjacent to piers, where it might have been expected. However there is significant potential for earlier features to remain *in situ*, both within the church and in its vicinity.
- 2.4 The church is a Grade I Listed Building.

3. Work Proposals and Potential Impact

- 3.1 The proposed works include excavations within the churchyard to connect the foul drainage from new toilets within the church to an existing manhole close to the Church Centre. Three new

manholes would be dug at intervals along the route, which passes under the existing footpath and then through the churchyard. The pipe run will be fairly shallow, between 0.3 – 1.4 m in depth.

3.2 The works would have potential impacts as follows:

- The disturbance of graves within the churchyard
- The disturbance of surviving foundations and other structures from the medieval church.

4. **Archaeological Evaluation, Watching Brief and Recording**

4.1 The archaeological recording will consist of the following main elements:

- Watching brief on the opening of the trench just outside the north porch excavation of the trench below it.
- Watching brief on excavations within the churchyard.
- Possible recording of evidence for earlier phases in the construction of the church;
- Possible recording of articulated remains within the churchyard.

4.2 The programme of archaeological work is intended to mitigate the impact of the proposed works on the fabric and buried archaeology of the church, and will only by agreement with the architect and the Diocesan Archaeological Adviser be extended beyond what is necessary to fulfil that aim.

4.4 A watching brief will be maintained on the excavation close to the north porch and within the churchyard, particularly in the location of the manholes. If any discoveries, such as articulated skeletons, are made while the trenches in the churchyard are under excavation, the contractor is to stop work. Further excavation will then be carried out by an archaeologist.

4.5 An illustrated report on the programme of work will be produced.

5. **Archaeological Recording**

5.1 *Recording*

Archaeological features will be recorded in plan (1:20) and where appropriate in section (1:10), and plotted onto the digital base plan (1:50) supplied by the architects. Where appropriate B/W photographs and colour transparencies should be taken of major contexts such as walls, floors, burials or *in-situ* artefacts.

5.2 *Finds*

Generally the preference will be to leave finds of minor significance *in-situ*, or have them re-buried in a position as near as possible to their place of origin. Other significant finds can, under authority of a faculty, be deposited with the appropriate museum.

5.3 *Human remains*

5.3.1 Where early modern or medieval human remains are disturbed in the course of the work they should be treated with due care and regard to the sensitivities involved. The location of any chancel should be recorded and reserved for re-burial, if immediate re-interment is not possible. Burials of archaeological significance should also be left *in-situ* until examined by an appropriately qualified osteoarchaeologist, and only removed by the archaeologist if impacts are substantial. The architect and parish are to be kept fully informed. No human remains may be removed without the express permission of the Consistory Court.

5.3.2 Unless it is necessary to remove for assessment by a physical anthropologist, any human bones which are disturbed during the course of the excavation work for drainage trenches, etc. are to be carefully set aside out of sight of the public. Materials from each burial 'site' should be stored in separate containers and these containers should be stored, under lock and key within the church until completion of the excavation works when they should be handed to the Incumbent to direct the re-burial. Excavation for re-interment of bones is to be carried out by the archaeological contractor in a location agreed with the architect and Incumbent.

5.4 *Assessment of further Study*

Where significant artefacts, environmental material or human burials are excavated they should be assessed for further analysis and an interim report submitted to the client and architect.

6. **Reporting**

6.1 *Site Archive*

6.1.1 The site archive should consist of the following material: correspondence relating to fieldwork, context sheets, site drawings, finds and sampling records, photographic records, assessment reports, historical data. Records should be microfiched and deposited, together with digital data with the appropriate museum. Advice on preparation of the archives is available in *Archaeological Archives* (AAF 2007) in addition to any guidance from the museum itself.

6.2 *Report*

6.2.1 The report should include relevant historical information, appropriate plans and sections, context descriptions, a description of finds, an objective account of archaeological deposits, appropriate building interpretation and photography.

6.2.2 A draft report should be completed within one month of the finish of fieldwork and submitted to the Architect, and the Diocesan Adviser.

6.2.3 A final report should be completed within three months of the finish of fieldwork and four copies submitted to the Architect who will ensure that one is deposited with the Oxfordshire HER.

6.2.4 Contractors should complete and submit an OASIS summary form to the Archaeology Data Service when the report has been accepted by the Diocesan Adviser.

6.3 *Publication*

6.3.1.1 Any significant results should be published, and the archaeologist should at least submit a brief summary of work to the *South Midlands Archaeology* and to the Oxfordshire HER.

6.2.4 Contractors should complete and submit an OASIS summary form to the Archaeology Data Service when the report has been accepted by the Diocesan Adviser.

7. Monitoring and consultation

7.1 Further details or variations in the specification, arising either before or during the works are to be agreed with the Diocesan Archaeological Adviser, who will monitor the work.

8. Standards and Professional Guidelines

8.1 In general, the standards and guidelines applied to sites within Oxfordshire and those issued by the Institute for Archaeologists shall apply.

J.T. Munby
Oxford Diocesan Adviser

January 2012

OXCMS: 2012-12

ABINGDON
ST HELENS CHURCH

ABTLN 12

B. SITE DIARY

B. PRIMARY CONTEXT DATA

PDF/A SCAN

FILMING INSTRUCTIONS

Submitter OASouth

No. of copies: 2

Headings

Site information

Line 1: [OASouth] County[Oxon] Parish:[Abingdon]

Site[St Helen's Church] Site code[ABHLN 12]

Line 2: Excavators name[D Score]

Line 3:

Classification of material

Tick if present

Index to archive	
Introduction	
A:Final Report	
A:Publication Report	
B:Site Data – Text: Diary/Daybook/Fieldnotes	✓
B: Site Data – Text: General Summaries	
B: Site Data – Text: Primary Context Records	
B: Site Data – Text: Synthesised Context Records	
B: Site Data – Text: Survey Reports	
B: Site Data – Text: Catalogue of Drawings	
B: Site Data – Text: Primary Drawings	
B: Site Data – Text: Synthesised Drawings	
C: Finds Data – Text: Primary Finds Data	
C: Finds Data – Text: Synthesised Finds Data	
C: Finds Data – Text: Specialist Reports	
C: Finds Data – Text: Box/Bag List	
D: Catalogue of Photos/Slides/Videos/X--rays	
E: Environmental/Ecofact Data: Primary Records	
E: Environmental/Ecofact Data: Synthesised Records	
E: Environmental/Ecofact Data: Specialist Reports	
F: Documentary	
F: Press and Publicity	
G: Correspondence	
H: Miscellaneous	



WATCHING BRIEF RECORD

SITE CODE **AB4LN12**

SITE NAME **ST HELENS, ABRINGTON**

DATE **30.1.12**

NGR

County

Start Time

10.00

Finish Time

2.45.

Milage

Previous Visit

Visit By

[Signature]

Type of construction work **SERVICE TRENCH**

Contacts made

Archaeology present?

Yes: - **EW AUGURED WITH - CULVERT? - [Sketch]**

No:

Undated:

Other:

COMMENTS

**TRENCH dug from POLEH → APPROX 4m INTO CHURCHYARD
(OVER ASP)**

Records? **Y.**



WATCHING BRIEF RECORD

SITE CODE **ASHW12**

SITE NAME **ST HELENS, ABINGDON**

DATE **31.1.12.**

NGR

County

Start Time

9.00.

Finish Time

4.00.

Milage

Previous Visit

30.1.12.

Visit By

cm.

Type of construction work

SERVICE TRENCH.

Contacts made

Archaeology present?

Yes: **- BURIAL VAULT (2)**

No:

Undated:

Other:

COMMENTS

Records? **YES.**



WATCHING BRIEF RECORD

SITE CODE **ABHLN 12**

SITE NAME **ST HELENS, ABINGDON**

DATE **1.2.12**

NGR

County

Start Time

8

Finish Time

4.30.?

Milage

Previous Visit

31.1.12.

Visit By

JM.

Type of construction work

SERVICE TRENCH.

Contacts made

Archaeology present?

Yes:

3x N-S WAYS TO WEST OF GRAVEYARD.

No:

Undated:

Other:

COMMENTS

Records? **YES.**



WATCHING BRIEF RECORD

SITE CODE *ABHUN12*

SITE NAME *ST MELLEN'S ABBEY*

DATE *2.2.12*

NGR

County

Start Time

8

Finish Time

3

Milage

Previous Visit

Visit By

[Signature]

Type of construction work *SEWER TRENCH*

Contacts made

Archaeology present?

Yes: *RECORDING TR TO WEST OF GRAVEYARD*

No:

Undated:

Other:

COMMENTS

Records? *YES*

PDF/A SCAN

FILMING INSTRUCTIONS

Submitter OASouth

No. of copies: 2

Headings

Site information

Line 1: [OASouth] County[Oxon] Parish:[Abingdon]

Site[St Helen's Church] Site code[ABHLN 12]

Line 2: Excavators name[D Score]

Line 3:

Classification of material

Tick if present

Index to archive	
Introduction	
A:Final Report	
A:Publication Report	
B:Site Data – Text: Diary/Daybook/Fieldnotes	
B: Site Data – Text: General Summaries	
B: Site Data – Text: Primary Context Records	✓
B: Site Data – Text: Synthesised Context Records	
B: Site Data – Text: Survey Reports	
B: Site Data – Text: Catalogue of Drawings	
B: Site Data – Text: Primary Drawings	
B: Site Data – Text: Synthesised Drawings	
C: Finds Data – Text: Primary Finds Data	
C: Finds Data – Text: Synthesised Finds Data	
C: Finds Data – Text: Specialist Reports	
C: Finds Data – Text: Box/Bag List	
D: Catalogue of Photos/Slides/Videos/X--rays	
E: Environmental/Ecofact Data: Primary Records	
E: Environmental/Ecofact Data: Synthesised Records	
E: Environmental/Ecofact Data: Specialist Reports	
F: Documentary	
F: Press and Publicity	
G: Correspondence	
H: Miscellaneous	



LEVELS REGISTER

SITE CODE **ABMLWIZ**

SITE NAME **ST HELENS, ABINGDON**

SHEET NO **1**

TBM	Backsite	Instrument Height (IH) (TBM+Backsight)	Level number	Foresight	Reduced Level (IH-Foresight)	Comments/Context No(s)/ Small Find No(s)/Plan or Section No(s)
53-21	1.44	54.65	1	2.06	52.59	STEP (T SEC 2)
			T	2.04	52.61	SEC. 1
			1	-	52.59	PLAN 1
			2	-	52.35	
			3	-	51.41	
			4	-	52.59	
	from sec	52.61	5	0.44	52.17	
			6	0.22	52.39	
			7	0.76	52.85	
			8	0.48	52.13	
			9	0.16	52.45	
			10	0.66	52.95	
			11	1.34	52.27	
			12	0.66	52.95	
			13	1.00	52.61	
			14	1.24	52.37	
			15	0.34	52.27	

LEVELS



CONTEXT RECORD

Context No. 1SITE ABMLN 12

ADDITIONAL SHEETS:

TYPE WALL/SEWER?

Trench

Context Type: Deposit / Cut / Structure

Check Lists:

Site sub-div

Overlain by:

DEPOSIT:

Structure No.

Abutted by:

1. compaction
2. colour
3. composition
4. inclusion
5. thickness
6. extent
7. comments
8. method & conditions

Plan No. 1

Cut by:

Filled by:

Section No.

Same as:

Part of:

CUT:

1. shape in plan
2. base/sides/top profile
3. dimension and depth
4. sketch
5. truncation
6. fill nos
7. other comments

Co-Ordinates

Consists of:

Overlies:

Level

Butts:

MASONRY:

Slide No.

Cuts:

1. materials
2. size of bricks etc
3. finish of stones
4. coursing/bond
5. form
6. faces
7. bond
8. dimensions as found
9. other comments

Neg No.

Fill of:

Matrix location

Relationships uncertain

Description (See check lists):

Red on Brick - unflagged750 x 100 x 60 mmor 4 x 2 3/8"CREAM/YELLOW LIME MORTAR5 COURSES + DEEP5 x BRICKS ON EDGE TO NORTH

STRATIGRAPHIC MATRIX

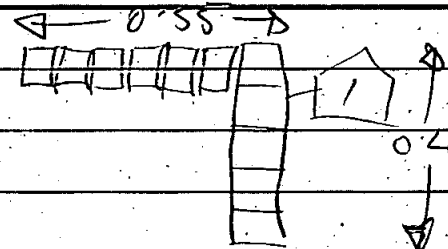

Interpretation/Discussion:

WALL/SEWER IN SERVICE TRENCH, 0.32m BGLSINGLE SKINNED - POSS PADM/CAP- POSS CURRENT RUN?

Finds (tick): None Pot Bone Flint Stone Burnt stone Glass
 Metal CBM Wood Leather

 Small FindsRecorder Rm SamplesDate 30.1.12 Building Materials

Initials



CONTEXT RECORD

Context No.

2

SITE ABHLN 12

ADDITIONAL SHEETS:

TYPE

BRICK
VAULT

Trench

Context Type: Deposit / Cut / Structure

Check Lists:

Site sub-div

Overlain by:

DEPOSIT:

1. compaction
2. colour
3. composition
4. inclusion
5. thickness
6. extent
7. comments
8. method & conditions

Structure No.

Abuted by:

Plan No.

Cut by:

Filled by:

Section No.

Same as:

Part of:

CUT:

1. shape in plan
2. base/sides/top profile
3. dimension and depth
4. sketch
5. truncation
6. fill nos
7. other comments

Co-Ordinates

Consists of:

Overlies:

Level

Butts:

MASONRY:

1. materials
2. size of bricks etc
3. finish of stones
4. coursing/bond
5. form
6. faces
7. bond
8. dimensions as found
9. other comments

Slide No.

Cuts:

Neg No.

Fill of:

Matrix location

Relationships uncertain

Description (See check lists):

OR/RED BRICKS
235 x 110 x 70
9 1/4 x 4 1/4 x 2 3/4"

LIGHT LIME MORTAR

 NAZE BRICK VAULT ROOF - 10 BRICKS WIDE

STRATIGRAPHIC MATRIX

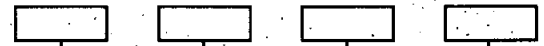

this context is

2

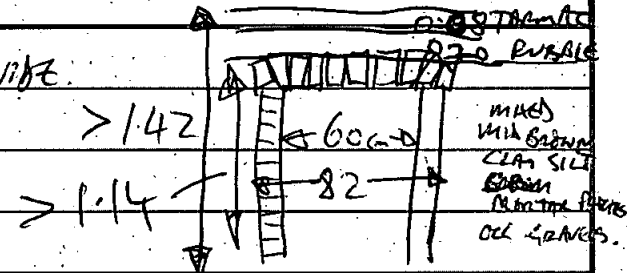

Interpretation/Discussion:

BRICK VAULTED ROOF IN N. GRAVEYARD

Finds (tick): None [] Pot [] Bone [] Flint [] Stone [] Burnt stone [] Glass []
Metal [] CBM [] Wood [] Leather []

 Small Finds

Recorder

 Samples

Date 31.1.12

 Building Materials

Initials



CONTEXT RECORD

Context No.

3

SITE ABHLN 12

ADDITIONAL SHEETS:

TYPE

WALL

Trench

Context Type: Deposit / Cut Structure

Check Lists:

Site sub-div

Overlain by:

DEPOSIT:

1. compaction
2. colour
3. composition
4. inclusion
5. thickness
6. extent
7. comments
8. method & conditions

Structure No.

Abuted by: a/10

Plan No.

1 2

Cut by:

Filled by:

Section No.

1

Same as:

Part of:

CUT:

1. shape in plan
2. base/sides/top profile
3. dimension and depth
4. sketch
5. truncation
6. fill nos
7. other comments

Co-Ordinates

Consists of:

Overlies:

Level

Butts:

MASONRY:

1. materials
2. size of bricks etc
3. finish of stones
4. coursing/bond
5. form
6. faces
7. bond
8. dimensions as found
9. other comments

Slide No.

Cuts:

Neg No.

Fill of:

Matrix location

Relationships uncertain

Description (See check lists):

LIMESTONE BRICKS - IRREGULAR
CREAMY LIME MORTAR
> 0.6 m LONG
0.54 m WIDE
> 0.72 m DEEP

STRATIGRAPHIC MATRIX

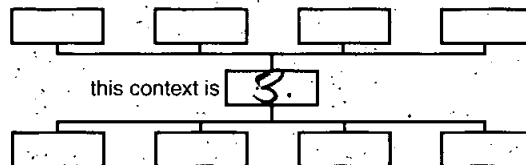

Interpretation/Discussion:

N'S AUGMENT LIMESTONE WALL - SURMOUNTED BY BRICK
WALL [6] - PART OF EXISTING WALL ON WESTERN SIDE OF GRAVEYARD

Finds (tick): None Pot Bone Flint Stone Burnt stone Glass
 Metal CBM Wood Leather

 Small Finds
Recorder DM
 Samples
Date 2.2.12
 Building Materials

Initials



CONTEXT RECORD

Context No.

4

SITE ABHLN18

ADDITIONAL SHEETS:

TYPE Wtu

Trench

Context Type: Deposit / Cut / Structure

Check Lists:

Site sub-div

Overlain by: [8]

DEPOSIT:

1. compaction
2. colour
3. composition
4. inclusion
5. thickness
6. extent
7. comments
8. method & conditions

Structure No.

Abuted by:

Plan No.

2

Cut by:

Filled by:

Section No.

1

Same as:

Part of:

CUT:

1. shape in plan
2. base/sides/top profile
3. dimension and depth
4. sketch
5. truncation
6. fill nos
7. other comments

Co-Ordinates

Consists of:

Overlies:

Level

Butts:

MASONRY:

1. materials
2. size of bricks etc
3. finish of stones
4. coursing/bond
5. form
6. faces
7. bond
8. dimensions as found
9. other comments

Slide No.

Cuts:

Neg No.

Fill of:

Matrix location

Relationships uncertain

Description (See check lists)

Wtu Limestone wall - irregularcontaining lime mortar.> 0.6 m long0.42 m wide.> 0.64 m deep - offset 20m at base of west side

STRATIGRAPHIC MATRIX

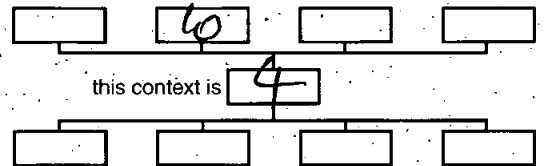

Interpretation/Discussion:

N-S aligned wall - parallel to [3] + [5]containing brick + tile within fabric of probable (16-17th c) date (Pers. Comm. JOHN COOPER).brick = 54 mm THICK = 2 1/8"

Finds (tick): None Pot Bone Flint Stone Burnt stone Glass
 Metal CBM Wood Leather

 Small FindsRecorder [Signature] SamplesDate 2.2.12 Building Materials

Initials



CONTEXT RECORD

Context No.

5

SITE ABALWIZ

ADDITIONAL SHEETS:

TYPE WALL

Trench:

Context Type: Deposit / Cut / Structure

Check Lists:

Site sub-div

Overlain by: 7 + 8

DEPOSIT:

1. compaction
2. colour
3. composition
4. inclusion
5. thickness
6. extent
7. comments
8. method & conditions

Structure No.

Abutted by: 10

Plan No.

2

Cut by:

Filled by:

Section No.

1

Same as:

Part of:

CUT:

1. shape in plan
2. base/sides/top profile
3. dimension and depth
4. sketch
5. truncation
6. fill nos
7. other comments

Co-Ordinates

Consists of:

Overlies:

Level

Butts:

MASONRY:

1. materials
2. size of bricks etc
3. finish of stones
4. coursing/bond
5. form
6. faces
7. bond
8. dimensions as found
9. other comments

Slide No.

Cuts:

Neg No.

Fill of:

Matrix location

Relationships uncertain

Description (See check lists):

LIMESTONEYELLOW/CREAM LIME MORTAR> 0.6m LONG0.42m WIDE> 0.7m DEEP.ROUGHLY SOUNDED.

STRATIGRAPHIC MATRIX

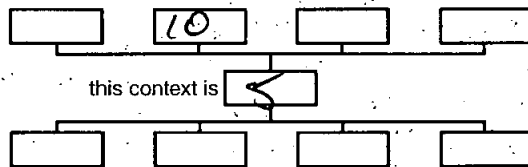

this context is

Interpretation/Discussion:

N-S AUGURED LIMESTONE WALL.

CONTAINED BRICK MAR 60mm THICK = 2 1/2" (ONE MORTAR)
= C16-17 (PERS. COMM. JOHN COOPER)

Finds (tick): None Pot Bone Flint Stone Burnt stone Glass
 Metal CBM Wood Leather

 Small FindsRecorder DZ SamplesDate 2.2.2012 Building Materials

Initials



CONTEXT RECORD

Context No.

6

SITE ABHLN12

ADDITIONAL SHEETS:

TYPE *WALL*

Trench

Context Type: Deposit / Cut / Structure

Check Lists:

Site sub-div

Overlain by: *SUB BASE*

DEPOSIT:

1. compaction
2. colour
3. composition
4. inclusion
5. thickness
6. extent
7. comments
8. method & conditions

Structure No.

Abutted by:

Plan No.

4 2

Cut by:

Filled by:

Section No:

1

Same as:

Part of:

CUT:

1. shape in plan
2. base/sides/top profile
3. dimension and depth
4. sketch
5. truncation
6. fill nos
7. other comments

Co-Ordinates

Consists of:

Overlies: *3*

Level

Butts:

MASONRY:

1. materials
2. size of bricks etc
3. finish of stones
4. coursing/bond
5. form
6. faces
7. bond
8. dimensions as found
9. other comments

Slide No.

Cuts:

Neg No.

Fill of:

Matrix location

Relationships uncertain

Description (See check lists)

*RED BRICKS**220 x 110 x 70**8 5/8 x 4 3/8 x 2 3/4"**CREAM LIME MORTAR**> 0.35 m long**> 0.36 m wide - AT LEAST 1 BRICK LENGTH BUT NOT LONG**0.22 m HIGH (UPPER WALL = SAME? IS 0.86m)*

STRATIGRAPHIC MATRIX

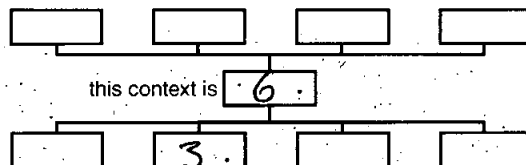

Interpretation/Discussion:

*N-S AUGURED BRICK WALL - PROB (part - FOOTINGS OF
 ADJACENT CONCRETE WALL (WEST) - OVERLYING *3* -
 SURVIVED INSTALLATION OF GATEWAY OVER.*

Finds (tick): None [] Pot [] Bone [] Flint [] Stone [] Burnt stone [] Glass []
 Metal [] CBM [] Wood [] Leather []

 Small FindsRecorder *Tm* SamplesDate *2.2.12* Building Materials

Initials



CONTEXT RECORD

Context No.

7

SITE ABKLN12

ADDITIONAL SHEETS:

TYPE SERVICE

Trench

Context Type: Deposit / Cut / Structure

Check Lists:

Site sub-div

Overlain by:

DEPOSIT:

1. compaction
2. colour
3. composition
4. inclusion
5. thickness
6. extent
7. comments
8. method & conditions

Structure No.

Abutted by:

Plan No.

2

Cut by:

Filled by:

Section No.

1

Same as:

Part of:

CUT:

1. shape in plan
2. base/sides/top profile
3. dimension and depth
4. sketch
5. truncation
6. fill nos
7. other comments

Co-Ordinates

Consists of:

Overlies:

Level

Butts:

MASONRY:

1. materials
2. size of bricks etc
3. finish of stones
4. coursing/bond
5. form
6. faces
7. bond
8. dimensions as found
9. other comments

Slide No.

Cuts:

Neg No.

Fill of:

Matrix location

Relationships uncertain.

Description (See check lists):

STRATIGRAPHIC MATRIX

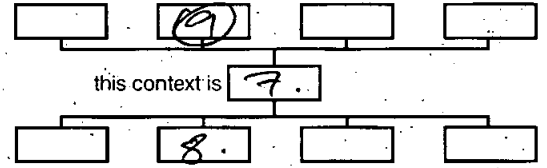

Interpretation/Discussion:

MODERN (1960's?) SERVICE - BRUSHED MANHOLE /
CONC / SERVICE PIPES.

- MAINLY REMOVED BY MACHINE

- PARTLY INSTALLED BENEATH EARLIER CULVERT / DRAIN [8]

Finds (tick): None [] Pot [] Bone [] Flint [] Stone [] Burnt stone [] Glass []
Metal [] CBM [] Wood [] Leather []

 Small FindsRecorder th SamplesDate 2.2.12 Building Materials

Initials



CONTEXT RECORD

Context No.

8

SITE ASHLN 12

ADDITIONAL SHEETS:

TYPE GRAIN

Trench

Context Type: Deposit / Cut / Structure

Check Lists:

Site sub-div

Overlain by:

DEPOSIT:

1. compaction
2. colour
3. composition
4. inclusion
5. thickness
6. extent
7. comments
8. method & conditions

Structure No.

Abutted by:

Plan No.

1

Cut by:

Filled by:

Section No.

1

Same as:

Part of:

CUT:

1. shape in plan
2. base/sides/top profile
3. dimension and depth
4. sketch
5. truncation
6. fill nos
7. other comments

Co-Ordinates

Consists of:

Overlies:

Level

Butts:

MASONRY:

1. materials
2. size of bricks etc
3. finish of stones
4. coursing/bond
5. form
6. faces
7. bond
8. dimensions as found
9. other comments

Slide No.

Cuts:

Neg No.

Fill of:

Matrix location

Relationships uncertain

Description (See check lists)

Red bricks (or/white) - CHAMBER AT EAST END
230 x 102 x 65
1 x 4 x 2 1/2"
CRUAMY LIME MORTAR
- SOME BRICKS PAINTED OR RE-USED.

STRATIGRAPHIC MATRIX

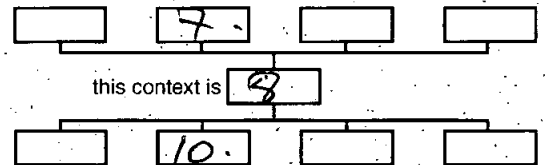

- MORTAR ON CHAMBER AT E. END - DARK CEMENTITIOUS & WATERPROOF
- SLAB/TILE CAPPING SUGGESTS FLOOR ON INSIDE OF GRAIN

- UNCLAR WHETHER IT SPANNS TO EAST OR WEST -
SUBSIDED OVER/AROUND NAUS [4] + [5] + SERVICE [7]

Interpretation/Discussion:

BRICK-BUILT GRAIN/CULVERT/SOAKAWAY STRUCTURE
- UNCLAR WHETHER IT SPANNS TO EAST OR WEST -
SUBSIDED OVER/AROUND NAUS [4] + [5] + SERVICE [7]

Finds (tick): None [] Pot [] Bone [] Flint [] Stone [] Burnt stone [] Glass []
 Metal [] CBM [] Wood [] Leather []

Small Finds

Recorder W

Samples

Date 2-2-12

Building Materials

Initials



CONTEXT RECORD

Context No.

a.

SITE **AB11W 12**

ADDITIONAL SHEETS:

TYPE **ANCE.**

Trench

Context Type: **Deposit** / Cut / Structure

Check Lists:

Site sub-div

Overlain by:

DEPOSIT:

1. compaction
2. colour
3. composition
4. inclusion
5. thickness
6. extent
7. comments
8. method & conditions

Structure No.

Abutted by:

Plan No.

MA

Cut by:

Filled by:

Section No.

1

Same as:

Part of:

CUT:

1. shape in plan
2. base/sides/top profile
3. dimension and depth
4. sketch
5. truncation
6. fill nos.
7. other comments

Co-Ordinates

Consists of:

Overlies:

Level

Butts:

MASONRY:

1. materials
2. size of bricks etc
3. finish of stones
4. coursing/bond
5. form
6. faces
7. bond
8. dimensions as found
9. other comments

Slide No.

Cuts:

Neg No.

Fill of:

Matrix location

Relationships uncertain

Description (See check lists):

IMABLE**DARK BROWN GLEN****SILT CLAY.****≤ 0.36 m THICK.**

STRATIGRAPHIC MATRIX

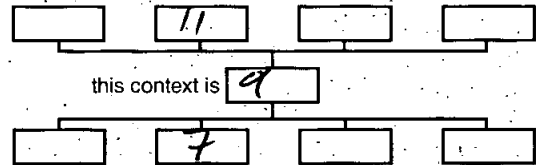

Interpretation/Discussion:

GARDEN / CEMETERY SOIL IN SEC. 1.

Finds (tick): None [] Pot [] Bone [] Flint [] Stone [] Burnt stone [] Glass []
 Metal [] CBM [] Wood [] Leather []

△ Small Finds

Recorder **JM**

◇ Samples

Date **2.2.12**

⬆ Building Materials

Initials



CONTEXT RECORD

Context No.

10

SITE ABHLEN 12.

ADDITIONAL SHEETS:

TYPE LANE

Trench

Context Type: Deposit / Cut / Structure

Check Lists:

Site sub-div

Overlain by: a / 8

DEPOSIT:

1. compaction
2. colour
3. composition
4. inclusion
5. thickness
6. extent
7. comments
8. method & conditions

Structure No.

Abuted by:

Plan No.

1 2

Cut by:

Filled by:

Section No.

1

Same as:

Part of:

CUT:

1. shape in plan
2. base/sides/top profile
3. dimension and depth
4. sketch
5. truncation
6. fill nos
7. other comments

Co-Ordinates

Consists of:

Overlies:

Level

Butts:

MASONRY:

1. materials
2. size of bricks etc
3. finish of stones
4. coursing/bond
5. form
6. faces
7. bond
8. dimensions as found
9. other comments

Slide No.

Cuts:

Neg No.

Fill of:

Matrix location

Relationships uncertain

Description (See check lists):

~~BRICK~~ LOOSE

DARK GREY

SAND SILT.

5/2 GRAVELS.

MOD? CBM - NOT RETAINED.

STRATIGRAPHIC MATRIX

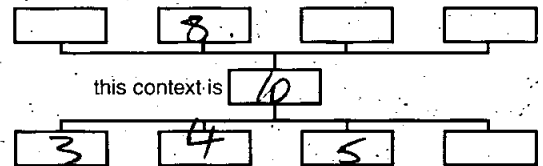

Interpretation/Discussion:

GREY SILT DEPOSIT AROUND WALLS [3] [4] + [5]

- INDISTINGUISHABLE BETWEEN WALLS.

- SOME CBM OF INDETERMINATE DATE.

Finds (tick): None Pot Bone Flint Stone Burnt stone Glass
 Metal CBM Wood Leather

△ Small Finds

Recorder D

◇ Samples

Date 2.2.12.

⊠ Building Materials

Initials



CONTEXT RECORD

Context No.

11

SITE ABYLN 12

ADDITIONAL SHEETS:

TYPE *LANE*

Trench

Context Type: *Deposit* / Cut / Structure

Check Lists:

Site sub-div

Overlain by:

DEPOSIT:

- 1. compaction
- 2. colour
- 3. composition
- 4. inclusion
- 5. thickness
- 6. extent
- 7. comments
- 8. method & conditions

Structure No.

Abutted by:

Plan No.

Cut by:

Filled by:

Section No. *1*

Same as:

Part of:

CUT:

- 1. shape in plan
- 2. base/sides/top profile
- 3. dimension and depth
- 4. sketch
- 5. truncation
- 6. fill nos
- 7. other comments

Co-Ordinates

Consists of:

Overlies:

Level

Butts:

MASONRY:

- 1. materials
- 2. size of bricks etc
- 3. finish of stones
- 4. coursing/bond
- 5. form
- 6. faces
- 7. bond
- 8. dimensions as found
- 9. other comments

Slide No.

Cuts:

Neg No.

Fill of:

Matrix location

Relationships uncertain

Description (See check lists):

YELLOW SANDSTONE SANDS & GRIT ≤ 30 mm φ. ≤ 0.14m THICK

STRATIGRAPHIC MATRIX

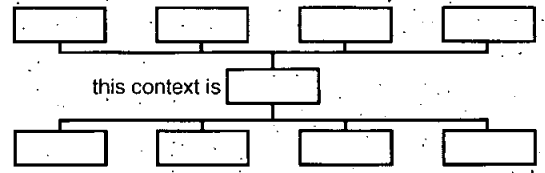

Interpretation/Discussion:

SUB BASE / HOOGINGS FOR PATH.

Finds (tick): None [] Pot [] Bone [] Flint [] Stone [] Burnt stone [] Glass []
Metal [] CBM [] Wood [] Leather []

△ Small Finds

◇ Samples

⏏ Building Materials

Recorder *[Signature]*

Date *2-2-12*

Initials



CONTEXT RECORD

Context No.

12

SITE *ABMUN 12*

ADDITIONAL SHEETS:

TYPE *PAVING*

Trench

Context Type: Deposit / Cut / Structure

Check Lists:

Site sub-div

Overlain by:

DEPOSIT:

1. compaction
2. colour
3. composition
4. inclusion
5. thickness
6. extent
7. comments
8. method & conditions

Structure No.

Abuted by:

Plan No.

2

Cut by:

Filled by:

Section No.

1

Same as:

Part of:

CUT:

1. shape in plan
2. base/sides/top profile
3. dimension and depth
4. sketch
5. truncation
6. fill nos
7. other comments

Co-Ordinates

Consists of:

Overlies:

11

Level

Butts:

MASONRY:

1. materials
2. size of bricks etc
3. finish of stones
4. coursing/bond
5. form
6. faces
7. bond
8. dimensions as found
9. other comments

Slide No.

Cuts:

Neg No.

Fill of:

Matrix location

Relationships uncertain

Description (See check lists):

STRATIGRAPHIC MATRIX

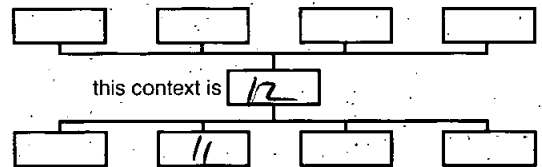

Interpretation/Discussion:

Mod CONC SLAB PAVING

Finds (tick): None [] Pot [] Bone [] Flint [] Stone [] Burnt stone [] Glass []
 Metal [] CBM [] Wood [] Leather []

△ Small Finds

◇ Samples

⬆ Building Materials

Recorder *T23*Date *2-2-12*

Initials

OXCMS 2012.12

ABINGTON
ST HELENS CHURCH
ABTLN 12

B CATALOGUE OF DRAWINGS

B. PRIMARY DRAWINGS

PDF/A SCAN

FILMING INSTRUCTIONS

Submitter OASouth

No. of copies: 2

Headings

Site information

Line 1: [OASouth] County[Oxon] Parish:[Abingdon]

Site[St Helen's Church] Site code[ABHLN 12]

Line 2: Excavators name[D Score]

Line 3:

Classification of material

Tick if present

Index to archive	
Introduction	
A:Final Report	
A:Publication Report	
B:Site Data – Text: Diary/Daybook/Fieldnotes	
B: Site Data – Text: General Summaries	
B: Site Data – Text: Primary Context Records	
B: Site Data – Text: Synthesised Context Records	
B: Site Data – Text: Survey Reports	
B: Site Data – Text: Catalogue of Drawings <i>⊕</i>	<input checked="" type="checkbox"/>
B: Site Data – Text: Primary Drawings	<input checked="" type="checkbox"/>
B: Site Data – Text: Synthesised Drawings	
C: Finds Data – Text: Primary Finds Data	
C: Finds Data – Text: Synthesised Finds Data	
C: Finds Data – Text: Specialist Reports	
C: Finds Data – Text: Box/Bag List	
D: Catalogue of Photos/Slides/Videos/X--rays	
E: Environmental/Ecofact Data: Primary Records	
E: Environmental/Ecofact Data: Synthesised Records	
E: Environmental/Ecofact Data: Specialist Reports	
F: Documentary	
F: Press and Publicity	
G: Correspondence	
H: Miscellaneous	

AB4LN12.
PLAN 1
NOT TO SCALE

MUTUAL'S

EXISTING
MH 4

RM 3

CHOCCH VARE 8

711081

NORTH
PORCH

PAVEMENT

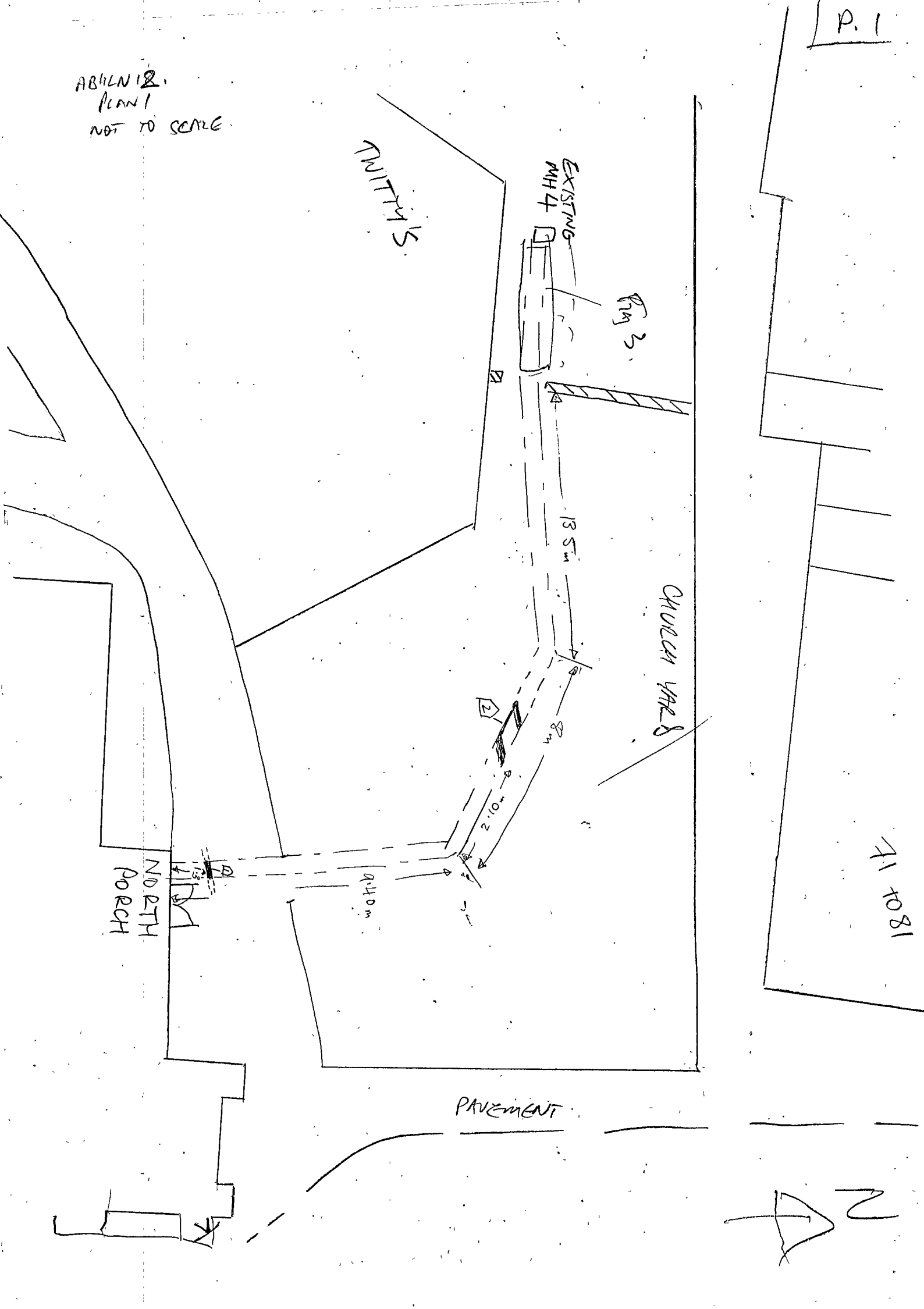
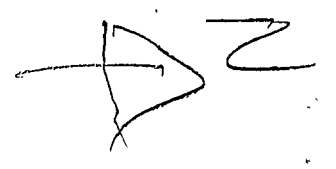

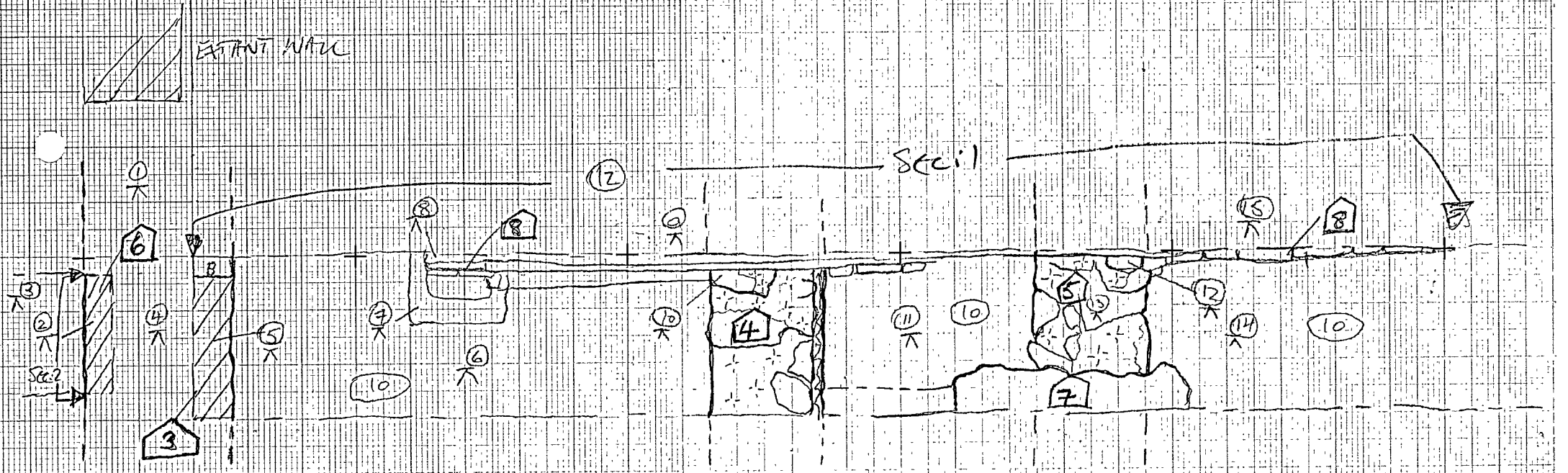

- ① 52.59
- ② 52.35
- ③ 51.41
- ④ 52.59
- ⑤ 54.17
- ⑥ 53.39
- ⑦ 53.85
- ⑧ 54.13
- ⑨ 54.45
- ⑩ 53.95
- ⑪ 53.27
- ⑫ 53.95
- ⑬ 53.61
- ⑭ 54.37
- ⑮ 54.27

PLAN/SECTION NO.	PLAN 2
DRAWN BY	T.B.
CHECKED BY	
DATE	
SCALE	1/20

NOTES

SW CO-ORD.

ABMLN 12

NORTH FACING SECTION 1:20 Tm 2.2.2012

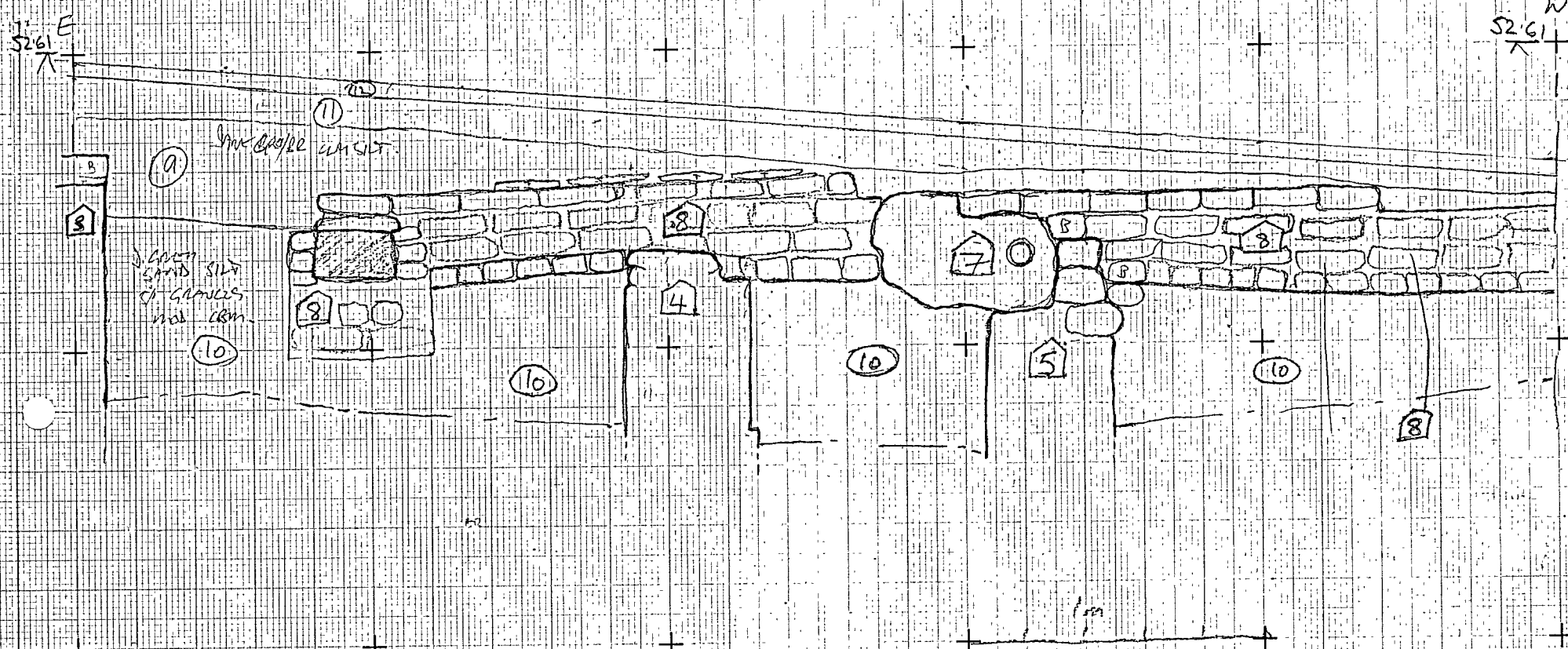

PLAN/SECTION NO.	1
DRAWN BY	Tm
CHECKED BY	
DATE	
SCALE	1:20

NOTES
SW CO-ORD.

ABMLN12

EAST FAUNGS

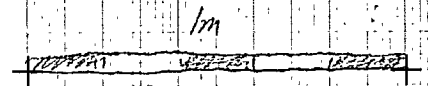
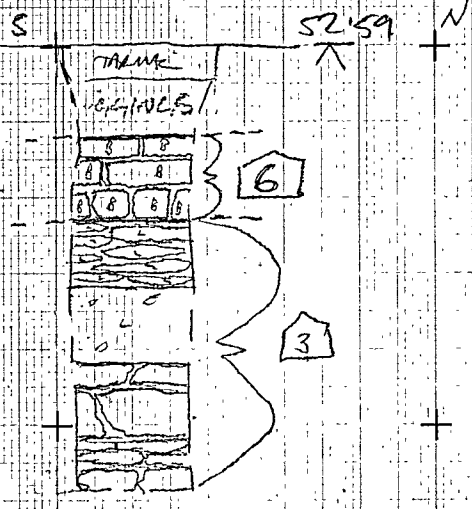

PLAN/SECTION NO.	2
DRAWN BY	[Signature]
CHECKED BY	
DATE	
SCALE	1:20

NOTES	
SW CO-ORD.	

OXCMS: 2012.12

ABINGDON
ST HELENS CHURCH
ABTLN 12.

D. CATALOGUE OF PHOTOS.

PDF/A SCAN

FILMING INSTRUCTIONS

Submitter OASouth

No. of copies: 2

Headings

Site information

Line 1: [OASouth] County[Oxon] Parish:[Abingdon]

Site[St Helen's Church] Site code[ABHLN 12]

Line 2: Excavators name[D Score]

Line 3:

Classification of material

Tick if present

Classification of material	Tick if present
Index to archive	
Introduction	
A:Final Report	
A:Publication Report	
B:Site Data – Text: Diary/Daybook/Fieldnotes	
B: Site Data – Text: General Summaries	
B: Site Data – Text: Primary Context Records	
B: Site Data – Text: Synthesised Context Records	
B: Site Data – Text: Survey Reports	
B: Site Data – Text: Catalogue of Drawings	
B: Site Data – Text: Primary Drawings	
B: Site Data – Text: Synthesised Drawings	
C: Finds Data – Text: Primary Finds Data	
C: Finds Data – Text: Synthesised Finds Data	
C: Finds Data – Text: Specialist Reports	
C: Finds Data – Text: Box/Bag List	
D: Catalogue of Photos/Slides/Videos/X--rays	<input checked="" type="checkbox"/>
E: Environmental/Ecofact Data: Primary Records	
E: Environmental/Ecofact Data: Synthesised Records	
E: Environmental/Ecofact Data: Specialist Reports	
F: Documentary	
F: Press and Publicity	
G: Correspondence	
H: Miscellaneous	

Sheet1

	A	B	C	D	E	F	
1	Site Code: ABHLN 12		Site Name: Abingdon St Helen's Church				
2	Site shot Number	Archive Shot Number	View	Description	Initials	Date	
3							
4	0001	0001		No shot			
5	0002	0002	E	Wall {1} sec. Shot	DS	30/01/12	
6	0003	0003	E	Plan shot wall {1}	DS	30/01/12	
7	0004	0004	E	Location shot	DS	30/01/12	
8	0005	0005	S	Location shot	DS	30/01/12	
9	0006	0006	E	Wall {1} sec. Shot	DS	30/01/12	
10	0007	0007	N	Working shot	DS	31/01/12	
11	0008	0008	Se	Working shot	DS	31/01/12	
12	0009	0009	Se	Working shot	DS	31/01/12	
13	0010	0010	NW	working shot vault {2} in section	DS	31/01/12	
14	0011	0011	SW	Vault {2}	DS	31/01/12	
15	0012	0012	SW	Vault {2}	DS	31/01/12	
16	0013	0013	S	Vault {2}	DS	31/01/12	
17	0014	0014	W	Working shot	DS	31/01/12	
18	0015	0015	W	Working shot to west into church centre	DS	01/02/12	
19	0016	0016	Se	Walls {3}{4}&{5} sec.1.	DS	02/02/12	
20	0017	0017	Se	Walls {3}{4}&{5} sec.1.	DS	02/02/12	
21	0018	0018	E	Walls {3} & {4}	DS	02/02/12	
22	0019	0019	E	Wall {3}	DS	02/02/12	
23	0020	0020	E	Wall {3}	DS	02/02/12	
24	0021	0021	W	Wall {4}	DS	02/02/12	
25	0022	0022	W	Wall {4}	DS	02/02/12	
26	0023	0023	W	Wall {5}	DS	02/02/12	
27	0024	0024	W	Wall {5}	DS	02/02/12	
28	0025	0025	E	Wall {5}	DS	02/02/12	
29	0026	0026	E	Walls {5}{6} {3} view along trench	DS	02/02/12	
30	0027	0027	E	Walls {5}{6} {3} view along trench oblique	DS	02/02/12	
31	0028	0028	E	Trench location shot	DS	02/02/12	
32	0029	0029	E	Trench location shot	DS	02/02/12	
33	0030	0030	N	Wall {3} relationship to cemetery wall	DS	02/02/12	
34	0031	0031	N	Wall {3} relationship to cemetery wall	DS	02/02/12	
35	0032	0032	S	Walls {4} & {5}	DS	02/02/12	
36	0033	0033	S	Walls {3} & {4}	DS	02/02/12	
37	0034	0034	Sw	Walls {3} & {4} & {5}	DS	02/02/12	
38	0035	0035	W	Tr location shot	DS	02/02/12	
39	0036	0036	S	Tr location shot	DS	02/02/12	
40	0037	0037	Se	Tr location shot	DS	02/02/12	
41	0038	0038	Se	Tr location shot	DS	02/02/12	
42	0039	0039	S	Graveyard to trench	DS	02/02/12	
43	0040	0040	S	Graveyard to trench	DS	02/02/12	
44	0041	0041	Se	Graveyard to trench	DS	02/02/12	
45	0042	0042	Se	Graveyard to trench	DS	02/02/12	
46	0043	0043	NW	Twittys almhouses 1707?	DS	02/02/12	
47	0044	0044	NW	Twittys plaques	DS	02/02/12	
48	0045	0045	W	Vicarage	DS	02/02/12	
49	0046	0046	SW	Long Alley almhouses	DS	02/02/12	
50	0047	0047	SW	Long Alley almhouses	DS	02/02/12	
51	0048	0048	W	Long Alley almhouses doorway	DS	02/02/12	
52	0049	0049	W	Long Alley almhouses doorway	DS	02/02/12	
53	0050	0050	W	Long Alley almhouses plaque	DS	02/02/12	
54	0051	0051	N	Towards Twitty's Almshouse	DS	02/02/12	
55	0052	0052	W	Wall {3}	DS	02/02/12	
56	0053	0053	W	Wall {3}	DS	02/02/12	
57	0054	0054	W	Wall {3} & extant wall	DS	02/02/12	
58	0055	0055	E	Trench location shot	DS	02/02/12	
59							



ABHLN12_0002.jpg



ABHLN12_0003.jpg



ABHLN12_0004.jpg



ABHLN12_0005.jpg



ABHLN12_0006.jpg



ABHLN12_0007.jpg



ABHLN12_0008.jpg



ABHLN12_0009.jpg



ABHLN12_0010.jpg



ABHLN12_0011.jpg



ABHLN12_0012.jpg



ABHLN12_0013.jpg



ABHLN12_0014.jpg



ABHLN12_0015.jpg



ABHLN12_0016.jpg



ABHLN12_0017.jpg



ABHLN12_0018.jpg



ABHLN12_0019.jpg



ABHLN12_0020.jpg



ABHLN12_0021.jpg



ABHLN12_0022.jpg



ABHLN12_0023.jpg



ABHLN12_0024.jpg



ABHLN12_0025.jpg



ABHLN12_0026.jpg



ABHLN12_0027.jpg



ABHLN12_0028.jpg



ABHLN12_0029.jpg



ABHLN12_0030.jpg



ABHLN12_0031.jpg



ABHLN12_0032.jpg



ABHLN12_0033.jpg



ABHLN12_0034.jpg



ABHLN12_0035.jpg



ABHLN12_0036.jpg



ABHLN12_0037.jpg



ABHLN12_0038.jpg



ABHLN12_0039.jpg



ABHLN12_0040.jpg



ABHLN12_0041.jpg



ABHLN12_0042.jpg



ABHLN12_0043.jpg



ABHLN12_0044.jpg



ABHLN12_0045.jpg



ABHLN12_0046.jpg



ABHLN12_0047.jpg



ABHLN12_0048.jpg



ABHLN12_0049.jpg



ABHLN12_0050.jpg



ABHLN12_0051.jpg



ABHLN12_0052.jpg



ABHLN12_0053.jpg



ABHLN12_0054.jpg



ABHLN12_0055.jpg