

Site/Project Name: **High Wycombe All Saints**

Site Code: HIALL 11

Site/Project Type: Building survey

Year(s): 2011

Accession Number:

Record Group	Contents	Comments	Box/File Number
	INTRODUCTION Project brief	1 sheet	Box 1 file 1
B	PRIMARY CONTEXT DATA Site notes	1 sheet	Box 1 file 1
B	PRIMARY DRAWINGS Site plan & section	2 A2 sheets	Roll 1 of 1 in box
D	CATALOGUE OF PHOTOGRAPHS B/W index Digital index films 1-3 Digital index jpg's	1 sheet 4 sheets 4 sheets	Box 1 file 1

PDF/A SCAN

FILMING INSTRUCTIONS

Submitter OASouth

No. of copies: 2

Headings

Site information

Line 1: [OASouth] County[Bucks] Parish:[High Wycombe]

Site[All Saints] Site code[HIALL 11]

Line 2: Excavators name[J Gill]

Line 3:

Classification of material

Tick if present

Classification of material	Tick if present
Index to archive	<input checked="" type="checkbox"/>
Introduction	<input type="checkbox"/>
A:Final Report	<input type="checkbox"/>
A:Publication Report	<input type="checkbox"/>
B:Site Data – Text: Diary/Daybook/Fieldnotes	<input type="checkbox"/>
B: Site Data – Text: General Summaries	<input type="checkbox"/>
B: Site Data – Text: Primary Context Records	<input type="checkbox"/>
B: Site Data – Text: Synthesised Context Records	<input type="checkbox"/>
B: Site Data – Text: Survey Reports	<input type="checkbox"/>
B: Site Data – Text: Catalogue of Drawings	<input type="checkbox"/>
B: Site Data – Text: Primary Drawings	<input type="checkbox"/>
B: Site Data – Text: Synthesised Drawings	<input type="checkbox"/>
C: Finds Data – Text: Primary Finds Data	<input type="checkbox"/>
C: Finds Data – Text: Synthesised Finds Data	<input type="checkbox"/>
C: Finds Data – Text: Specialist Reports	<input type="checkbox"/>
C: Finds Data – Text: Box/Bag List	<input type="checkbox"/>
D: Catalogue of Photos/Slides/Videos/X--rays	<input type="checkbox"/>
E: Environmental/Ecofact Data: Primary Records	<input type="checkbox"/>
E: Environmental/Ecofact Data: Synthesised Records	<input type="checkbox"/>
E: Environmental/Ecofact Data: Specialist Reports	<input type="checkbox"/>
F: Documentary	<input type="checkbox"/>
F: Press and Publicity	<input type="checkbox"/>
G: Correspondence	<input type="checkbox"/>
H: Miscellaneous	<input type="checkbox"/>

OASIS DATA COLLECTION FORM: England

[List of Projects](#) | [Manage Projects](#) | [Search Projects](#) | [New project](#) | [Change your details](#) | [HER coverage](#) | [Change country](#) | [Log out](#)

Printable version

OASIS ID: oxfordar1-145348

Project details

Project name	All Saints Church High Wycombe Buckinghamshire
Short description of the project	All Saints Church is a Grade I listed building which has remained an important religious and historical focus within High Wycombe since the Norman period. The church has had a set of bells, almost certainly since the medieval period, which has been replaced or augmented at intervals but in recent years cracks have appeared in the walls of the tower housing the bells and since 2008 it has not been possible to ring the largest four bells for structural reasons. Investigations were undertaken which concluded that the current structure was failing, particularly the wall-plates which were infested with death watch beetle, and needed replacing. A reinforced concrete ring beam would effectively tie the tower together and a new bell frame was needed so that the bells could be orientated differently to reduce the stresses on the south wall. Many of the bells were of poor tonal quality, so it was decided to take the opportunity that these works presented to replace the entire ring with a new set of 12 bells plus 2 semi-tones.
Project dates	Start: 20-12-2011 End: 20-12-2011
Previous/future work	Yes / Not known
Any associated project reference codes	HIALL 11 - Sitecode
Type of project	Building Recording
Site status	Listed Building
Current Land use	Other 2 - In use as a building
Monument type	CHURCH Medieval
Significant Finds	NONE None
Methods & techniques	"Survey/Recording Of Fabric/Structure"
Prompt	Faculty jurisdiction

Project location

Country	England
Site location	BUCKINGHAMSHIRE WYCOMBE HIGH WYCOMBE All Saints Church
Study area	2.00 Square metres

Site coordinates SU 8656 9309 51 0 51 37 46 N 000 44 57 W Point

Project creators

Name of Organisation Oxford Archaeology
 Project brief originator G Pledger Senior Conservation Engineer
 Project design originator Oxford Archaeology
 Project director/manager J. Gill
 Project supervisor J Gill
 Type of sponsor/funding body Parochial Church Council

Project archives

Physical Archive Exists? No
 Digital Archive recipient Oxford Archaeology
 Digital Archive ID HIALl 11
 Digital Contents "other"
 Digital Media available "Images raster / digital photography", "Text"
 Paper Archive recipient Bucks County Museum
 Paper Archive ID HIALl 11
 Paper Contents "other"
 Paper Media available "Diary", "Plan", "Report", "Section", "Unpublished Text"

Project bibliography 1

Publication type Grey literature (unpublished document/manuscript)
 Title All Saints Church High Wycombe Buckinghamshire
 Author(s)/Editor(s) Gill J
 Date 2012
 Issuer or publisher Oxford Archaeology South
 Place of issue or publication Oxford
 Description Client report
 URL <http://library.thehumanjourney.net/1016>
 Entered by Nicola Scott (n.scott@oxfordarch.co.uk)
 Entered on 12 March 2013

OASIS:

Please e-mail English Heritage for OASIS help and advice

© ADS 1996-2012 Created by Jo Gilham and Jen Mitcham, email Last modified Wednesday 9 May 2012

Cite only: <http://www.oasis.ac.uk/form/print.cfm> for this page

Box 1 File 1

HENRY WYCOMBE

ALL SAINTS

HALL II

ALL RECORDS

See also 1001 10-1

PDF/A SCAN

FILMING INSTRUCTIONS

Submitter OASouth

No. of copies: 2

Headings

Site information

Line 1: [OASouth] County[Bucks] Parish:[High Wycombe]

Site[All Saints] Site code[HIALL 11]

Line 2: Excavators name[J Gill]

Line 3:

Classification of material

Tick if present

Classification of material	Tick if present
Index to archive	
Introduction	<input checked="" type="checkbox"/>
A:Final Report	
A:Publication Report	
B:Site Data – Text: Diary/Daybook/Fieldnotes	
B: Site Data – Text: General Summaries	
B: Site Data – Text: Primary Context Records	
B: Site Data – Text: Synthesised Context Records	
B: Site Data – Text: Survey Reports	
B: Site Data – Text: Catalogue of Drawings	
B: Site Data – Text: Primary Drawings	
B: Site Data – Text: Synthesised Drawings	
C: Finds Data – Text: Primary Finds Data	
C: Finds Data – Text: Synthesised Finds Data	
C: Finds Data – Text: Specialist Reports	
C: Finds Data – Text: Box/Bag List	
D: Catalogue of Photos/Slides/Videos/X--rays	
E: Environmental/Ecofact Data: Primary Records	
E: Environmental/Ecofact Data: Synthesised Records	
E: Environmental/Ecofact Data: Specialist Reports	
F: Documentary	
F: Press and Publicity	
G: Correspondence	
H: Miscellaneous	

From: Graham Pledger, Senior Conservation Engineer

Re: Church of All Saints, High Wycombe, Buckinghamshire
Conservation Engineering Team Report dated 18 September 2008

Date: 21 July 2011

i) Archaeological Record. The 1909 workshop drawing, (see attached), goes a long way to providing an adequate record. The 1963 alterations have apparently been marked up on a further 1909 plan but this has not been submitted to us. However, both plans need to be supplemented by a plan of the supporting belfry floor including the (decayed) timber ring beams/wall plates and at least an E-W and N-S section of both bellframe and supporting belfry floor.

The full report should be presented in a way that makes it readily understandable to the reader (who may not have specialist knowledge of bell frames), bearing in mind that it might become the only record of the frame. The date(s) of the survey work, and the date of the report should be recorded, along with the name(s) of the author(s) and surveyor(s) The following guidelines should be observed:

- printed copies should be on acid-free A4 paper, with folded A3 drawings inserted as necessary;
- references should be supplied for all sources cited;
- the involvement of consultees (DAC, CBC, SPAB or EH) should be mentioned and any assistance received in making the record should be acknowledged;
- six paper copies of the report should be provided, one of which should be kept by the PCC. Other copies should be sent to the DAC, the Historic Environment Record, the Diocesan Record Office, the Library of the Central Council of Church Bell Ringers and the Church Buildings Council;
- print-quality electronic copies may be submitted if preferred, although a paper copy should be provided for the parish.

It is good practice for any resulting archive (original sketches, drawings, photographs, notes, etc) to be deposited in the relevant Diocesan Record Office.

ii) New concrete ring beam. Approved.

iii) Lowered ceiling. Whilst no drawing has been submitted, it is understood that this will be inserted beneath the present clockroom floor structure but above the cantilevered clock platform on the east wall. Approved.

iv) Permanent lifting beams. It is noted that these are to be built into the walls rather than left in open pockets as recommended.

PDF/A SCAN

FILMING INSTRUCTIONS

Submitter OASouth

No. of copies: 2

Headings

Site information

Line 1: [OASouth] County[Bucks] Parish:[High Wycombe]

Site[All Saints] Site code[HIALL 11]

Line 2: Excavators name[J Gill]

Line 3:

Classification of material

Tick if present

Index to archive	
Introduction	
A:Final Report	
A:Publication Report	
B:Site Data – Text: Diary/Daybook/Fieldnotes	<input checked="" type="checkbox"/>
B: Site Data – Text: General Summaries	
B: Site Data – Text: Primary Context Records	
B: Site Data – Text: Synthesised Context Records	
B: Site Data – Text: Survey Reports	
B: Site Data – Text: Catalogue of Drawings	
B: Site Data – Text: Primary Drawings	
B: Site Data – Text: Synthesised Drawings	
C: Finds Data – Text: Primary Finds Data	
C: Finds Data – Text: Synthesised Finds Data	
C: Finds Data – Text: Specialist Reports	
C: Finds Data – Text: Box/Bag List	
D: Catalogue of Photos/Slides/Videos/X--rays	
E: Environmental/Ecofact Data: Primary Records	
E: Environmental/Ecofact Data: Synthesised Records	
E: Environmental/Ecofact Data: Specialist Reports	
F: Documentary	
F: Press and Publicity	
G: Correspondence	
H: Miscellaneous	

20/12/11

All Saints High Wycombe - Site Notes.

EH agree that concrete ring beam is the only way of getting the bells to ring again (haven't rung since 2008) but they can't actually support this on heritage ground.
Main structure is 1909

V. bad death watch beetle in wall plates (which I think are older than main frame).

I think the 2 wall plates are definitely older than the main frame which is 1909. Main clue are 2 equally spaced marks in each presumably from binders/joist across bell tower. Slightly odd that they don't really line up quite ~~to~~ but it may well be that there was a spine joist and that the 2 binders to each side were stepped. It's always possible (of course) that the beams ~~are~~ ^{were} reused so it's all a red herring but in 1909 I don't think they'd have reused just the little bit.



One beam also shows clear evidence of form plates in 'end' walls which would have sat on the ledges in these walls. These replaced in 1963 work by conc pads.

The marks certainly don't relate to 1909 work - too old fashioned.

I'm still in 2 minds about the 'old' wall plates ~~at all~~. The wood clearly has far more wear etc & is older but possibly reused. The 2 plates have chamfered undersides but intermediate joists don't

On or 2 clear bits of 1963 strengthening to the steel bell frame - will only really be the corner for that for the door. Bells re-hung in 1963 with newly cast bearings ~~etc~~ (John Taylor, Loughborough 1963) but bells themselves 1909.

BELL CHAMBER

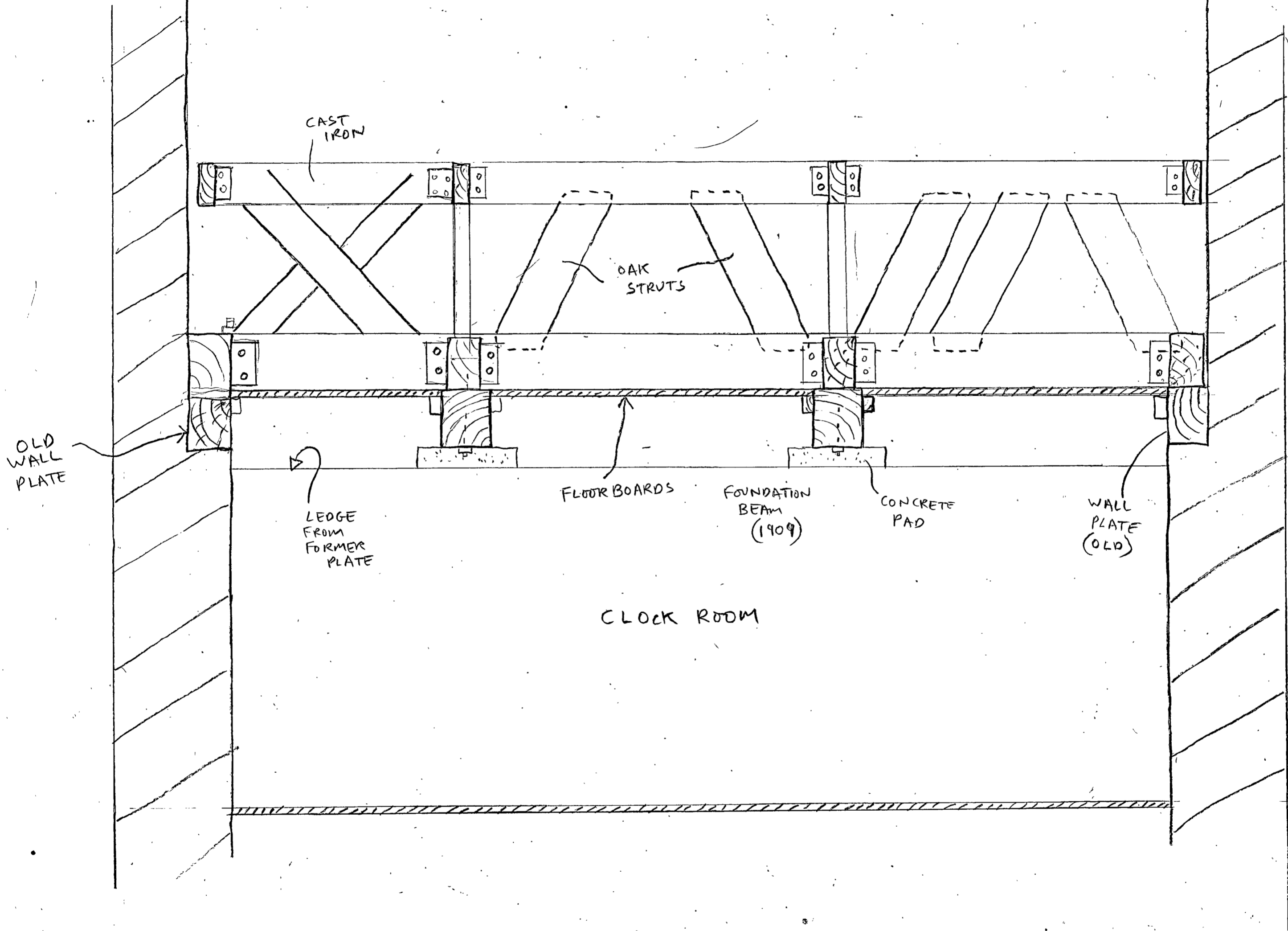

49
D61

CLOCK ROOM

H1ALL11
ALL SAINTS HIGH WYCOMBE
SECTION THROUGH TOWER LOOKING SOUTH
DEC 2011
JON GILL
SCALE 1:20

ALL SAINTS, HIGH WYCOMBE
PLAN OF CLOCK ROOM
BENEATH BELL
CHAMBER

SCALE: 1:20
HIALLI
DEC 2011
JON GILL

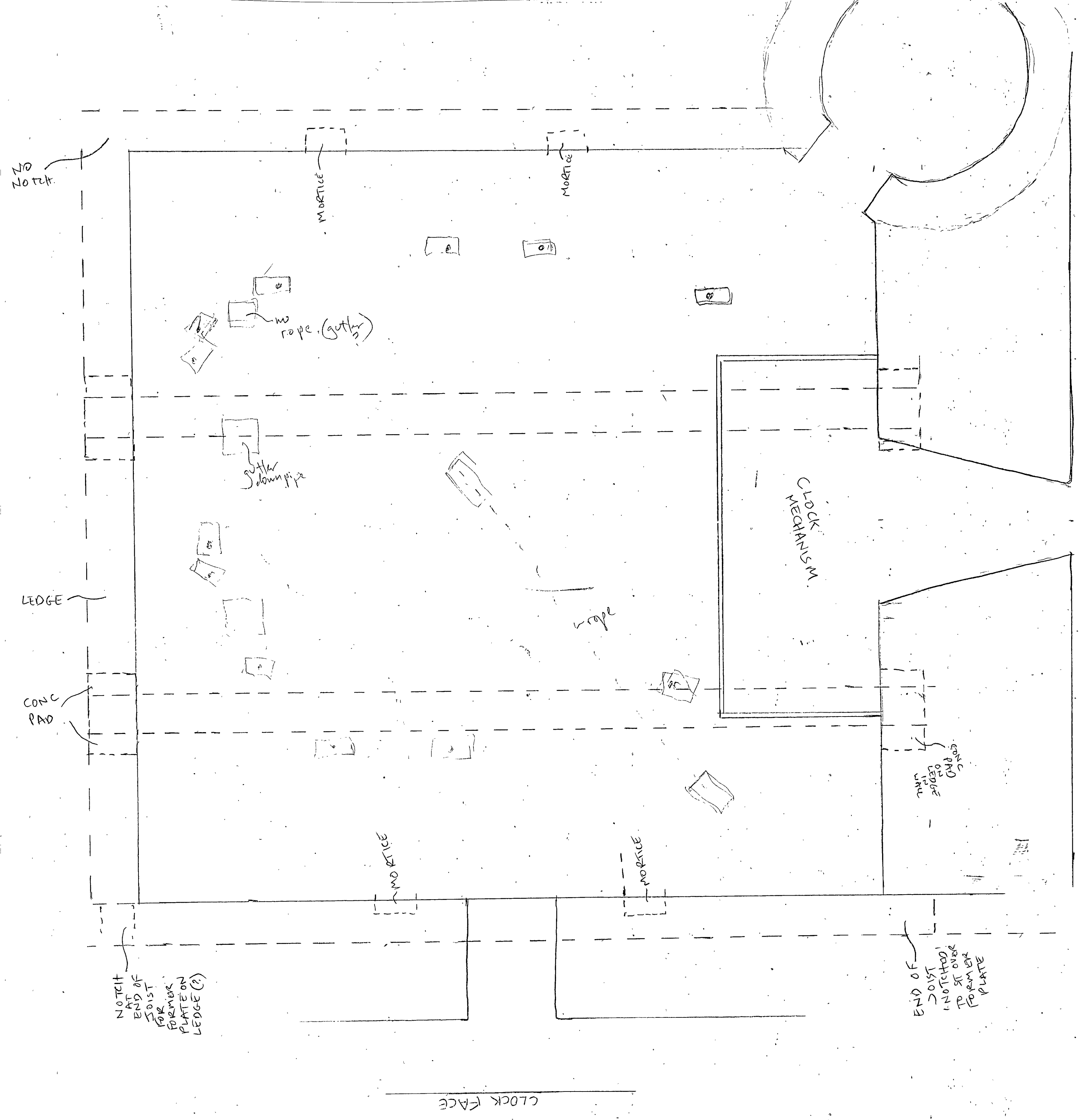

NO NOTCH

MORTICE

MORTICE

w rope (gutter?)

Gutter down pipe

LEDGE

CONC PAD

CLOCK MECHANISM

CONC PAD ON LEDGE WITH WIRE

MORTICE

MORTICE

NOTCH AT END OF JOIST FOR FORMER PLATE ON LEDGE (?)

END OF JOIST NOTCH TO SET OVER FORMER PLATE

CLOCK FACE

PDF/A SCAN

FILMING INSTRUCTIONS

Submitter OASouth

No. of copies: 2

Headings

Site information

Line 1: [OASouth] County[Bucks] Parish:[High Wycombe]

Site[All Saints] Site code[HIALL 11]

Line 2: Excavators name[J Gill]

Line 3:

Classification of material

Tick if present

Index to archive	
Introduction	
A:Final Report	
A:Publication Report	
B:Site Data – Text: Diary/Daybook/Fieldnotes	
B: Site Data – Text: General Summaries	
B: Site Data – Text: Primary Context Records	
B: Site Data – Text: Synthesised Context Records	
B: Site Data – Text: Survey Reports	
B: Site Data – Text: Catalogue of Drawings	
B: Site Data – Text: Primary Drawings	
B: Site Data – Text: Synthesised Drawings	
C: Finds Data – Text: Primary Finds Data	
C: Finds Data – Text: Synthesised Finds Data	
C: Finds Data – Text: Specialist Reports	
C: Finds Data – Text: Box/Bag List	
D: Catalogue of Photos/Slides/Videos/X--rays	✓
E: Environmental/Ecofact Data: Primary Records	
E: Environmental/Ecofact Data: Synthesised Records	
E: Environmental/Ecofact Data: Specialist Reports	
F: Documentary	
F: Press and Publicity	
G: Correspondence	
H: Miscellaneous	

Oxford Archaeology			Photographic Record Sheet		J Gill
SITE CODE: HIALL11			SITE NAME: All Saints, High Wycombe Bell Frame		FILM No. 1
Camera No.			Lens No.		Black & white
Date	Neg	View toward	Details		Initials
20 Dec 11	2	NW	Room beneath the bell frame – general view		
	3	SW	Room beneath the bell frame – general view		
	4	E	Room beneath the bell frame – clock mechanism enclosure		
	5	SW	Room beneath the bell frame – pulley wheel		
	6	E	Room beneath the bell frame – wall plate detail		
	7	S	Room beneath the bell frame – part of clock mechanism		
	8	SW	Room beneath the bell frame – ceiling detail		
	9	W	Room beneath the bell frame – intermediate joist on pad		
	10	W	Room beneath the bell frame – floor detail		
	11	S	Room beneath the bell frame – floor detail		
	12	S	Room beneath the bell frame – part of clock mechanism		
	13	E	Room beneath the bell frame – pulleys etc in ceiling		
	14	SE	Room beneath the bell frame – pulleys etc in ceiling		
	15	S	Room beneath the bell frame – wall detail		
	16	N	Bells and bell frame in main bell chamber – general view		
	17	N	Bells and bell frame in main bell chamber – general view		
	18	S	Bells and bell frame in main bell chamber – general view		
	19	S	Bells and bell frame in main bell chamber – general view		
	20	S	Bells and bell frame in main bell chamber – general view		
	21	E	Bells and bell frame in main bell chamber – general view		
	22	E	Bells and bell frame in main bell chamber – general view		
	23	N	Bells and bell frame in main bell chamber – general view		
	24	N	Bells and bell frame in main bell chamber – general view		
	25	N	Bells and bell frame in main bell chamber – general view		
	26	N	Bells and bell frame in main bell chamber – general view		
	27	W	Bells and bell frame in main bell chamber – general view		
	28	W	Bells and bell frame in main bell chamber – general view		
	29	W	Bells and bell frame in main bell chamber – general view		
	30	W	Bells and bell frame in main bell chamber – general view		
	31	W	Bells and bell frame in main bell chamber – general view		
	32	N	Bells and bell frame in main bell chamber – general view		
	33	N	Bells and bell frame in main bell chamber – general view		
	34	N	Bells and bell frame in main bell chamber – general view		
	35	N	Bells and bell frame in main bell chamber – general view		
	36	S	Bells and bell frame in main bell chamber – general view		
	37	S	Bells and bell frame in main bell chamber – general view		

Oxford Archaeology			Photographic Record Sheet		J Gill	
SITE CODE: HIALL11			SITE NAME: All Saints, High Wycombe Bell Frame		FILM No. 1	
Camera No.			Lens No.		Digital	
Date	Neg	View toward	Details			Initials
20 Dec 11	1	E	Clock room beneath bell chamber – joist detail			
	2	N	Clock room beneath bell chamber – joist detail and clock lever			
	3	E	Clock room beneath bell chamber – towards clock enclosure			
	4	E	Clock room beneath bell chamber – towards clock enclosure			
	5	SW	Clock room beneath bell chamber – general			
	6	SW	Clock room beneath bell chamber – floor detail			
	7	NW	Clock room beneath bell chamber – general			
	8	SW	Clock room beneath bell chamber – floor detail			
	9	SW	Clock room beneath bell chamber – pulley			
	10	S	Clock room beneath bell chamber – detail in wall plate			
	11	S	Clock room beneath bell chamber – floor detail			
	12	E	Clock room beneath bell chamber – floor detail			
	13	S	Clock room beneath bell chamber – detail of ledge			
	14	N	Clock room beneath bell chamber – ceiling detail			
	15	NW	Clock room beneath bell chamber – ceiling detail			
	16	NE	Clock room beneath bell chamber – ceiling details			
	17	E	Clock room beneath bell chamber – general			
	18	E	Clock room beneath bell chamber – clock mechanism			
	19	S	Bell chamber before removal of bells – general view			
	20	S	Bell chamber before removal of bells – general view			
	21	S	Bell chamber before removal of bells – general view			
	22	S	Bell chamber before removal of bells – general view			
	23	SE	Bell chamber before removal of bells – general view			
	24	SE	Bell chamber before removal of bells – general view			
	25	SW	Bell chamber before removal of bells – general view			
	26	S	Bell chamber before removal of bells – general view			
	27	N	Bell chamber before removal of bells – general view			
	28	N	Bell chamber before removal of bells – general view			
	29	N	Bell chamber before removal of bells – general view			
	30	W	Bell chamber before removal of bells – general view			
	31	W	Bell chamber before removal of bells – general view			
	32	W	Bell chamber before removal of bells – general view			
	33	SW	Bell chamber before removal of bells – general view			
	34	SW	Bell chamber before removal of bells – general view			
	35	E	Bell chamber before removal of bells – general view			
	36	E	Bell chamber before removal of bells – general view			
	37	N	Bell chamber before removal of bells – general view			

	38	N	Bell chamber before removal of bells – general view	
	39	N	Bell chamber before removal of bells – general view	
	40	S	Bell chamber before removal of bells – general view	
	41	S	Bell chamber before removal of bells – general view	
	42	S	Bell chamber before removal of bells – general view	
	43	S	Bell chamber before removal of bells – detail by NE corner	
	44	S	Bell chamber before removal of bells – general view	
	45	S	Bell chamber before removal of bells – general view	
	46	S	Bell chamber before removal of bells – general view	
	47	S	Bell chamber before removal of bells – general view	
	48	S	Bell chamber before removal of bells – general view	
	49	S	Bell chamber before removal of bells – general view	
	50	S	Bell chamber before removal of bells – detail by door jamb	
	51	S	Bell chamber before removal of bells – general view	



HIALL11_F1 (1).JPG



HIALL11_F1 (2).JPG



HIALL11_F1 (3).JPG



HIALL11_F1 (4).JPG



HIALL11_F1 (5).JPG



HIALL11_F1 (6).JPG



HIALL11_F1 (7).JPG



HIALL11_F1 (8).JPG



HIALL11_F1 (9).JPG



HIALL11_F1 (10).JPG



HIALL11_F1 (11).JPG



HIALL11_F1 (12).JPG



HIALL11_F1 (13).JPG



HIALL11_F1 (14).JPG



HIALL11_F1 (15).JPG



HIALL11_F1 (16).JPG



HIALL11_F1 (17).JPG



HIALL11_F1 (18).JPG



HIALL11_F1 (19).JPG



HIALL11_F1 (20).JPG



HIALL11_F1 (21).JPG



HIALL11_F1 (22).JPG



HIALL11_F1 (23).JPG



HIALL11_F1 (24).JPG



HIALL11_F1 (25).JPG



HIALL11_F1 (26).JPG



HIALL11_F1 (27).JPG



HIALL11_F1 (28).JPG



HIALL11_F1 (29).JPG



HIALL11_F1 (30).JPG



HIALL11_F1 (31).JPG



HIALL11_F1 (32).JPG



HIALL11_F1 (33).JPG



HIALL11_F1 (34).JPG



HIALL11_F1 (35).JPG



HIALL11_F1 (36).JPG



HIALL11_F1 (37).JPG



HIALL11_F1 (38).JPG



HIALL11_F1 (39).JPG



HIALL11_F1 (40).JPG



HIALL11_F1 (41).JPG



HIALL11_F1 (42).JPG



HIALL11_F1 (43).JPG



HIALL11_F1 (44).JPG



HIALL11_F1 (45).JPG



HIALL11_F1 (46).JPG



HIALL11_F1 (47).JPG



HIALL11_F1 (48).JPG



HIALL11_F1 (49).JPG



HIALL11_F1 (50).JPG



HIALL11_F1.JPG



HIALL11_F2 (1).JPG



HIALL11_F2 (2).JPG



HIALL11_F2 (3).JPG



HIALL11_F2 (4).JPG



HIALL11_F2 (5).JPG



HIALL11_F2 (6).JPG



HIALL11_F2 (7).JPG



HIALL11_F2 (8).JPG



HIALL11_F2 (9).JPG



HIALL11_F2 (10).JPG



HIALL11_F2 (11).JPG



HIALL11_F2 (12).JPG



HIALL11_F2 (13).JPG



HIALL11_F2 (14).JPG



HIALL11_F2 (15).JPG



HIALL11_F2 (16).JPG



HIALL11_F2 (17).JPG



HIALL11_F2 (18).JPG



HIALL11_F2 (19).JPG



HIALL11_F2 (20).JPG



HIALL11_F2 (21).JPG



HIAL11_F3 (1).JPG



HIAL11_F3 (2).JPG



HIAL11_F3 (3).JPG



HIAL11_F3 (4).JPG



HIAL11_F3 (5).JPG



HIAL11_F3 (6).JPG