

The Loans 19 Wharf Road Shillingford Oxfordshire



Archaeological Watching Brief Report



June 2006

Issue N^o: 1
OA Job N^o: 3101
Planning Ref N^o: P05/W0625
NGR: SU 5945 9262

Client Name:

Client Ref No:

Document Title: The Loans, 19 Wharf Road, Shillingford, Oxfordshire

Document Type: Watching Brief

Issue Number: 1

National Grid Reference: NGR SU 5945 9262

Planning Reference: P05/W0625

OA Job Number: 3101

Site Code: SHLOAN 06

Invoice Code: SHLOANWB

Receiving Museum: Oxfordshire County Museum Service

Museum Accession No: OXCMS 2006.11

Prepared by: James Mumford

Position: Project Officer

Date: 14th June 2006

Checked by: Dan Dodds

Position: Head of Small Works

Date: 14th June 2006

Approved by: Nick Shepherd

Position: Head of Fieldwork

Date: 14th June 2006

Signed.....

Document File Location U:/OAU/wbREPORTS/Oxfordshire/SHLOAN.doc

Graphics File Location Servergo/r thru z*SHLOAN06*SHLOANWB*The
Loans, Shillingford*AH*14.6.06

Illustrated by Amy Tiffany Hemingway

Disclaimer:

This document has been prepared for the titled project or named part thereof and should not be relied upon or used for any other project without an independent check being carried out as to its suitability and prior written authority of Oxford Archaeology being obtained. Oxford Archaeology accepts no responsibility or liability for the consequences of this document being used for a purpose other than the purposes for which it was commissioned. Any person/party using or relying on the document for such other purposes agrees, and will by such use or reliance be taken to confirm their agreement to indemnify Oxford Archaeology for all loss or damage resulting therefrom. Oxford Archaeology accepts no responsibility or liability for this document to any party other than the person/party by whom it was commissioned.

Oxford Archaeology

© Oxford Archaeological Unit Ltd 2006

Janus House

Osney Mead

Oxford OX2 0ES

t: (0044) 01865 263800

f: (0044) 01865 793496

e: info@oxfordarch.co.uk

w: www.oxfordarch.co.uk

Oxford Archaeological Unit Limited is a Registered Charity No: 285627

The Loans, 19 Wharf Road, Shillingford, Oxfordshire

ARCHAEOLOGICAL WATCHING BRIEF REPORT

CONTENTS

Summary	1
1 Introduction	1
1.1 Location and scope of work	1
1.2 Geology and topography	1
1.3 Archaeological and historical background	1
2 Project Aims and Methodology	1
2.1 Aims	1
2.2 Methodology	2
3 Results	2
3.1 Description of deposits	2
3.2 Finds	2
3.3 Palaeo-environmental remains	2
4 Discussion and Conclusions	3
Appendix 1 Archaeological Context Inventory	4
Appendix 2 Bibliography and References	4
Appendix 3 Summary of Site Details	4

LIST OF FIGURES

- Fig. 1 Site location
Fig. 2 Plan of new swimming pool, location of section and section

Cover Plate: View of site during excavation of foundations from south-west.

SUMMARY

From February to June 2006 Oxford Archaeology (OA) carried out an archaeological watching brief at The Loans, 19 Wharf Road, Shillingford, Oxfordshire (NGR: SU 5945 9262). The work was commissioned in advance of the construction of a new swimming pool at the rear of the property. The watching brief revealed thick soil horizons and a possible linear feature/ditch.

1 INTRODUCTION

1.1 Location and scope of work

- 1.1.1 From February to June 2006 Oxford Archaeology (OA) carried out an archaeological watching brief at The Loans, 19 Wharf Road, Shillingford, Oxfordshire (Fig. 1). The work was commissioned in respect of a planning application for construction of new swimming pool at the rear of the property (Planning Application No. P05/W0625).
- 1.1.2 A project brief was set by Paul Smith, the County Archaeological Officer representing South Oxfordshire District Council (OCAS 2006).
- 1.1.3 OA prepared a Written Scheme of Investigation (WSI) detailing how it would meet the requirements of the brief (OA 2006).

1.2 Geology and topography

- 1.2.1 The development site lies on the east side of Wharf Road, Shillingford and north of the River Thames (SU 5945 9262). The existing land use is a single dwelling and garden. The site is situated at approximately 48 metres above OD and the underlying geology is 1st (Flood Plain) Terrace Deposits.

1.3 Archaeological and historical background

- 1.3.1 The archaeological background to the watching brief was prepared for the WSI for the project (OA 2006) and is reproduced below.
- 1.3.2 An undated enclosure has been identified from crop marks at SU 5955 9270 (HBSMR 15367), about 100 metres north-east of the development area. This is a trapezoidal ditched enclosure enclosing an area of about 4,800 square metres. There are additional linear features and possible pits outside the enclosure. Another complex of parallel ditches has been identified at SU 594 929. The environs of Warborough and Shillingford contain many other extensive prehistoric, Roman and Saxon remains.

2 PROJECT AIMS AND METHODOLOGY

2.1 Aims

2.1.1 To identify and record the presence/absence, extent, condition, quality and date of archaeological remains in the areas affected by the development.

2.1.2 To make available the results of the archaeological investigation.

2.2 Methodology

2.2.1 The site was cleared by hand and then the foundations for the swimming pool were excavated by hand. The north side of the foundation trenches were excavated under archaeological supervision, the southern, western and eastern were excavated and filled with concrete without any archaeological supervision. The centre of the swimming pool was excavated using a mini excavator.

2.2.2 All archaeological features were planned at a scale of 1:100 and where excavated their sections drawn at scales of 1:20. All excavated features were photographed using colour slide and black and white print film. A general photographic record of the work was made Recording followed procedures detailed in the *OAU Fieldwork Manual* (ed. D Wilkinson, 1992).

3 RESULTS

3.1 Description of deposits (*Fig. 2*)

3.1.1 The foundation trenches cut into a light yellowish brown sandy gravel (1) natural at 1.2 m below ground level. This had been sealed by a 0.12 m - 0.14 m thick layer of very dark grey brown silty clay (2) alluvium. Overlying this was a 0.5 m thick layer of reddish brown silty clay with patches of yellowish brown clay and gravel (3). This was a former old sub soil, which was sealed by a 0.7 m thick dark reddish brown silty clay (4) cultivated topsoil. This was sealed by the present garden topsoil and flowerbed of a very dark grey brown silty clay loam (5). It had been cut by a service trench (9) with vertical sides and flat base. It measured 5.2 m x 0.6 m x 1.1 m and was filled by dark brown silty clay (10) and brick rubble with 4" ceramic pipe in base. Cutting into the top was the garden path (6) with a three-course high drystone wall (7), which bordered the gravel path (8).

3.1.2 During the later removal the central area of the swimming pool a possible ditch (11) was located in the east trench and partly exposed in the northern trench. The ditch 11 had a shallow concave profile and cut through the alluvium layer (2) into the natural gravel (1). It measured 0.9 m wide and 0.35 m in depth and was filled by a dark reddish brown silty clay (12), which was sealed below the sub soil (3). The ditch was undated.

3.2 Finds

3.2.1 No finds were recovered from the watching brief.

3.3 Palaeo-environmental remains

- 3.3.1 No deposits suitable for environmental sampling were identified during the watching brief.

4 **DISCUSSION AND CONCLUSIONS**

- 4.1.1 The watching brief revealed an number of thick soil deposits. These appear to be from when the site was a former dairy farm and later garden make-up in the 19th and early 20th century. A feature was observed in the last part of the ground-works and could be a linear relating to the enclosure recorded in crop marks to the north-east of the site. It cut through the alluvium deposit overlying the natural and was sealed by the thick sub soil horizon, which could be a seal a number of earlier features on the river flood plain.

APPENDICES

APPENDIX 1 ARCHAEOLOGICAL CONTEXT INVENTORY

<i>Context</i>	<i>Type</i>	<i>Depth</i>	<i>Width</i>	<i>Length</i>	<i>Comments</i>
1	Natural				Natural Gravel
2	Layer	0.14 m			Alluvium
3	Layer	0.50 m			Sub soil
4	Layer	0.70 m			Cultivated soil
5	Layer	0.50 m			Garden topsoil
6	Cut				Garden pathway
7	Structure	0.22 m	0.24 m		
8	Layer	0.16 m			Gravel pathway
9	Cut	1.10 m	0.60 m		Service trench
10	Fill				fill of trench
11	Cut	0.35 m	0.90 m		Ditch
12	Fill				Fill of ditch

APPENDIX 2 BIBLIOGRAPHY AND REFERENCES

OA 2006 *The Loans, 19 Wharf Road, Shillingford, Oxfordshire Written Scheme of Investigation*

OAU, 1992 *Field Manual* (ed. Wilkinson D)

OCAS, 2006 *Design Brief for Archaeological Watching Brief P05/W0625 – The Loans, 19 Wharf Road, Shillingford (in the parish of Warborough)*

APPENDIX 3 SUMMARY OF SITE DETAILS

Site name: The Loans, 19 Wharf Road, Shillingford, Oxfordshire

Site code: SHLOAN 06

Grid reference: NGR SU 5945 9262

Type of watching brief: Monitoring of ground-works for the construction of a new swimming pool at rear of property.

Date and duration of project: Four site visits from the 7/2/2006 to the 2/6/2006.

Area of site: 10.2 m x 5.2 m

Summary of results: The watching brief revealed thick soil horizons and a possible linear.

Location of archive: The archive is currently held at OA, Janus House, Osney Mead, Oxford, OX2 0ES, and will be deposited with Oxfordshire County Museums Service in due course, under the following accession number: OXCMS: 2006.11



Reproduced from the Pathfinder 1:25,000 scale by permission of the Ordnance Survey on behalf of The Controller of Her Majesty's Stationery Office © Crown Copyright 1992. All rights reserved. Licence No. AL 10005569

Figure 1: Site location

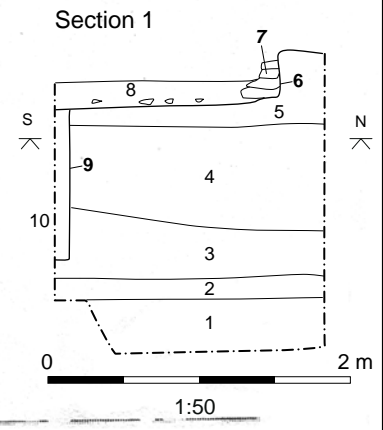
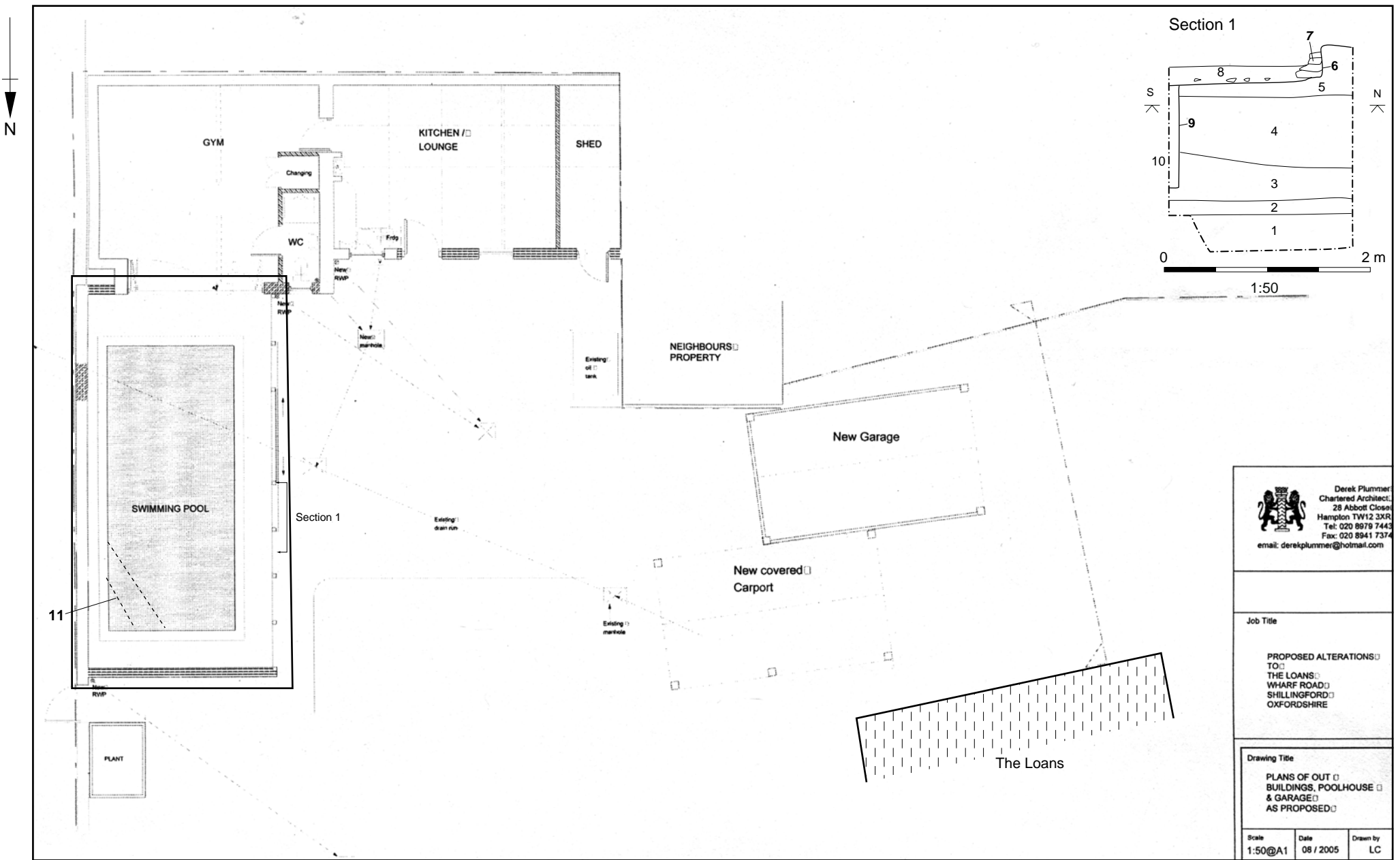

Derek Plummer
Chartered Architect,
28 Abbott Close
Hampton TW12 3XR
Tel: 020 8979 7443
Fax: 020 8941 7374
email: derekplummer@hotmail.com

Job Title

PROPOSED ALTERATIONS TO
THE LOANS
WHARF ROAD
SHILLINGFORD
OXFORDSHIRE

Drawing Title

PLANS OF OUT
BUILDINGS, POOLHOUSE
& GARAGE
AS PROPOSED

Scale 1:50@A1	Date 08 / 2005	Drawn by LC
------------------	-------------------	----------------

Figure 2: Plan of new swimming pool, location of section feature and section



**Head Office/Registered Office/
OA South**

Janus House
Osney Mead
Oxford OX2 0ES

t: +44 (0) 1865 263 800
f: +44 (0) 1865 793 496
e: info@oxfordarchaeology.com
w: <http://oxfordarchaeology.com>

OA North

Mill 3
Moor Lane
Lancaster LA1 1QD

t: +44 (0) 1524 541 000
f: +44 (0) 1524 848 606
e: [oanorth@oxfordarchaeology.com](mailto: oanorth@oxfordarchaeology.com)
w: <http://oxfordarchaeology.com>

OA East

15 Trafalgar Way
Bar Hill
Cambridgeshire
CB23 8SQ

t: +44 (0) 1223 850500
e: [oaeast@oxfordarchaeology.com](mailto: oaeast@oxfordarchaeology.com)
w: <http://oxfordarchaeology.com>



Director: Gill Hey, BA PhD FSA MCifA
*Oxford Archaeology Ltd is a
Private Limited Company, N^o: 1618597
and a Registered Charity, N^o: 285627*