

Site/Project Name: **Oxford, Iffley Church of St Mary the Virgin**

Site Code: OXIFMV 05

Site/Project Type: Watching Brief

Year(s): 2005

Accession Number: OXCMS: 2005.81

Record Group	Contents	Comments	Box/File Number
	<b>INTRODUCTION</b> Archaeological recording specification	3 sheets	Box 1 file 1
A	<b>REPORT</b> Watching Brief Report  OASIS form printout	see <a href="http://library.thehumanjourney.net/1745">http://library.thehumanjourney.net/1745</a> 3 sheets	Box 1 file 2
B	<b>PRIMARY CONTEXT DATA</b>  Watching brief record sheets Context checklist Context record sheets	5 sheets 1 sheet 4 sheets	Box 1 file 3
B	<b>CATALOGUE OF DRAWINGS</b>  Plan record sheet Section record sheet	1 sheet 1 sheet	Box 1 file 4
B	<b>PRIMARY DRAWINGS</b>  Plan Sections	1 A3 sheet 1 A4 sheet	Box 1 file 5
D	<b>CATALOGUE OF PHOTOGRAPHS</b>  Black and white photographic record sheet Colour photographic record sheet Digital photographic record sheet	2 sheets 1 sheet 1 sheet	Box 1 file 6

**PDF/A SCAN**

**FILMING INSTRUCTIONS**

Submitter OASouth

No. of copies: 2

**Headings**

**Site information**

Line 1: [OA South] County[Oxon] Parish:[Oxford]

Site[Iffley Church of St Mary the Virgin] Site code[OXIFMV 05]

Line 2: Excavators name[D Dodds]

Line 3:

**Classification of material**

**Tick if present**

Classification of material	Tick if present
Index to archive	<input checked="" type="checkbox"/>
Introduction	<input type="checkbox"/>
A:Final Report	<input type="checkbox"/>
A:Publication Report	<input type="checkbox"/>
B:Site Data – Text: Diary/Daybook/Fieldnotes	<input type="checkbox"/>
B: Site Data – Text: General Summaries	<input type="checkbox"/>
B: Site Data – Text: Primary Context Records	<input type="checkbox"/>
B: Site Data – Text: Synthesised Context Records	<input type="checkbox"/>
B: Site Data – Text: Survey Reports	<input type="checkbox"/>
B: Site Data – Text: Catalogue of Drawings	<input type="checkbox"/>
B: Site Data – Text: Primary Drawings	<input type="checkbox"/>
B: Site Data – Text: Synthesised Drawings	<input type="checkbox"/>
C: Finds Data – Text: Primary Finds Data	<input type="checkbox"/>
C: Finds Data – Text: Synthesised Finds Data	<input type="checkbox"/>
C: Finds Data – Text: Specialist Reports	<input type="checkbox"/>
C: Finds Data – Text: Box/Bag List	<input type="checkbox"/>
D: Catalogue of Photos/Slides/Videos/X--rays	<input type="checkbox"/>
E: Environmental/Ecofact Data: Primary Records	<input type="checkbox"/>
E: Environmental/Ecofact Data: Synthesised Records	<input type="checkbox"/>
E: Environmental/Ecofact Data: Specialist Reports	<input type="checkbox"/>
F: Documentary	<input type="checkbox"/>
F: Press and Publicity	<input type="checkbox"/>
G: Correspondence	<input type="checkbox"/>
H: Miscellaneous	<input type="checkbox"/>

CHURCH OF ST. MARY THE VIRGIN, IFFLEY  
OXFORDS

Box 1 FILE 1

INTRODUCTION

**PDF/A SCAN**

**FILMING INSTRUCTIONS**

Submitter OASouth

No. of copies: 2

**Headings**

**Site information**

Line 1: [OA South] County[Oxon] Parish:[Oxford]

Site[Iffley Church of St Mary the Virgin] Site code[OXIFMV 05]

Line 2: Excavators name[D Dodds]

Line 3:

**Classification of material**

**Tick if present**

Classification of material	Tick if present
Index to archive	
Introduction	<input checked="" type="checkbox"/>
A:Final Report	
A:Publication Report	
B:Site Data – Text: Diary/Daybook/Fieldnotes	
B: Site Data – Text: General Summaries	
B: Site Data – Text: Primary Context Records	
B: Site Data – Text: Synthesised Context Records	
B: Site Data – Text: Survey Reports	
B: Site Data – Text: Catalogue of Drawings	
B: Site Data – Text: Primary Drawings	
B: Site Data – Text: Synthesised Drawings	
C: Finds Data – Text: Primary Finds Data	
C: Finds Data – Text: Synthesised Finds Data	
C: Finds Data – Text: Specialist Reports	
C: Finds Data – Text: Box/Bag List	
D: Catalogue of Photos/Slides/Videos/X--rays	
E: Environmental/Ecofact Data: Primary Records	
E: Environmental/Ecofact Data: Synthesised Records	
E: Environmental/Ecofact Data: Specialist Reports	
F: Documentary	
F: Press and Publicity	
G: Correspondence	
H: Miscellaneous	

## **St Mary the Virgin Church, Iffley**

[Archdeaconry of Oxfordshire: Deanery of Cowley]

### **Archaeological Recording Specification**

#### **1. Summary of Specification**

- 1.1 This specification provides the outline for an archaeological contractor to provide a cost for the archaeological recording arising from the lowering and improvement of the existing perimeter drains at St Mary the Virgin Church, Iffley.
- 1.2 The aim of the programme of archaeological recording is to mitigate the impact of the proposed works on the fabric and buried archaeology of the church and its immediate vicinity.
- 1.2 The objectives of the archaeological recording will be as follows:
  - to determine the character of the fabric (above and below ground) in the vicinity of the new works
  - to signal, before work proceeds, the discovery of an archaeological find for which further action is required
  - to provide a report and ordered archive on the investigation.

#### **2. Background**

- 2.1 St Mary the Virgin Church, Iffley was built the Romanesque style in 1175-82, with nave, central tower and chancel. A further two bays were added to the chancel in the 13th century, in the Early English style. Unusually, the original high, narrow layout has been preserved. Some new windows were inserted in the 13th and 15th centuries and parapets added in the 17th century. Restoration work during the 19th century included the reinsertion of a round window in the west front. The south and west doorways have some fine Norman decoration, although the former door is blocked on the inside by the altar. The church is a Grade I Listed Building.
- 2.2 During the 13th century an anchorite, Annora, is believed to have lived for nine years in a cell on the south side of the church. The cell could have been of timber or stone construction and there may have been a window from it into the church. No evidence has yet been uncovered showing the position of this structure. Anchorites lived with their future coffin lid and were buried under the stone.

#### **3. Work Proposals and Potential Impact**

- 3.1 The existing perimeter drain is too shallow to prevent damp in the outer walls of the church, particularly at the west end. It is proposed to lower the existing channel and dig a new ground trench at the foot of the west facade. These works would have potential impacts as follows:
  - Exposure of the fabric and foundations of the church
  - Possible impact on remains of the anchorite's cell.

#### 4. **Archaeological Watching Brief and Recording**

4.1 The archaeological watching brief and recording will consist of the following main elements:

- Watching brief on the excavations to lower the existing perimeter channels, with particular emphasis on the south side
- Watching brief on ground-disturbance for the new ground channel at the west end
- Cleaning up and photographic recording of any significant finds.

4.2 The programme of archaeological work is intended to mitigate the impact of the proposed works on the fabric and buried archaeology of the church, and will only by agreement with the architect and English Heritage be extended beyond what is necessary to fulfil that aim.

4.4 A watching brief will be maintained on all phases of the groundworks.

4.5 An illustrated report on the programme of work will be produced.

#### 5. **Archaeological Recording**

##### 5.1 *Recording*

Archaeological features will be recorded in plan (1:20) and where appropriate in section (1:10), and plotted onto the digital base plan (1:50) supplied by the architects. Where appropriate B/W photographs and colour transparencies should be taken of major contexts such as walls, floors, burials or *in-situ* artefacts.

##### 5.2 *Finds*

Generally the preference will be to leave finds of minor significance *in-situ*, or have them re-buried in a position as near as possible to their place of origin. Other significant finds can, under authority of a faculty, be deposited with the appropriate museum.

##### 5.3 *Human remains*

5.3.1 Where early modern or medieval human remains are disturbed in the course of the work they should be treated with due care and regard to the sensitivities involved. The location of any charnel should be recorded and reserved for re-burial, if immediate re-interment is not possible. Burials of archaeological significance should also be left *in-situ* until examined by an appropriately qualified osteoarchaeologist, and only removed by the archaeologist if impacts are substantial. The architect and parish are to be kept fully informed. No human remains may be removed without the express permission of the Consistory Court.

5.3.2 Unless it is necessary to remove for assessment by a physical anthropologist, any human bones which are disturbed during the course of the excavation work for drainage trenches, etc. are to be carefully set aside out of sight of the public. Materials from each burial 'site' should be stored in separate containers and these containers should be stored, under lock and key within the church until completion of the excavation works when they should be handed to the Incumbent to direct the re-burial. Excavation for re-interment of bones is to be carried out by the archaeological contractor in a location agreed with the architect and Incumbent.

#### 5.4 *Assessment of further Study*

Where significant artefacts, environmental material or human burials are excavated they should be assessed for further analysis and an interim report submitted to the client and architect.

### 6. **Reporting**

#### 6.1 *Site Archive*

6.1.1 The site archive should consist of the following material: correspondence relating to fieldwork, context sheets, site drawings, finds and sampling records, photographic records, assessment reports, historical data. Records should be microfiched and deposited with the appropriate museum.

#### 6.2 *Report*

6.2.1 The report should include relevant historical information, appropriate plans and sections, context descriptions, a description of finds, an objective account of archaeological deposits, appropriate building interpretation and photography.

6.2.2 A draft report should be completed within one month of the finish of fieldwork and submitted to the Architect, and the Diocesan Adviser.

6.2.3 A final report should be completed within three months of the finish of fieldwork and four copies submitted to the Architect who will ensure that one is deposited with the Oxfordshire SMR.

#### 6.3 *Publication*

6.3.1.1 Any significant results should be published, and the archaeologist should at least submit a brief summary of work to the *South Midlands Archaeology* and to the Oxfordshire SMR.

### 7. **Monitoring and consultation**

7.1 Further details or variations in the specification, arising either before or during the works are to be agreed with the Diocesan Archaeological Adviser, who will monitor the work.

### 8. **Standards and Professional Guidelines**

8.1 In general, the standards and guidelines applied to sites within Oxfordshire shall apply.

J.T. Munby  
Oxford Diocesan Adviser

April 2005

CHURCH OF ST MARY THE VIRGIN, IFFLEY  
OX15MV05

BOX 1 FILE 2

A. FINAL REPORT



PDF/A SCAN

FILMING INSTRUCTIONS

Submitter OASouth

No. of copies: 2

Headings

Site information

Line 1: [OA South] County[Oxon] Parish:[Oxford]

Site[Iffley Church of St Mary the Virgin] Site code[OXIFMV 05]

Line 2: Excavators name[D Dodds]

Line 3:

Classification of material

Tick if present

Classification of material	Tick if present
Index to archive	
Introduction	
A:Final Report	<input checked="" type="checkbox"/>
A:Publication Report	
B:Site Data – Text: Diary/Daybook/Fieldnotes	
B: Site Data – Text: General Summaries	
B: Site Data – Text: Primary Context Records	
B: Site Data – Text: Synthesised Context Records	
B: Site Data – Text: Survey Reports	
B: Site Data – Text: Catalogue of Drawings	
B: Site Data – Text: Primary Drawings	
B: Site Data – Text: Synthesised Drawings	
C: Finds Data – Text: Primary Finds Data	
C: Finds Data – Text: Synthesised Finds Data	
C: Finds Data – Text: Specialist Reports	
C: Finds Data – Text: Box/Bag List	
D: Catalogue of Photos/Slides/Videos/X--rays	
E: Environmental/Ecofact Data: Primary Records	
E: Environmental/Ecofact Data: Synthesised Records	
E: Environmental/Ecofact Data: Specialist Reports	
F: Documentary	
F: Press and Publicity	
G: Correspondence	
H: Miscellaneous	

# OASIS DATA COLLECTION FORM: England

[List of Projects](#) | [Search Projects](#) | [New project](#) | [Change your details](#) | [HER coverage](#) | [Change country](#) | [Log out](#)

## Printable version

**OASIS ID: oxfordar1-60636**

### Project details

Project name	Church of St Mary the Virgin, Iffley
Short description of the project	In August 2008 Oxford Archaeology (OA) carried out an archaeological watching brief at Church of St Mary the Virgin, Iffley, Oxford, Oxfordshire (NGR SP 527 034). The work was commissioned by John Perryman Architects on behalf of the PCC in advance of new drainage around the walls of the church. The watching brief revealed no archaeological features or deposits within the new drainage trench.
Project dates	Start: 12-08-2005 End: 06-09-2005
Previous/future work	No / No
Any associated project reference codes	OXIFMV05 - Sitecode
Any associated project reference codes	OXCMS:2005.81 - Museum accession ID
Type of project	Recording project
Site status	Listed Building
Current Land use	Other 4 - Churchyard
Monument type	NORMAN CHURCH Medieval
Significant Finds	NONE None
Investigation type	'Watching Brief'
Prompt	Listed Building Consent

### Project location

Country	England
Site location	OXFORDSHIRE OXFORD OXFORD Church of St Mary the Virgin, Iffley, Oxford
Study area	43.00 Square metres
Site coordinates	SP 527 034 51.7263813093 -1.236908652920 51 43 34 N 001 14 12 W Point

**Project creators**

Name of Organisation	Oxford Archaeology
Project brief originator	The Office of Archdeaconry of Oxfordshire, Deanery of Cowley
Project design originator	Oxford Archaeology
Project director/manager	D. Dodds
Project supervisor	J Mumford

**Project archives**

Physical Archive Exists?	No
Digital Archive recipient	Oxford Archaeology
Digital Contents	'Stratigraphic'
Digital Media available	'Text'
Paper Archive recipient	Oxfordshire County Museum Service
Paper Archive ID	OXCMS:2005.81
Paper Contents	'Stratigraphic'
Paper Media available	'Context sheet', 'Photograph', 'Plan', 'Report', 'Section', 'Unpublished Text'

**Project bibliography 1.**

Publication type	Grey literature (unpublished document/manuscript)
Title	Church of St Mary the Virgin, Iffley, Oxford, Archaeological Watching Brief
Author(s)/Editor(s)	J.Mumford
Date	2005
Issuer or publisher	Oxford Archaeology South
Place of issue or publication	Oxford
Description	Spiral bound client report
Entered by	Matthew Guy (matthew.guy@thehumanjourney.net)
Entered on	11 June 2009

# OASIS:

Please e-mail English Heritage for OASIS help and advice

© ADS 1996-2006 Created by Jo Gilham and Jen Mitcham, email Last modified Friday 3 February 2006

Cite only: /dl/export/home/web/oasis/form/print.cfm for this page

CHURCH OF ST MARY THE VIRGIN, IFFLEY  
OX1FMV 05

BOX 1 FILE 3

B PRIMARY CONTEXT RECORDS

**PDF/A SCAN**

**FILMING INSTRUCTIONS**

Submitter OASouth

No. of copies: 2

**Headings**

**Site information**

Line 1: [OA South] County[Oxon] Parish:[Oxford]

Site[Iffley Church of St Mary the Virgin] Site code[OXIFMV 05]

Line 2: Excavators name[D Dodds]

Line 3:

**Classification of material**

**Tick if present**

Index to archive	
Introduction	
A:Final Report	
A:Publication Report	
B:Site Data – Text: Diary/Daybook/Fieldnotes	
B: Site Data – Text: General Summaries	
B: Site Data – Text: Primary Context Records	✓
B: Site Data – Text: Synthesised Context Records	
B: Site Data – Text: Survey Reports	
B: Site Data – Text: Catalogue of Drawings	
B: Site Data – Text: Primary Drawings	
B: Site Data – Text: Synthesised Drawings	
C: Finds Data – Text: Primary Finds Data	
C: Finds Data – Text: Synthesised Finds Data	
C: Finds Data – Text: Specialist Reports	
C: Finds Data – Text: Box/Bag List	
D: Catalogue of Photos/Slides/Videos/X--rays	
E: Environmental/Ecofact Data: Primary Records	
E: Environmental/Ecofact Data: Synthesised Records	
E: Environmental/Ecofact Data: Specialist Reports	
F: Documentary	
F: Press and Publicity	
G: Correspondence	
H: Miscellaneous	



# WATCHING BRIEF RECORD

SITE CODE *OX1FMU 05*

SITE NAME *St Mary Virgin / FFLEY*

DATE *12/8/05*

NGR

County

Start Time

*1 PM*

*OXON*

Finish Time

*1.45 PM*

Milage

Previous Visit

Visit By

*D. DODD*

Type of construction work

*DRAIN Digging Around PERIMETER of Church BUILDING*

Contacts made

*I. P. COX - CONTRACTORS*

Archaeology present?

Yes:

No:

*PHOTOS (DIGI) TAKEN*

Undated:

Other:

COMMENTS

*CONTRACTORS I P COX SITE SET-UP ONLY. THEY ARE INTENDING TO REMOVE SHINGLE AND REMOVE MODERN PIPE. SUGGEST RETURN VISIT FOR ON 16th OR 17th AUGUST.*

Records?



# WATCHING BRIEF RECORD

SITE CODE **OX1FMV05**

SITE NAME **ST MARY'S THE VIRGIN, IFFLEY, OXFORD**

DATE **23/8/05.**

NGR

County **OXON**

Start Time **3.00**

Finish Time **3.15**

Milage

Previous Visit

Visit By **J MUMFORD**

Type of construction work

**NEW FRENCH DRAIN.**

Contacts made

Archaeology present?

Yes:

No:

Undated:

Other:

## COMMENTS

**HAD CONSIDERED WORKING AROUND CHURCH, ARE ~~NOT~~ NOT GOING BELOW DEPTH OF OLD PIPE, BUT REMOVING IT AND REPLACING WITH NEW CERAMIC PIPE**

Records?



Oxford Archaeological Unit	<b>WATCHING BRIEF RECORD</b>		
SITE CODE OXIFM05	SITE NAME St Mary the Virgin Church, Ippley		DATE 25/8/05
NGR	County <p style="text-align: center;">OXON</p>	Start Time	3.00
		Finish Time	4.00
Milage	Previous Visit	Visit By <p style="text-align: center;">J. Mumford.</p>	
Type of construction work <p style="text-align: center;">NEW DRAINAGE</p>			
Contacts made			
Archaeology present?			
Yes:			
No:			
Undated:			
Other:			
<b>COMMENTS</b>			
<p>WORK CLEARING OUT 0.35m WIDE x 0.4m DEEP TRENCH AROUND CHURCH. VERTICAL SIDES &amp; FLAT BASE FILLED WITH LOOSE SHINGLE AND PEA GRADE CONCR. CUT THROUGH REDDISH BROWN SILTY SAND LOAM OF OLD CEMETERY SOIL WITH 0.1m THICK TOPSOIL/TWIG</p> <p>NEW PIPE LAID AT LEVEL OF OLD PIPE OR HIGHER IN PLACES, NO EXCAVATION BEYOND DEPTH OF OLD FRENCH DRAIN.</p>			
Records?			



# WATCHING BRIEF RECORD

SITE CODE OXIFMV 05

SITE NAME ST MARY VIRGIN, IFFLEY

DATE 31st August 05

NGR

County

Start Time

14:00

Finish Time

Milage

Previous Visit

5m.

Visit By

D. DEDDS

Type of construction work

PERIMETER DRAINAGE DIGGING

Contacts made

Archaeology present? Y

Yes: ONE BROKEN DISARTICULATED SKULL - CHARNEL. POSITION RECORDED

No:

Undated:

Other:

## COMMENTS

Skull DISCOVERED N SIDE OF TOWER 1.0m N OF TOWER WALL + 1.5m EAST OF EXTERNAL TOWER STEPS. Skull FOUND IN MIXED GRAVEYARD SOIL ON NORTH SIDE OF EXISTING DRAINAGE CUT. BONE NOT RETAINED BUT LEFT FOR RE-BURIAL.

Records?



Oxford Archaeology

# WATCHING BRIEF RECORD

SITE CODE **OX1FMV05**

SITE NAME **Iffley Church, Oxon**

DATE **6/9/05**

NGR

County

Start Time

**3 pm**

**Oxfordshire**

Finish Time

**4 pm**

Milage

Previous Visit

Visit By

**C. Jowett**

Type of construction work

**Drainage channels**

Contacts made

**Site foreman.**

Archaeology present?

Yes:



**Human Remains**

No:

Undated:

Other:

## COMMENTS

**1/2 of South side of drainage had been dug to max depth - other half isn't being taken down any more as they have required fall for drainage pipe**

**Tomb lies in way of pipe - no remains found + no grave cut visible (although site had been disturbed by trample)**

**2 Sections drawn - 1 at E end, other where channel found towards W end.**

**No more digging expected - will call OA if they are going to.**

Records?

**2 x Sections 4 x context sheets.**





# CONTEXT RECORD

Context No. 100

SITE OxIFMV 05

ADDITIONAL SHEETS:

TYPE Deposit

Trench

Context Type: Deposit / Cut / Structure

Check Lists:

Site sub-div

Overlain by: /

DEPOSIT:

Structure No.

Abutted by:

1. compaction 2. colour  
3. composition 4. inclusion  
5. thickness 6. extent  
7. comments 8. method & conditions

Plan No.

Cut by:

Contractors plan

Filled by:

Section No.

Same as:

CUT:

1

Part of:

1. shape in plan  
2. base/sides/top profile  
3. dimension and depth  
4. sketch 5. truncation 6. fill nos 7. other comments

Co-Ordinates

Consists of:

Overlies: (101)

Level

Butts:

MASONRY:

Slide No.

Cuts:

1. materials 2. size of bricks etc  
3. finish of stones 4. coursing/bond 5. form 6. faces  
7. bond 8. dimensions as found  
9. other comments

Neg No.

Fill of:

Matrix location

Relationships uncertain

Description (See check lists):

STRATIGRAPHIC MATRIX

Topsoil  
light grey brown silty loam  
loose + friable with frequent  
chalk flecks + occ small s/rounded pebbles.  
- humic (covered by grass)  
Thickness =

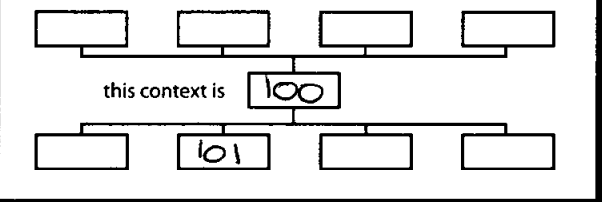

Interpretation/Discussion

Topsoil

Finds (tick): None [] Pot [] Bone [] Flint [] Stone [] Burnt stone [] Glass [] Metal []  
CBM [] Wood [] Leather []

Small Finds /

Recorder CS

Samples /

Date 6/9/05

Building Materials /

Initials



# CONTEXT RECORD

Context No.

101

SITE OX1FMV 05

ADDITIONAL SHEETS:

TYPE *Layer*

Trench

Context Type: Deposit / Cut / Structure

Check Lists:

Site sub-div

Overlain by: (100)

DEPOSIT:

Structure No.

Abutted by:

1. compaction
2. colour
3. composition
4. inclusion
5. thickness
6. extent
7. comments
8. method & conditions

Plan No.

*contractors plan*

Cut by:

Filled by:

CUT:

Section No.

1

Same as:

Part of:

1. shape in plan
2. base/sides/top profile
3. dimension and depth
4. sketch
5. truncation
6. fill nos
7. other comments

Co-Ordinates

Consists of:

Overlies:

Level

Butts:

MASONRY:

Slide No.

Cuts:

1. materials
2. size of bricks etc
3. finish of stones
4. coursing/bond
5. form
6. faces
7. bond
8. dimensions as found
9. other comments

Neg No.

Fill of:

Matrix location

Relationships uncertain

Description (See check lists):

*Light grey brown clay gravel.  
Hard + cohesive with frag  
Chalk pieces (<0.03m)*

STRATIGRAPHIC MATRIX

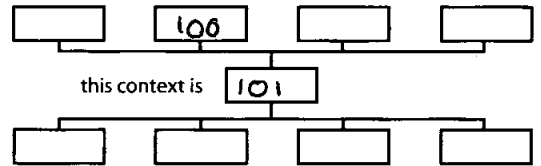

Thickness =

Interpretation/Discussion

*Subsoil which appeared to have been disturbed but  
not recently*

**Finds** (tick): None [] Pot [] Bone [] Flint [] Stone [] Burnt stone [] Glass [] Metal [] CBM [] Wood [] Leather []

Small Finds

Recorder *CS*

Samples

Date *6/9/05*

Building Materials

Initials



# CONTEXT RECORD

Context No.

102

SITE OX1FMV05

ADDITIONAL SHEETS:

TYPE Layer

Trench

Context Type: Deposit / Cut / Structure

Check Lists:

Site sub-div

Overlain by: /

DEPOSIT:

- 1. compaction
- 2. colour
- 3. composition
- 4. inclusion
- 5. thickness
- 6. extent
- 7. comments
- 8. method & conditions

Structure No.

Abutted by:

Plan No.

Cut by:

Contractors Plan

Filled by:

Section No.

Same as: (100)

CUT:

- 1. shape in plan
- 2. base/sides/top profile
- 3. dimension and depth
- 4. sketch
- 5. truncation
- 6. fill nos
- 7. other comments

2

Part of:

Co-Ordinates

Consists of:

Overlies: (103)

Level

Butts:

MASONRY:

- 1. materials
- 2. size of bricks etc
- 3. finish of stones
- 4. coursing/bond
- 5. form
- 6. faces
- 7. bond
- 8. dimensions as found
- 9. other comments

Slide No.

Cuts:

Neg No.

Fill of:

Matrix location

Relationships uncertain

Description (See check lists):

STRATIGRAPHIC MATRIX

Dark brown silty clay, very organic/humic soft + loose with occasional small s/rounded pebbles.

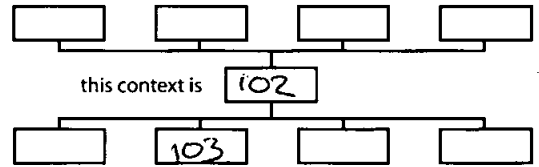

Interpretation/Discussion

Topsoil / turf - very organic (due to decomposed vegetation + leaf litter?)

Finds (tick): None [] Pot [] Bone [] Flint [] Stone [] Burnt stone [] Glass [] Metal [] CBM [] Wood [] Leather []

△ Small Finds /

Recorder OS

◇ Samples /

Date 6/9/05

△ Building Materials /

Initials



# CONTEXT RECORD

Context No. *Handwritten: None Fill?*

SITE *OXIFMU 05*

ADDITIONAL SHEETS:

TYPE *103*

Trench

Context Type: Deposit / Cut / Structure

Check Lists:

Site sub-div

Overlain by: *(102)*

DEPOSIT:

Structure No.

Abutted by:

- 1. compaction 2. colour
- 3. composition 4. inclusion
- 5. thickness 6. extent
- 7. comments 8. method & conditions

Plan No.

*contractors plan*

Cut by:

Filled by:

Section No.

*2*

Same as: *(101) ?*

Part of:

CUT:

- 1. shape in plan
- 2. base/sides/top profile
- 3. dimension and depth
- 4. sketch 5. truncation 6. fill nos 7. other comments

Co-Ordinates

Consists of:

Overlies:

Level

Butts:

MASONRY:

Slide No.

Cuts:

- 1. materials 2. size of bricks etc
- 3. finish of stones 4. coursing/bond 5. form 6. faces
- 7. bond 8. dimensions as found 9. other comments

Neg No.

Fill of:

Matrix location

Relationships uncertain

Description (See check lists):

*Mid grey brown silty clay, Hard & compact with frequent gravel pieces*

STRATIGRAPHIC MATRIX

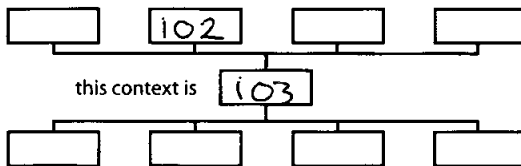

Thickness =

Interpretation/Discussion

*Subsoil containing human remains (charnel)  
No other finds / grave cuts / features.*

*Human Remains left on site to be reburied by contractors*

Finds (tick): None [ ] Pot [ ] Bone [4] Flint [ ] Stone [ ] Burnt stone [ ] Glass [ ] Metal [ ]  
CBM [ ] Wood [ ] Leather [ ]

Small Finds

Recorder *CS*

Samples

Date *6/9/05*

Building Materials

Initials



CHURCH OF ST MARY THE VIRGIN, IFFLEY  
OX1FMV 05



Box 1 FILE 4

B CATALOGUE OF DRAWINGS

PDF/A SCAN

FILMING INSTRUCTIONS

Submitter OASouth

No. of copies: 2

Headings

Site information

Line 1: [OA South] County[Oxon] Parish:[Oxford]

Site[Iffley Church of St Mary the Virgin] Site code[OXIFMV 05]

Line 2: Excavators name[D Dodds]

Line 3:

Classification of material

Tick if present

Index to archive	
Introduction	
A:Final Report	
A:Publication Report	
B:Site Data – Text: Diary/Daybook/Fieldnotes	
B: Site Data – Text: General Summaries	
B: Site Data – Text: Primary Context Records	
B: Site Data – Text: Synthesised Context Records	
B: Site Data – Text: Survey Reports	
B: Site Data – Text: Catalogue of Drawings	<input checked="" type="checkbox"/>
B: Site Data – Text: Primary Drawings	
B: Site Data – Text: Synthesised Drawings	
C: Finds Data – Text: Primary Finds Data	
C: Finds Data – Text: Synthesised Finds Data	
C: Finds Data – Text: Specialist Reports	
C: Finds Data – Text: Box/Bag List	
D: Catalogue of Photos/Slides/Videos/X--rays	
E: Environmental/Ecofact Data: Primary Records	
E: Environmental/Ecofact Data: Synthesised Records	
E: Environmental/Ecofact Data: Specialist Reports	
F: Documentary	
F: Press and Publicity	
G: Correspondence	
H: Miscellaneous	





CHURCH OF ST MARY THE VIRGIN, IFFLEY  
OX15MV 05

Box 1 FILES

B PRIMARY DRAWINGS

**PDF/A SCAN**

**FILMING INSTRUCTIONS**

Submitter OASouth

No. of copies: 2

Headings

Site information

Line 1: [OA South] County[Oxon] Parish:[Oxford]

Site[Iffley Church of St Mary the Virgin] Site code[OXIFMV 05]

Line 2: Excavators name[D Dodds]

Line 3:

Classification of material

Tick if present

Classification of material	Tick if present
Index to archive	
Introduction	
A:Final Report	
A:Publication Report	
B:Site Data – Text: Diary/Daybook/Fieldnotes	
B: Site Data – Text: General Summaries	
B: Site Data – Text: Primary Context Records	
B: Site Data – Text: Synthesised Context Records	
B: Site Data – Text: Survey Reports	
B: Site Data – Text: Catalogue of Drawings	
B: Site Data – Text: Primary Drawings	<input checked="" type="checkbox"/>
B: Site Data – Text: Synthesised Drawings	
C: Finds Data – Text: Primary Finds Data	
C: Finds Data – Text: Synthesised Finds Data	
C: Finds Data – Text: Specialist Reports	
C: Finds Data – Text: Box/Bag List	
D: Catalogue of Photos/Slides/Videos/X--rays	
E: Environmental/Ecofact Data: Primary Records	
E: Environmental/Ecofact Data: Synthesised Records	
E: Environmental/Ecofact Data: Specialist Reports	
F: Documentary	
F: Press and Publicity	
G: Correspondence	
H: Miscellaneous	

OX/IFMV 05  
Plan 1  
Scale 1:100

4/2/05

- Chambers at 1 & 4: see also dwg D5
- i) the existing drainage - cemented in - is retained in these chambers.
  - ii) water test outfall drainage from these chambers to ensure satisfactory discharge & soakage.
  - iii) existing downpipes into both chambers are directly jointed/no access. See dwgs D4, 5 & 6 for rectifying this.

- Generally to existing drainage & trenches to the East of Chambers 1 & 4:
- i) remove & bag backfill material (gravel/pebbles/chippings), for possible reuse or if not used, cart away.
  - ii) lift & remove all existing drainage pipes & runs, except set aside 2<sup>nd</sup> existing trapped silt gulleys for re-installation: see dwg S1
  - iii) provide provisional diversion of rainwater from rainwater downpipes (retained) to ensure water is discharged min 5m away from Church walls.
  - iv) retain existing larch batten & peg edging strip to protect the grass edge during the works - see dwg D6 for new batten edging.
  - v) 'reduce' existing trenches to new levels shown on the drawing & cut new 'trench extensions' as shown on this drawing.

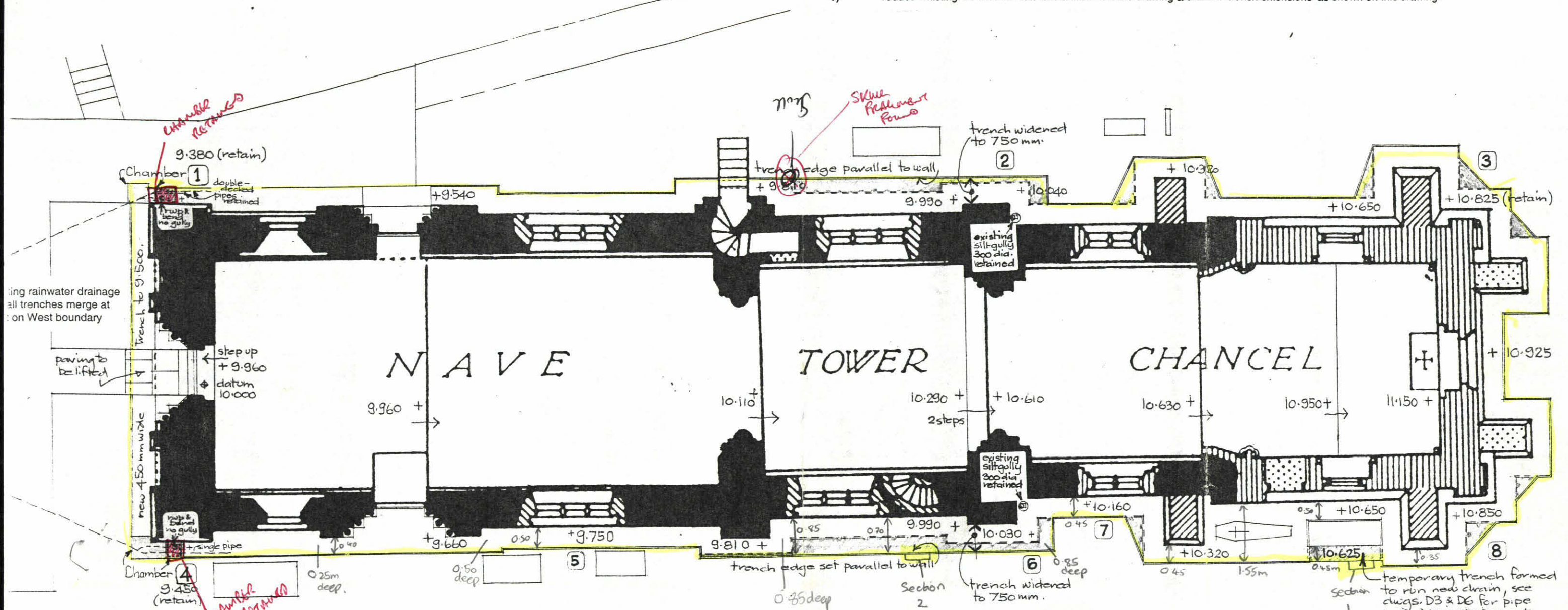

ing rainwater drainage  
all trenches merge at  
on West boundary

step up  
+ 9.960  
datum  
10.000

- At the West Facade as shown on this drawing:
- i) lift & set aside paving slabs to the main W. door entrance path as shown & set aside for re-installation.
  - ii) excavate a 450mm wide trench to reduce level at 9.500 (i.e. approx. 300mm deep) to the complete W. elevations' width.
  - iii) install a new larch batten & post edging strip to protect the grass edge.

For backfill/re-instatement see dwg D6.

**Legend:**  
line of original trench dotted  
shaded area dug out to adjacent trench bottom level.  
new larch strip & peg grass edging batten.  
sprayed extension to trench.

Location N°	Ground level: Grass bank	Ground level: Chippings	RW Drainage (upper pipe invert)	Land Drainage (lower pipe invert)	New trench bottom	Comments on trench bottom
1	9.780	9.760	9.500	9.400	9.380	Remains as existing
2	11.030	10.630	10.470	10.050	10.040	In ballast bottom not found
3	11.980	11.230	-	10.835	10.825	Remains as existing
4	9.840	9.820	9.470	9.460	9.450	Remains as existing
5	-	10.330	10.170	9.760	9.750	Natural ground
6	-	10.670	10.510	10.040	10.030	Natural ground
7	-	10.760	-	10.170	10.160	Natural ground
8	11.930	11.330	-	10.860	10.850	Natural ground

**DRAINAGE TRENCH: EXISTING** but take to new levels as shown.  
for existing trench levels see plan drawing S1

date JAN. '05	job no D416	project: IFFLEY: ST MARY the VIRGIN PERIMETER DRAINAGE SCHEME.
drawn J.P.	drg no D1	JOHN PERRYMAN ARCHITECTS 4 MIDDLE WAY, SUMMERTOWN, OXFORD. OX2 7LH. tel: (01865) 54345
scale 1:100		

# IFFley Church

## OX15MV 05

Section 1

1:20 CS 6/9/05.  
N Facing sect.

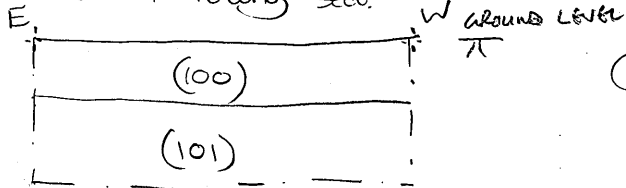

(100) topsoil  
light grey brown silty loam,  
loose + friable with freq chalk  
flecks

(101) light grey brown clay grit  
hard + cohesive, freq chalk  
pieces.

Section 2

N facing section of bench  
where human remains were discovered.

1:20 CS 6/9/05.

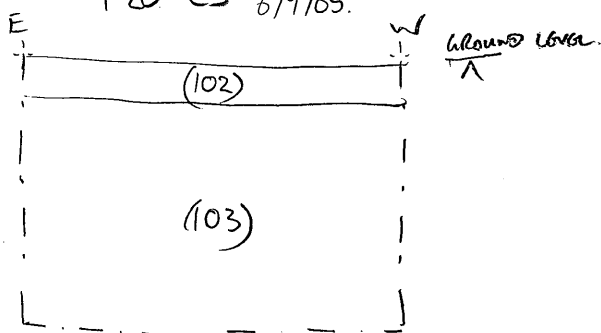

(102) dark brown silty clay - very  
organic, soft + loose  
cc small s/rounded pebbles.

(103) Mid grey brown <sup>silty</sup> clay ~~gravel~~  
hard + compact w/ freq gravel  
contained channel x 1/2 bag  
10 litres



CHURCH OF ST MARY THE VIRGIN, IFFLEY  
OX11 1MV 05

BOX 1 FILE 6

D CATALOGUE OF PHOTOGRAPHS.

**PDF/A SCAN**

**FILMING INSTRUCTIONS**

Submitter OASouth

No. of copies: 2

**Headings**

**Site information**

Line 1: [OA South] County[Oxon] Parish:[Oxford]

Site[Iffley Church of St Mary the Virgin] Site code[OXIFMV 05]

Line 2: Excavators name[D Dodds]

Line 3:

**Classification of material**

**Tick if present**

Index to archive	
Introduction	
A:Final Report	
A:Publication Report	
B:Site Data – Text: Diary/Daybook/Fieldnotes	
B: Site Data – Text: General Summaries	
B: Site Data – Text: Primary Context Records	
B: Site Data – Text: Synthesised Context Records	
B: Site Data – Text: Survey Reports	
B: Site Data – Text: Catalogue of Drawings	
B: Site Data – Text: Primary Drawings	
B: Site Data – Text: Synthesised Drawings	
C: Finds Data – Text: Primary Finds Data	
C: Finds Data – Text: Synthesised Finds Data	
C: Finds Data – Text: Specialist Reports	
C: Finds Data – Text: Box/Bag List	
D: Catalogue of Photos/Slides/Videos/X--rays	<input checked="" type="checkbox"/>
E: Environmental/Ecofact Data: Primary Records	
E: Environmental/Ecofact Data: Synthesised Records	
E: Environmental/Ecofact Data: Specialist Reports	
F: Documentary	
F: Press and Publicity	
G: Correspondence	
H: Miscellaneous	



# PHOTOGRAPHIC RECORD SHEET

SITE CODE **OXIFMV05**

SITE NAME **Ifley Church, Oxon**

FILM NO. **1**

Camera number

Lens number

Black & white / colour

Date	Negative number	View	Context(s)	Initials
	0			
6/9/05	1	—	ID SHOT	CS
	2	S	Section 1	
	3	↓	↓	
	4	↓	↓	
	5	S	Section 2 (Awkward angle to take picture at - apologies!)	
	6	↓	↓	
	7	↓	↓	
	8	W	General shots of gravestones	
	9	↓	↓	
	10	↓	↓	
	11	E		
	12	↓		
	13	↓		
	14	N		
	15	↓		
	16	↓		
	17	E		
	18	↓		
	19	↓		
	20	E	View <sup>along</sup> north side	
	21	W	view along north side	
	22	W	view along north side	
	23	E	" " " "	
	24	E	" " " "	
	25			
	26			
	27			
	28			
	29			
	30			
	31			
	32			
	33			
	34			
	35			
	36			
	37			



# PHOTOGRAPHIC RECORD SHEET

SITE CODE **OXIFMVOS**

SITE NAME **St MARY'S THE VIRGIN, IFFLEY**

FILM NO. **2**

Camera number

Lens number

Black & white / colour

Date	Negative number	View	Context(s)	Initials
	0			
	1		1 D SHOT	
	2	→E	VIEW OF TRENCH ALONG NORTH SIDE OF CHURCH	
	3	→W	" " " " " "	
	4	→W	" " " " " "	
	5	→E	" " " " " "	
	6	→E	" " " " " "	
	7			
	8			
	9			
	10			
	11			
	12			
	13			
	14			
	15			
	16			
	17			
	18			
	19			
	20			
	21			
	22			
	23			
	24			
	25			
	26			
	27			
	28			
	29			
	30			
	31			
	32			
	33			
	34			
	35			
	36			
	37			



# PHOTOGRAPHIC RECORD SHEET

SITE CODE *OC21AN05*

SITE NAME *Iffley, Church of St Mary*

FILM NO. *1*

Camera number

Lens number

Black & white / colour

Date	Negative number	View	Context(s)	Initials
	<i>0</i>			
<i>6/9/05</i>	<i>1</i>		<i>ID shot</i>	<i>CJ</i>
	<i>2</i>	<i>S</i>	<i>Section 1</i>	↓
	<i>3</i>	<i>"</i>	<i>"</i>	
	<i>4</i>	<i>"</i>	<i>"</i>	
	<i>5</i>	<i>S</i>	<i>Section 2</i>	
	<i>6</i>	<i>"</i>	<i>"</i>	
	<i>7</i>	<i>"</i>	<i>"</i>	
	<i>8</i>	<i>W</i>	<i>General shot</i>	
	<i>9</i>	<i>"</i>	<i>"</i>	
	<i>10</i>	<i>"</i>	<i>"</i>	
	<i>11</i>	<i>"</i>	<i>"</i>	
	<i>12</i>	<i>"</i>	<i>"</i>	
	<i>13</i>	<i>"</i>	<i>"</i>	
	<i>14</i>	<i>"</i>	<i>"</i>	
	<i>15</i>	<i>"</i>	<i>"</i>	
	<i>16</i>	<i>"</i>	<i>"</i>	
	<i>17</i>	<i>"</i>	<i>"</i>	
	<i>18</i>	<i>"</i>	<i>"</i>	
	<i>19</i>	<i>"</i>	<i>"</i>	
	<i>20</i>	<i>E</i>	<i>View along North Side</i>	
	<i>21</i>	<i>W</i>	<i>"</i>	
	<i>22</i>	<i>W</i>	<i>"</i>	
	<i>23</i>	<i>E</i>	<i>"</i>	
	<i>24</i>	<i>E</i>	<i>"</i>	
	<i>25</i>			
	<i>26</i>			
	<i>27</i>			
	<i>28</i>			
	<i>29</i>			
	<i>30</i>			
	<i>31</i>			
	<i>32</i>			
	<i>33</i>			
	<i>34</i>			
	<i>35</i>			
	<i>36</i>			
	<i>37</i>			

