

Trophy Gate Trench Hampton Court Palace

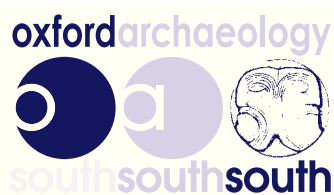

Archaeological Watching Brief Report



May 2012

Client: Historic Royal Palaces

Issue No: 1

OA Job No: 5302

NGR: TQ 15470 68589



Client Name: Historic Royal Palaces
Client Ref No: N/A
Document Title: Trophy Gate Trench, Hampton Court Palace
Document Type: Archaeological Watching Brief Report
Issue/Version Number: 1
Grid Reference: TQ 1547 6859
Planning Reference: N/A
Invoice Code: HCP89WB
OA Job Number: 5302
Site Code: HCP89
Receiving Museum: Historic Royal Palaces
Museum Accession No.: HCP089
Event No.: N/A

Issue	Prepared by	Checked by	Approved by	Signature
1	Paul Leader Assistant Supervisor	Ben Ford MIFA Senior Project Manager	(name) (position)	

Document File Location: Projects on server1:\HCP89 Trophy Gate Trench
Graphics File Location: Serer10:/oaupubs1_AtoH*HCP89*HCP89WB*Trophy Gate Trench, Hampton Court
Palace*jc*AndGS
Illustrated by: Georgina Slater

Disclaimer:

This document has been prepared for the titled project or named part thereof and should not be relied upon or used for any other project without an independent check being carried out as to its suitability and prior written authority of Oxford Archaeology being obtained. Oxford Archaeology accepts no responsibility or liability for the consequences of this document being used for a purpose other than the purposes for which it was commissioned. Any person/party using or relying on the document for such other purposes agrees, and will by such use or reliance be taken to confirm their agreement to indemnify Oxford Archaeology for all loss or damage resulting there from. Oxford Archaeology accepts no responsibility or liability for this document to any party other than the person/party by whom it was commissioned.

© Oxford Archaeological Unit Ltd 2012

Janus House

Osney Mead

Oxford OX2 0ES

t: +44 (0) 1865 263800

e: oasouth@thehumanjourney.net

f: +44 (0) 1865 793496

w: oasouth.thehumanjourney.net

Oxford Archaeological Unit Limited is a Registered Charity No: 285627



Trophy Gate Trench, Hampton Court Palace

Archaeological Watching Brief Report

Written by Paul Leader.

Illustrated by Georgina Slater

Table of Contents

Summary.....	2
1 Introduction.....	2
1.1 Scope of work.....	2
1.2 Location, geology and topography.....	2
1.3 Archaeological and historical background.....	2
2 Project Aims and Methodology.....	2
2.1 Aims.....	2
2.2 Methodology.....	2
3 Results.....	3
3.1 Description of deposits.....	3
3.2 Finds.....	3
4 Discussion and conclusions.....	3
Appendix A. Bibliography and references.....	4
Appendix B. Summary of Site Details.....	5

List of Figures

Fig. 1 Site location

Fig. 2 Trench Location



Summary

On the 12th and 13th March 2012, Oxford Archaeology (OA) carried out an Archaeological Watching Brief at Trophy Gate, Hampton Court Palace. A single trench measuring 20m NE-SW, 12.5m NW-SE, 0.45m wide and 0.4m deep was excavated across the main access road to the south-east of the Trophy Gate Entrance. The work was commissioned by Historic Royal Palaces (HRP), in advance of the installation of new services. The Watching Brief only revealed modern tarmac and associated levelling.

1 INTRODUCTION

1.1 Scope of work

- 1.1.1 Oxford Archaeology (OA) were commissioned by Historic Royal Palaces to undertake an Archaeological Watching Brief during the excavation of a service trench at the Trophy Gate, Hampton Court Palace, near Hampton, Surrey. The Site is centred on National Grid Reference TQ 1547 6859 (Fig. 1).
- 1.1.2 The works which took place on 12th and 13th March 2012, consisted of the excavation of single trench measuring 20m NE-SW, 12.5m NW-SE, 0.45m wide and 0.4m deep c. 6m across the main access road to the south-east of the Trophy Gate Entrance (Fig. 2).

1.2 Geology and topography

- 1.2.1 The Site is situated on the First Terrace Drift Geology in the flood plain of the River Thames, which overlies London Clay.
- 1.2.2 The Site is relatively level and lies at a height of c 9.49 m above OD.

1.3 Archaeological and historical background

- 1.3.1 Hampton Court Palace is a Scheduled Ancient Monument (Surrey No. 83) of outstanding national importance. The wider historical background to the Palace has been well documented and is not repeated here.

2 PROJECT AIMS AND METHODOLOGY

2.1 Aims

- 2.1.1 To identify and record the presence/absence, extent, condition, quality and date of archaeological remains in the areas affected by the groundworks.
- 2.1.2 To make available the results of the archaeological investigation.

2.2 Methodology

- 2.2.1 The works involved the mechanical excavation of a trench through the existing tarmac surface and the associated make-up, immediately to the south-east of the Trophy Gate (Fig 2). The works were overseen by an attending archaeologist.
- 2.2.2 The trenches were planned at a scale of 1:250. A general photographic record of the work was made. Recording followed procedures detailed in the *OAU Fieldwork Manual* (ed. D Wilkinson, 1992).



3 RESULTS

3.1 Description of deposits

3.1.1 The only deposits encountered were the modern tarmac driveway surface and the sandy, gravel associated make-up beneath. This showed evidence of previous disturbance from other services.

3.2 Finds

3.2.1 No finds were encountered.

4 DISCUSSION AND CONCLUSIONS

4.1.1 Due to the low impact of the works limited archaeological conclusions can be drawn. What has been demonstrated is that at least part of the tarmac driveway has been excavated previously with the laying of modern make up and tarmac deposits.



APPENDIX A. BIBLIOGRAPHY AND REFERENCES

OAU, 1992. *Fieldwork Manual* (ed. D Wilkinson).



APPENDIX B. SUMMARY OF SITE DETAILS

Site name:	Trophy Gate Trench, Hampton Court Palace
Site code:	HCP89
Grid reference:	Centred at NGR TQ 1547 6859
Type of watching brief:	Service trench
Date and duration of project:	12 th and 13 th March 2012
Area of site:	Service trench measured 20m NE-SW, 12.5m NW-SE, 0.45m wide and 0.4m deep c. 6m to the south east of the Trophy Gate Entrance
Summary of results:	Only the modern tarmac and associated make-up was encountered
Location of archive:	The archive is currently held at OA, Janus House, Osney Mead, Oxford, OX2 0ES, and will be deposited with Historic Royal Palaces at Hampton Court Palace, Surrey, KT8 9AU in due course.

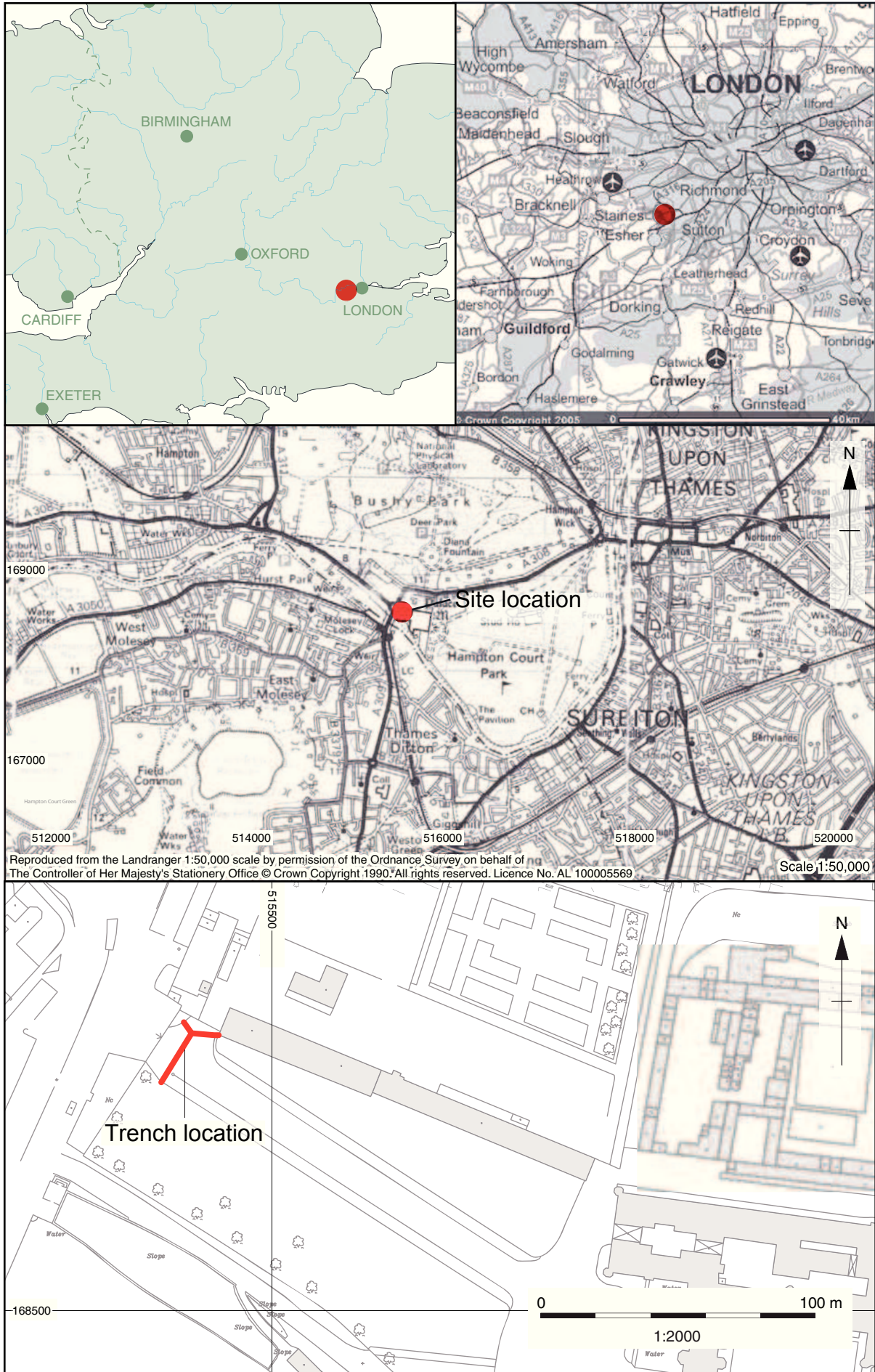
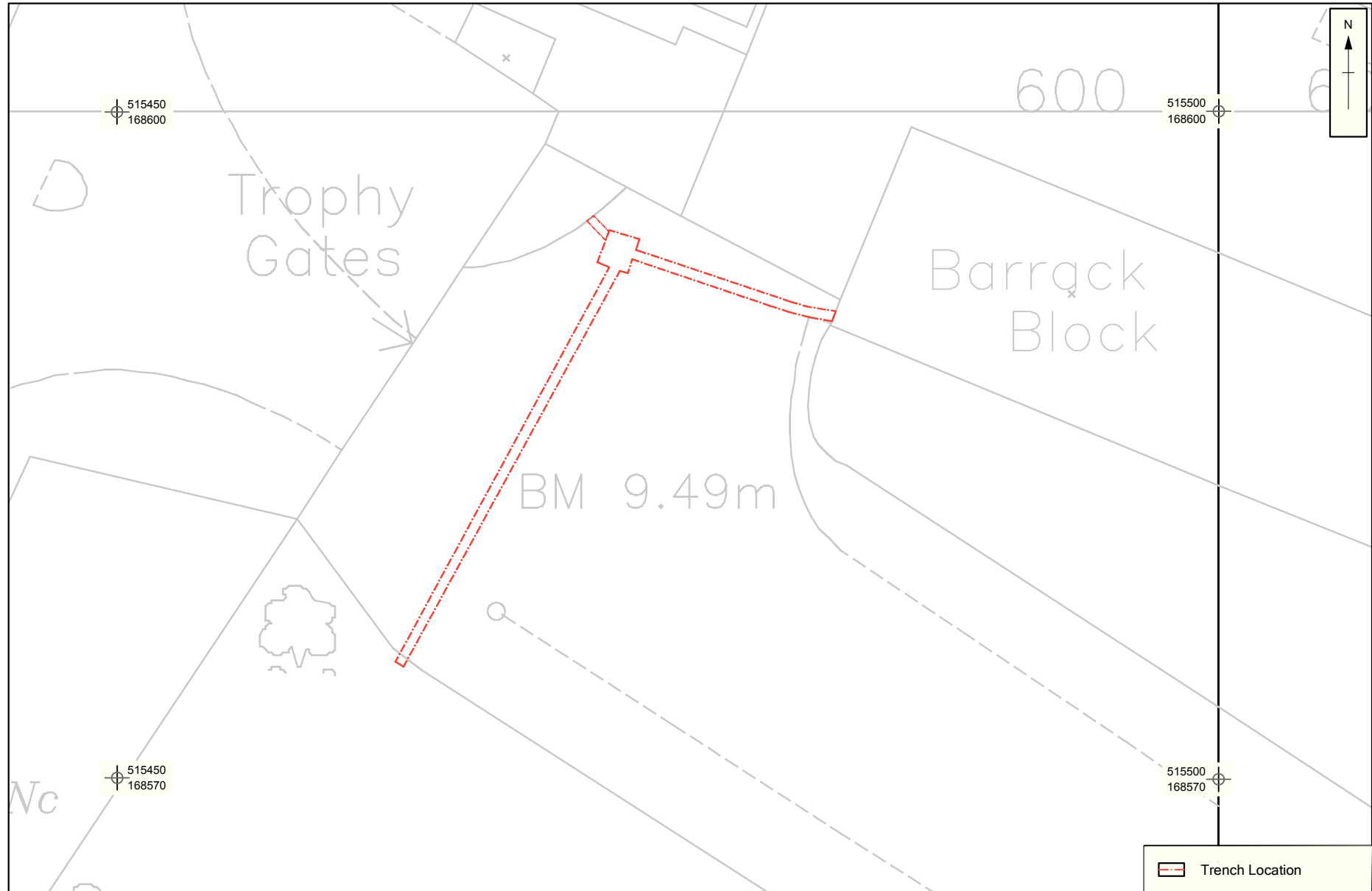

Figure 1: Site location



All OS data reproduced by permission of the Ordnance Survey on behalf of the controller of Her Majesty's Stationery Office © Crown copyright. All rights reserved. License AL 100005569

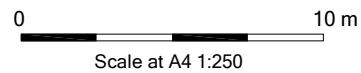

Figure 2, Trophy Gate Trench Location
Hampton Court Palace

CHECKED BY: MB/MW



**Head Office/Registered Office/
OA South**

Janus House
Osney Mead
Oxford OX2 0ES

t: +44 (0) 1865 263 800
f: +44 (0) 1865 793 496
e: info@oxfordarch.co.uk
w: <http://thehumanjourney.net>

OA North

Mill 3
Moor Lane
Lancaster LA1 1GF

t: +44 (0) 1524 541 000
f: +44 (0) 1524 848 606
e: [oanorth@thehumanjourney.net](mailto: oanorth@thehumanjourney.net)
w: <http://thehumanjourney.net>

OA East

15 Trafalgar Way
Bar Hill
Cambridgeshire
CB23 8SQ

t: +44 (0) 1223 850 500
f: +44 (0) 1223 850 599
e: [oaeast@thehumanjourney.net](mailto: oaeast@thehumanjourney.net)
w: <http://thehumanjourney.net>



Director: David Jennings, BA MIFA FSA

*Oxford Archaeology Ltd is a
Private Limited Company, N^o: 1618597
and a Registered Charity, N^o: 285627*