

Site/Project Name: **Oxford Beaumont Street Void**

Site Code: OXBEVO 09

Site/Project Type: Watching Brief

Year(s): 2009

Accession Number: OXCMS:2009.30

Record Group	Contents	Comments	Box/File Number
A	REPORT Archaeological watching brief report OASIS report print out	1 bound copy 2 sheets	Box 1 file 1
B	SITE DIARY Watching brief record	1 sheet	Box 1 file 2
B	PRIMARY CONTEXT DATA Context Checklist Context record sheet	1 sheet 12 sheets	Box 1 file 3
B	CATALOGUE OF DRAWINGS Plan record sheet Section record sheet	1 sheet 1 sheet	Box 1 file 4
B	PRIMARY DRAWINGS Plans Sections	1 A4 sheet 2 A4 sheets	Box 1 file 5
D	CATALOGUE OF PHOTOGRAPHS Black and white photographic record sheet Digital photographic record sheet	1 sheet 1 sheet	Box 1 file 6

PDFA SCAN

FILMING INSTRUCTIONS

Submitter OASouth
 No. of Scan copies: 3

Headings

Site information

Line 1: [OASouth] County: [Oxfordshire] Parish:[Oxford]
 Site: [Oxford Beaumont Street Void] Site code: [OXBEVO 09]
 Line 2: Excavators name[D. Dodds]
 Line 3:

Classification of material

Tick if present

Classification of material	Tick if present
Index to archive	<input checked="" type="checkbox"/>
Introduction	<input type="checkbox"/>
A:Final Report	<input type="checkbox"/>
A:Publication Report	<input type="checkbox"/>
B:Site Data – Text: Diary/Daybook/Fieldnotes	<input type="checkbox"/>
B: Site Data – Text: General Summaries	<input type="checkbox"/>
B: Site Data – Text: Primary Context Records	<input type="checkbox"/>
B: Site Data – Text: Synthesised Context Records	<input type="checkbox"/>
B: Site Data – Text: Survey Reports	<input type="checkbox"/>
B: Site Data – Text: Catalogue of Drawings	<input type="checkbox"/>
B: Site Data – Text: Primary Drawings	<input type="checkbox"/>
B: Site Data – Text: Synthesised Drawings	<input type="checkbox"/>
C: Finds Data – Text: Primary Finds Data	<input type="checkbox"/>
C: Finds Data – Text: Synthesised Finds Data	<input type="checkbox"/>
C: Finds Data – Text: Specialist Reports	<input type="checkbox"/>
C: Finds Data – Text: Box/Bag List	<input type="checkbox"/>
D: Catalogue of Photos/Slides/Videos/X--rays	<input type="checkbox"/>
E: Environmental/Ecofact Data: Primary Records	<input type="checkbox"/>
E: Environmental/Ecofact Data: Synthesised Records	<input type="checkbox"/>
E: Environmental/Ecofact Data: Specialist Reports	<input type="checkbox"/>
F: Documentary	<input type="checkbox"/>
F: Press and Publicity	<input type="checkbox"/>
G: Correspondence	<input type="checkbox"/>
H: Miscellaneous	<input type="checkbox"/>

A REPORT

--	--	--	--	--

No. 978033 Buff



PDF A SCAN

FILMING INSTRUCTIONS

Submitter OASouth
 No. of Scan copies: 3

Headings

Site information

Line 1: [OASouth] County: [Oxfordshire] Parish:[Oxford]
 Site: [Oxford Beaumont Street Void] Site code: [OXBEVO 09]
 Line 2: Excavators name[D. Dodds]

Line 3:

Classification of material

Tick if present

Classification of material	Tick if present
Index to archive	
Introduction	
A:Final Report	<input checked="" type="checkbox"/>
A:Publication Report	
B:Site Data – Text: Diary/Daybook/Fieldnotes	
B: Site Data – Text: General Summaries	
B: Site Data – Text: Primary Context Records	
B: Site Data – Text: Synthesised Context Records	
B: Site Data – Text: Survey Reports	
B: Site Data – Text: Catalogue of Drawings	
B: Site Data – Text: Primary Drawings	
B: Site Data – Text: Synthesised Drawings	
C: Finds Data – Text: Primary Finds Data	
C: Finds Data – Text: Synthesised Finds Data	
C: Finds Data – Text: Specialist Reports	
C: Finds Data – Text: Box/Bag List	
D: Catalogue of Photos/Slides/Videos/X--rays	
E: Environmental/Ecofact Data: Primary Records	
E: Environmental/Ecofact Data: Synthesised Records	
E: Environmental/Ecofact Data: Specialist Reports	
F: Documentary	
F: Press and Publicity	
G: Correspondence	
H: Miscellaneous	

OASIS DATA COLLECTION FORM:

England

[List of Projects](#) | [Search Projects](#) | [New project](#) | [Change your details](#) | [HER coverage](#) | [Change country](#) | [Log out](#)

Printable version

OASIS ID: oxfordar1-82878

Project details

Project name	Oxford Beaumont Street Void
Short description of the project	On March 26th 2009, Oxford Archaeology (OA) carried out an archaeological watching brief during trenching adjacent to the Ashmolean Museum, Beaumont Street, Oxford (NGR: SP 5118 0654). The work was commissioned by Oxfordshire Highways as part of new trenching for new kerbing and drains. The watching brief revealed a well constructed stone built cess pit with a stone arched roof and an access passageway leading off to the east. The feature was sealed by deposits producing 18th/early 19th dating evidence. No other significant archaeology was observed.
Project dates	Start: 26-03-2009 End: 26-03-2009
Previous/future work	No / Not known
Any associated project reference codes	OXBEVO 09 - Sitecode
Any associated project reference codes	OXCMS:2009.30 - Museum accession ID
Type of project	Recording project
Site status	None
Current Land use	Transport and Utilities 1 - Highways and road transport
Monument type	NONE None
Significant Finds	NONE None
Investigation type	'Watching Brief'
Prompt	Highway agency work

Project location

Country	England
Site location	OXFORDSHIRE OXFORD OXFORD Oxford Beaumont Street Void
Study area	40.00 Square metres
Site coordinates	SP 511 065 51.7544027998 -1.2596189545 51 45 15 N 001 15 34 W Point

Project creators

Name of Organisation Oxford Archaeology

Project brief originator verbal brief

Project director/manager D. Dodds

Project supervisor M.Sims

Project archives

Physical Archive Exists? No

Digital Archive recipient Oxford Archaeology

Digital Contents 'Stratigraphic'

Digital Media available 'Images raster / digital photography','Text'

Paper Archive recipient Oxfordshire County Museum Service

Paper Contents 'Stratigraphic'

Paper Media available 'Context sheet','Diary','Microfilm','Notebook - Excavation',' Research',' General Notes','Photograph','Plan','Report','Section','Unpublished Text'

Project bibliography 1

Publication type Grey literature (unpublished document/manuscript)

Title Trenching Adjacent to the Ashmolean Museum Beaumont Street Oxford, Archaeological Watching Brief Report

Author(s)/Editor(s) Sims M.

Date 2009

Issuer or publisher OXFORD ARCHAEOLOGY

Place of issue or publication OXFORD

Description Plastic bound client report

Entered by wajdan.majeed (wajdan.majeed@oxfordarch.co.uk)

Entered on 16 September 2010

OASIS:

Please e-mail English Heritage for OASIS help and advice

© ADG 1999-2009. Created by the OASIS project. The OASIS project is funded by English Heritage. OASIS is a registered charity.

B SITE DIARY

--	--	--	--	--

No.978033 Buff



PDF/A SCAN

FILMING INSTRUCTIONS

Submitter OASouth

No. of Scan copies: 3

Headings

Site information

Line 1: [OASouth] County: [Oxfordshire] Parish:[Oxford]

Site: [Oxford Beaumont Street Void] Site code: [OXBEVO 09]

Line 2: Excavators name[D. Dodds]

Line 3:

Classification of material

Tick if present

Classification of material	Tick if present
Index to archive	
Introduction	
A:Final Report	
A:Publication Report	
B:Site Data – Text: Diary/Daybook/Fieldnotes	<input checked="" type="checkbox"/>
B: Site Data – Text: General Summaries	
B: Site Data – Text: Primary Context Records	
B: Site Data – Text: Synthesised Context Records	
B: Site Data – Text: Survey Reports	
B: Site Data – Text: Catalogue of Drawings	
B: Site Data – Text: Primary Drawings	
B: Site Data – Text: Synthesised Drawings	
C: Finds Data – Text: Primary Finds Data	
C: Finds Data – Text: Synthesised Finds Data	
C: Finds Data – Text: Specialist Reports	
C: Finds Data – Text: Box/Bag List	
D: Catalogue of Photos/Slides/Videos/X--rays	
E: Environmental/Ecofact Data: Primary Records	
E: Environmental/Ecofact Data: Synthesised Records	
E: Environmental/Ecofact Data: Specialist Reports	
F: Documentary	
F: Press and Publicity	
G: Correspondence	
H: Miscellaneous	



WATCHING BRIEF RECORD

SITE CODE *OXBE1009*

SITE NAME *Beaumont St. Oxford*

DATE *26-3-09*

NGR

County

OXON

Start Time

08.00

Finish Time

10.30

Milage

Previous Visit

—

Visit By

M. SIMS

Type of construction work

Trenching for new ~~kerb~~ kerbstones

Contacts made

Archaeology present?

Yes:

✓ (19th cent p.A.)

No:

Undated:

Other:

COMMENTS

On site to monitor discovery of a void exposed in base of trenching for new kerbstones along Beaumont street opposite Ashmolean entrance

Void was collapsed stone vaulting over square stone pit approx 2m x 2m

Walls + roof heavily organically stained probable cess?

Passageway leading off to east ~~end~~ covered with stone slabs

N.E. corner of pit makes use of earlier stone structure - Building foundations?

Records?

Photos plan sections ext.

B. PRIMARY CONTEXT RECORDS

--	--	--	--	--	--

No. 978033 Buff



PDF A SCAN

FILMING INSTRUCTIONS

Submitter OASouth

No. of Scan copies: 3

Headings

Site information

Line 1: [OASouth] County: [Oxfordshire] Parish:[Oxford]

Site: [Oxford Beaumont Street Void] Site code: [OXBEVO 09]

Line 2: Excavators name[D. Dodds]

Line 3:

Classification of material

Tick if present

Index to archive	
Introduction	
A:Final Report	
A:Publication Report	
B:Site Data – Text: Diary/Daybook/Fieldnotes	
B: Site Data – Text: General Summaries	
B: Site Data – Text: Primary Context Records	<input checked="" type="checkbox"/>
B: Site Data – Text: Synthesised Context Records	
B: Site Data – Text: Survey Reports	
B: Site Data – Text: Catalogue of Drawings	
B: Site Data – Text: Primary Drawings	
B: Site Data – Text: Synthesised Drawings	
C: Finds Data – Text: Primary Finds Data	
C: Finds Data – Text: Synthesised Finds Data	
C: Finds Data – Text: Specialist Reports	
C: Finds Data – Text: Box/Bag List	
D: Catalogue of Photos/Slides/Videos/X--rays	
E: Environmental/Ecofact Data: Primary Records	
E: Environmental/Ecofact Data: Synthesised Records	
E: Environmental/Ecofact Data: Specialist Reports	
F: Documentary	
F: Press and Publicity	
G: Correspondence	
H: Miscellaneous	



CONTEXT RECORD

Context No.

10

SITE *OXBEV 09*

ADDITIONAL SHEETS:

TYPE *Surface*

Trench

Context Type: Deposit / Cut / Structure

Check Lists:

Site sub-div

Overlain by:

DEPOSIT:

1. compaction
2. colour
3. composition
4. inclusion
5. thickness
6. extent
7. comments
8. method & conditions

Structure No.

Abutted by:

Plan No.

2

Cut by:

Filled by:

Section No.

1:2

Same as:

Part of:

CUT:

1. shape in plan
2. base/sides/top profile
3. dimension and depth
4. sketch
5. truncation
6. fill nos
7. other comments

Co-Ordinates

Consists of:

Overlies: 11:15

Level

Butts: 16

MASONRY:

1. materials
2. size of bricks etc
3. finish of stones
4. coursing/bond
5. form
6. faces
7. bond
8. dimensions as found
9. other comments

Slide No.

Cuts:

Neg No.

Fill of:

Matrix location

Relationships uncertain

Description (See check lists):

- 1) Compact
- 2) v. dark grey
- 3) Tarnal
- 4) 0.1m thick.

STRATIGRAPHIC MATRIX

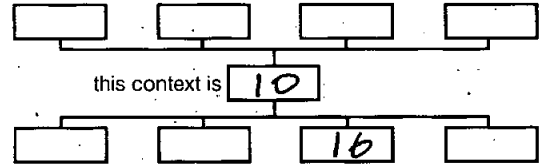

Interpretation/Discussion:

Tarnal road surface, Beaumont St.

Finds (tick): None [] Pot [] Bone [] Flint [] Stone [] Burnt stone [] Glass []
 Metal [] CBM [] Wood [] Leather []

 Small Finds
Recorder *[Signature]*
 Samples

Date

 Building Materials

Initials



CONTEXT RECORD

Context No.

11

SITE *OXBEVO 09*

ADDITIONAL SHEETS:

TYPE *Lager*

Trench

Context Type: Deposit / Cut / Structure

Check Lists:

Site sub-div

Overlain by: *10*

DEPOSIT:

1. compaction
2. colour
3. composition
4. inclusion
5. thickness
6. extent
7. comments
8. method & conditions

Structure No.

Abutted by:

Plan No.

Cut by: *15*

Filled by:

Section No.

Same as:

CUT:

1. shape in plan
2. base/sides/top profile
3. dimension and depth
4. sketch
5. truncation
6. fill nos
7. other comments

Co-Ordinates

Consists of:

Overlies: *12*

Level

Butts:

MASONRY:

1. materials
2. size of bricks etc
3. finish of stones
4. coursing/bond
5. form
6. faces
7. bond
8. dimensions as found
9. other comments

Slide No.

Cuts:

Neg No.

Fill of:

Matrix location

Relationships uncertain

Description (See check lists):

STRATIGRAPHIC MATRIX

1) Compact

2) Pale grey

3) Concrete

4) N.I

5) 0.1m deep.

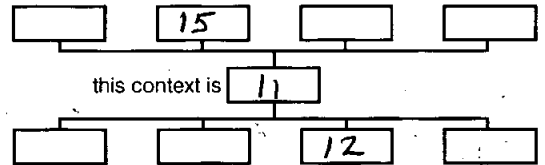

Interpretation/Discussion:

*Concrete bed for tarmac surface (10)*Finds (tick): None Pot Bone Flint Stone Burnt stone Glass
Metal CBM Wood Leather Small FindsRecorder *M* Samples

Date

 Building Materials

Initials



CONTEXT RECORD

Context No.

12

SITE OXBKVO 09

ADDITIONAL SHEETS:

TYPE Layer

Trench

Context Type: Deposit / Cut / Structure

Check Lists:

Site sub-div

Overlain by: 11

DEPOSIT:

1. compaction
2. colour
3. composition
4. inclusion
5. thickness
6. extent
7. comments
8. method & conditions

Structure No.

Abutted by:

Plan No.

2

Cut by: 15

Filled by:

Section No.

1:2

Same as:

Part of:

CUT:

1. shape in plan
2. base/sides/top profile
3. dimension and depth
4. sketch
5. truncation
6. fill nos
7. other comments

Co-Ordinates

Consists of:

Overlies: 17

Level

Butts:

MASONRY:

1. materials
2. size of bricks etc
3. finish of stones
4. coursing/bond
5. form
6. faces
7. bond
- 8/ dimensions as found
9. other comments

Slide No.

Cuts:

Neg No.

Fill of:

Matrix location

Relationships uncertain

Description (See check lists):

STRATIGRAPHIC MATRIX

- 1) Compact
- 2) Orange yellow
- 3) Gravel
- 5) 0.15m deep.

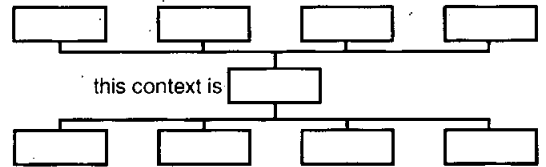

Interpretation/Discussion:

Gravel hardcore base for Beaumont Street

Finds (tick): None Pot Bone Flint Stone Burnt stone Glass
 Metal CBM Wood Leather

 Small FindsRecorder *MA* Samples

Date

 Building Materials

Initials



CONTEXT RECORD

Context No.

13

SITE *OXBEV 09*

ADDITIONAL SHEETS:

TYPE *Surface*

Trench

Context Type: Deposit / Cut / Structure

Check Lists:

Site sub-div.

Overlain by:

DEPOSIT:

1. compaction
2. colour
3. composition
4. inclusion
5. thickness
6. extent
7. comments
8. method & conditions

Structure No.

Abutted by:

Plan No.

2

Cut by:

Filled by:

Section No.

1:2

Same as:

Part of:

CUT:

1. shape in plan
2. base/sides/top profile
3. dimension and depth
4. sketch
5. truncation
6. fill nos
7. other comments

Co-Ordinates

Consists of:

Overlies: 14

Level

Butts: 16

MASONRY:

1. materials
2. size of bricks etc
3. finish of stones
4. coursing/bond
5. form
6. faces
7. bond
8. dimensions as found
9. other comments

Slide No.

Cuts:

Neg No.

Fill of:

Matrix location

Relationships uncertain

Description (See check lists):

- 1) Compact
- 2) Pale grey
- 3) 0.5m x 0.5m paving slabs
- 4) Depth 0.1m

STRATIGRAPHIC MATRIX

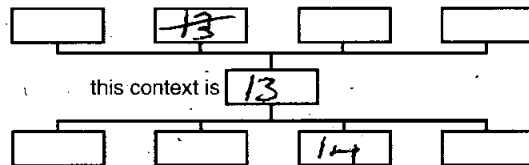

Interpretation/Discussion:

Pavement in front of mixed m.

Finds (tick): None Pot Bone Flint Stone Burnt stone Glass
 Metal CBM Wood Leather

 Small Finds
Recorder *[Signature]*
 Samples

Date

 Building Materials

Initials



CONTEXT RECORD

Context No.

14

SITE OXBEV009

ADDITIONAL SHEETS:

TYPE Layer

Trench

Context Type: Deposit / ~~Cut~~ / Structure

Check Lists:

Site sub-div

Overlain by: 13

DEPOSIT:

1. compaction
2. colour
3. composition
4. inclusion
5. thickness
6. extent
7. comments
8. method & conditions

Structure No.

Abutted by:

Plan No.

2

Cut by:

Filled by:

Section No.

1:2

Same as:

Part of:

CUT:

1. shape in plan
2. base/sides/top profile
3. dimension and depth
4. sketch
5. truncation
6. fill nos
7. other comments

Co-Ordinates

Consists of:

Overlies: 17

Level

Butts: 16

MASONRY:

1. materials
2. size of bricks etc
3. finish of stones
4. coursing/bond
5. form
6. faces
7. bond
8. dimensions as found
9. other comments

Slide No.

Cuts:

Neg No.

Fill of:

Matrix location

Relationships uncertain

Description (See check lists):

- 1) Friable
- 2) Orange yellow
- 3) Sand
- 4) a -
- 5) 0.1m thick.

STRATIGRAPHIC MATRIX

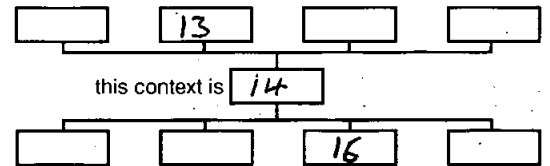

Interpretation/Discussion:

Sand bed below paving slabs (13)

Finds (tick): None Pot Bone Flint Stone Burnt stone Glass
 Metal CBM Wood Leather

△ Small Finds

Recorder *[Signature]*

◇ Samples

Date

⬆ Building Materials

Initials



CONTEXT RECORD

Context No. **14/15**

SITE **OXBEV09**

ADDITIONAL SHEETS:

TYPE **CS**

Trench

Context Type: ~~Deposit~~ / ~~Cut~~ / ~~Structure~~

Check Lists:

Site sub-div

Overlain by: **14:10**

DEPOSIT:

1. compaction
2. colour
3. composition
4. inclusion
5. thickness
6. extent
7. comments
8. method & conditions

Structure No.

Abutted by:

Plan No.

2

Cut by:

Filled by: **15/16**

Section No.

1:2

Same as:

Part of:

CUT:

1. shape in plan
2. base/sides/top profile
3. dimension and depth
4. sketch
5. truncation
6. fill nos
7. other comments

Co-Ordinates:

Consists of:

Overlies:

Level

Butts:

Slide No.

Cuts: **11:12:17**

Neg No.

Fill of:

MASONRY:

1. materials
2. size of bricks etc
3. finish of stones
4. coursing/bond
5. form & faces
7. bond
8. dimensions as found
9. other comments

Matrix location

Relationships uncertain

Description (See check lists):

- 1) straight edged linear
- 2) vertical sides flat base
- 3) 0.3m deep 0.3m wide

STRATIGRAPHIC MATRIX

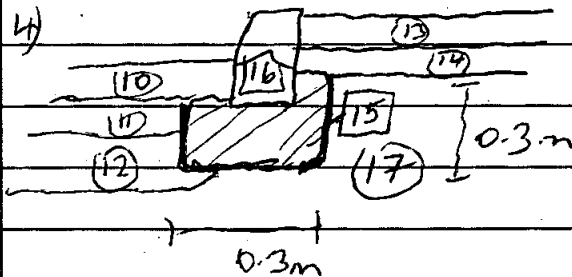
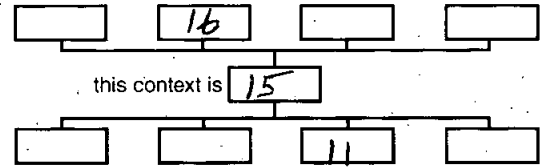

- 5) N.A
- 6) Filled by **16**

Interpretation/Discussion:

Construction cut for kerbstones **16**

Finds (tick): None Pot Bone Flint Stone Burnt stone Glass
 Metal CBM Wood Leather

Small Finds

Recorder

Samples

Date

Building Materials

Initials



CONTEXT RECORD

Context No. **16**

SITE OXBE 10.09	ADDITIONAL SHEETS:	TYPE Structure
Trench	Context Type: Deposit/Cut/Structure	Check Lists:
Site sub-div	Overlain by: 14:10	DEPOSIT: 1. compaction 2. colour 3. composition 4. inclusion 5. thickness 6. extent 7. comments 8. method & conditions
Structure No.	Abutted by:	
Plan No. 2	Cut by:	CUT: 1. shape in plan 2. base/sides/top profile 3. dimension and depth 4. sketch 5. truncation 6. fill nos 7. other comments
	Filled by:	
Section No. 1:2	Same as:	MASONRY: 1. materials 2. size of bricks etc 3. finish of stones 4. coursing/bond 5. form 6. faces 7. bond 8. dimensions as found 9. other comments
	Part of:	
Co-Ordinates	Consists of:	
	Overlies: 11:12	
Level	Butts:	
Slide No.	Cuts:	
Neg No.	Fill of: 15	
Matrix location	Relationships uncertain	

Description (See check lists):

1) Concrete kerbstones, concrete base
 2) Kerbstones 0.9m x 0.18m x 0.12m
 3) ~~4) Batted~~
 5) Linear feature along edge of road

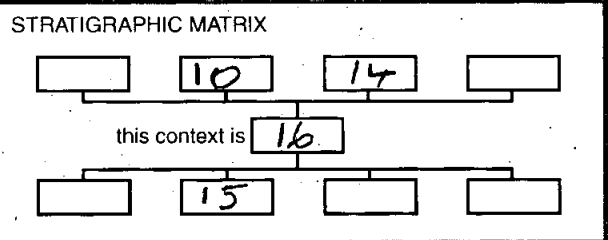

Interpretation/Discussion: **Masonry concrete kerbing along northern edge of beaumont street**

Finds (tick): None Pot Bone Flint Stone Burnt stone Glass
 Metal CBM Wood Leather

<input type="checkbox"/> Small Finds	Recorder [Signature]
<input type="checkbox"/> Samples	Date
<input type="checkbox"/> Building Materials	Initials



CONTEXT RECORD

Context No.

17

SITE OXBEVO 09

ADDITIONAL SHEETS:

TYPE Layer

Trench

Context Type: Deposit / ~~Cut~~ / Structure

Check Lists:

Site sub-div

Overlain by: 12 : 14

DEPOSIT:

1. compaction
2. colour
3. composition
4. inclusion
5. thickness
6. extent
7. comments
8. method & conditions

Structure No.

Abutted by:

Plan No.

2

Cut by: 15

Filled by:

Section No.

1:2

Same as:

Part of:

CUT:

1. shape in plan
2. base/sides/top profile
3. dimension and depth
4. sketch
5. truncation
6. fill nos
7. other comments

Co-Ordinates

Consists of:

Overlies: 18:19:20

Level

Butts:

MASONRY:

1. materials
2. size of bricks etc
3. finish of stones
4. coursing/bond
5. form
6. faces
7. bond
8. dimensions as found
9. other comments

Slide No.

Cuts:

Neg No.

Fill of:

Matrix location

Relationships uncertain.

Description (See check lists):

STRATIGRAPHIC MATRIX

1) Tendrils

2) Grey-brown

3) silt-clay

4) Stone + CBM frags charcoal flecking

5) Depth > 1m



this context is 17

Interpretation/Discussion:

Layer of made ground. Possibly from 1821 re construction of Beadmart street.

Finds (tick): None Pot Bone Flint Stone Burnt stone Glass
 Metal CBM Wood Leather Clay pipes

 Small Finds

Recorder, M

 Samples

Date

 Building Materials

Initials



CONTEXT RECORD

Context No.

18

SITE OXBEVO 09

ADDITIONAL SHEETS:

TYPE Structure

Trench

Context Type: Deposit / Cut / Structure

Check Lists:

Site sub-div

Overlain by: 20:17

DEPOSIT:

1. compaction
2. colour
3. composition
4. inclusion
5. thickness
6. extent
7. comments
8. method & conditions

Structure No.

Abuted by:

Plan No.

1:2

Cut by:

Filled by:

Section No.

1:2

Same as:

Part of:

CUT:

1. shape in plan
2. base/sides/top profile
3. dimension and depth
4. sketch
5. truncation
6. fill nos
7. other comments

Co-Ordinates

Consists of:

Overlies:

Level

Butts: 19

MASONRY:

1. materials
2. size of bricks etc
3. finish of stones
4. coursing/bond
5. form
6. faces
7. bond
8. dimensions as found
9. other comments

Slide No.

Cuts:

Neg No.

Fill of:

Matrix location

Relationships uncertain

Description (See check lists):

STRATIGRAPHIC MATRIX

1) Limestone

2) Up to 0.25 x 0.2 x 0.15m

3) Roughly dressed

4) Rubble rough coursing

5) Square pit with stone vaulting over

7) No mortar used

8) 1.8m x 1.8m depth > 2m

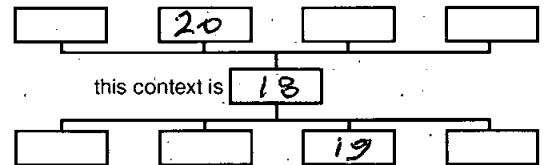

Interpretation/Discussion:

Stone lined cess pit. interiorheavily organic stainedsides rough built stones used for arching/vaultingwell dressed + squared.Passeway 0.85m wide leading off to east.

Finds (tick): None Pot Bone Flint Stone Burnt stone Glass
 Metal CBM Wood Leather

△ Small Finds

Recorder [Signature]

◇ Samples

Date

⬆ Building Materials

Initials



CONTEXT RECORD

Context No.

19

SITE *OXBEVO 03*

ADDITIONAL SHEETS:

TYPE *Structure*

Trench

Context Type: *Deposit / Cut / Structure*

Check Lists:

Site sub-div.

Overlain by: *20*

DEPOSIT:

1. compaction
2. colour
3. composition
4. inclusion
5. thickness
6. extent
7. comments
8. method & conditions

Structure No.

Abutted by: *18*

Plan No.

1:2

Cut by: -

Filled by:

Section No.

2

Same as:

Part of:

CUT:

1. shape in plan
2. base/sides/top profile
3. dimension and depth
4. sketch
5. truncation
6. fill nos.
7. other comments

Co-Ordinates

Consists of:

Overlies:

Level

Butts:

MASONRY:

1. materials
2. size of bricks etc
3. finish of stones
4. coursing/bond
5. form 6. faces
7. bond
8. dimensions as found
9. other comments

Slide No.

Cuts:

Neg No.

Fill of:

Matrix location

Relationships uncertain

Description (See check lists):

STRATIGRAPHIC MATRIX

- 1) Ashlar blocks
- 2) 0.4m x 0.22m x 0.22m
- 3) Well dressed
- 4) Regular courses
- 5) Squared corner
- 7) Lime mortar
- 8) >1m x >1m x >2m high

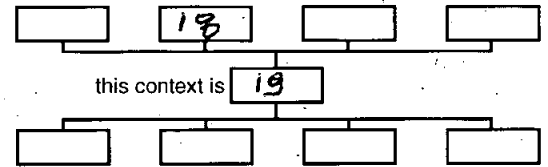

Interpretation/Discussion:

Corner of earlier structure / Possible gable or chimney stack of earlier building reused used as NE corner of cess pit [18]

Finds (tick): None Pot Bone Flint Stone Burnt stone Glass
 Metal CBM Wood Leather

 Small Finds
Recorder *W*
 Samples

Date

 Building Materials

Initials



CONTEXT RECORD

Context No. **20**

SITE **DXBEVO 09**

ADDITIONAL SHEETS:

TYPE **Structure**

Trench

Context Type: Deposit / Cut / Structure

Check Lists:

Site sub-div

Overlain by: **17**

DEPOSIT:

- 1. compaction
- 2. colour
- 3. composition
- 4. inclusion
- 5. thickness
- 6. extent
- 7. comments
- 8. method & conditions

Structure No.

Abuted by:

Plan No.

112

Cut by:

Filled by:

Section No.

2

Same as:

Part of:

CUT:

- 1. shape in plan
- 2. base/sides/top profile
- 3. dimension and depth
- 4. sketch
- 5. truncation
- 6. fill / os
- 7. other comments

Co-Ordinates

Consists of:

Overlies: **18:19**

Level

Butts:

MASONRY:

- 1. materials
- 2. size of bricks etc
- 3. finish of stones
- 4. coursing/bond
- 5. form
- 6. faces
- 7. bond
- 8. dimensions as found
- 9. other comments

Slide No.

Cuts:

Neg No.

Fill of:

Matrix location

Relationships uncertain

Description (See check lists):

STRATIGRAPHIC MATRIX

- 1) Limestone
- 2) 1m x 0.3m x 0.45m x 0.13m
- 3) Well dressed
- 4) Single layer of slabs
- 5) Slab roof over passageway leading to east off 18

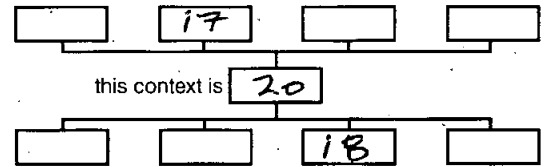

Interpretation/Discussion:

Stone slab roof over passageway leading eastwards off Cess pit 18

Finds (tick): None [] Pot [] Bone [] Flint [] Stone [] Burnt stone [] Glass [] Metal [] CBM [] Wood [] Leather []

Small Finds

Recorder

Samples

Date

Building Materials

Initials



CONTEXT RECORD

Context No.

21

SITE *OXBEV009*

ADDITIONAL SHEETS:

TYPE *Fill*

Trench

Context Type: Deposit / Cut / Structure

Check Lists:

Site sub-div

Overlain by: *17*

DEPOSIT:

1. compaction
2. colour
3. composition
4. inclusion
5. thickness
6. extent
7. comments
8. method & conditions

Structure No.

Abutted by:

Plan No.

1

Cut by:

Filled by:

Section No.

2

Same as:

Part of:

CUT:

1. shape in plan
2. base/sides/top profile
3. dimension and depth
4. sketch
5. truncation
6. fill nos
7. other comments

Co-Ordinates

Consists of:

Overlies:

Level

Butts: *18; 19*

MASONRY:

1. materials
2. size of bricks etc
3. finish of stones
4. coursing/bond
5. form
6. faces
7. bond
8. dimensions as found
9. other comments

Slide No.

Cuts:

Neg No.

Fill of: *20*

Matrix location

Relationships uncertain

Description (See check lists):

STRATIGRAPHIC MATRIX

- 1) Friable
- 2) Grey brown
- 3) Silty loam
- 4) Some stone fragments
- 5) > 1.6m deep
- 6) Fills *20* almost completely

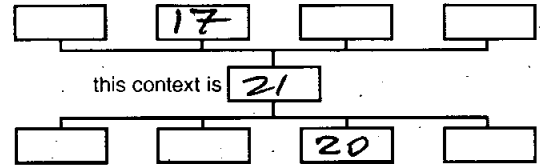

Interpretation/Discussion:

*Last backfilling/ Blocking of passage**20*

Vertical face suggests that it may have been retained by wooden door since rotted out.

Finds (tick): None Pot Bone Flint Stone Burnt stone Glass
 Metal CBM Wood Leather

 Small FindsRecorder *MS* Samples

Date

 Building Materials

Initials

B. CATALOGUE OF DRAWINGS

--	--	--	--	--

No. 978033 Buff



PDFA SCAN

FILMING INSTRUCTIONS

Submitter OASouth
 No. of Scan copies: 3

Headings

Site information

Line 1: [OASouth] County: [Oxfordshire] Parish:[Oxford]

Site: [Oxford Beaumont Street Void] Site code: [OXBEVO 09]

Line 2: Excavators name[D. Dodds]

Line 3:

Classification of material

Tick if present

Index to archive	
Introduction	
A:Final Report	
A:Publication Report	
B:Site Data – Text: Diary/Daybook/Fieldnotes	
B: Site Data – Text: General Summaries	
B: Site Data – Text: Primary Context Records	
B: Site Data – Text: Synthesised Context Records	
B: Site Data – Text: Survey Reports	
B: Site Data – Text: Catalogue of Drawings	✓
B: Site Data – Text: Primary Drawings	
B: Site Data – Text: Synthesised Drawings	
C: Finds Data – Text: Primary Finds Data	
C: Finds Data – Text: Synthesised Finds Data	
C: Finds Data – Text: Specialist Reports	
C: Finds Data – Text: Box/Bag List	
D: Catalogue of Photos/Slides/Videos/X--rays	
E: Environmental/Ecofact Data: Primary Records	
E: Environmental/Ecofact Data: Synthesised Records	
E: Environmental/Ecofact Data: Specialist Reports	
F: Documentary	
F: Press and Publicity	
G: Correspondence	
H: Miscellaneous	

B. PRIMARY DRAWINGS

--	--	--	--	--

No. 978033 Buff



PDF A SCAN

FILMING INSTRUCTIONS

Submitter OASouth

No. of Scan copies: 3

Headings

Site information

Line 1: [OASouth] County: [Oxfordshire] Parish:[Oxford]

Site: [Oxford Beaumont Street Void] Site code: [OXBEVO 09]

Line 2: Excavators name[D. Dodds]

Line 3:

Classification of material

Tick if present

Index to archive	
Introduction	
A:Final Report	
A:Publication Report	
B:Site Data – Text: Diary/Daybook/Fieldnotes	
B: Site Data – Text: General Summaries	
B: Site Data – Text: Primary Context Records	
B: Site Data – Text: Synthesised Context Records	
B: Site Data – Text: Survey Reports	
B: Site Data – Text: Catalogue of Drawings	
B: Site Data – Text: Primary Drawings	✓
B: Site Data – Text: Synthesised Drawings	
C: Finds Data – Text: Primary Finds Data	
C: Finds Data – Text: Synthesised Finds Data	
C: Finds Data – Text: Specialist Reports	
C: Finds Data – Text: Box/Bag List	
D: Catalogue of Photos/Slides/Videos/X--rays	
E: Environmental/Ecofact Data: Primary Records	
E: Environmental/Ecofact Data: Synthesised Records	
E: Environmental/Ecofact Data: Specialist Reports	
F: Documentary	
F: Press and Publicity	
G: Correspondence	
H: Miscellaneous	

OXBEVO 09

Plan 1

Scale 1:50

Feature location plan.

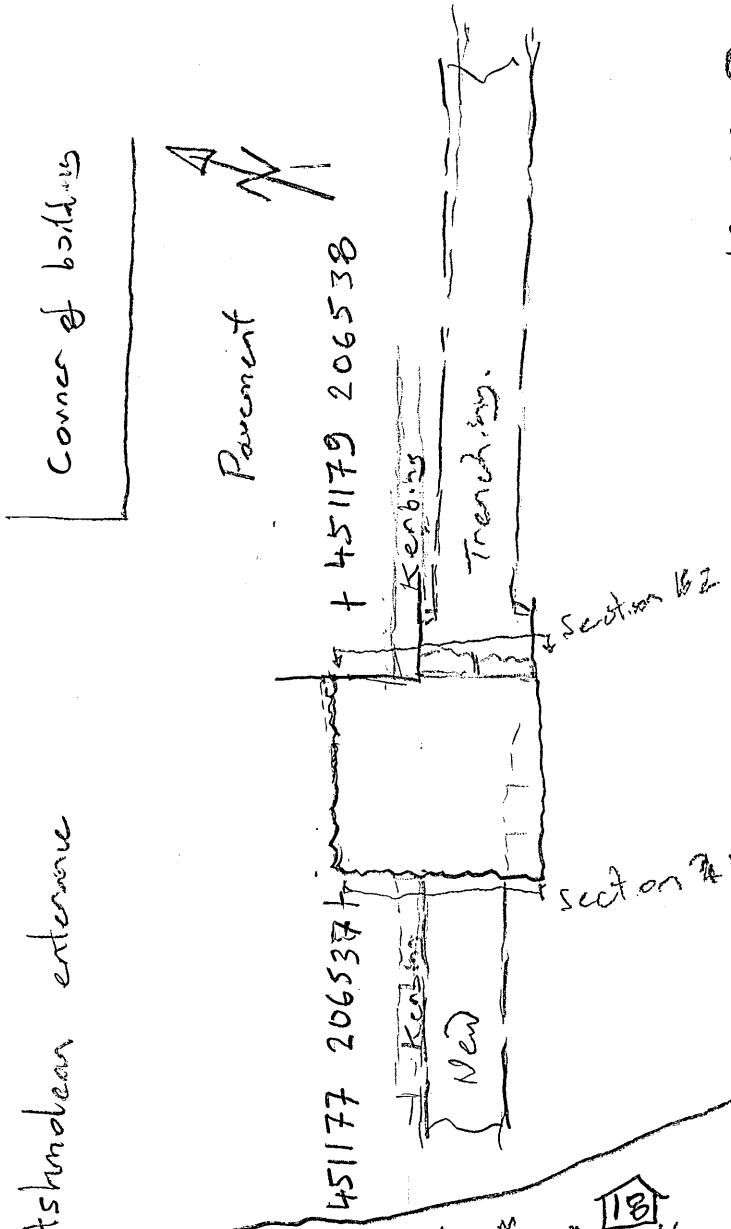

Ashundean entrance

OXBEVO 09

Plan 295

Scale 1:20

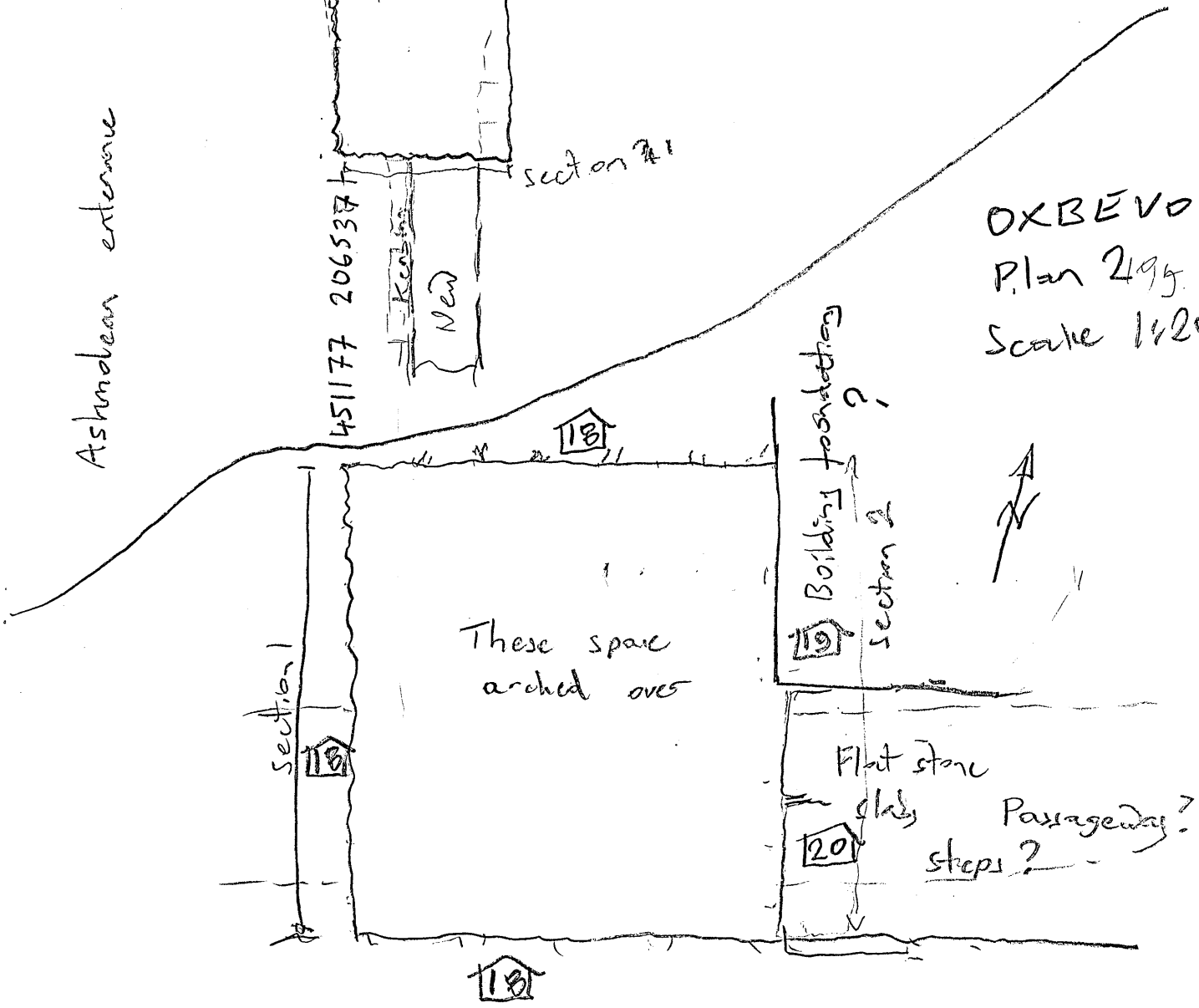

S 63.29m
K

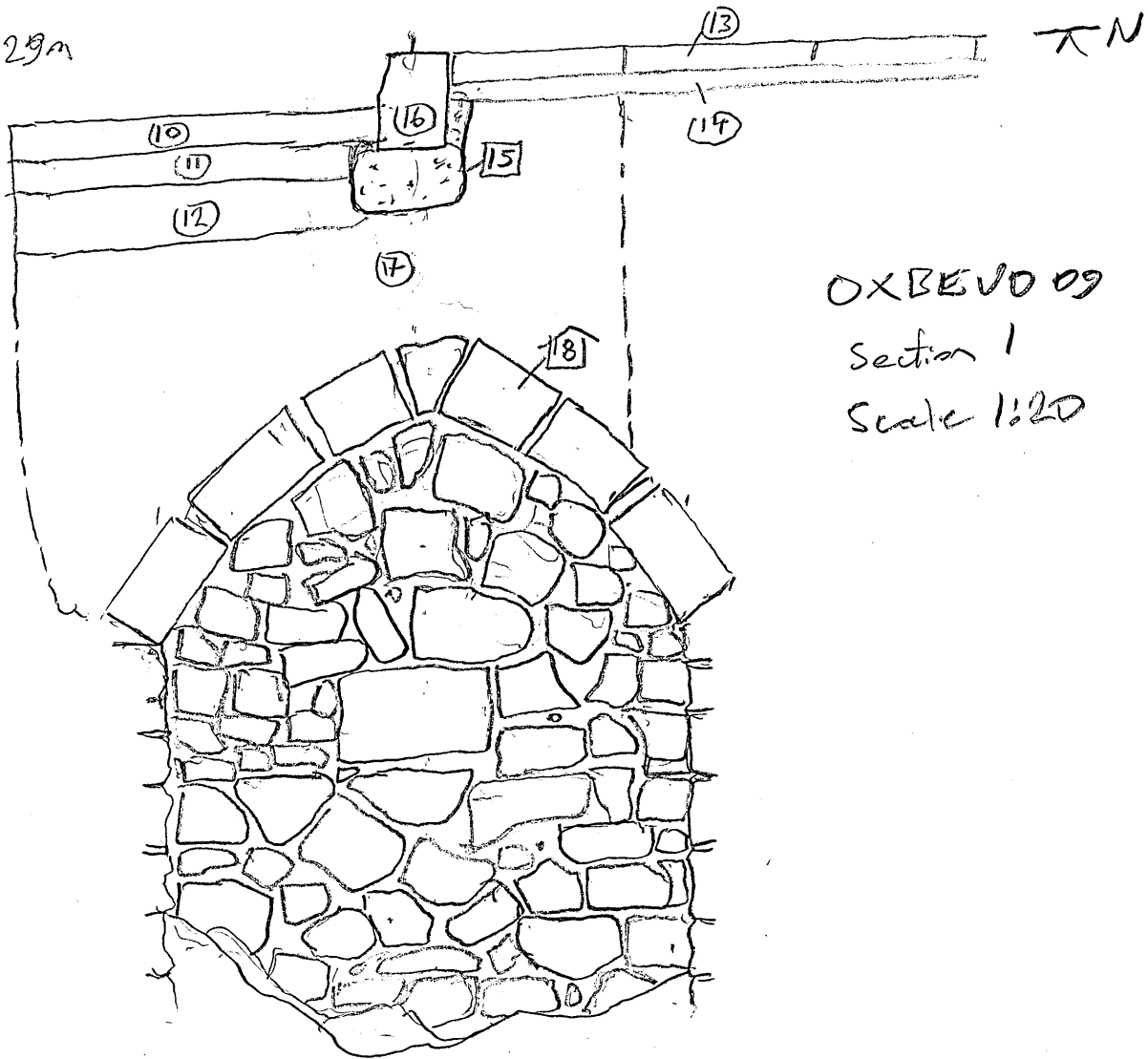

OXBEVD 09
Section 1
Scale 1:20

Fallen in material

N 63.29m

N S

OXBEVD 09
Section 2
Scale 1:20

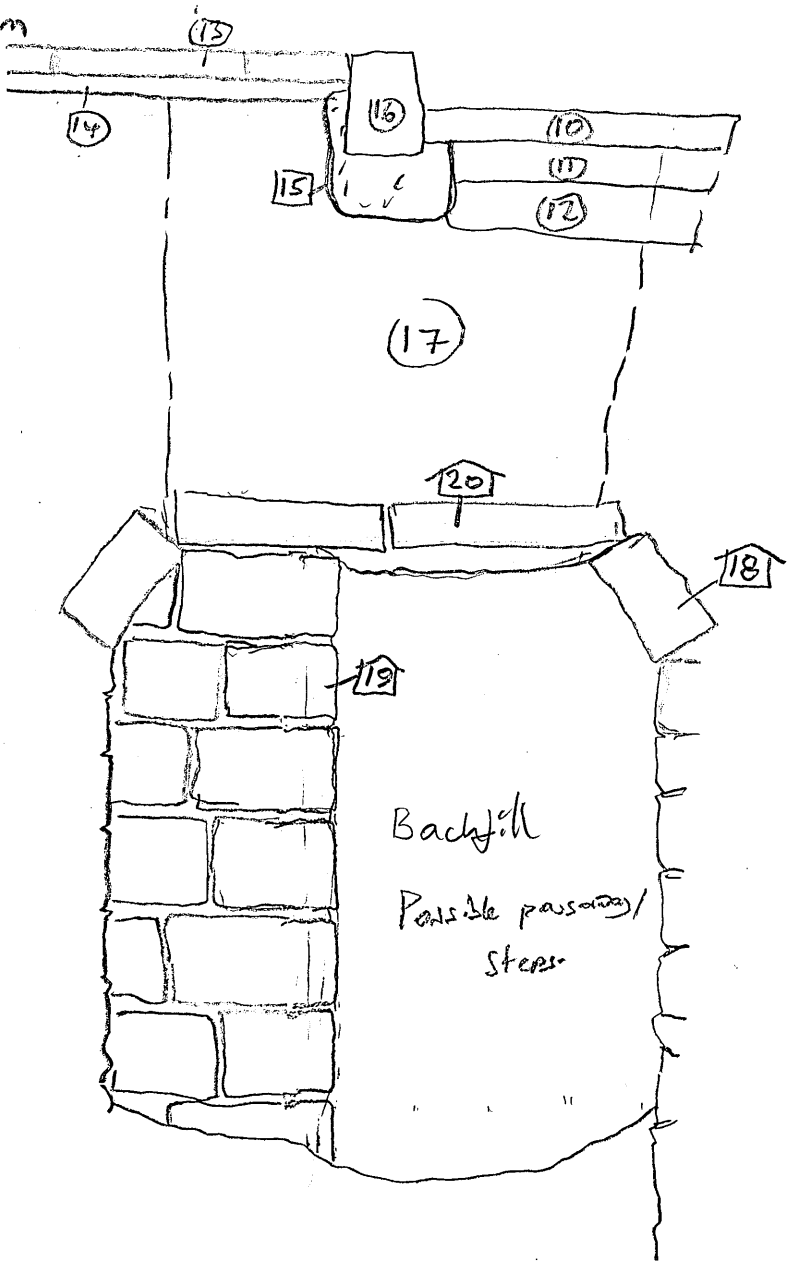

D. CATALOGUE OF PHOTOS

--	--	--	--	--	--

No. 978033 Buff



PDF/A SCAN

FILMING INSTRUCTIONS

Submitter OASouth

No. of Scan copies: 3

Headings

Site information

Line 1: [OASouth] County: [Oxfordshire] Parish:[Oxford]

Site: [Oxford Beaumont Street Void] Site code: [OXBEVO 09]

Line 2: Excavators name[D. Dodds]

Line 3:

Classification of material

Tick if present

Classification of material	Tick if present
Index to archive	
Introduction	
A:Final Report	
A:Publication Report	
B:Site Data – Text: Diary/Daybook/Fieldnotes	
B: Site Data – Text: General Summaries	
B: Site Data – Text: Primary Context Records	
B: Site Data – Text: Synthesised Context Records	
B: Site Data – Text: Survey Reports	
B: Site Data – Text: Catalogue of Drawings	
B: Site Data – Text: Primary Drawings	
B: Site Data – Text: Synthesised Drawings	
C: Finds Data – Text: Primary Finds Data	
C: Finds Data – Text: Synthesised Finds Data	
C: Finds Data – Text: Specialist Reports	
C: Finds Data – Text: Box/Bag List	
D: Catalogue of Photos/Slides/Videos/X--rays	<input checked="" type="checkbox"/>
E: Environmental/Ecofact Data: Primary Records	
E: Environmental/Ecofact Data: Synthesised Records	
E: Environmental/Ecofact Data: Specialist Reports	
F: Documentary	
F: Press and Publicity	
G: Correspondence	
H: Miscellaneous	



PHOTOGRAPHIC RECORD SHEET

SITE CODE *OXBEVD 09*

SITE NAME *Vault in Beadmart St. Oxford*

FILM NO. *1*

Camera number

Lens number

Black & white / ~~colour~~

Date	Negative number	View	Context(s)	Initials
	0			
	1	W	Section 1	
	2	W	" "	
	3	W	" "	
	4	W	" "	
	5	E	Section 2	
	6	E	" "	
	7	E	" "	
	8	E	" "	
	9	E	Detail of wall T19T	
	10	E	" "	
	11			
	12			
	13			
	14			
	15			
	16			
	17			
	18			
	19			
	20			
	21			
	22			
	23			
	24			
	25			
	26			
	27			
	28			
	29			
	30			
	31			
	32			
	33			
	34			
	35			
	36			
	37			

DIGITAL PHOTOGRAPHIC RECORD SHEET

Oxford Archaeology Oxford Archaeology Janus
House, Osney Mead Oxford, OX2 0ES

Site code OXBEVO 09		Site name Trenching in Beaumont Street, Oxford		Camera number		Sheet 1	
View No.	Photo No.	Context No. Description (Add context numbers where applicable)	Geo-Ref Photo	Object Photo	Scale (m)	View to	Initials and date
1	Picture 000.jpg	OXBEVO 09 ID Shot					ms
2	Picture 001.jpg	Wall 19 and blocked up passageway			1 m	E	ms
3	Picture 002.jpg	Wall 19 and blocked up passageway			1 m	E	ms
4	Picture 003.jpg	South wall of 18				S	ms
5	Picture 004.jpg	North wall of 18 and wall 19				N	ms
6	Picture 005.jpg	West wall of pit 18			0.5 m	W	ms
7	Picture 006.jpg	Section 1			0.5 m	W	ms
8	Picture 007.jpg	Section 1			0.5 m	W	ms
9	Picture 008.jpg	North wall of 18				N	ms
10	Picture 009.jpg	Overall view of void			0.5 m	W	ms
11	Picture 010.jpg	Overall view of void			0.5 m	W	ms
12	Picture 011.jpg	Detail of stone vaulting			0.5 m	W	ms
13	Picture 012.jpg	Top of section 1 showing arching			1 m	W	ms
14	Picture 013.jpg	Top of section 1 showing arching			1 m	W	ms
15	Picture 018.jpg	Section 2			1 m	E	ms
16	Picture 019.jpg	Section 2			1 m	E	ms
17	Picture 020.jpg	Section 2			1 m	E	ms
18	Picture 021.jpg	Wall 19			1 m	E	ms
19	Picture 022.jpg	Stone slabs 20			1 m	E	ms
20	Picture 023.jpg	Section 2			1 m	E	ms
21	Picture 024.jpg	Plan view of feature 18			1 m	E	ms
22	Picture 025.jpg	Plan view of feature 18			1 m	E	ms
23	Picture 026.jpg	Trenching alongside the Ashmolean				E	ms
24	Picture 027.jpg	Trenching alongside the Ashmolean				E	ms
25	Picture 028.jpg	Trenching alongside the Ashmolean				E	ms
26	Picture 029.jpg	Trenching alongside the Ashmolean				E	ms
27	Picture 030.jpg	Trenching alongside the Ashmolean				E	ms
28	Picture 031.jpg	Void as first exposed				E	ms