

**All Saints Church, Binfield, Berkshire**

*NGR SU 8433 7217*

**ARCHAEOLOGICAL WATCHING BRIEF REPORT**

**Oxford Archaeological Unit**

**March 1995**

**All Saints Church, Binfield, Berkshire (SU 8433 7217)  
Archaeological Watching Brief.**

Recently a toilet block has been added to the church of All Saints at Binfield. The work involved the establishment of stairs at the east end of the choir vestry descending to a new room partly cut into the ground level and external to the church lying between the clergy vestry and the chancel (see attached figure).

Prior to the work commencing an archaeological evaluation was undertaken outside the east end of the choir vestry where two coffin slabs present. The trench located a brick vault containing three lead coffins dated to the early 19th century (Binfield Church, Berkshire. Archaeological Evaluation by the Oxford Archaeological Unit. OAU April 1993).

During the building work an archaeological watching brief was maintained during the work inside the choir vestry. The Oxford Archaeological Unit was also on call to record any graves disturbed during the digging of a service trench across the church yard eastwards to the carpark. Nothing of significance was revealed in the service trench and the OAU did not inspect the trench.

The work inside the choir vestry was inspected on 1st December 1994 following a call from the architect. Where the stairwell was to be sited the floor had been removed and a cross section through the below-floor deposits and an airduct was observed. The airduct was a recent feature. The deposits on either side of the duct contained substantial pieces of worked chalk, which were thought to be the remains of a previous building. This layer was observed to impinge directly on top of natural clay.

Outside the church the only unusual feature was a buttress to the north east corner of the chancel wall sitting on top of a surface of uncoarsed brickwork. The bricks were not laid regularly and surface was at an angle of c 20 degrees from horizontal. It is thought that this could be the entrance to the brick vault which was found when the OAU carried out an evaluation in the same area in April 1993.

Olivia Pierpoint  
Oxford Archaeological Unit  
February 1995

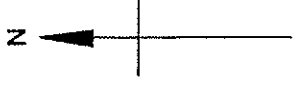
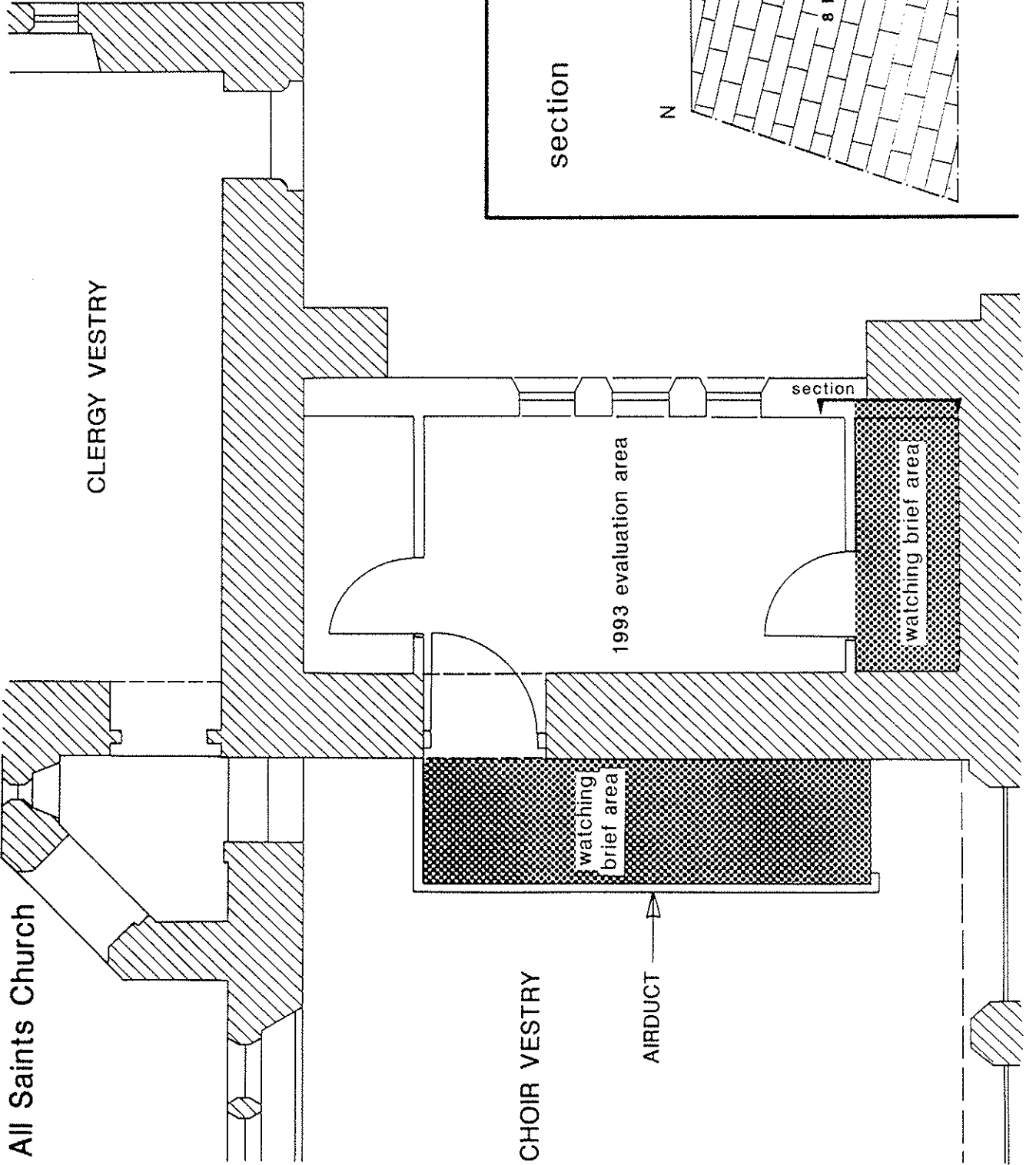

scale 1:50

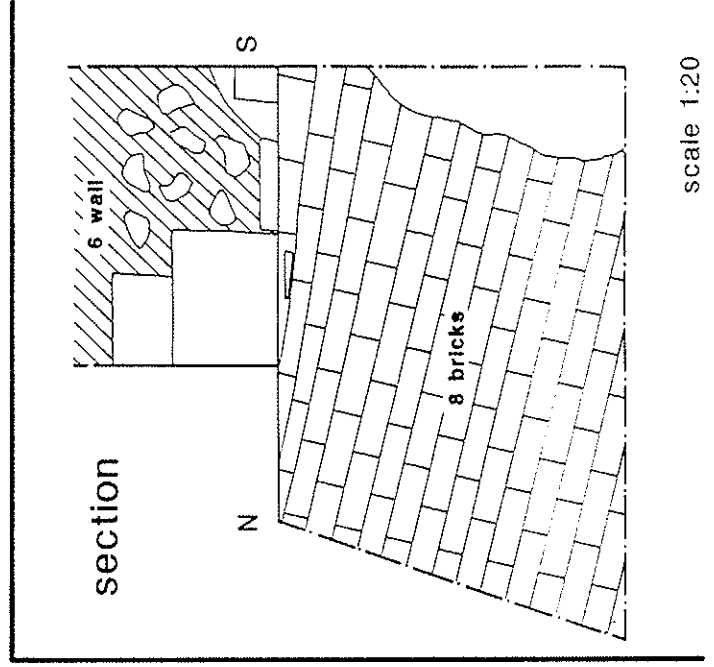

scale 1:20