

Cornbury Park Near Charlbury Oxfordshire



Archaeological Watching Brief Report



Oxford Archaeology

14th November 2002

Client Name: Cornbury Park Estate

Issue N^o: 1

OA Job N^o: 1469

Planning Ref N^o: W2000/0091.0092

NGR: SP 3509 1816

Client Name: Cornbury Park Estate
Client Ref No:
Document Title: Cornbury Park, near Charlbury, Oxfordshire
Document Type: Watching Brief
Issue Number: 1
National Grid Reference: NGR SP 3509 1816
Planning Reference: W2000/0091,0092
OA Job Number: 1469
Site Code: CHLOPA 02
Invoice Code: CHLOPAWB
Receiving Museum
Museum Accession No: 2002.179
Prepared by: James Mumford
Position: Supervisor
Date: 07th November 2002
Checked by: Jon Hiller
Position: Senior Project Manager
Date: 07th November 2002
Approved by: Nick Shepard
Position: Head of Fieldwork
Date: 07th November 2002
Document File Location U:/OAU/wbREPORTS/Oxfordshire/CHCOPA.doc
Graphics File Location Server 10(W):/OAUpubs 1/AtoH*C
codes*CHCOPAWB*Cornbury Park,
Charlbury*ACT*07.11.02
Illustrated by Amy Tucker

Signed. 

Disclaimer:

This document has been prepared for the titled project or named part thereof and should not be relied upon or used for any other project without an independent check being carried out as to its suitability and prior written authority of Oxford Archaeology being obtained. Oxford Archaeology accepts no responsibility or liability for the consequences of this document being used for a purpose other than the purposes for which it was commissioned. Any person/party using or relying on the document for such other purposes agrees, and will by such use or reliance be taken to confirm their agreement to indemnify Oxford Archaeology for all loss or damage resulting therefrom. Oxford Archaeology accepts no responsibility or liability for this document to any party other than the person/party by whom it was commissioned.

Oxford Archaeology

© Oxford Archaeological Unit Ltd 2002

Janus House

Osney Mead

Oxford OX2 0ES

t: (0044) 01865 263800

f: (0044) 01865 793496

e: info@oxfordarch.co.uk

w: www.oxfordarch.co.uk

Oxford Archaeological Unit Limited is a Registered Charity No: 285627

Cornbury Park, near Charlbury, Oxfordshire

ARCHAEOLOGICAL WATCHING BRIEF REPORT

CONTENTS

Summary.....	1
1 Introduction	1
1.1 Location and scope of work	1
1.2 Geology and topography	1
1.3 Archaeological and historical background	1
2 Project Aims and Methodology.....	2
2.1 Aims	2
2.2 Methodology.....	2
3 Results	2
3.1 Description of deposits	2
3.2 Finds	3
3.3 Palaeo-environmental remains	3
4 Discussion and Conclusions.....	3
Appendix 1 Archaeological Context Inventory	4
Appendix 2 Bibliography and References	4
Appendix 3 Summary of Site Details.....	4

LIST OF FIGURES

- Fig. 1 Site location
Fig. 2 Site plan
Fig. 3 Section 1

Cover Plate: View of the Pavilion from the south.

SUMMARY

In September and October 2002 Oxford Archaeology (OA) carried out an archaeological watching brief at Cornbury Estate Park, near Charlbury, Oxfordshire (NGR SP 3509 1816). The work was commissioned by Cornbury Park Estate in advance of construction of a new swimming pool. The watching brief revealed that prior to the construction of a sunken garden in the 19th century, the site was part of the driveway leading up to the front of the Cornbury Park House.

1 INTRODUCTION

1.1 Location and scope of work

1.1.1 In September and October 2002 Oxford Archaeology (OA) carried out an archaeological watching brief at Cornbury Park, near Charlbury, Oxfordshire (Fig. 1). The work was commissioned by Cornbury Park Estate in respect of a planning application for new swimming pool and ground works in the garden (Planning Application No. W2000/0091, 0092)

1.1.2 A project brief was set by Hugh Coddington the Deputy County Archaeological Officer for Oxfordshire County Council.

1.1.3 OA prepared a Written Scheme of Investigation detailing how it would meet the requirements of the brief (OA, 2002).

1.2 Geology and topography

1.2.1 The site lies on fine loam soils over Limestone/Tayton stone at 123 m above OD. The site is situated adjacent to Cornbury House, Cornbury Park, which lies southwest of the town of Charlbury.

1.3 Archaeological and historical background

1.3.1 The archaeological background to the watching brief was prepared for the WSI for the project (OA, 2002) and is reproduced below.

1.3.2 Cornbury House is a Grade I Listed building of late 16th century date and enlarged in 1632-3 by Nicholas Stone for Henry Danvers, the Earl of Derby. In 1337 it is referenced as a hunting lodge in the Royal Forest of Wychwood, "built of stone and timber" (Pevsner and Sherwood, 1974, 553-5). The building seems to have been demolished when the present structure was built.

1.3.3 The stables were built in 1663 and a chapel added in 1677. A wall creating an entrance court was added in 1689 (*ibid.*)

1.3.4 The site of the new swimming pool is situated on the site of a 19th century sunken garden. This was situated to the north of the east facade of the house and was surrounded by a Ha Ha wall with an ornate pavilion at the north end. The garden was decorated with a number of garden stone ornaments.

2 PROJECT AIMS AND METHODOLOGY

2.1 Aims

- 2.1.1 To identify and record the presence/absence, extent, condition, quality and date of archaeological remains in the areas affected by the development.
- 2.1.2 To make available the results of the archaeological investigation.

2.2 Methodology

- 2.2.1 First a trench was excavated around the south end of the proposed swimming pool to re-route a water pipe around the house. Then the area of the swimming pool was excavated with a 360⁰ machine (Fig. 2). The area was piled and then the concrete was poured. The drive in front of the east front of the house was graded for new drive.
- 2.2.2 All archaeological features were planned at a scale of 1:100 and where excavated their sections drawn at scales of 1:20. All excavated features were photographed using colour slide and black and white print film. A general photographic record of the work was made. Recording followed procedures detailed in the *OAU Fieldwork Manual* (ed D Wilkinson, 1992).

3 RESULTS

3.1 Description of deposits

Swimming Pool and Pipe Trench

- 3.1.1 The excavations for the swimming pool showed that the natural (7) was sealed below a 1 m thick layer (6) a series of thin dumps of silty clay loam over compacted layers of crushed stone and gravel. This was the remains of an earlier driveway to the house. Overlying this was a 0.7 m thick layer of yellowish brown silty clay (2) with lenses of limestone fragments and gravel. This was material used to build up the ground for the sunken garden. Cut into this was a large circular feature (3) with near vertical sides rounding to a flat base. It measured 2 m in diameter and 1.5 m in depth and contained a limestone soakaway (4) constructed in rough drystone courses on a compact rubble base. This had slowly silted up with dark greyish brown silty clay (5) (Fig. 3).
- 3.1.2 Two other features were observed, comprising a 20th century brick drain (8) and a 1.2 x 1.2 x 1m plinth of concrete and brick rubble (9) for a garden ornament (Figs 2). These were all sealed under a 0.4 m thick layer of dark brown silty clay loam topsoil (1).

New driveway

- 3.1.3 Where the area for a new driveway was stripped by the machine a 0.2-4 m thick layer of topsoil (1) overlying the combrash natural (7) was identified (not illustrated).

Ha Ha Wall repair

3.1.4 The Yew tree next to the Ha Ha wall was removed because of the root damage to the base of the wall. This revealed a 1.5 m wide wall constructed of rough limestone blocks bonded with a lime mortar and rubble core. This formed the solid base for the present tall west garden wall (Fig. 2).

3.2 Finds

3.2.1 No finds were recovered during the watching brief.

3.3 Palaeo-environmental remains

3.3.1 No deposits suitable for environmental sampling were identified during the watching brief.

4 DISCUSSION AND CONCLUSIONS

4.1.1 The results from the watching brief showed that prior to the construction of the 19th century sunken garden, the driveway ran up to the front of the house. In the 19th century stone retaining walls boxed in the area and the interior was filled with rubble and landscaped including foundations for garden monuments and accesses for services.

APPENDICES

APPENDIX 1 ARCHAEOLOGICAL CONTEXT INVENTORY

<i>Context</i>	<i>Type</i>	<i>Depth</i>	<i>Width</i>	<i>Length</i>	<i>Comments</i>	<i>Finds</i>
1	Layer	0.4 m			Topsoil	None
2	Layer				Garden make up	None
3	Cut	1.5 m	2 m	2 m	Cut for soakaway	
4	Structure	1.5 m	1.6 m		Stone soakaway	
5	Fill				Fill of soakaway	None
6	Layer				Old driveway	None
7	Natural					
8	Structure	1.4 m	0.5 m	0.5 m	Brick Drain	None
9	Structure	1 m	1.2 m	1.2 m	Plinth for garden ornament	

APPENDIX 2 BIBLIOGRAPHY AND REFERENCES

OA 1992 Fieldwork Manual, (Ed. D Wilkinson, first edition, August 1992)

OA 2002 *Land Adjacent to Cornbury Park Estate, near Charlbury, Oxfordshire* Written Scheme of Investigation

Geotechnical Engineering Ltd 2002 report of *Ground Investigation at Cornbury House, Charlbury, Oxfordshire*

Pevsner, N and Sherwood L. 1974 *Buildings of England, Oxfordshire*. Penguin.

APPENDIX 3 SUMMARY OF SITE DETAILS

Site name: Cornbury Park, near Charlbury, Oxfordshire

Site code: CHCOPA 02

Grid reference: NGR SP 3500 1816

Type of watching brief: Ground works for new swimming pool.

Date and duration of project: Five site visits from the 2/9/2002 to 14/10/2002.

Area of site: 22 m x 52 m

Summary of results: The watching brief revealed that prior to the 19th century sunken garden the area was part of the driveway up to the front of the house.

Location of archive: The archive is currently held at OA, Janus House, Osney Mead, Oxford, OX2 0ES, and will be deposited with Oxfordshire County Museums Service in due course, under the following accession number: 2002.179

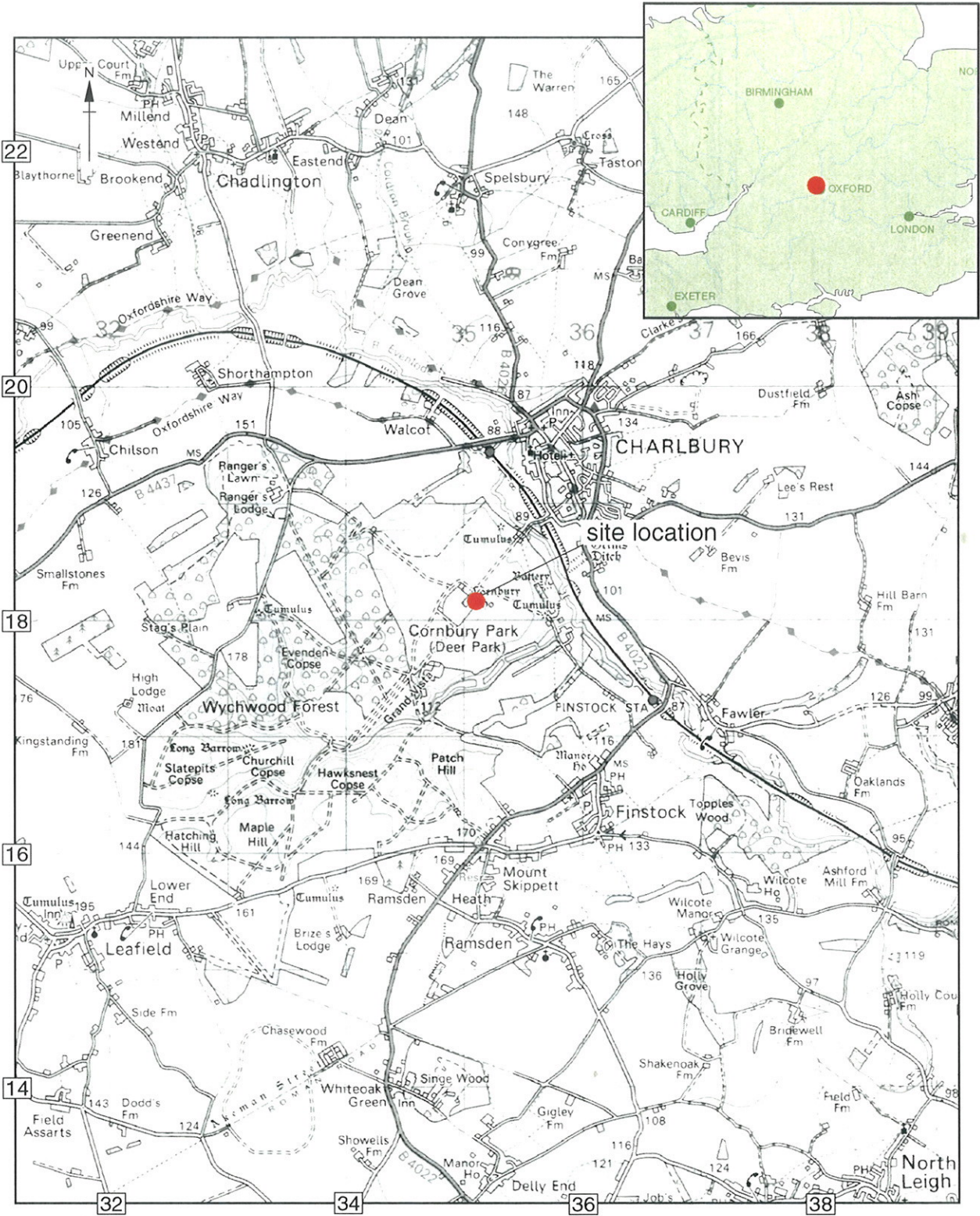

Scale 1:50,000

Reproduced from the Landranger 1:50,000 scale by permission of the Ordnance Survey on behalf of The Controller of Her Majesty's Stationery Office © Crown Copyright 1997. All rights reserved. Licence No. AL 100005569

Figure 1: Site location

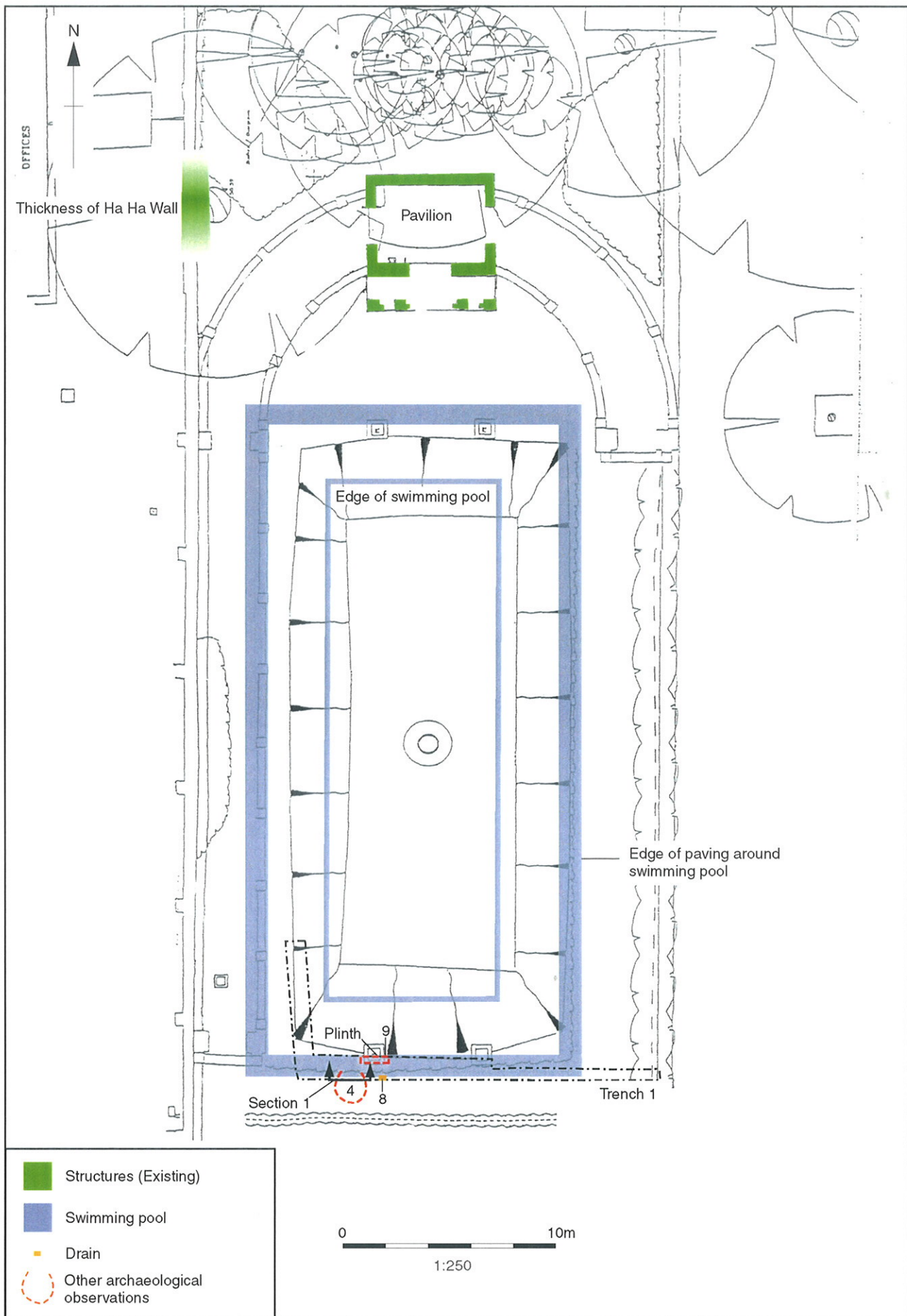

Figure 2: Site Plan

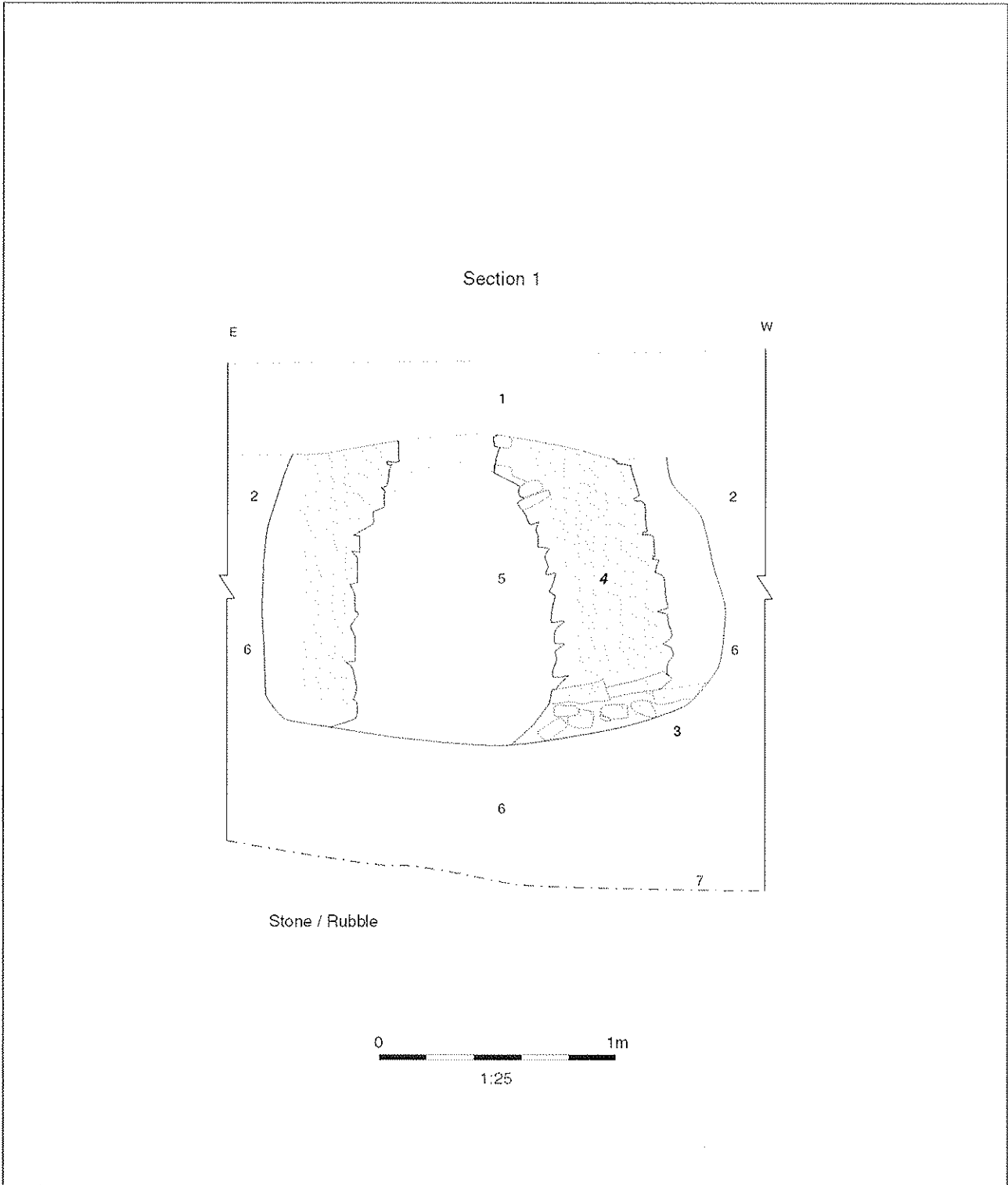

Figure 3: Section 1



Oxford Archaeology

Janus House
Osney Mead
Oxford OX2 0ES

t: (0044) 01865 263800
f: (0044) 01865 793496
e: info@oxfordarch.co.uk
w: www.oxfordarch.co.uk



Oxford Archaeology North

Storey Institute
Meeting House Lane
Lancaster LA1 1TF

t: (0044) 01524 848666
f: (0044) 01524 848606
e: lancinfo@oxfordarch.co.uk
w: www.oxfordarch.co.uk



Director: David Jennings, BA MIFA FSA

Oxford Archaeological Unit is a
Private Limited Company, N^o: 1618597
and a Registered Charity, N^o: 285627

Registered Office:

Oxford Archaeological Unit
Janus House, Osney Mead, Oxford OX2 0ES