

Site/Project Name: **Pinnocks Farm, Northmoor**
 Site Code: **NOPIFM10**
 Site/Project Type: **Archaeological Watching Brief**
 Year(s): **2010**
 Accession Number: **OXCMS:2010.103**

Record Group	Contents	Comments	Box/File Number
	INTRODUCTION OASIS Form Printout	2 sheets	Box 1 File 1
A	REPORT Archaeological Watching Brief Report	http://library.thehumanjourney.net/474/	Box 1 File 2
B	PRIMARY CONTEXT RECORDS Watching Brief Record	2 sheets	Box 1 File 3
B	CATALOGUE OF DRAWINGS Plan Record Sheet	1 sheet	Box 1 File 4
B	PRIMARY DRAWINGS A4 Plan	1 sheet	Box 1 File 5
D	CATALOGUE OF PHOTOGRAPHS Black and White Photographic Record Sheet Digital Photographic Record Sheet	1 sheet 1 sheet	Box 1 File 6

SCAN PDF

FILMING INSTRUCTIONS

Submitter OASouth

No. of CD copies: 3

Headings

Site information

Line 1: [OASouth] County:[Oxfordshire] Parish:[Northmoor] Site:[Pinnocks Farm]

Site code[NOPIFM 10]

Line 2: Excavators name[BEDFORD W]

Line 3:

Classification of material

Tick if present

Classification of material	Tick if present
Index to archive	<input checked="" type="checkbox"/>
Introduction	<input type="checkbox"/>
A:Final Report	<input type="checkbox"/>
A:Publication Report	<input type="checkbox"/>
B:Site Data – Text: Diary/Daybook/Fieldnotes	<input type="checkbox"/>
B: Site Data – Text: General Summaries	<input type="checkbox"/>
B: Site Data – Text: Primary Context Records	<input type="checkbox"/>
B: Site Data – Text: Synthesised Context Records	<input type="checkbox"/>
B: Site Data – Text: Survey Reports	<input type="checkbox"/>
B: Site Data – Text: Catalogue of Drawings	<input type="checkbox"/>
B: Site Data – Text: Primary Drawings	<input type="checkbox"/>
B: Site Data – Text: Synthesised Drawings	<input type="checkbox"/>
C: Finds Data – Text: Primary Finds Data	<input type="checkbox"/>
C: Finds Data – Text: Synthesised Finds Data	<input type="checkbox"/>
C: Finds Data – Text: Specialist Reports	<input type="checkbox"/>
C: Finds Data – Text: Box/Bag List	<input type="checkbox"/>
D: Catalogue of Photos/Slides/Videos/X--rays	<input type="checkbox"/>
E: Environmental/Ecofact Data: Primary Records	<input type="checkbox"/>
E: Environmental/Ecofact Data: Synthesised Records	<input type="checkbox"/>
E: Environmental/Ecofact Data: Specialist Reports	<input type="checkbox"/>
F: Documentary	<input type="checkbox"/>
F: Press and Publicity	<input type="checkbox"/>
G: Correspondence	<input type="checkbox"/>
H: Miscellaneous	<input type="checkbox"/>

NORTHMOOR, PINNOCKS FARM
NOPIFM10

Box 1 File 1

INTRODUCTION

--	--	--	--	--	--

SCAN PDF

FILMING INSTRUCTIONS

Submitter OASouth

No. of CD copies: 3

Headings

Site information

Line 1: [OASouth] County:[Oxfordshire] Parish:[Northmoor] Site:[Pinnocks Farm]

Site code[NOPIFM 10]

Line 2: Excavators name[BEDFORD W]

Line 3:

Classification of material

Tick if present

Index to archive	
Introduction	✓
A:Final Report	
A:Publication Report	
B:Site Data – Text: Diary/Daybook/Fieldnotes	
B: Site Data – Text: General Summaries	
B: Site Data – Text: Primary Context Records	
B: Site Data – Text: Synthesised Context Records	
B: Site Data – Text: Survey Reports	
B: Site Data – Text: Catalogue of Drawings	
B: Site Data – Text: Primary Drawings	
B: Site Data – Text: Synthesised Drawings	
C: Finds Data – Text: Primary Finds Data	
C: Finds Data – Text: Synthesised Finds Data	
C: Finds Data – Text: Specialist Reports	
C: Finds Data – Text: Box/Bag List	
D: Catalogue of Photos/Slides/Videos/X--rays	
E: Environmental/Ecofact Data: Primary Records	
E: Environmental/Ecofact Data: Synthesised Records	
E: Environmental/Ecofact Data: Specialist Reports	
F: Documentary	
F: Press and Publicity	
G: Correspondence	
H: Miscellaneous	

OASIS DATA COLLECTION FORM: England

[List of Projects](#) | [Manage Projects](#) | [Search Projects](#) | [New project](#) | [Change your details](#) | [HER coverage](#) | [Change country](#) | [Log out](#)

Printable version

OASIS ID: oxfordar1-92602

Project details

Project name	Northmoor, Pinnocks Farm
Short description of the project	On November 5-8th 2010, Oxford Archaeology (OA) carried out an archaeological watching brief at Pinnocks Farm, Northmoor, Oxfordshire (NGR: SP 412 029). The work was commissioned in advance of the construction of a new extension. The watching brief revealed modern disturbed ground and garden soils overlying natural gravel. No significant archaeology was observed.
Project dates	Start: 05-11-2010 End: 08-11-2010
Previous/future work	No / Not known
Any associated project reference codes	NOIFM10 - Sitecode
Any associated project reference codes	OXCMS:2010.103 - Museum accession ID
Type of project	Recording project
Current Land use	Other 5 - Garden
Monument type	NA None
Significant Finds	NA None
Investigation type	'Watching Brief'
Prompt	Direction from Local Planning Authority - PPS

Project location

Country	England
Site location	OXFORDSHIRE WEST OXFORDSHIRE NORTHMOOR Pinnocks Farm
Study area	72.00 Square metres
Site coordinates	SP 412 029 51.7228489811 -1.403475732240 51 43 22 N 001 24 12 W Point

Project creators

Name of Organisation	Oxford Archaeology
----------------------	--------------------

Project brief originator	No written brief was issued
Project design originator	Oxford Archaeology
Project director/manager	W, Bedford
Project supervisor	P. Leader
Project archives	
Physical Archive Exists?	No
Physical Archive recipient	Oxfordshire County Museum Service
Physical Archive ID	OXCMS:2010.103
Digital Archive recipient	Oxford Archaeology
Digital Archive ID	NOIFM10
Digital Contents	'Stratigraphic'
Digital Media available	'Images raster / digital photography','Text'
Paper Archive recipient	Oxfordshire County Museum Service
Paper Archive ID	OXCMS:2010.103
Paper Contents	'Stratigraphic'
Paper Media available	'Diary','Photograph','Plan','Report','Unpublished Text'

Project bibliography 1

Publication type	Grey literature (unpublished document/manuscript)
Title	Pinnocks Farm, Northmoor
Author(s)/Editor(s)	Leader, P
Date	2010
Issuer or publisher	Oxford Archaeology
Place of issue or publication	Oxford
Description	A4 bound client report
Entered by	Susan Rawlings (susan.rawlings@oxfordarch.co.uk)
Entered on	4 February 2011

OASIS:

NORTHMOOR, PINNOCKS FARM
NOIRMIØ

Box 1 File 2

A. FINAL REPORT.

--	--	--	--	--

SCAN PDF

FILMING INSTRUCTIONS

Submitter OASouth

No. of CD copies: 3

Headings

Site information

Line 1: [OASouth] County:[Oxfordshire] Parish:[Northmoor] Site:[Pinnocks Farm]

Site code[NOPIFM 10]

Line 2: Excavators name[BEDFORD W]

Line 3:

Classification of material

Tick if present

Classification of material	Tick if present
Index to archive	
Introduction	
A:Final Report	✓
A:Publication Report	
B:Site Data – Text: Diary/Daybook/Fieldnotes	
B: Site Data – Text: General Summaries	
B: Site Data – Text: Primary Context Records	
B: Site Data – Text: Synthesised Context Records	
B: Site Data – Text: Survey Reports	
B: Site Data – Text: Catalogue of Drawings	
B: Site Data – Text: Primary Drawings	
B: Site Data – Text: Synthesised Drawings	
C: Finds Data – Text: Primary Finds Data	
C: Finds Data – Text: Synthesised Finds Data	
C: Finds Data – Text: Specialist Reports	
C: Finds Data – Text: Box/Bag List	
D: Catalogue of Photos/Slides/Videos/X--rays	
E: Environmental/Ecofact Data: Primary Records	
E: Environmental/Ecofact Data: Synthesised Records	
E: Environmental/Ecofact Data: Specialist Reports	
F: Documentary	
F: Press and Publicity	
G: Correspondence	
H: Miscellaneous	

NORTH MOOR, PINNOCKS FARM
NOPIFM10

Box 1 File 3

B. PRIMARY CONTEXT RECORDS

--	--	--	--	--

SCAN PDF

FILMING INSTRUCTIONS

Submitter OASouth

No. of CD copies: 3

Headings

Site information

Line 1: [OASouth] County:[Oxfordshire] Parish:[Northmoor] Site:[Pinnocks Farm]

Site code[NOPIFM 10]

Line 2: Excavators name[BEDFORD W]

Line 3:

Classification of material

Tick if present

Index to archive	
Introduction	
A:Final Report	
A:Publication Report	
B:Site Data – Text: Diary/Daybook/Fieldnotes	
B: Site Data – Text: General Summaries	
B: Site Data – Text: Primary Context Records	✓
B: Site Data – Text: Synthesised Context Records	
B: Site Data – Text: Survey Reports	
B: Site Data – Text: Catalogue of Drawings	
B: Site Data – Text: Primary Drawings	
B: Site Data – Text: Synthesised Drawings	
C: Finds Data – Text: Primary Finds Data	
C: Finds Data – Text: Synthesised Finds Data	
C: Finds Data – Text: Specialist Reports	
C: Finds Data – Text: Box/Bag List	
D: Catalogue of Photos/Slides/Videos/X--rays	
E: Environmental/Ecofact Data: Primary Records	
E: Environmental/Ecofact Data: Synthesised Records	
E: Environmental/Ecofact Data: Specialist Reports	
F: Documentary	
F: Press and Publicity	
G: Correspondence	
H: Miscellaneous	



WATCHING BRIEF RECORD

SITE CODE *NO11EM10*

SITE NAME *Pinnacles Farm, Northmoor.*

DATE *5/11/16.*

NGR

County *Oxon.*

Start Time

2.00

Finish Time

4.00

Milage *24.*

Previous Visit *—*

Visit By *P. Leader*

Type of construction work *Footings for extension.*

Contacts made

Archaeology present?

Yes:

No:

Undated:

Other:

COMMENTS

- Visit from contractor on site. Has stopped all work as planning inform them they need arch. on site.
- C. 60% of trenches have already been dug and backfilled with concrete. C. 0.5-0.6m visible of modern tarmac made ground visible above concrete. Ground seems disturbed previously. Mid-brown-grey clay-silt, CBM & Brick inclusions.
- Monitor excavation 1 more trench. C. 0.6m of same material seen elsewhere then compacted yellow gravel sand natural. No archaeology.
- 360° 1.6m digger used with hooked bucket & lower excavation. Trenches low below current ground level.

Records? *Digi slots.*



WATCHING BRIEF RECORD

SITE CODE *NOPIENLO*

SITE NAME *Pinnocks Farm Northmoor*

DATE *5/11/10*

NGR

County *OXON*

Start Time

08.00

Finish Time

Milage *24.*

Previous Visit *5/11/10*

Visit By *P. Leader*

Type of construction work
Footings for extension.

Contacts made

Archaeology present?

Yes:

No:

Undated:

Other:

COMMENTS

- Continued excavation of footings, 360' i-b ton with 30mm toothed bucket + hand digging.
- Trench excavated to c. 1m.
- Same material excavated as 5/11/10, distributed to spread made ground. No archaeology.

Sample section, not to scale.

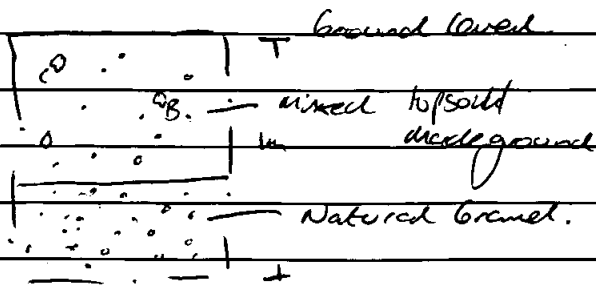

Records? *Digi + SLR 8200. Plan of trench location*

NORTHMOOR, PINNOCKS FARM
NOPIFM10

Box 1 File 4

B. CATALOGUE OF DRAWINGS

--	--	--	--	--	--

SCAN PDF

FILMING INSTRUCTIONS

Submitter OASouth

No. of CD copies: 3

Headings

Site information

Line 1: [OASouth] County:[Oxfordshire] Parish:[Northmoor] Site:[Pinnocks Farm]

Site code[NOPIFM 10]

Line 2: Excavators name[BEDFORD W]

Line 3:

Classification of material

Tick if present

Classification of material	Tick if present
Index to archive	
Introduction	
A:Final Report	
A:Publication Report	
B:Site Data – Text: Diary/Daybook/Fieldnotes	
B: Site Data – Text: General Summaries	
B: Site Data – Text: Primary Context Records	
B: Site Data – Text: Synthesised Context Records	
B: Site Data – Text: Survey Reports	
B: Site Data – Text: Catalogue of Drawings	✓
B: Site Data – Text: Primary Drawings	
B: Site Data – Text: Synthesised Drawings	
C: Finds Data – Text: Primary Finds Data	
C: Finds Data – Text: Synthesised Finds Data	
C: Finds Data – Text: Specialist Reports	
C: Finds Data – Text: Box/Bag List	
D: Catalogue of Photos/Slides/Videos/X--rays	
E: Environmental/Ecofact Data: Primary Records	
E: Environmental/Ecofact Data: Synthesised Records	
E: Environmental/Ecofact Data: Specialist Reports	
F: Documentary	
F: Press and Publicity	
G: Correspondence	
H: Miscellaneous	

NORTH MOOR, PINNOCKS FARM
NOPIFM10
Box 1 Files
B. PRIMARY DRAWINGS

--	--	--	--	--

SCAN PDF

FILMING INSTRUCTIONS

Submitter OASouth

No. of CD copies: 3

Headings

Site information

Line 1: [OASouth] County:[Oxfordshire] Parish:[Northmoor] Site:[Pinnocks Farm]

Site code[NOPIFM 10]

Line 2: Excavators name[BEDFORD W]

Line 3:

Classification of material

Tick if present

Index to archive	
Introduction	
A:Final Report	
A:Publication Report	
B:Site Data – Text: Diary/Daybook/Fieldnotes	
B: Site Data – Text: General Summaries	
B: Site Data – Text: Primary Context Records	
B: Site Data – Text: Synthesised Context Records	
B: Site Data – Text: Survey Reports	
B: Site Data – Text: Catalogue of Drawings	
B: Site Data – Text: Primary Drawings	✓
B: Site Data – Text: Synthesised Drawings	
C: Finds Data – Text: Primary Finds Data	
C: Finds Data – Text: Synthesised Finds Data	
C: Finds Data – Text: Specialist Reports	
C: Finds Data – Text: Box/Bag List	
D: Catalogue of Photos/Slides/Videos/X--rays	
E: Environmental/Ecofact Data: Primary Records	
E: Environmental/Ecofact Data: Synthesised Records	
E: Environmental/Ecofact Data: Specialist Reports	
F: Documentary	
F: Press and Publicity	
G: Correspondence	
H: Miscellaneous	

N ←

New footings
Trenches dug +
Concrete poured
Prior to visit.

Trenches dug when present

N011Fm10
P. 1
Location of
Foundation Trenches
1:50
Pz 8/11/10

Existing Farm House
C. 1700

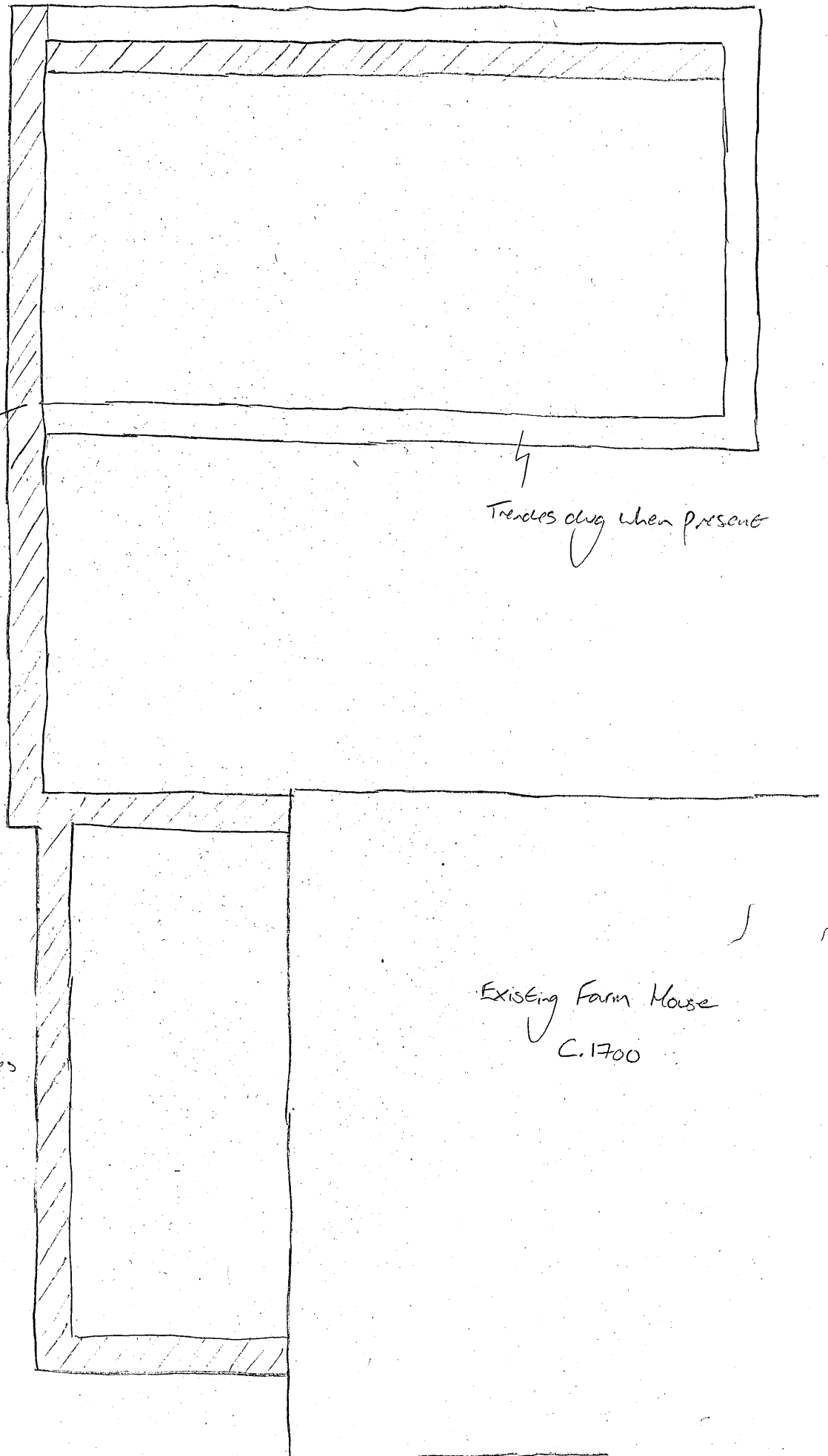
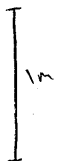

NORTHMOOR, PINNOCKS FARM
NOPIFM10

Box 1 File 6

D. CATALOGUE OF PHOTOGRAPHS

--	--	--	--	--

SCAN PDF

FILMING INSTRUCTIONS

Submitter OASouth

No. of CD copies: 3

Headings

Site information

Line 1: [OASouth] County:[Oxfordshire] Parish:[Northmoor] Site:[Pinnocks Farm]

Site code[NOPIFM 10]

Line 2: Excavators name[BEDFORD W]

Line 3:

Classification of material

Tick if present

Classification of material	Tick if present
Index to archive	
Introduction	
A:Final Report	
A:Publication Report	
B:Site Data – Text: Diary/Daybook/Fieldnotes	
B: Site Data – Text: General Summaries	
B: Site Data – Text: Primary Context Records	
B: Site Data – Text: Synthesised Context Records	
B: Site Data – Text: Survey Reports	
B: Site Data – Text: Catalogue of Drawings	
B: Site Data – Text: Primary Drawings	
B: Site Data – Text: Synthesised Drawings	
C: Finds Data – Text: Primary Finds Data	
C: Finds Data – Text: Synthesised Finds Data	
C: Finds Data – Text: Specialist Reports	
C: Finds Data – Text: Box/Bag List	
D: Catalogue of Photos/Slides/Videos/X--rays	✓
E: Environmental/Ecofact Data: Primary Records	
E: Environmental/Ecofact Data: Synthesised Records	
E: Environmental/Ecofact Data: Specialist Reports	
F: Documentary	
F: Press and Publicity	
G: Correspondence	
H: Miscellaneous	



PHOTOGRAPHIC RECORD SHEET

SITE CODE *NOPIFM 10*

SITE NAME *Pinnock Farm, Northmoor*

FILM NO. *1*

Camera number

Lens number

Black & white / ~~colour~~

Date	Negative number	View	Context(s)	Initials
<i>8/11/10</i>	<i>0</i>	<i>-</i>	<i>ID Shot</i>	<i>PC</i>
	<i>1</i>	<i>N</i>	<i>General Working/Trench Shots</i>	
	<i>2</i>	<i>N</i>		
	<i>3</i>	<i>SW</i>		
	<i>4</i>	<i>N</i>		
	<i>5</i>	<i>SW</i>		
	<i>6</i>	<i>SW</i>		
	<i>7</i>	<i>SE</i>		
	<i>8</i>	<i>SE</i>		
	<i>9</i>			
	<i>10</i>			
	<i>11</i>			
	<i>12</i>			
	<i>13</i>			
	<i>14</i>			
	<i>15</i>			
	<i>16</i>			
	<i>17</i>			
	<i>18</i>			
	<i>19</i>			
	<i>20</i>			
	<i>21</i>			
	<i>22</i>			
	<i>23</i>			
	<i>24</i>			
	<i>25</i>			
	<i>26</i>			
	<i>27</i>			
	<i>28</i>			
	<i>29</i>			
	<i>30</i>			
	<i>31</i>			
	<i>32</i>			
	<i>33</i>			
	<i>34</i>			
	<i>35</i>			
	<i>36</i>			
	<i>37</i>			

Sheet1

	A	B	C	D	E
1	Site Code: NOPLFM10		Site Name: Northmoor, Pinnocks Farm		
2	Site shot	Archive Shot			
3	Number	Number	View	Description	Initials
4	0001	0001	N	General site / trench shot	PL
5	0002	0002	S	General site / trench shot	PL
6	0003	0003	SW	General site / trench shot	PL
7	0004	0004	S	General site / trench shot	PL
8	0005	0005	SW	General site / trench shot	PL
9	0006	0006	S	General site / trench shot	PL
10	0007	0007	N	General site / trench shot	PL
11	0008	0008	SW	General site / trench shot	PL
12	0009	0009	NW	General site / trench shot	PL
13	0010	0010	NW	General site / trench shot	PL
14	0011	0011	N	General site / trench shot	PL
15	0012	0012	SE	General site / trench shot	PL
16					
17					
18					
19					
20					
21					
22					
23					
24					
25					
26					
27					
28					
29					
30					
31					
32					
33					
34					
35					
36					
37					
38					
39					
40					
41					
42					
43					
44					
45					
46					
47					
48					