

Figure 2.1: Fluxgate magnetometer survey

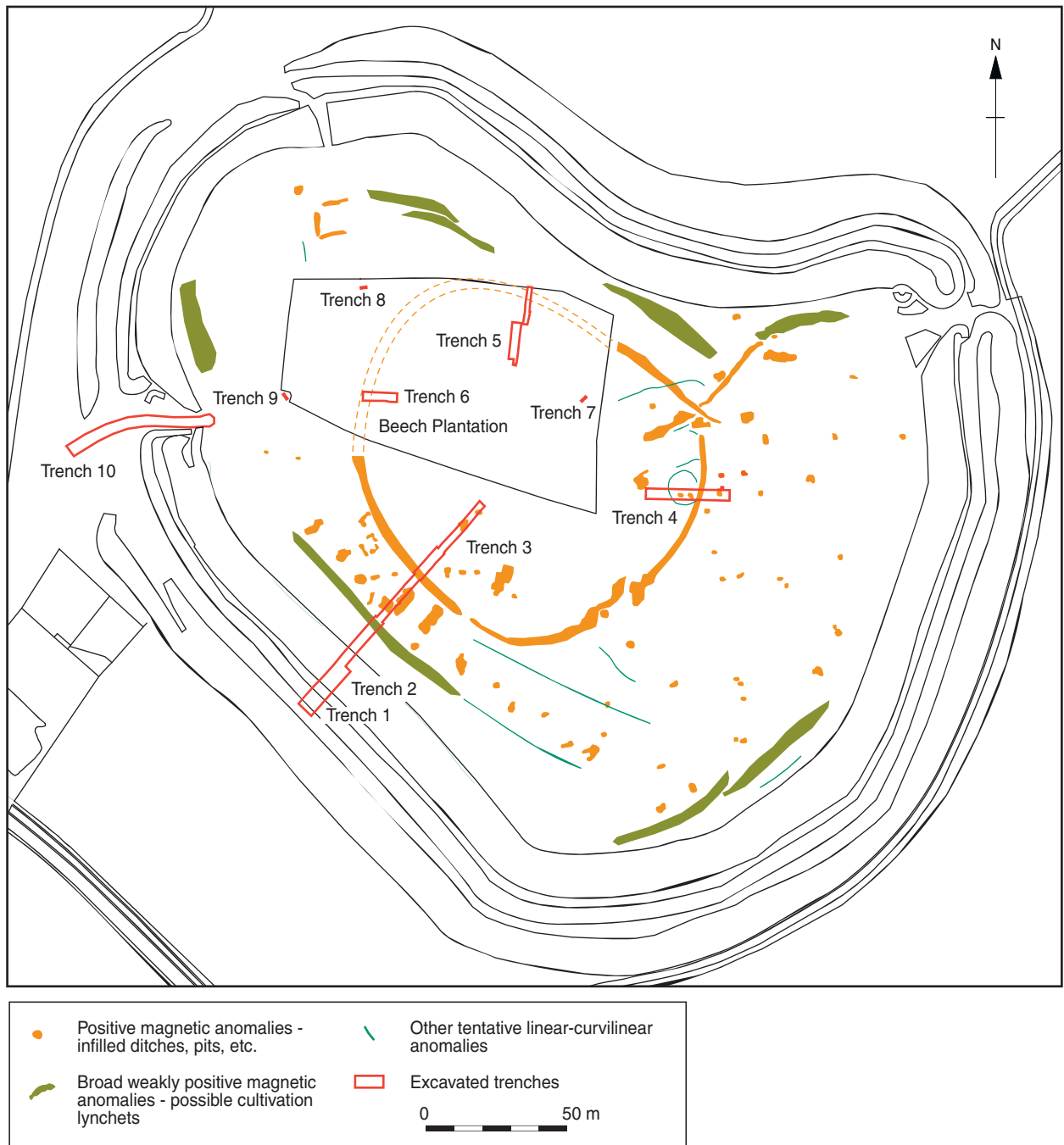
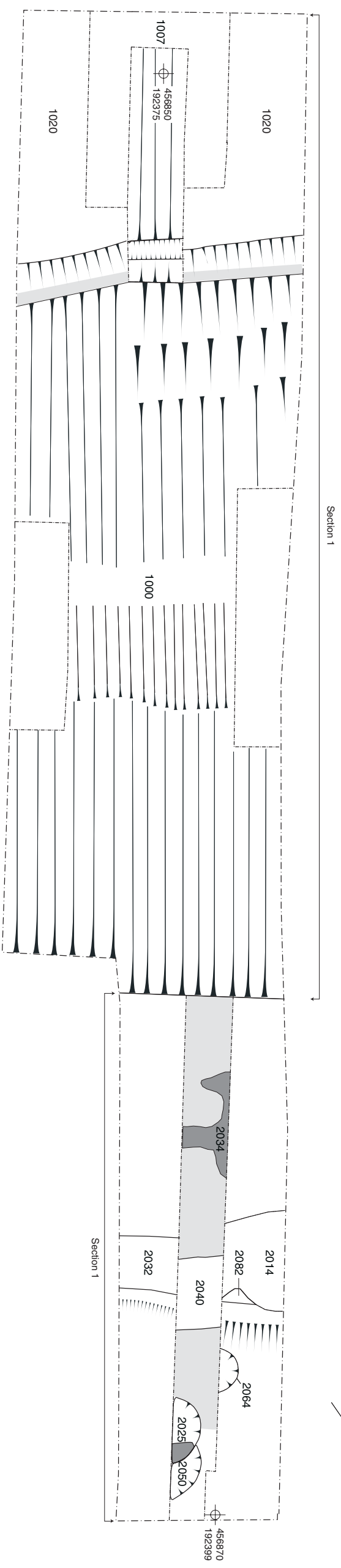

Figure 2.2: Location of trenches and geophysical survey

Trench 1 and 2
Plan



Section 1

(Section reversed)

NE

SW



114 mOD

Counterscarp bank



Figure 2.3: Plan and section of Trenches 1 and 2

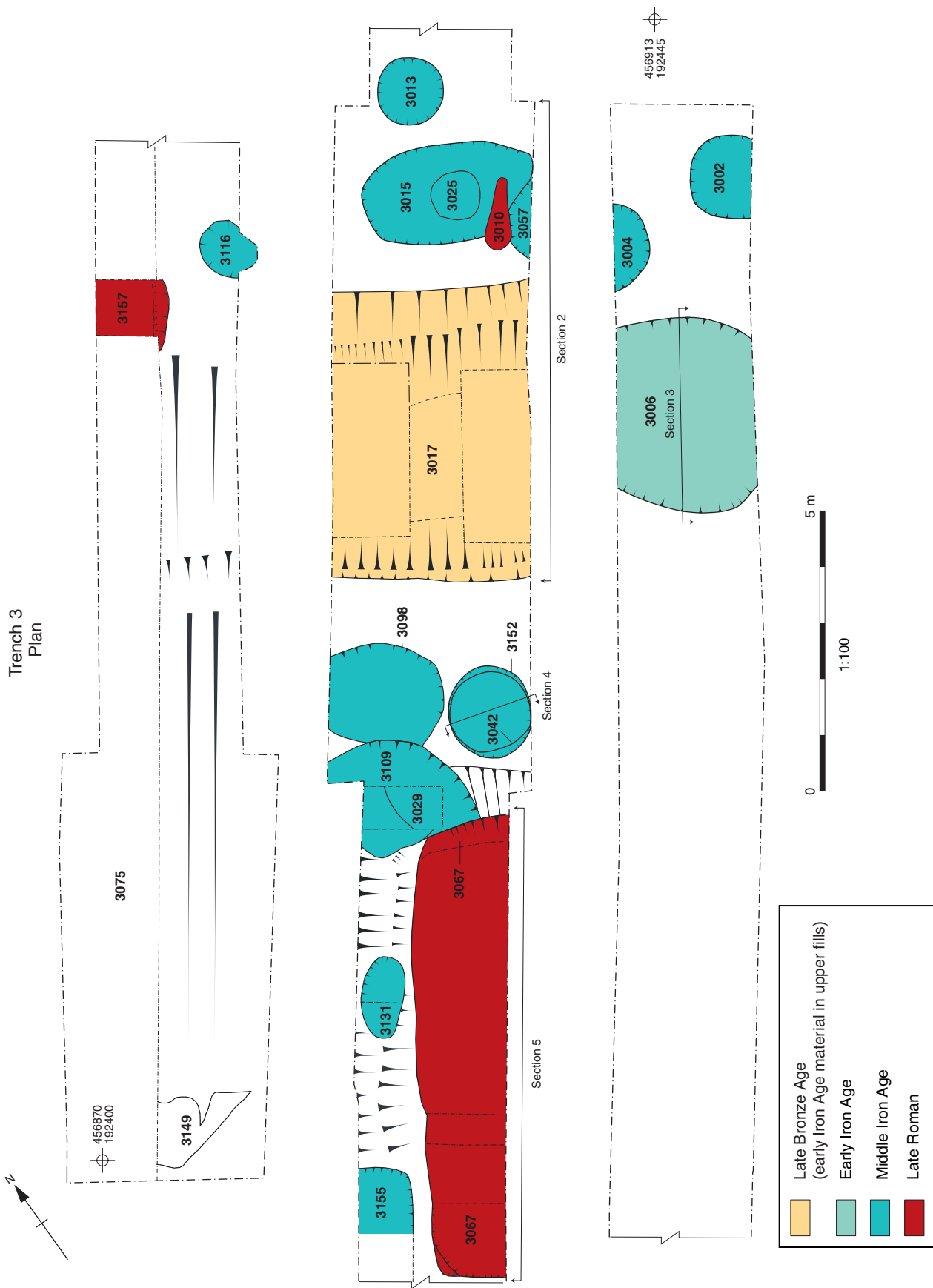

Figure 2.4: Plan of Trench 3

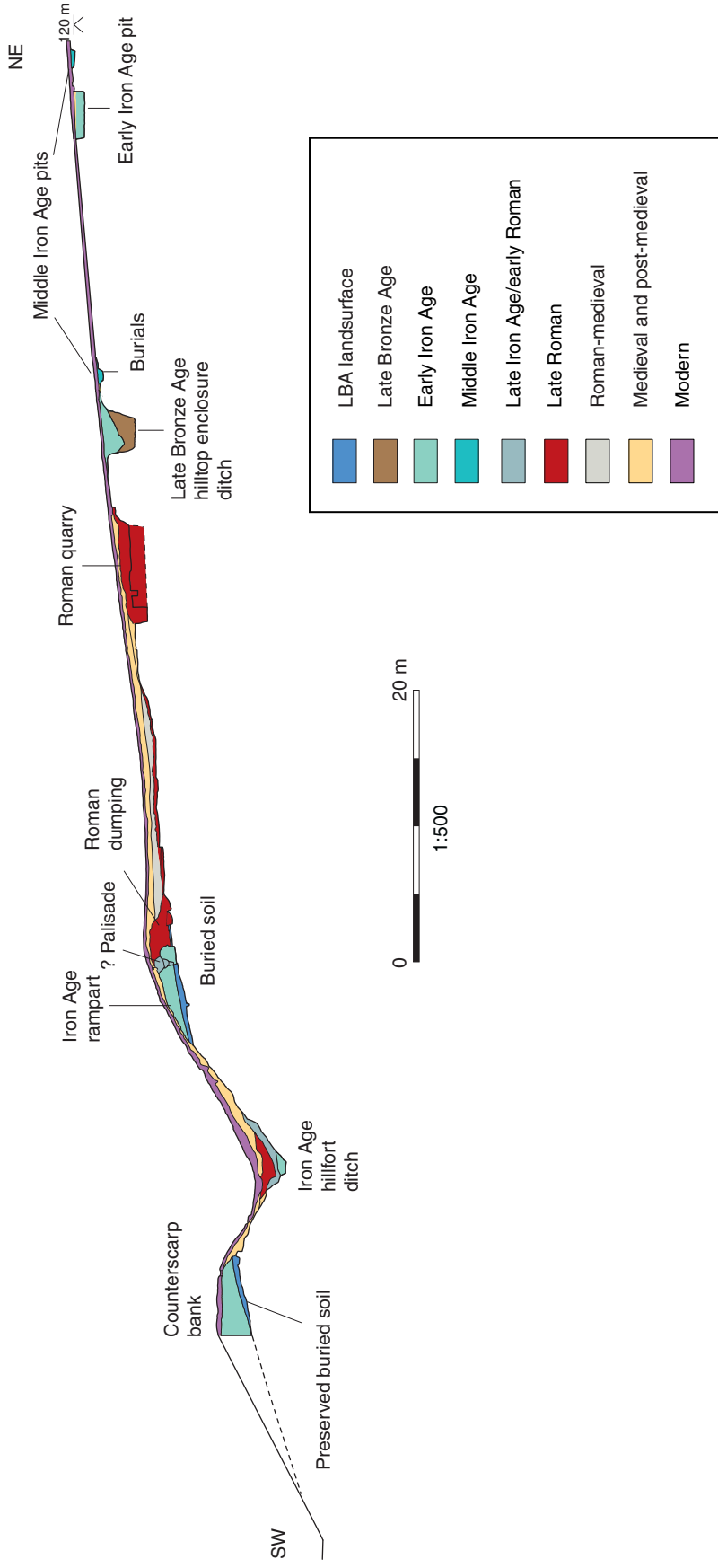

Figure 2.5: Schematic section of Trenches 1, 2 and 3 with phasing

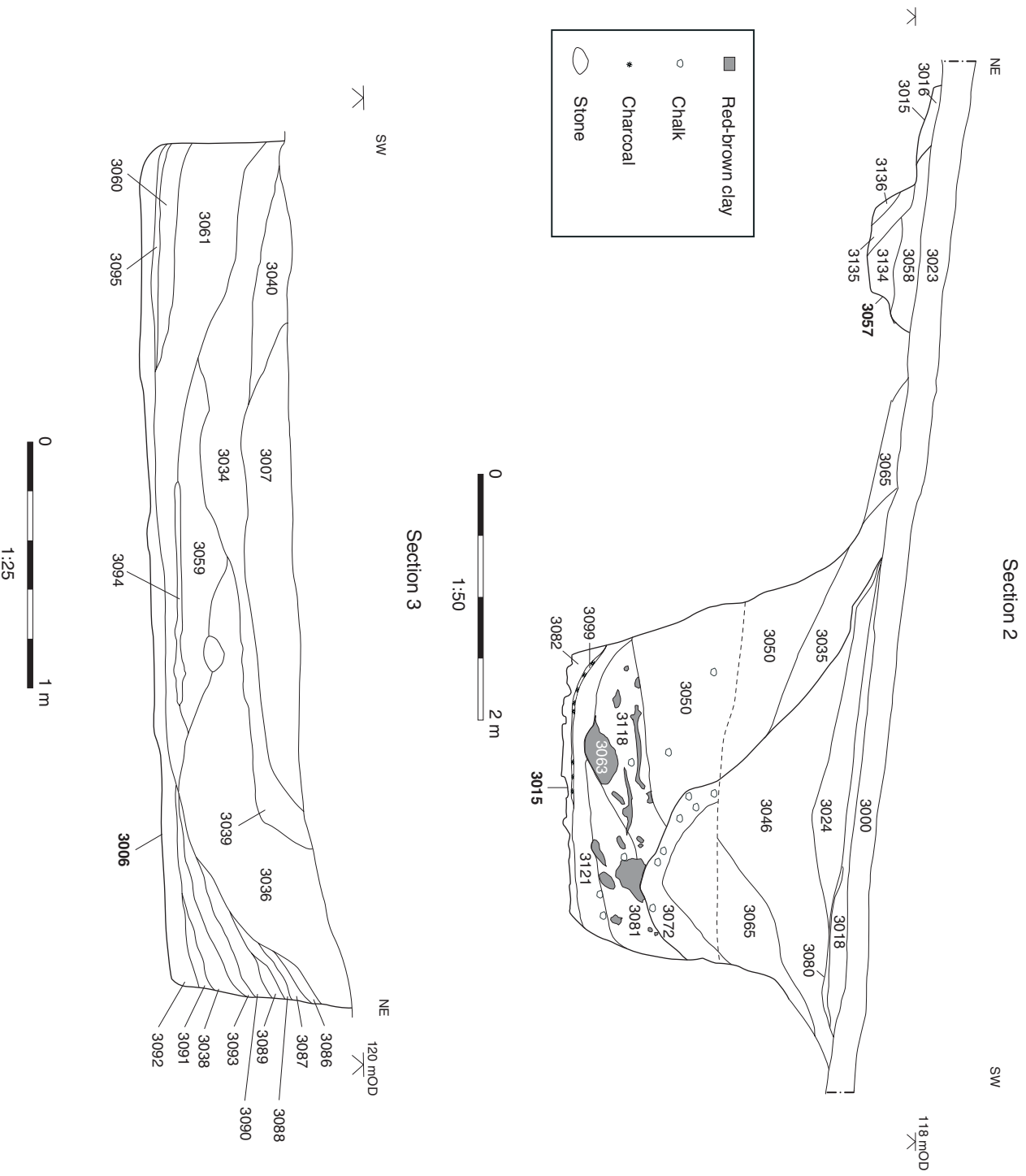
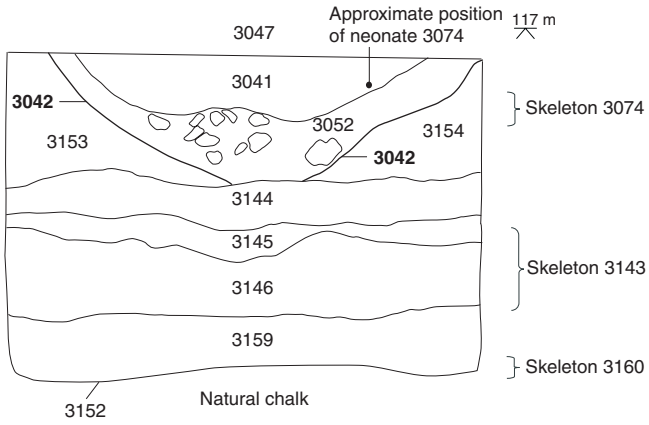
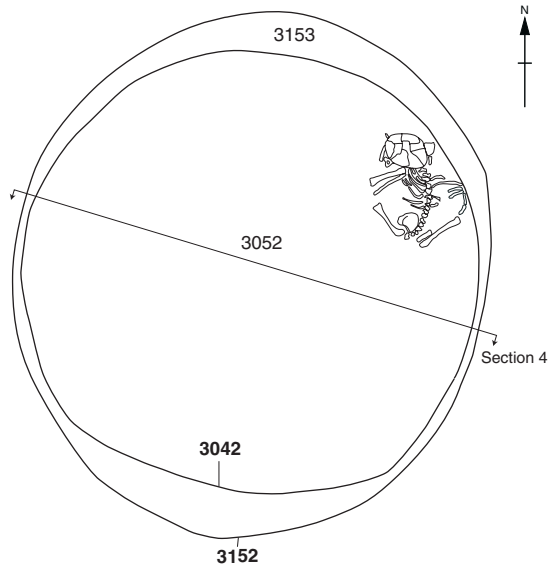

Figure 2.6: Sections of Late Bronze Age ditch 3017, early Iron Age pit 3006 and middle Iron Age pits 3015 and 3057

Section 4



Neonate 3074



Skeleton 3143

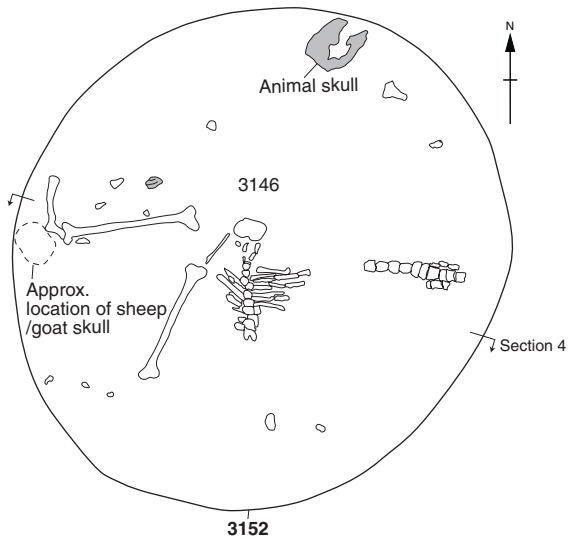

Skeleton 3160

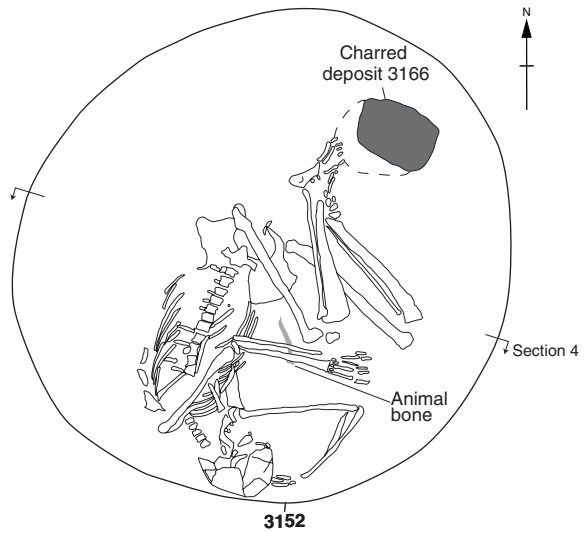

- Animal bone
- Charred deposit



Figure 2.7: Middle Iron Age burials, pit 3152

Skeleton 3048

Skeleton 3113

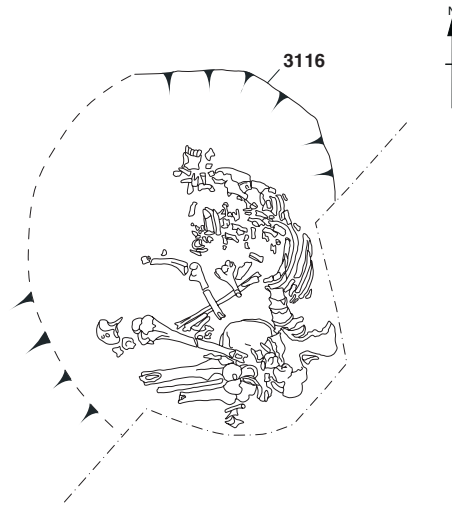
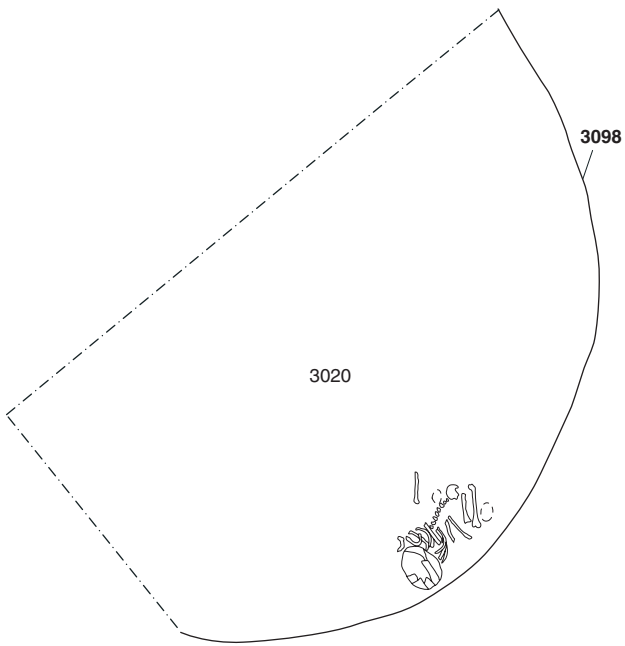

Skeleton 3183

Skeleton 3012

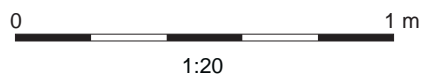
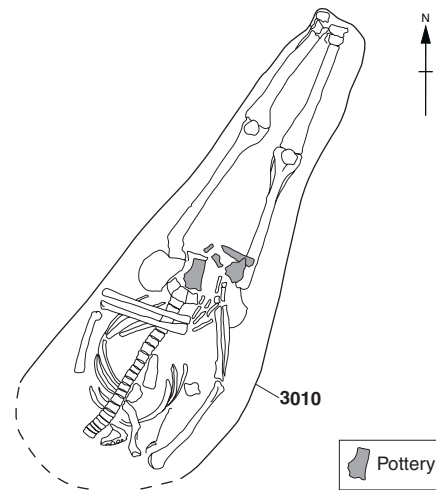
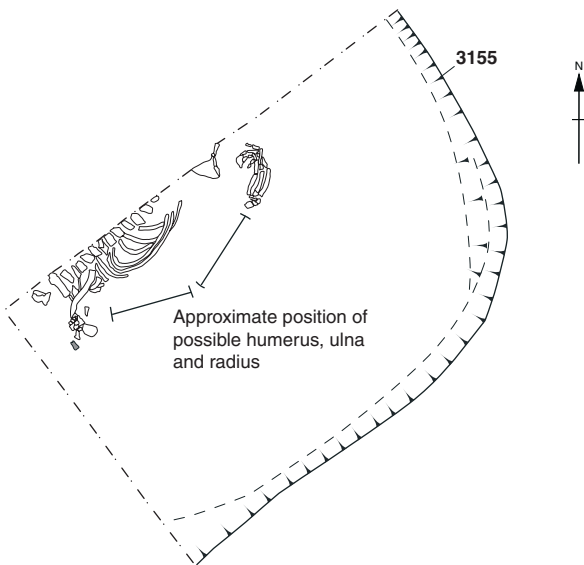

Figure 2.8: Plans of middle Iron Age burials 3048, 3113 and 3183 and Roman burial 3012

Section 5

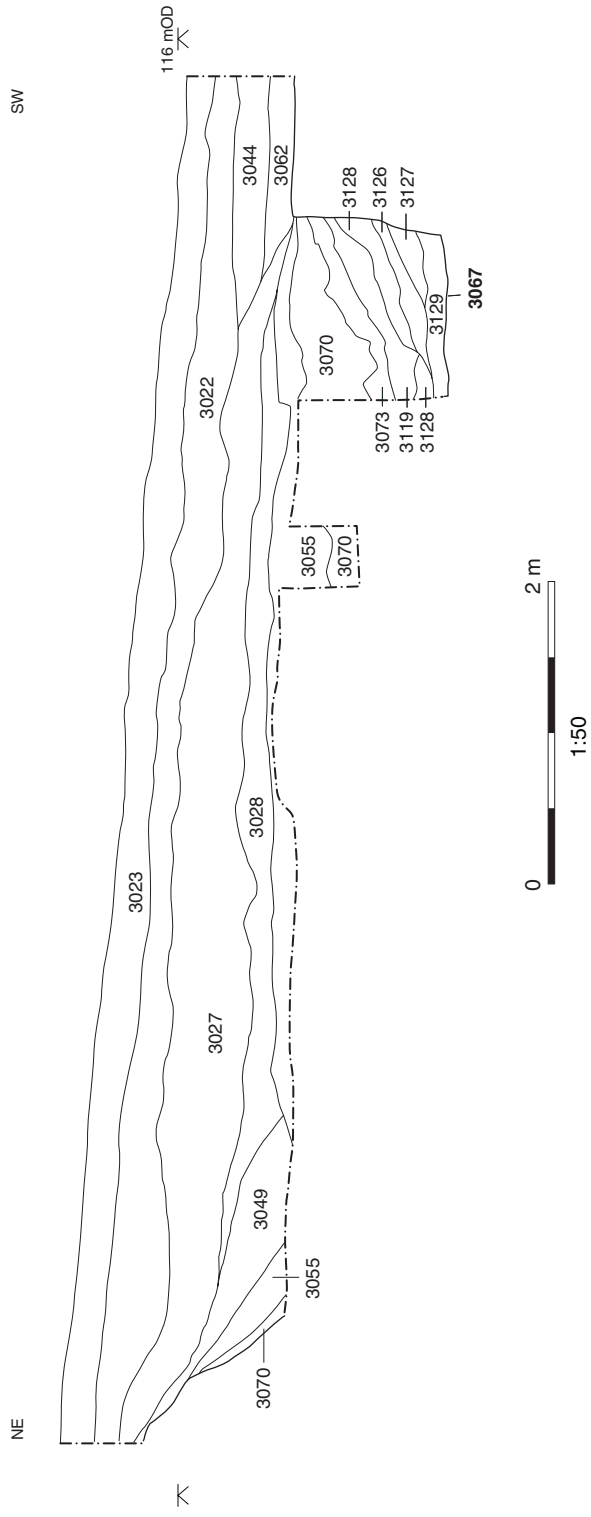
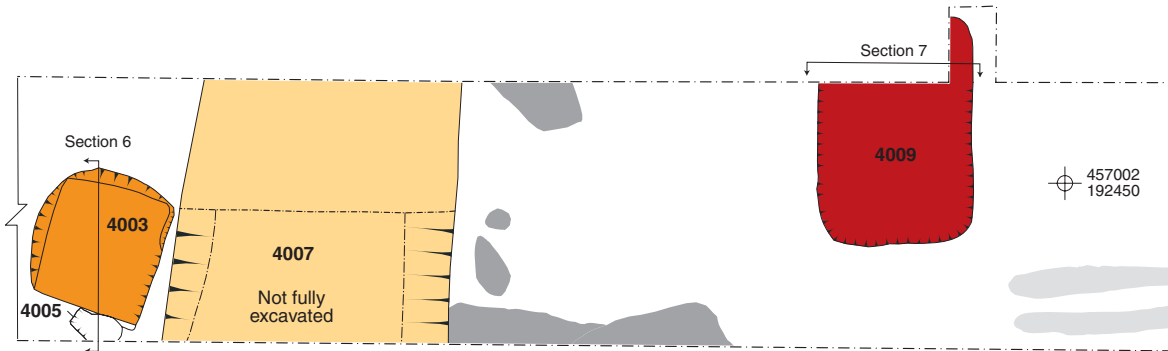
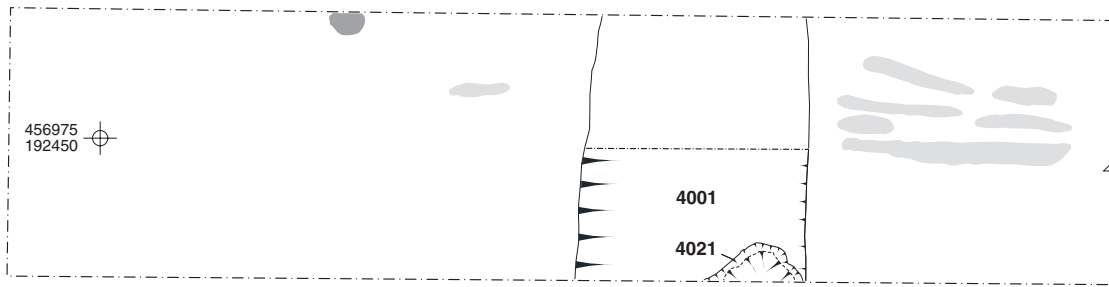

Figure 2.9: Section of late Roman pit 3067

Trench 4
Plan



0 5 m

1:100

Section 6

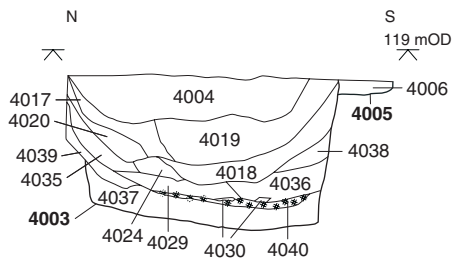

Section 7

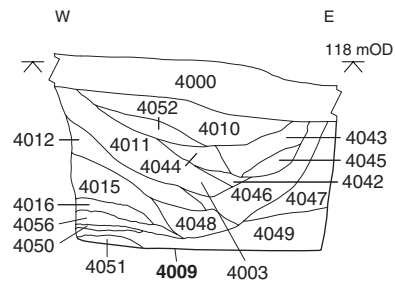

0 2 m

1:50

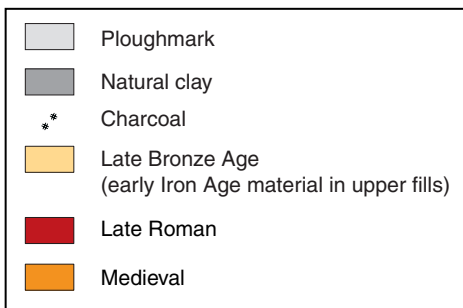

Figure 2.10: Plan of Trench 4 and sections of pits 4003 and 4009

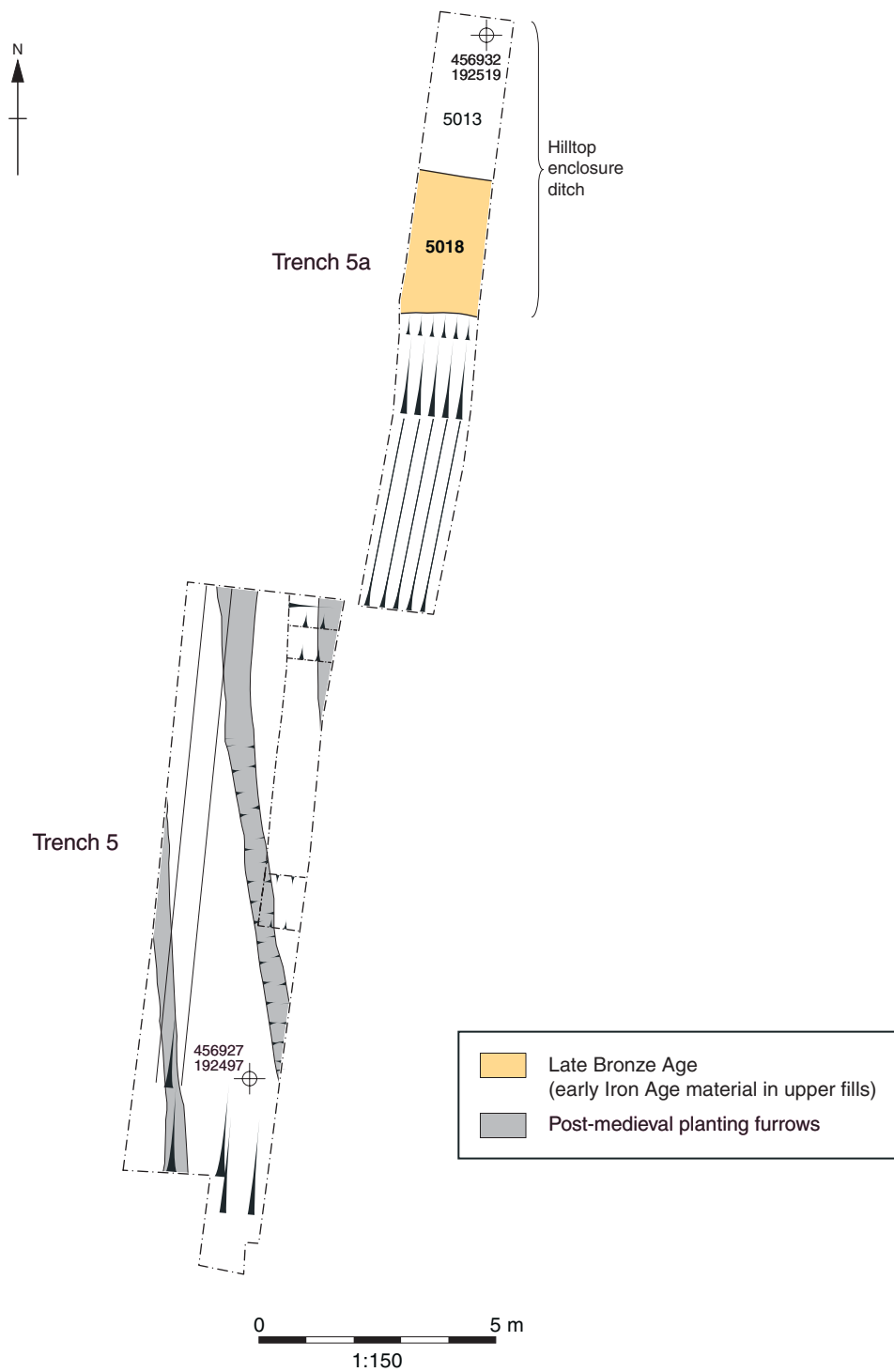

Figure 2.11: Plan of Trench 5

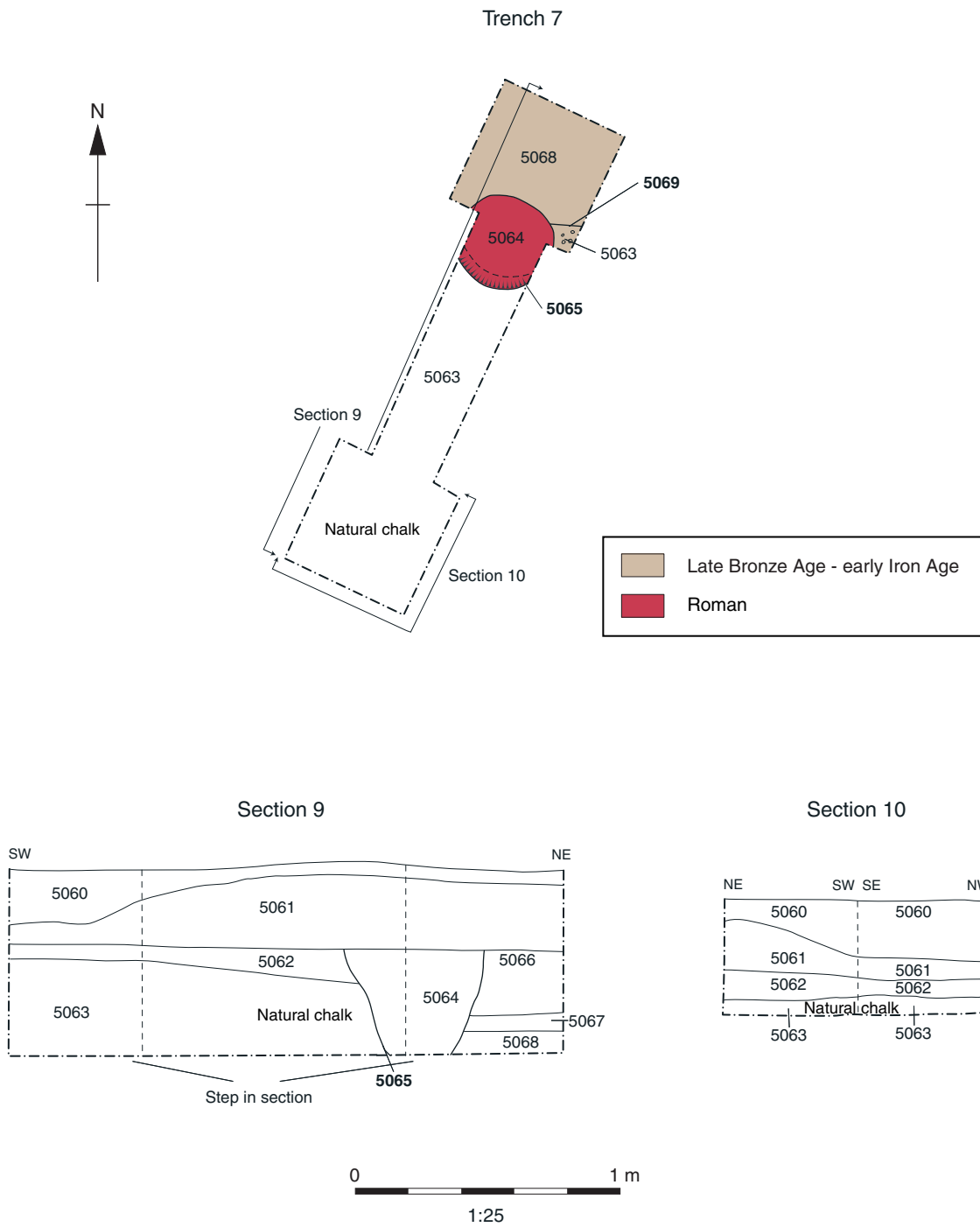

Figure 2.13: Plan and sections of Trench 7

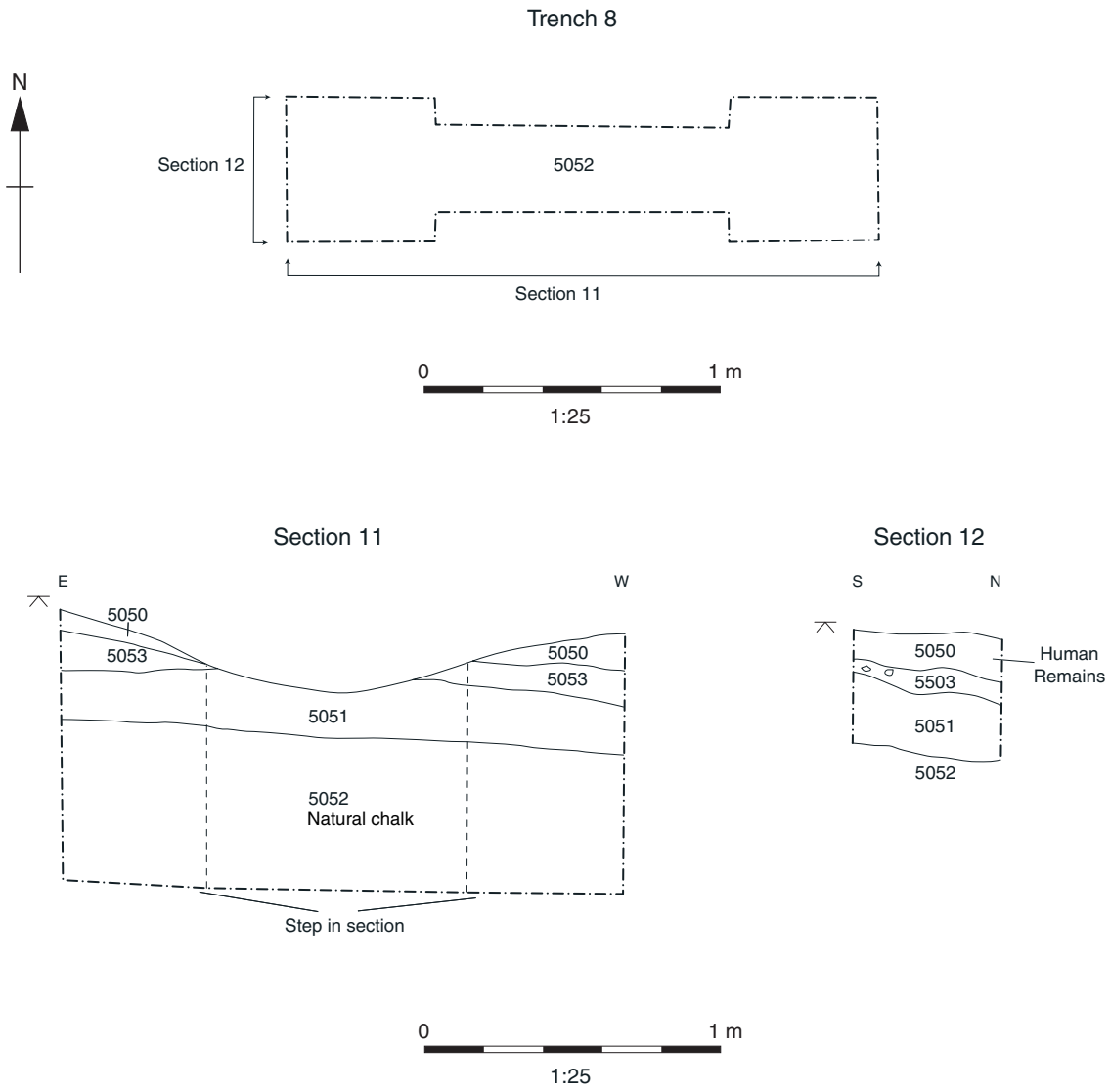

Figure 2.14: Plan and sections of Trench 8

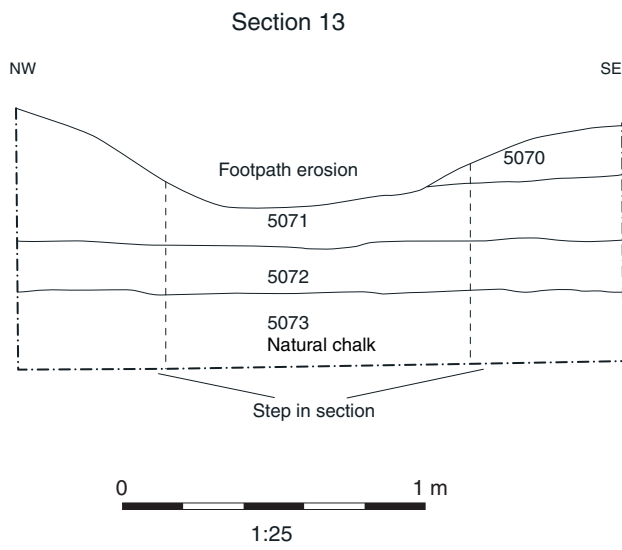
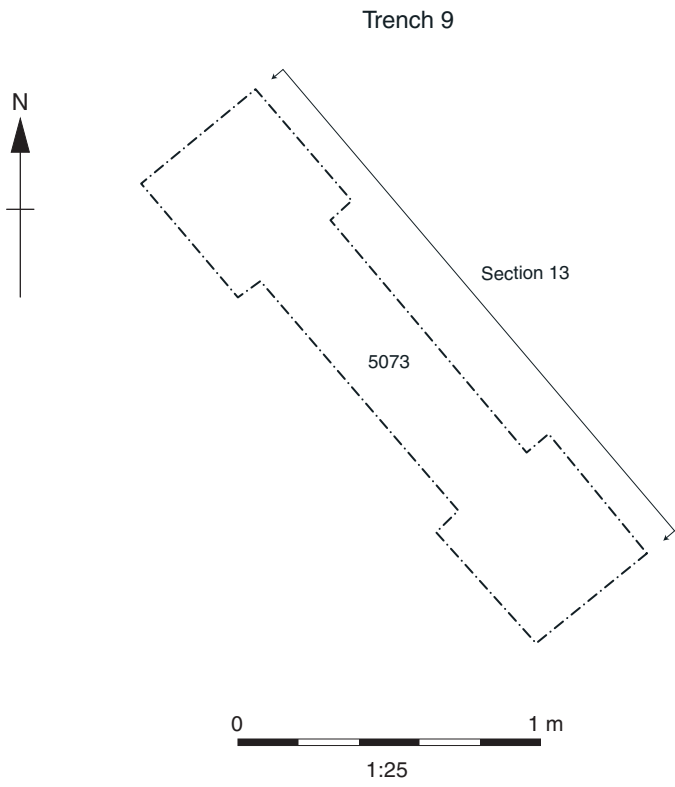

Figure 2.15: Plan and section of Trench 9



Figure 2.16: Plan and section of Trench 10

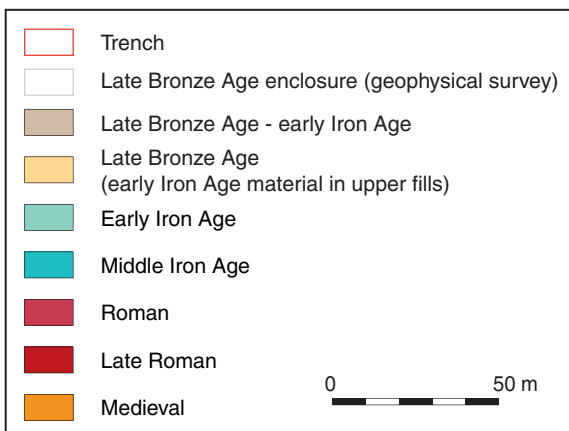
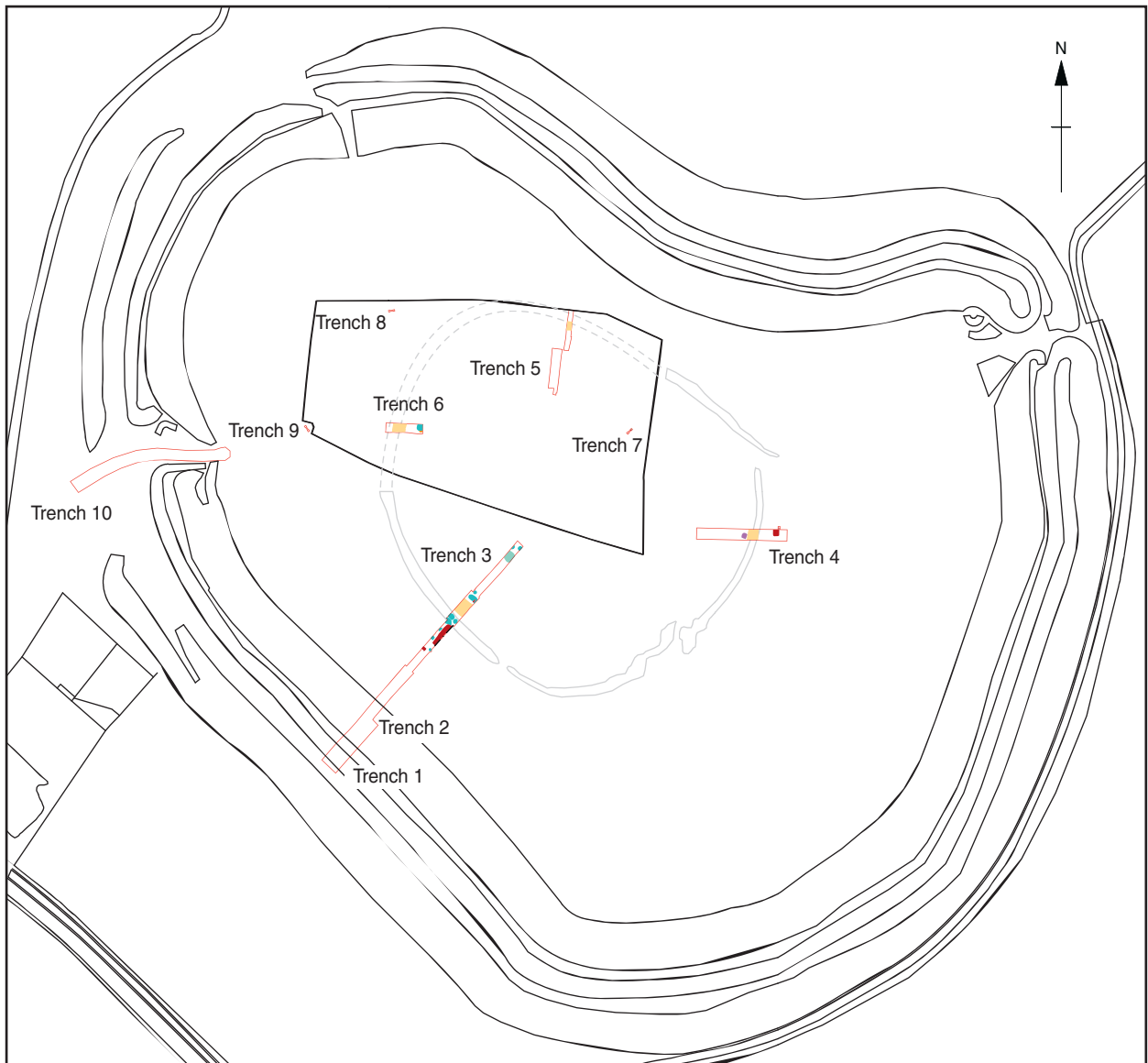

Figure 2.17: Overall phase plan