



STATION STREET, COCKERMOUTH, Cumbria

Archaeological Desk- Based Assessment and Watching Brief



Oxford Archaeology North

January 2006

Architects Plus

Issue No: 2005-6/474

OA North Job No: L9408

NGR: NY 3120 3056

Planning Application No:
2/03/1170

Document Title: STATION STREET, COCKERMOUTH, CUMBRIA
Document Type: Archaeological Desk-Based Assessment and Watching Brief
Client Name: Architects Plus

Issue Number: 2005-6/474
OA Job Number: L9408
National Grid Reference: NY 3120 3056

Prepared by:	Louise Ford	Steve Clarke
Position:	Assistant Supervisor	Assistant Supervisor
Date:	May 2005	November 2005
Checked by:	Stephen Rowland	Signed.....
Position:	Project Manager	
Date:	January 2006	
Approved by:	Alan Lupton	Signed.....
Position:	Operations Manager	
Date:	January 2006	

Oxford Archaeology North
Storey Institute
Meeting House Lane
Lancaster
LA1 1TF
t: (0044) 01524 848666
f: (0044) 01524 848606

w: www.oxfordarch.co.uk
e: info@oxfordarch.co.uk

© Oxford Archaeological Unit Ltd (2006)
Janus House
Osney Mead
Oxford
OX2 0EA
t: (0044) 01865 263800
f: (0044) 01865 793496

Oxford Archaeological Unit Limited is a Registered Charity No: 285627

Disclaimer:

This document has been prepared for the titled project or named part thereof and should not be relied upon or used for any other project without an independent check being carried out as to its suitability and prior written authority of Oxford Archaeology being obtained. Oxford Archaeology accepts no responsibility or liability for the consequences of this document being used for a purpose other than the purposes for which it was commissioned. Any person/party using or relying on the document for such other purposes agrees, and will by such use or reliance be taken to confirm their agreement to indemnify Oxford Archaeology for all loss or damage resulting therefrom. Oxford Archaeology accepts no responsibility or liability for this document to any party other than the person/party by whom it was commissioned.

CONTENTS

SUMMARY	3
ACKNOWLEDGEMENTS.....	4
1. INTRODUCTION	5
1.1 Circumstances of Project.....	5
2. METHODOLOGY	6
2.1 Project Design	6
2.2 Desk-Based Assessment.....	6
2.3 Watching Brief	7
2.4 Archive	7
3. BACKGROUND	8
3.1 Location, Topography and Geology.....	8
3.2 Historical and Archaeological Background	8
3.3 Map Regression Analysis.....	10
3.4 Previous Archaeological Interventions	12
4. GAZETTEER OF SITES	13
5. SIGNIFICANCE OF THE REMAINS.....	18
5.1 Introduction	18
5.2 Criteria.....	18
5.3 Significance.....	20
6. WATCHING BRIEF RESULTS.....	21
6.1 Results	21
6.2 Finds.....	22
7. CONCLUSIONS.....	23
7. BIBLIOGRAPHY	24

7.1	Cartographic Sources	24
7.2	Secondary Sources	24
8.	ILLUSTRATIONS	26
8.1	Figures	26
8.2	Plates	26
APPENDIX 1. PROJECT DESIGN		27
APPENDIX 2. CONTEXT LIST		33
APPENDIX 3. FINDS SUMMARY		34

SUMMARY

Architects Plus propose to develop an area of land (Planning Application No: 2/03/1170), by building a retail unit and flats, adjacent to the Co-op and Post Office on Station Street, Cockermouth, Cumbria (NY 3120 3056). Following the submission of a project design, Oxford Archaeology North (OA North) was commissioned to undertake a desk-based assessment and watching brief.

The desk-based assessment was undertaken in March 2005 and involved the consultation of the Cumbria Historic Environment Record (HER) in Kendal and the Cumbria Record Office (CRO) in Whitehaven. In total, ten sites were identified within the development area and its vicinity. Three sites were identified from the HER, including two listed buildings (Sites **02** - a former subscription school and **06** - Christchurch, South Street) along with a gallows place name, indicating the probable location of such a facility (Site **05**). Six sites were identified from cartographic sources, representing residential, commercial, light industrial and public buildings; these included an unidentified building, a timber yard, a Sunday school, a sawmill, and a post office with an associated lean-to structure (respectively, Sites **01**, **03–05**, **07–08**). One site, medieval burgage plot and associated buildings, was identified from previous excavations (Site **10**). All but the medieval burgage plots and possibly the gallows sites date to the post-medieval period and, where dates are available, to the nineteenth century.

Sites within the study area were assessed for their archaeological significance by using the criteria laid down in Annex 4 of Planning Policy Guidance 16 (PPG 16, DoE 1990). Only the medieval burgage plots (Site **10**) were deemed to have any regional significance, while the remainder were only significant within either a very local context, or, as a means of helping to ascertain the nature of previous land-use within the development area itself.

One building of indeterminate function (Site **01**) was identified as lying within the area of the proposed development. The preservation of medieval burgage plots (Site **10**) on Main Street, to the west of the development area, raised the possibility that medieval boundary features might also be preserved within the current development area.

The watching brief monitored groundworks within the adjoining yard immediately to the south of the Post Office building and was undertaken in August and September 2005. These groundworks comprised the underpinning of the western property boundary wall and the excavation of a foundation trench along the southern wall of the Post Office. No features of archaeological importance were revealed.

The full results of the desk-based assessment, including an assessment of the impact of the development and pertinent recommendations, are detailed in a previous OA North report (OA North 2005). The current document details and discusses the results of the desk-based assessment and watching brief.

ACKNOWLEDGEMENTS

Oxford Archaeology North (OA North) would like to thank Marie Frame of Architects Plus for commissioning the project and also David Atkinson of Thomas Armstrong Construction. Thanks are also due to the staff of the Cumbria HER at Kendal, and all the staff of the County Record Office in Whitehaven for their assistance with this project.

The desk-based assessment was undertaken by Louise Ford, while the watching brief was conducted by Steve Clarke and Christina Clarke. The drawings were produced by Christina Clarke and Mark Tidmarsh. The project was managed by Emily Mercer and Stephen Rowland, who also edited the report, together with Alan Lupton.

1. INTRODUCTION

1.1 CIRCUMSTANCES OF PROJECT

- 1.1.1 Architects Plus propose to develop an area of land to the immediate south of the Co-op and Post Office (Planning Application No: 2/03/1170) on Station Street, Cockermouth, Cumbria (NY 3120 3056) (Fig 1). Accordingly, following submission of a project design (*Appendix 1*), Oxford Archaeology North (OA North) were commissioned to undertake a desk-based assessment and a watching brief during groundworks related to the development of the site.
- 1.1.2 The desk-based assessment, undertaken in March 2005, comprised a search of both published and unpublished records held by the Historic Environment Record (HER) in Kendal, the Cumbria Record Office (CRO) in Whitehaven, and the archives and library held at OA North. The significance criteria detailed in PPG 16 (DoE 1990) was employed to assess the potential archaeological and historical significance of sites identified during the research. Because of the time delay between the completion of the desk-based assessment and the commencement of the watching brief, the results of the desk-based assessment, including an assessment of the impact of the proposed development and pertinent recommendations, were previously submitted as a separate document (OA North 2005).
- 1.1.3 A watching brief was maintained over three days in August and September 2005 and monitored groundworks within the adjoining yard immediately to the south of the Post Office building (Fig 8). These groundworks comprised the underpinning of the western property boundary wall, for a length of 8.3m and the excavation of a 4.2m by 2.3m foundation trench along the southern wall of the Post Office. The current document contains the fieldwork results of both the desk-based assessment and of the watching brief, along with a discussion of the watching brief results within the context of the information gained from the desk-based assessment.

2. METHODOLOGY

2.1 PROJECT DESIGN

2.1.1 A project design (*Appendix 1*) was submitted by OA North in response to a request by Architects Plus for an archaeological desk-based assessment and watching brief of the proposed development of the land adjacent to the Co-op and Post Office on Station Street, Cockermouth. The project design was adhered to in full, and the work was consistent with the relevant standards and procedures of the Institute of Field Archaeologists, and generally accepted best practice.

2.2 DESK-BASED ASSESSMENT

2.2.1 Several sources were consulted in accordance with the project design. A search was conducted of both published and unpublished records held by the Cumbria County Record Office (CCRO) in Whitehaven, the Cumbria Historic Environment Record (HER) in Kendal, and the archives and library held at OA North. The study area consists of an area approximately 10 x 10m² centred on land adjacent to the Co-op and Post Office (Fig 2). The identified sites were collated and are presented in the gazetteer (*Section 4*). The study area and the town of Cockermouth were also examined to provide an historical and archaeological background. The results were analysed using the set of criteria used to assess the importance of an ancient monument (PPG 16, DoE 1990).

2.2.2 ***Cumbria Historic Environment Record (HER)***: the Cumbria Historic Environment Record held in Kendal was consulted. This consists of a list of known archaeological sites and monuments within the county and is maintained by Cumbria County Council. Each site recorded within the assessment area was accessed and a brief entry, including grid reference, sources, and description was collated.

2.2.3 ***Cumbria County Record Office (CCRO), Whitehaven***: the county record office in Whitehaven holds original documents and maps for the Whitehaven area, including Cockermouth. It was visited primarily to consult early maps of the area, which can provide details of the landscape development; other documents relevant to the study area were also consulted.

2.2.4 ***Oxford Archaeology North***: OA North has an extensive archive of cartographic and secondary sources relevant to the study area, as well as numerous unpublished client reports on work carried out both as OA North and in its former guise of Lancaster University Archaeological Unit (LUAU). These were consulted where necessary.

2.3 WATCHING BRIEF

- 2.3.1 Following the unmonitored removal of the uppermost concrete surface at the site, the watching brief comprised observation of all groundworks associated with the development and the accurate recording of exposed soil horizons. Full records were made on OA North *pro-forma* recording sheets accompanied by scaled plans and sections; a monochrome and colour slide photographic record was maintained throughout. Pits for the underpinning of the western wall were dug by hand and with the use of a pneumatic jack-hammer, while the foundation trench against the southern wall was excavated by a mini digger with a toothed ditching bucket.

2.4 ARCHIVE

- 2.4.1 A full professional archive has been compiled in accordance with the project design (*Appendix 1*), and in accordance with current IFA and English Heritage guidelines (English Heritage 1991). The paper and digital archive will be deposited in Kendal HER on completion of the project.

3. BACKGROUND

3.1 LOCATION, TOPOGRAPHY AND GEOLOGY

- 3.1.1 The proposed development is located next to the current Co-op and Post Office buildings on Station Street, Cockermouth (NY 3120 3056) at the junction with South Street (formerly Back Lane) and to the south of Main Street. It covers an area of approximately 10 x 10m within the historic centre of Cockermouth.
- 3.1.2 The study area is situated within the West Cumbrian Coastal Plain to the north-east of Workington and Whitehaven. The landscape consists of a broad flood plain of the river Derwent that flows through Cockermouth and joins the north-flowing river Cocker (Countryside Commission 1998, 27).
- 3.1.3 The geology is typified by outcrops of Coal Measures, shales and sandstones of the Hensingham Group and the Chief Limestone Group, all of which date to the Carboniferous period (*ibid*). Glacial deposits of boulder clay, sand, and gravel are also present within this region (*ibid*).

3.2 HISTORICAL AND ARCHAEOLOGICAL BACKGROUND

- 3.2.1 **Prehistoric Period:** whilst no evidence for prehistoric activity has been identified in Cockermouth itself, there is potential in the area. Palynological evidence from the Solway Plain to the north of Cockermouth suggests human interference of forests during the Neolithic period and the Bronze Age (Bewley 1994, 54). Indeed, many stone axes have been recovered from the Solway Plain, but none specifically from Cockermouth (*ibid*). Further evidence for Neolithic activity exists at the Elva Plain Stone circle (NY 177 317), which consists of fifteen stones located approximately 5km to the west of Cockermouth (www.visitcumbria.com/cm/elva.htm). The earliest and closest evidence for prehistoric activity is suggested by a Bronze Age collared urn find at Papcastle, c 3km to the west of Cockermouth (*ibid*, 61). There is possible Iron Age activity within Cockermouth in Fitz Wood, where a 'well-preserved rampart and ditch, 750 feet (229 m) round, with a straight ditch cutting across' has been identified (Bradbury 1995, 11).
- 3.2.2 **Roman Period:** no Roman evidence has been recovered within the town of Cockermouth, but the fort of *Derventio* at Papcastle lies approximately 2km to the west of the town (Birley 1963, 122). This relatively large fort was excavated in the mid-1980s (Shotton 1993, 34), indicating evidence of its importance in the communications network to other forts in the region (Holder 2004, 62).
- 3.2.3 **Early Medieval Period:** the name 'cocker' is possibly Celtic in origin and may have derived from the Welsh word 'cock-or' meaning the red (heather?) of the mountain face (Bradbury 1995, 26). Alternatively, it could come from the old English word 'kukra' (*ibid*), meaning crooked, possibly relating to the shape of the river. Little is known about the Dark Ages in Cumbria, not least because

of lack of recognisable and datable material culture between the end of Roman administration c410 AD and (O'Sullivan 1985). The native British kingdom of Rheged is known to have expanded into the Solway plain by the fifth century and, at its height, is thought to have extended north of the Solway and as far south as the river Duddon (Higham 1986). It is possible that what may have been a short-cist cemetery at Moreseby, c10km to the south-west of Cockermouth and a single, empty, cist from Backfoot, c15km to the north-west, date to this post-Roman, Early Christian period (O'Sullivan 1985), as may the cemetery at Eaglesfield, c3km to the south-west and excavated during the nineteenth century (Wilson 1978). By the mid-seventh century, Cumbria had been incorporated into the kingdom of Northumbria (Kirkby 1962) and an Anglian influence can be seen on local place names (Rollinson 1996). Although there is very little settlement evidence from this period, it has been suggested that curvilinear churchyards (of which around 30 survive in some form and continue in use into the present, including four within 10km of Cockermouth), may well be of Anglo-Saxon origin (O'Sullivan 1985). From the later ninth century, the Christian kingdoms of northern Britain were ravaged by Scandinavian armies. With the Danish capture of York in AD 865 the once-powerful Anglian kingdom of Northumbria was gradually dismembered, falling prey to the Danes of Yorkshire and, from AD 902, to the large-scale immigration of Norse settlers, evicted from Ireland (Higham 1985). Other parts of the North West, including the former kingdom of Rheged, returned to British hands, this time in the form of the kingdom of Strathclyde, ruled from Dumbarton (Morris, 1973). It was the Norse, however, who had the most considerable affect on the area, not least toponymically (Higham 1986), and it is possible that from the 920s, coastal settlement along the Solway Firth was encouraged by the rulers of Cumbria (Higham 1985). It is possible that one such settler, or perhaps an earlier raider, was buried at Eaglesfield (*ibid*), while examples of Scandinavian sculpture within the Derwent valley to the west of Cockermouth further attest to the presence of such settlers (*ibid*).

- 3.2.4 **Medieval Period:** following the turmoil of the Norman Conquest, Cumbria briefly fell into Scottish hands, but, by the end of the eleventh century, Norman control had been asserted with William Rufus' capture of Carlisle in 1092 (Rowley 1983). The earliest medieval structure in Cockermouth is the castle, which was built sometime between 1072 and 1106 by Waldeve, second son of Gospatric, Earl of Dunbar (Cumbria County Council 2002, 8). It was constructed using stone from the Roman fort at Papcastle and was extended during the thirteenth and fourteenth centuries for protection against the Scots, who brutally sacked Cockermouth a number of times. Further wars, such as the Wars of the Roses and the Civil War, have led to its present ruinous condition. The construction of this castle provided a focus for the development of the town of Cockermouth with the earliest settlement probably developing on the East side of the river, by the castle around the market place in the Bitter Beck valley (Leech *et al* forthcoming). The earliest evidence for this lies in a charter referring to Alan son of Waldeve at 'Cokyrmoth' dating to around the mid-twelfth century (Winchester 1986, 109). In 1227, a market was granted by Royal Charter, and in 1270, approximately 175 burgage plots were recorded as being laid out (Leech *et al* forthcoming). The arrangement of these burgage plots seems to have been typical of planned towns of the period - along the

wide Main Street and with back lanes to the rear. The site's position at the junction of Station Street and South Street (formerly Back Lane) would suggest that it occupied an area at the very rear of one of these burgage plots. A number of mills were also in operation, particularly those involved with the textile and leather industries, with wool being the town's economic mainstay. Indeed, a fulling mill was recorded as early as 1156 (Bradbury 1994). The later thirteenth and fourteenth centuries were disrupted by economic and political struggles, as well as plague and pestilence, resulting in a lack of tenants for the burgage plots (*ibid*). The sheep murrains of the later thirteenth century had a particular impact upon the town's economy, depending as it did upon the cloth industry (Winchester 1986).

3.2.5 **Post-Medieval Period:** by the sixteenth century, the town was a thriving market centre, which was maintained into the seventeenth and eighteenth centuries (Leech *et al* forthcoming). The textile industry remained an important focus, with the conversion of the burgage plots into cottages and terraces for the workforce by the nineteenth century (*ibid*). By the mid-nineteenth century, there were over 40 industrial sites including wool, linen and cotton mills, hat factories and tanneries. In 1965, the Council for British Archaeology (CBA) selected Cockermouth as one of 51 'Gem Towns' worthy of special care in preservation and development (Bradbury 1994).

3.3 MAP REGRESSION ANALYSIS

3.3.1 **Enclosure Map (c1832):** (Fig 3) given that this map is largely concerned with illustrating the ownership of various tracts of land, it is only of limited use for establishing the contemporary landuse of the study area regarding. Although the map covers the area of the majority of the town, important features, such as the castle and Main Street, are not illustrated, and the same is true of the study area. However, the map does illustrate a long east/west-aligned building immediately opposite the study area, on the south side of Back Lane, and it seems likely that the large area of enclosed land immediately to the south of Back Lane, which is likely to represent one of the medieval open fields, is owned by John Stoddart.

3.3.2 **Wood's Map of Cockermouth (1832):** (Fig 4) this map offers more clues to the character of nineteenth-century Cockermouth. Development along both sides of Back Lane is limited to fewer, well-spaced, east/west-aligned buildings, contrasting with the concentration of north/south aligned buildings fronting the parallel medieval thoroughfare of Main Street. One of these larger buildings (Site 01), encompasses about half of the southern end of the study area. The open fields to the south of Back Lane do not appear to have been greatly subdivided by field boundaries, which may suggest that the buildings within that area may all be inhabited by the tenants of John Stoddart. In contrast to this, there has been much greater alteration of the Main Street medieval toft boundaries, with very few retaining their original length, stretching between Main Street and Back Lane. Instead, the majority have been truncated by straight boundaries parallel to Main Street, and the original toft boundaries removed, either to allow development of small plots either side of Chaloner Street (perpendicular to Main Street, and possibly originally a

field vennel) or to create larger plots, two or three tofts wide, within which the larger Back Lane buildings have been constructed. Site **01** occupies one such plot, two tofts wide. Station Street does not yet exist, although it is notable that a number of the larger Chaloner Street tenements back onto the eastern boundary of the tenement occupied by Site **01**. Site **02**, the subscription school, also seems to be present on Back Lane to the west of the development area, and appears to occupy three combined burgage plots. Opposite the development site are two buildings in very similar positions to the Timber Yard (Site **03**) and Sunday School (Site **04**) annotated on the 1866 OS map. Similarly, on the north side of Back Lane to the west of the study area is a building that may correlate with the sawmill (Site **05**), again annotated on the 1866 OS map.

3.3.3 **First Edition Ordnance Survey Map (1866):** (Fig 5) this map is well-annotated and provides a number of clues regarding the nature of contemporary activity in the region of the study area. Back Lane has become South Street, and many of the fossilised tofts have become further subdivided. That within which the development area lies has actually expanded northwards to encompass a tenement fronting Main Street, the structures of which have been demolished. The result of this is to formalise the area occupied by modern Station Street, although it is not annotated as such and, whether the land remained the property of the owner of Site **01**, is not apparent. Within the study area, Site **01** has been subdivided into two dwellings, each with rear extensions, fronting South Street. The western-most of these dwellings has a large and somewhat irregularly-shaped extension fronting South Street, which could either represent another extension or, perhaps more likely, a private yard area. Opposite the study area are a timber yard (Site **03**) and a Sunday School (Site **04**), both of which utilise and extend the pre-existing buildings illustrated on Wood's plan of 1832. They have also been provided with demarcated yard areas. Four plots to the west of the study area is a tenement occupied by a sawmill (Site **05**) which, while it corresponds with a building on Wood's plan, appears larger and at a slightly different alignment. Christ Church (Site **06**), at the time only a year old, also appears on the map to the west of the development area. The number of troughs scattered across the large fields to the south of South Lane indicate the largely pastoral character of the surrounding area.

3.3.4 **Second Edition Ordnance Survey Map (1900):** (Fig 6) Station Street now exists, flanked on both sides by regular square buildings without yards, demonstrating an increase in construction over the previous forty years. Site **01** has been demolished to allow Station Street to connect with South Street and with the newly-constructed Station Road. Where the western dwelling of Site **01** once stood, there is now a vacant space on the corner of Station Street and South Street. The current layout of the Post Office (Site **07**, immediately adjoining the study area to the north), Co-op, lean-to store (Site **08**, immediately adjoining the development area to the west) and yard area are now represented on this map, showing that few changes have occurred in the study area over the past century. Whether or not the sawmill (Site **05**) to the west of the development site survives, it has given its name to a residential estate. A further terrace of houses has appeared on the south side of South

Street and much of the former meadow land and orchards have been replaced by new developments, including a School (Site **11**), a fire station (Site **12**) and a large agricultural Hall (Site **13**); on the site of the timber yard (Site **03**) there is a building of unidentified function (Site **14**) and, on the site of the Sunday school (Site **04**), an auction mart (Site **15**). Sites **14** and **15** are separated by the newly constructed Station Road.

- 3.3.5 **Third Edition Ordnance Survey Map (1925):** (Fig 7) this map depicts a very similar layout to the previous map with no changes occurring in the development area. Within the vicinity, the construction of the grand theatre (Site **16**), a pavilion (Site **17**) and the tennis ground (Site **18**) accentuate what it is likely to be the more salubrious end of town.

3.4 PREVIOUS ARCHAEOLOGICAL INTERVENTIONS

- 3.4.1 Previous archaeological interventions by OA North have taken place in 1980–1 on 75–87 Main Street, to the north-west of Station Street, which uncovered evidence for a succession of buildings dating from the twelfth to the nineteenth centuries within burgage plots (Site **10** - Leech *et al* forthcoming). The earliest buildings, dating to the twelfth to fourteenth centuries were confined to the street frontage with a garden or cultivated area to the rear. The buildings were constructed around a framework of earthfast posts; whilst this construction method is known from other parts of England, such as the South and the Midlands, this is the first known example in the North West (*ibid*). These structures were then abandoned by the fifteenth century and new structures erected, with further re-building occurring during the eighteenth and nineteenth centuries.
- 3.4.2 Further interventions have been undertaken by other archaeological units, but, despite the known antiquity of Cockermouth, very little archaeology was encountered during these activities. In 1999, Northern Archaeological Associates (NAA) monitored the line of a new flood defence along Rubby Banks Road on the West bank of the River Cocker (to the east of the development area) (NAA 2000) while in 2000 Carlisle Archaeology Ltd (CA) undertook an evaluation at Bridge Street, to the north of the development area (CA 2000); no archaeology was encountered at either site. A watching brief at Curwen Grove, Crown Street, to the north-west of the study area, encountered a 0.3m - 0.4m thick charcoal-rich subsoil above the gravelly yellow natural (CCC 2002). An evaluation by North Pennines Heritage Trust (NPHT) at Mitre Court, St Helens Street, to the north-east of the development area, recorded a cobbled surface and drains associated with the former Crown and Mitre Hotel (NPHT 2002). The same unit conducted watching briefs behind 39 Market Place and at Cockermouth castle, both to the north-east of the development area, but no archaeological features were observed (NPHT 2003a; 2003b).

4. GAZETTEER OF SITES

Site number	01
Site name	Building to the north of South Street
NGR	NY 12077 30552
Site type	Building
Period	Post-medieval
HER No	N/A
Sources	Wood (1832), OS First edition (1866), OS Second edition (1900)
Description	A large, broadly east/west aligned building identified from Wood's 1832 plan of Cockermouth. The building would appear to encompass, and extend slightly beyond, the southern half of the development area. Since the building occupies a double-width burgage plot, it is likely to have been a substantial structure, and may have been occupied by wealthier people. The 1866 OS map indicates that the building has been subdivided into two equal-sized dwellings, to the rear of which of which are several small extensions. A large extension appears to have been built adjoining the western-most of the two dwellings, although the somewhat irregular shape may indicate that this demarcates a private yard area rather than a structure. By the 1900 OS Second edition map, it seems likely that Site 01 has been demolished to make way for Station Street and the back alley adjoining South Street.
Assessment	Within the study and any remains will be affected by any development.

Site number	02
Site name	24–28 South Street
NGR	NY 11971 30583
Site type	Subscription School
Period	Post-medieval
Listed Building No	25882
Sources	HER
Description	Early nineteenth century. Roughcast walls, slate roof, brick chimneys, three storeys. Three panelled doors (no 28 with a traceried fanlight); three 12-paned sash windows on each floor, those on the top floor being square and smaller, all in plain stone architraves. Cobbles in front of all three doors, which are slightly set back from the rest of the street. The whole was built as a subscription school, and after divided into three dwellings.
Assessment	Outside the study area and will not be affected by any development.

Site number	03
Site name	Timber Yard
NGR	NY 12076 30533
Site type	Industrial building
Period	Post-medieval
HER No	N/A
Sources	Wood (1832), OS First edition (1866), OS Second edition (1900)
Description	Building in this location first shown on the Wood's 1832 map, but only annotated as a timber yard on the OS First edition map. Shows several buildings within a rectangular demarcated yard. By 1900, the OS Second edition indicates that an agricultural hall has been built on the site.
Assessment	Outside the study area and will not be affected by any development.

Site number	04
Site name	Sunday School, South Street
NGR	NY 12111 30530
Site type	Building
Period	Post-medieval
HER No	N/A
Sources	Wood (1832), OS First edition (1866), OS Second edition (1900);
Description	Building appears on Wood's 1832 plan, but is not annotated as a Sunday School until the 1866 OS map, when there appears to be a small yard and extension. By 1900, the Second edition OS map indicates that the building has been demolished and replaced by the auction mart.
Assessment	Outside the study area and will not be affected by any development.

Site number	05
Site name	Sawmill
NGR	NY 12030 30568
Site type	Industrial buildings
Period	Post-medieval
Sources	Wood (1832), OS First edition (1866), OS Second edition (1900), OS Third edition (1925)
Description	Building within a plot 1.5 burgage plots in width shown on Wood's map of 1832, but would appear to be of a slightly different size and alignment to the sawmill annotated on the 1866 OS First edition map. The same buildings are shown on the 1900 and 1925 OS maps, but the annotation, Sawmill Crescent, would appear to indicate a residential development.
Assessment	Outside the study area and will not be affected by any development.

Site number	06
Site name	Christ Church, South Street
NGR	NY 11892 30566
Site type	Church
Period	Post-medieval
Listed Building No	25884
Sources	HER
Description	Built 1865 by Bruce of Whitehaven. Early English style. North-west angle tower with lancets. Double-decked interior, with two tiers of iron columns with moulded capitals, and a balcony over the aisles, cutting the very long two-light windows. Stepped east window of five pointed lancets. Open timber roof (pointed wagon vault) with a flat ceiling over the point.
Assessment	Outside the study area and will not be affected by any development.

Site number	07
Site name	Post Office
NGR	NY 12088 30561
Site type	Building
Period	Post-medieval
HER No	N/A
Sources	Second edition OS 1900; Third edition OS 1925
Description	Building first shown on the 1900 Second edition OS map. Dates to the construction of Station Street at some point between 1866 and 1900.
Assessment	Beside the study area and may be affected by any development.

Site number	08
Site name	Lean-to Store
NGR	NY 12078 30556
Site type	Building
Period	Post-medieval
HER No	N/A
Sources	Second edition OS 1900; Third edition OS 1925
Description	Building first shown on the 1900 Second edition OS map. Shown to the rear of Post Office Site 04 and likely to be contemporary with the construction of Station Street at some point between 1866 and 1900, as all of the new buildings lining the west side of the street are provided with such structures.
Assessment	Within the study area and could be affected by any development.

Site number	09
Site name	Gallow Barrow Place Name Site
NGR	NY 11900 30390
Site type	Gallows Place Name
Period	Undated
HER No	10773
Sources	HER
Description	Possible site of gallows
Assessment	Outside the study area and will not be affected by any development.

Site number	10
Site name	Burgage plots, Main Street
NGR	NY 119 307
Site type	Burgage plots
Period	Medieval
HER No	N/A
Sources	Leech <i>et al</i> forthcoming
Description	Three burgage plots along the west end of Main Street.
Assessment	Outside the study area and will not be affected by any development

Site number	11
Site name	Schools, Gallowbarrow
NGR	NY 11915 30470
Site type	Buildings
Period	Post-medieval
HER No	N/A
Sources	Second edition OS 1900; Third edition OS 1925
Description	Two separate building complexes with adjoining yards, possibly one each for boys and girls. Some of the original structures appear to have survived as the current school.
Assessment	Outside the study area and will not be affected by any development

Site number	12
Site name	Fire Engine Station
NGR	NY 11952 30519
Site type	Buildings and yard
Period	Post-medieval
HER No	N/A
Sources	Second edition OS 1900; Third edition OS 1925
Description	A large open yard area and associated small building complexes with access to South Street via a small avenue. Although the fire station now stands further to the

south-east, much of the open yard area currently survives as such and, the same may be true of one or two of the buildings.

Assessment Outside the study area and will not be affected by any development

Site number 13
Site name Agricultural Hall, South Street
NGR NY 12014 30532
Site type Building
Period Post-medieval
HER No N/A
Sources Second edition OS 1900; Third edition OS 1925
Description A large rectangular building bounded by South Street to the north, Kittyson Lane to the east and adjoining a large yard to the rear and with possible storage facilities. It is possible the building is still extant, as a structure of similarly size and shape is shown on the current OS 1:10,000 map.

Assessment Outside the study area and will not be affected by any development

Site number 14
Site name Unidentified building, South Street/Kittyson Lane
NGR NY 12170 30509
Site type Building
Period Post-medieval
HER No N/A
Sources Second edition OS 1900; Third edition OS 1925
Description A large building complex running almost the entire length of Kittyson Lane with what would appear to be extensive associated storage facilities. A rectangular building currently occupies the site, and it is possible that this is the structure identified on the 1900 and 1925 OS maps. However, the storage facilities are no longer extant.

Assessment Outside the study area and will not be affected by any development

Site number 15
Site name Auction Mart, South Street
NGR NY 12124 30503
Site type Building
Period Post-medieval
HER No N/A
Sources Second edition OS 1900; Third edition OS 1925
Description A large building fronting South Street, bounded by Station Road to the west and Lorton Street to the South-west. It is possible the building is still extant, as a structure of similarly size and shape is shown on the current OS 1:10,000 map.

Assessment Outside the study area and will not be affected by any development

Site number 16
Site name Grand Theatre
NGR NY 12094 30462
Site type Building
Period Post-medieval
HER No N/A
Sources Third edition OS 1925
Description A rectangular building fronting Lorton Street to the north-east and Station Road to the north-west. It is possible the building is still extant, as a structure of similarly size and shape is shown on the current OS 1:10,000 map.

Assessment Outside the study area and will not be affected by any development

Site number	17
Site name	Pavilion
NGR	NY 12156 30384
Site type	Building
Period	Post-medieval
HER No	N/A
Sources	Third edition OS 1925
Description	A small building, no longer extant as the area has since been developed.
Assessment	Outside the study area and will not be affected by any development

Site number	18
Site name	Tennis Ground
NGR	NY 12176 30366
Site type	Facility
Period	Post-medieval
HER No	N/A
Sources	Third edition OS 1925
Description	A large area demarcated on the 1925 OS map as a tennis ground, bounded by Lorton Street to the north-east. No longer extant as the area has since been developed.
Assessment	Outside the study area and will not be affected by any development

5. SIGNIFICANCE OF THE REMAINS

5.1 INTRODUCTION

5.1.1 In total, 18 sites have been identified during this desk-based assessment. Of these, 14 were identified from cartographic sources, whilst a further three were provided by the HER, and one from documentary sources. Of these, two are Listed Buildings (Site **02**, the former subscription school, and Site **06**, Christchurch, South Street) of which Site **02** is Grade II listed. The earliest site dates to the medieval period, and comprises burgage plots and buildings on Main Street (Site **10**), to the north-west of the development area. Most of the identified sites in the study area are dated to the post-medieval period and include 14 buildings (Sites **01–05**, **07** and **08** and **11–17**), a tennis ground (Site **18**) and a church (Site **07**). The gallows place name site (Site **09**) is undated, but may have a medieval origin. Only three of the buildings are located within the development area (Sites **01**, **07** and **08**) and may be affected by any development. There is, however, potential on the development site for the preservation of remains associated with a medieval burgage plot, as evidenced by further plots close-by, at Site **10**. No scheduled monuments were identified within the study area. The remainder of the sites are useful in tracing the nature of development and land-use around the development area.

Site Number	Period	No of sites
09	Undated	1
10	Medieval	1
01–08, 11–18	Post-Medieval	15

Table 1: Number of sites by period

5.2 CRITERIA

5.2.1 There are a number of different methodologies used to assess the archaeological significance of sites; that to be used here is the ‘Secretary of State’s criteria for scheduling ancient monuments’ which is included as Annex 4 of PPG 16 (DoE 1990). The sites previously listed (*Section 4*, above) were each considered using the criteria, with the results below.

5.2.2 **Period:** the earliest site, located within the study area represents burgage plots dating back to the medieval period (Site **10**) and remains of activities carried out to the rear of such plots may be preserved within the study area. The majority of the identified buildings (Sites **01–08** and **11–15**) are likely to have been built at various dates within the span of the nineteenth century, although the possibility remains that those first appearing on Wood’s map of 1832, including building (Site **01**), timber yard (Site **03**), Sunday school (Site **04**) and sawmill (Site **05**) could be older. Sites **16–17**, the Grand Theatre, pavilion

and tennis ground respectively, all date from the first quarter of the twentieth century. It is also possible that the gallows represented by the place name (Site **09**) could be medieval in origin. With the exception of the medieval burgage plots (Site **10**), none of the sites can be considered to specifically characterise their period of origin.

5.2.3 **Rarity:** while it can be argued that as all the sites represent the development of Cockermouth, they have some local significance, the nature of most of the sites ranges from common to ubiquitous. They represent domestic (Site **01**), public (schools - Sites **02**, **04** and **11**; church - Site **06**, Fire Station - Site **12**, Grand Theatre - Site **16**, pavilion - Site **17**, tennis ground - Site **18**), industrial (timber yard - Site **03**; sawmill - Site **05**) and commercial (Post office and associate structure - Sites **07** and **08**, Agricultural Hall - Site **13**, Auction Mart - Site **15**) functions, activities that must be common to almost every British town. With the exception of listed buildings Site **02** (subscription School) and Site **06** (Christchurch), the structures themselves are unlikely to be rare, or significant, particularly in the case of Sites **07** and **08**, which date to the end of the nineteenth century. Sites **01** and **02** are perhaps locally significant, as they are slightly older. Whilst the gallows place name site (Site **09**) is of interest in terms of social history, it is again quite common in many historic towns. Burgage plots Site **10** are not particularly rare within the context of medieval Cockermouth, although the opportunity to investigate such a feature is somewhat more-so.

5.2.4 **Documentation:** many of the properties on Station Street which were constructed in the nineteenth and twentieth centuries are commercial properties. This is known from the many directories that list the uses of properties (eg Kelly 1873, Bulmer 1883). Of interest is the Maryport Co-operative Society Limited, which was in use in 1894 (Kelly 1894, 119) and may have been housed in the same building within which the Co-op superstore is presently located. Whilst the precise uses of the buildings in the study area are unknown (building Site **01**, in particular), the uses of some properties on Station Street and South Street are known from these trade directories, although none are accompanied by much in the way of documentary evidence. The exception is perhaps the burgage plots (Site **10**), which do have documentation relating to their origin and use (*Section 3.2.4*).

5.2.5 **Group Value:** the medieval burgage plots (Site **10**) have group value as they represent part of the wider, planned medieval town of Cockermouth. It could be argued that Sites **01** - **05**, a possibly domestic building, the subscription school, the timber yard, the Sunday school and the sawmill respectively, also have some group value as they represent contemporary suburban development. However, of these, only the timber yard (Site **03**) and the sawmill (Site **05**) are likely to have any direct relationship with each other, as might the pavilion (Site **17**) and the tennis ground (Site **18**) and thus any real group value.

5.2.6 **Survival/Condition:** a number of the sites are no longer extant, including building Site **01**, the timber yard (Site **03**), and the Sunday school (Site **04**). While the gallows place name site (Site **09**) remains, the physical elements of this feature no longer exist. Remains of medieval burgage plots (Site **10**) were preserved below ground, and there may be further evidence of similar activity

in the development area. The remaining sites are all structures and have so far survived.

- 5.2.7 **Fragility/Vulnerability:** if remains of any potential medieval burgage plot activity, similar to that discovered at Site **10** exist, they are potentially vulnerable to any ground disturbing future development, as are any remains of building Site **01**. The Post Office and lean-to structure (Sites **07** and **08**) adjoining the development area are cosmetically vulnerable, but they cannot be considered fragile and are unlikely to be unduly affected by the proposed development. The remaining sites are too far away to be affected by any activity within the development area.
- 5.2.8 **Diversity:** there is limited diversity in the function of the individual sites, with domestic, commercial, industrial, agricultural and public roles represented, (Sites **05–07**), with occasional change of use of the same structures (eg the sawmill, Site **05**). Diversity within the study area would appear to decline over time, with an increase in domestic, commercial and public buildings at the expense of agricultural and industrial features as the area becomes more intensely developed.
- 5.2.9 **Potential:** there is potential for some medieval activity in the study area with the existence of burgage plots close-by (Site **10**). There is also potential for further investigation of any physical remains of pre-/early nineteenth century building Site **01**, along with any related backyard deposits and features relating to the use of this structure.

5.3 SIGNIFICANCE

- 5.3.1 Whilst only 16 post-medieval sites, one medieval site and one undated site have been identified during this assessment, they are all of some local significance for expanding our knowledge of historic Cockermouth and of the development area. The burgage plots (Site **10**) are regionally significant, not just because they highlight the medieval origins of the town, but mainly because of the good state of preservation of medieval archaeological features within an area where contemporary remains are often sparse and restricted to fossilised burgage boundaries. The old subscription school (Site **02**), and Christchurch (Site **06**) are Listed Buildings and are, therefore, historically significant, both within Cockermouth, but also regionally. The remainder of the sites cannot be argued to have anything greater than local significance beyond a characterisation of the potential archaeological remains within the proposed development area; they are informative about the progression of the southern part of Cockermouth from an area to the rear of burgage plots and of common pasture with some agriculture and light industry, through increasing development of what may have been more salubrious suburbs, to a much more commercialised part of town.

6. WATCHING BRIEF RESULTS

6.1 RESULTS

- 6.1.1 **Groundwork locations:** all groundworks were enacted within the rear yard to the south of the Post Office, bounded to the north by the southern wall of the Post Office building, to the south by a wall along South Street, to the east by a gated wall onto Station road itself and to the west by a wall along an alley accessing the rear of the Station Street properties. During the underpinning of the western wall, a series of pits measuring 1m square by *c* 0.5m deep were excavated at roughly 2m intervals along the base of the internal surface of the wall. Observations of these pits indicated that the underlying soil horizons were broadly similar in character and representative section of Trenches 1 and 2 are reproduced in Figure 9. Trench 1 was excavated 4.28m south of the Post Office wall, while Trench 2 was excavated in the north-west corner of the site where the western wall of the yard met the southern wall of the Post Office. After the wall footings were laid along the western boundary wall, a foundation trench for a staircase (Trench 3) was excavated against the southern wall of the Post Office. Trench 3 ran 4.4m east/west from the north-west corner of the development area and was 2.3m wide by 2m deep.
- 6.1.2 **Trench 1:** examination of the south-facing section (Section 1) showed that below the 0.06m thick modern concrete surface, **1**, there was a 0.3m thick make-up layer, **2**, which consisted of a greyish-black friable, slightly silty-sandy soil mixed with ash (50%) with inclusions of moderate small to medium sub-rounded stones. Layer **2** sloped east to west and overlay the natural drift geology, **3**, which was a creamy-yellow loose sandy gravel. No features were revealed.
- 6.1.3 **Trench 2:** excavation of Trench 2 (Section 2) revealed only one deposit, **4**, which consisted of a friable dry silty-sandy soil mixed with loose mortar and ash, with frequent inclusions of small to medium sub-rounded stones. This layer was at least 0.5m thick and was probably a make-up layer for concrete surface **1**.
- 6.1.4 **Trench 3:** beneath concrete layer **1**, natural drift geology **3** was revealed at the western end of Trench 3. Natural geology **3** had been cut to the north by a foundation trench (**6**) for the southern wall of the Post Office (Fig 9 Section 4). Foundation trench **6** was had been backfilled with deposit **5**, a firm dark brown/black silty-sand with rare inclusions of gravel. Both natural geology **3** and foundation cut **6** had been cut by possible pit **8**, which ran diagonally across Trench 3 from the south-western corner to the north-east. This feature had been filled with a single deposit, **7**, throughout the entire exposed depth of 2m. Context **7** was fairly homogenous, though faint layers could be seen within it and, overall, consisted of a yellowish-brown friable sandy-clay soil with occasional pockets of gravel. A moderate amount of post-medieval pottery ranging in date from the seventeenth to the twentieth century was recovered from context **7** (Section 6.2; Appendix 3).

6.2 FINDS

- 6.2.1 In total, seven fragments of pottery were recovered during the groundworks, all from backfill 7 in Trench 3 (*Appendix 3*). But for a single sherd of bone china hollow-ware, all were of earthenware and could only be broadly dated, generally ranging from the late seventeenth or eighteenth centuries to the twentieth century. Considering the fact that pit 8 cuts the foundation trench for the construction of the Post Office building, a late nineteenth or twentieth century date for the assemblage seems more plausible than an early one.

7. CONCLUSIONS

7.1 DISCUSSION

- 7.1.1 Although the desk-based assessment identified limited potential for medieval and post-medieval archaeological remains within the development area, particularly of previous phases of post-medieval building activity (Site **01**), no such remains were encountered during the watching brief. There is, however, the possibility that archaeological remains survive away from the monitored interventions which, located so close to existing structures, are most likely to show evidence of disturbance. The absence of medieval remains, even of refuse, is perhaps unsurprising given the location of the site, right at the rear of the medieval burgage plots. A comparison of the position of the groundworks with the location of the known post-medieval structure (Site **01**) within the development area would suggest that any sub-surface structural remains of Site **01** are likely to lie just to the south of the monitored interventions. The location of such features, further away from the main area of recent activity, may mean that they have a greater potential for survival than the disturbed deposits within the monitored interventions.
- 7.1.2 It would also appear, from the fact that the natural geology lay immediately beneath the modern concrete surface of the development area, that a degree of preparation, including removal of topsoil and any subsoil deposits (and possibly the upper levels of the natural geology, as well), had occurred. This would have had a serious impact upon archaeological remains in the area. The date of this truncation possibly relates to the later nineteenth century construction of the Station Street buildings. The purpose of pit **8** is uncertain, as it did not contain vast amounts of building debris or refuse and, at over 2m in depth, it represents a substantial feature. Given the date of the pottery and its stratigraphic relationship with the Post Office building, it is highly likely to be of late nineteenth to early twentieth century date.

7. BIBLIOGRAPHY

7.1 CARTOGRAPHIC SOURCES

Enclosure Map of Cockermouth, c 1832

Wood's Map of Cockermouth, 1832

First Edition Ordnance Survey Map, 1866 25": 1 mile

Second Edition Ordnance Survey Map, 1900 25": 1 mile

Third Edition Ordnance Survey Map, 1925 25": 1 mile

7.2 SECONDARY SOURCES

Bewley, RH, 1994 *Prehistoric and Romano-British Settlement in the Solway Plain, Cumbria*, Oxbow Monograph **36**, Oxford

Birley, E, 1963 Roman Papcastle, *Trans Cumberland Westmorland Antiq Archaeol Soc*, n ser, **63**, 96–125

Bradbury, JB, 1994 *Cockermouth and District in Old Photographs*, Stroud

Bradbury, JB, 1995 *Bradbury's history of Cockermouth*, Cockermouth

Bulmer, T, 1883 *History, topography and directory of West Cumberland*, Barrow

Carlisle Archaeology Ltd, 2000 *Report on an Archaeological evaluation at Bridge Street, Cockermouth* unpubl rep

Countryside Commission, 1998 *Countryside Character Volume 2: North West*, Cheltenham

Cumbria County Council, 2002 *Extensive Urban Survey for Cumbria: Archaeological Assessment Report for Cockermouth and Papcastle*, London

DoE, 1990 *Planning Policy Guidance 16: Archaeology and Planning*, London

English Heritage, 1991 *Management of Archaeological Projects*, London

Higham, HJ, 1985 'The Scandinavians in North Cumbria: raids and settlement in the later ninth to mid tenth centuries' in JR Baldwin and ID Whyte (eds) *The Scandinavians in Cumbria*, Scottish Society for Northern Studies

Higham, NJ, 1986 *The Northern Counties to AD 1000*, Harlow

Holder, P, 2004 Roman place-names on the Cumbrian coast, in RJA Wilson and ID Caruana (eds), *Romans on the Solway: Essays in honour of Richard Bellhouse*, Kendal, pp 52–65

- Kelly, ER, 1873 *Kelly's Directory of Cumberland*, London
- Kelly, ER, 1894 *Kelly's Directory of Cumberland*, London
- Kirkby, DP, 1962 Strathclyde and Cumbria: a survey of historical development to 1092, *Trans Cumberland Westmorland Antiq Archaeol Soc*, n ser, **62**, 77-94
- Leech, RH, *et al* forthcoming *Excavations at 75–87 Main Street, Cockermouth*
- Northern Archaeological Associates, 2000 *Rubby Banks Road, Cockermouth, Archaeological Monitoring of a Flood Defence Wall* unpubl rep
- North Pennines Heritage Trust, 2002 *Mitre Court, St Helens Street, Cockermouth* unpubl rep
- North Pennines Heritage Trust, 2003a *Report for an Archaeological Watching Brief of Land at 39 Market Place, Cockermouth, Cumbria*, unpubl rep
- North Pennines Heritage Trust, 2003b *Report on an Archaeological Watching Brief at Cockermouth Castle*
- O'Sullivan, D, 1985 'Cumbria before the Vikings; a review of some 'Dark-Age' problems in North-West England' in JR Baldwin and ID Whyte (eds) *The Scandinavians in Cumbria*, Scottish Society for Northern Studies
- Oxford Archaeology North, 2005 *Station Street, Cockermouth, Cumbria: Archaeological Desk-Based Assessment*, unpubl rep
- Rollinson, W, 1996 *A History of Cumberland and Westmorland*, London
- Rowley, T, 1983 *The Norman Heritage 1055-1200*, London
- Shotter, D, 1993 *Romans and Britons in North-West England*, Preston
- Wilson, PA 1978 'Eaglesfield: the place, the name, the burials' *Transactions of the Cumberland and Westmorland Antiquarian and Archaeological Society* 78, 47-54.
- Winchester, AJL, 1986 Medieval Cockermouth, *Trans Cumberland Westmorland Antiq Archaeol Soc*, n ser, **86**, 109–28
- www.visitcumbria.com/cm/elva.htm nd *Elva Plain Stone Circle*

8. ILLUSTRATIONS

8.1 FIGURES

Figure 1: Site Location Map

Figure 2: Plan of Gazetteer Sites

Figure 3: Extract of the Enclosure Map (c 1832)

Figure 4: Extract of Wood's Plan of Cockermouth (1832)

Figure 5: Extract of First Edition Ordnance Survey map (1866)

Figure 6: Extract of Second Edition Ordnance Survey map (1900)

Figure 7: Extract of Third Edition Ordnance Survey map (1925)

Figure 8: Watching Brief Location Plan

Figure 9: Plans and Sections of Trenches 1, 2 and 3 with Section Location Plan

8.2 PLATES

Plate 1: South-facing Section 1 in Trench 1

Plate 2: Post-Office wall showing blocked chute, and west-facing section

Plate 3: East-facing Section 4 in Trench 3 showing foundation trench and natural gravel

Plate 4: cut of Pit 8 in section within Trench 3, facing east

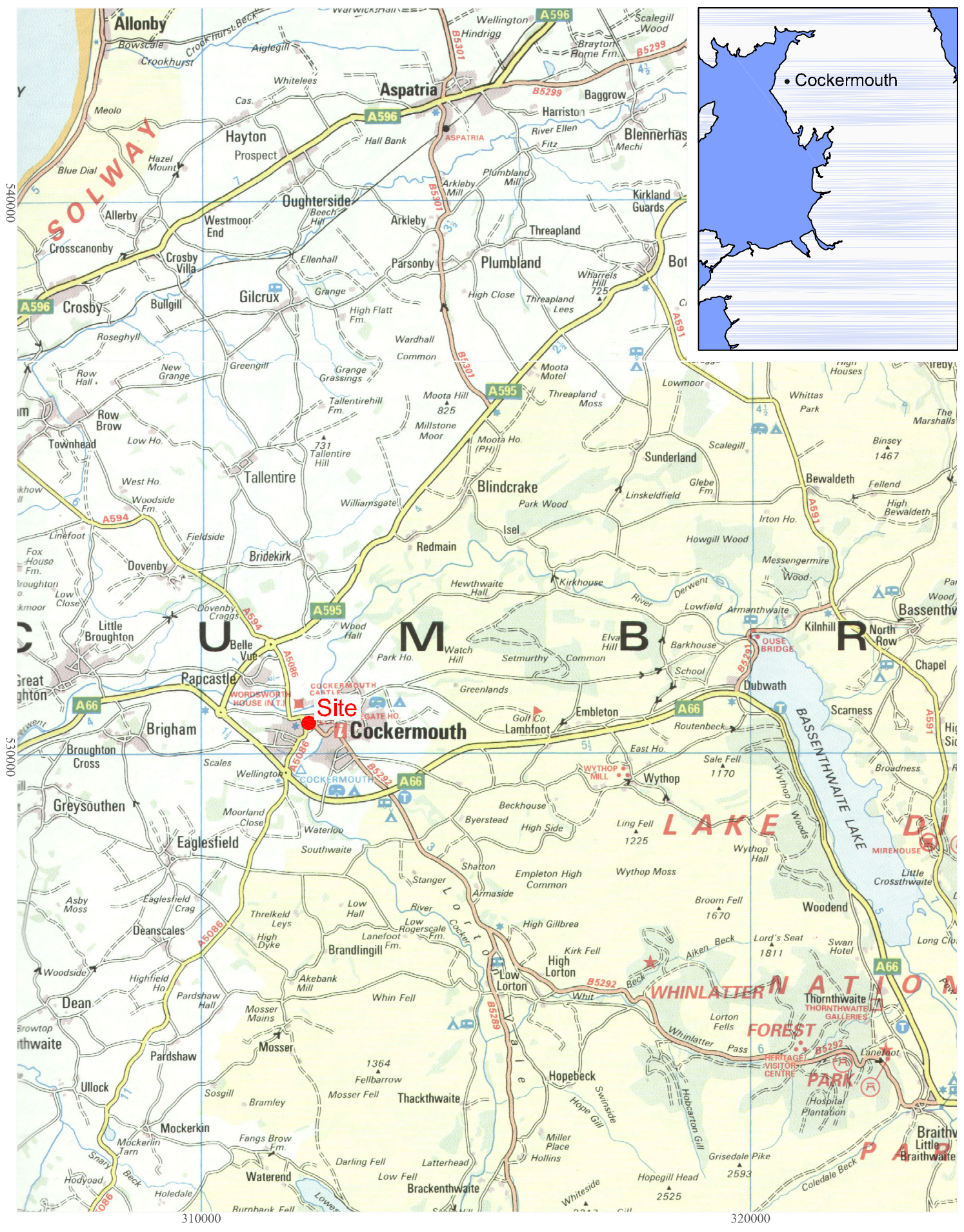

based upon the Ordnance Survey 1:100,000
 with the permission of the controller of HMSO
 © Crown Copyright

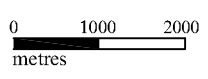
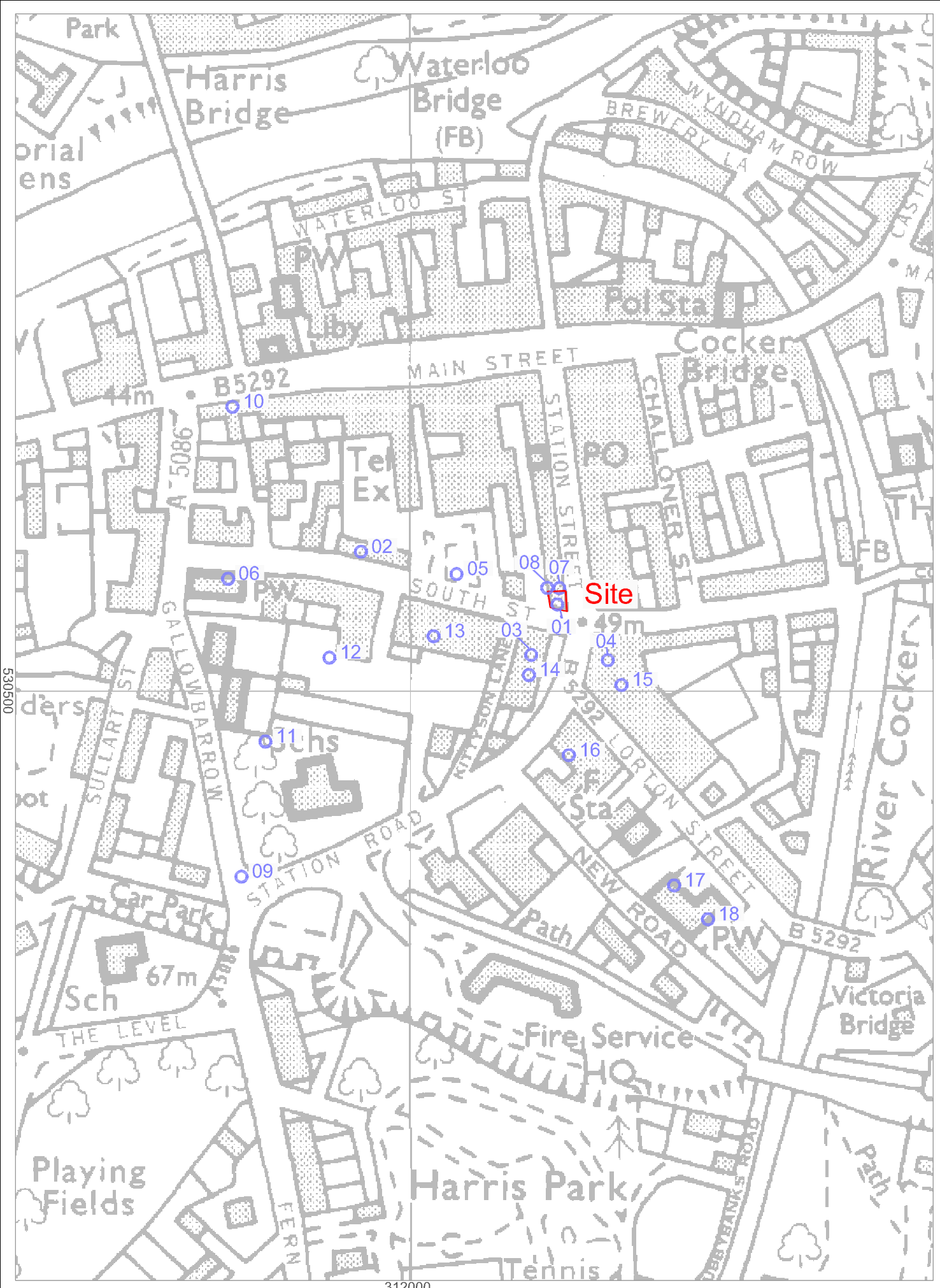

Figure 1: Location Map



530500

312000

based upon the Ordnance Survey 1:10,000
 with the permission of the controller of HMSO
 © Crown Copyright

0 60m
 Scale 1:3000 @ A4



Figure 2: Gazetteer sites plan



Site

Not to Scale



Figure 3: Extract of the Enclosure Map (c 1832)



approximate location of development



Not to Scale



Figure 4: Extract of Wood's plan of Cockermouth (c 1832)

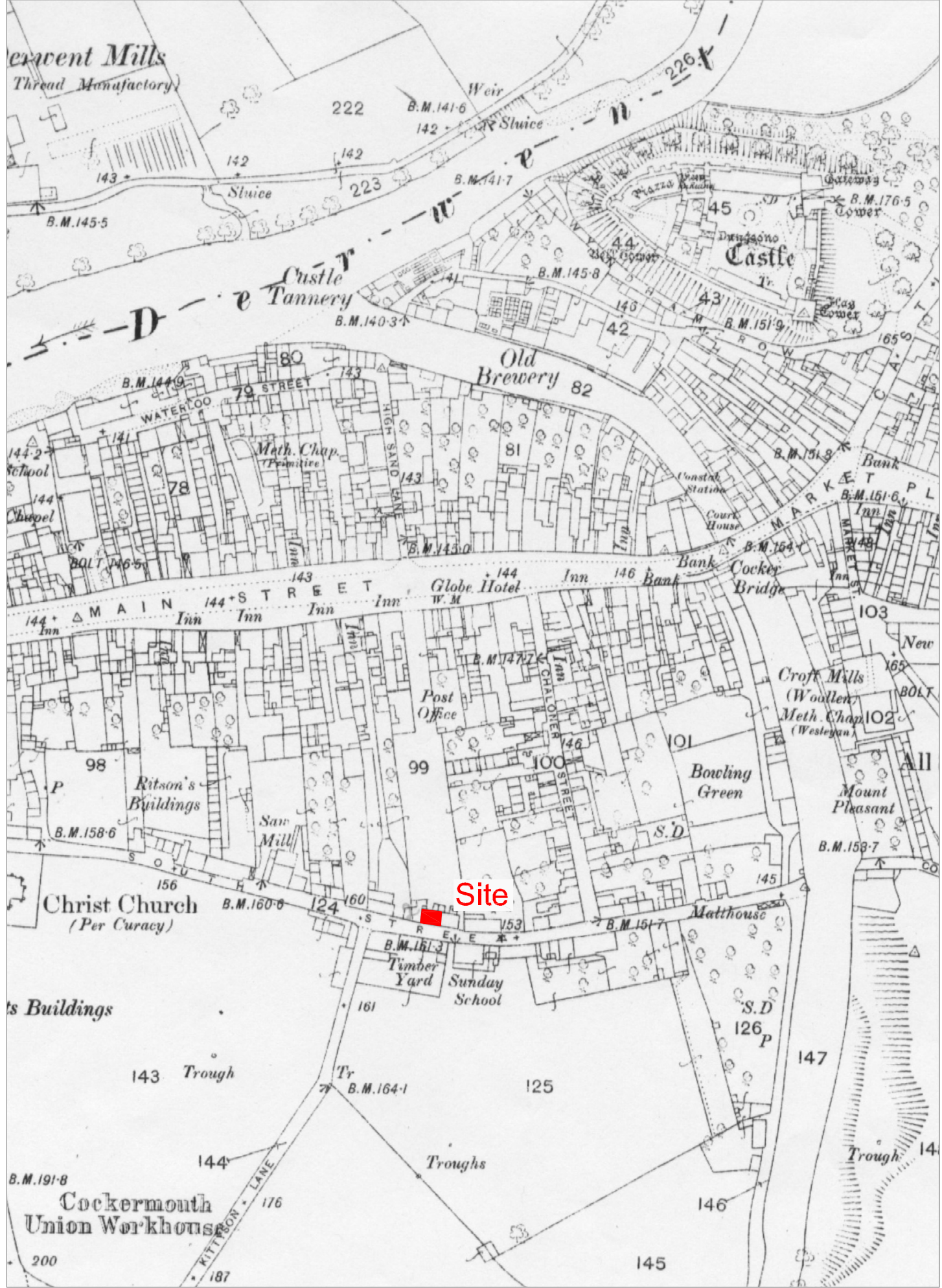

Not to Scale



Figure 5: Extract of First Edition Ordnance Survey map (1866)

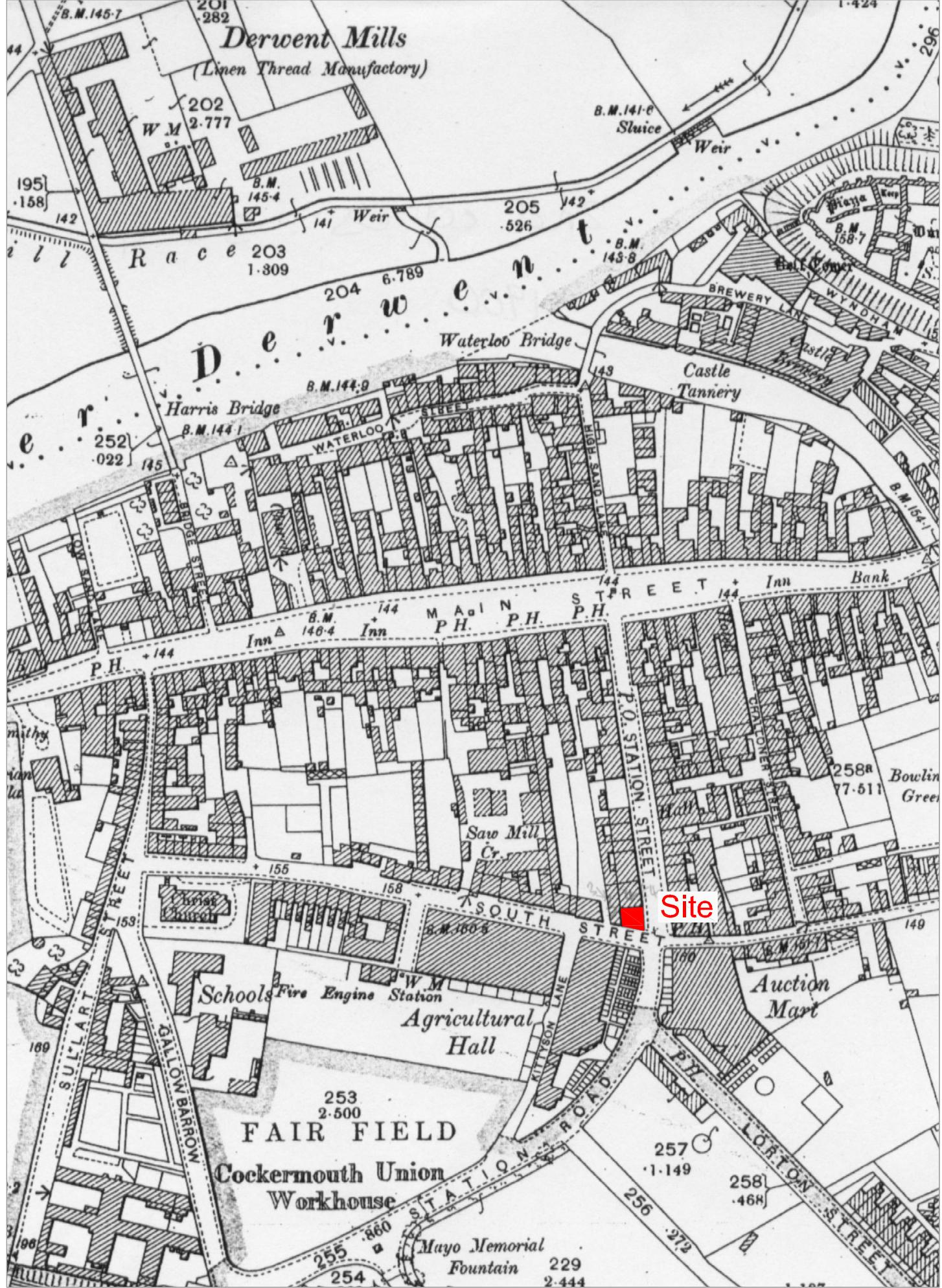

Figure 6: Extract of Second Edition Ordnance Survey map (1900)

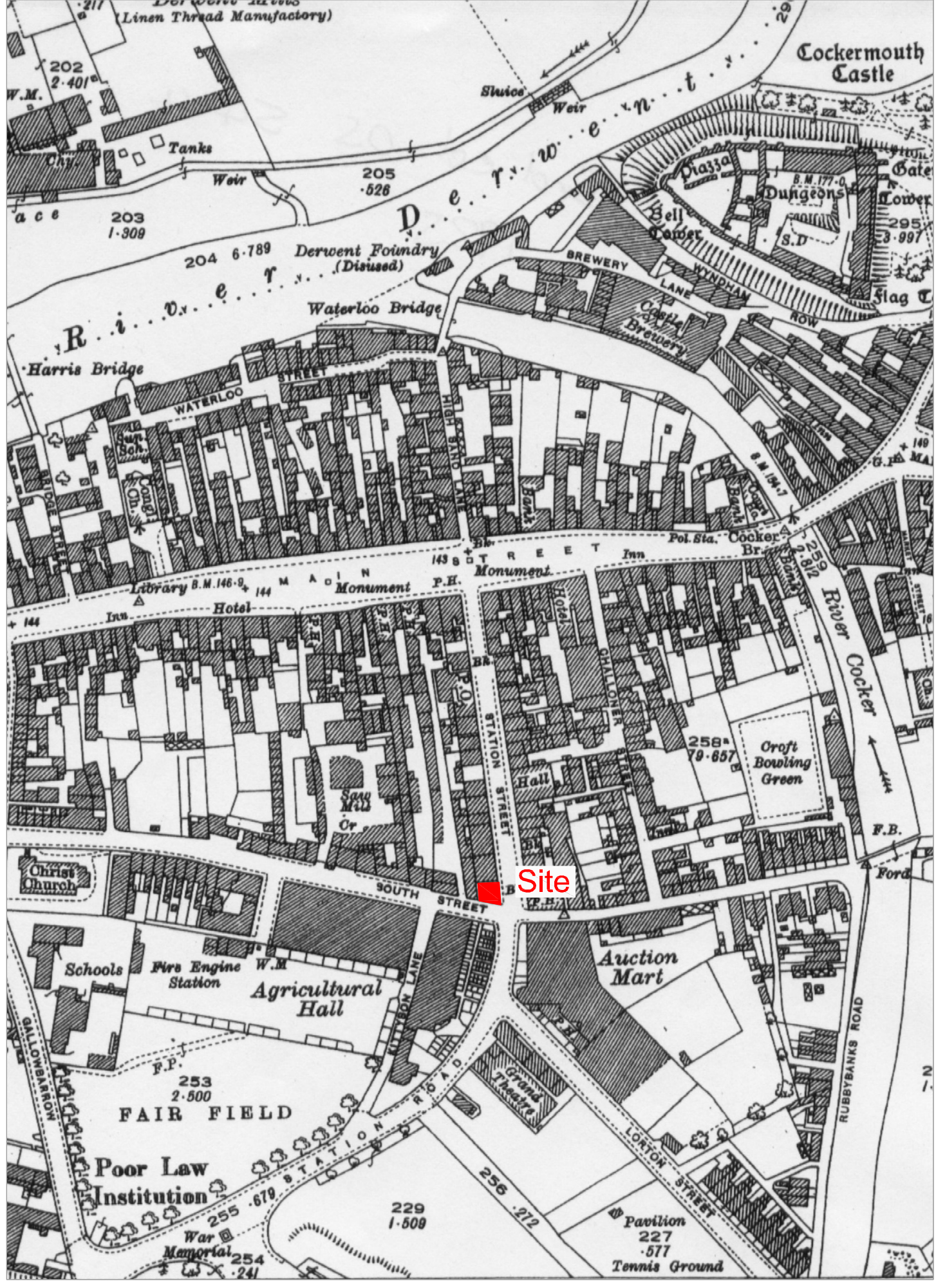
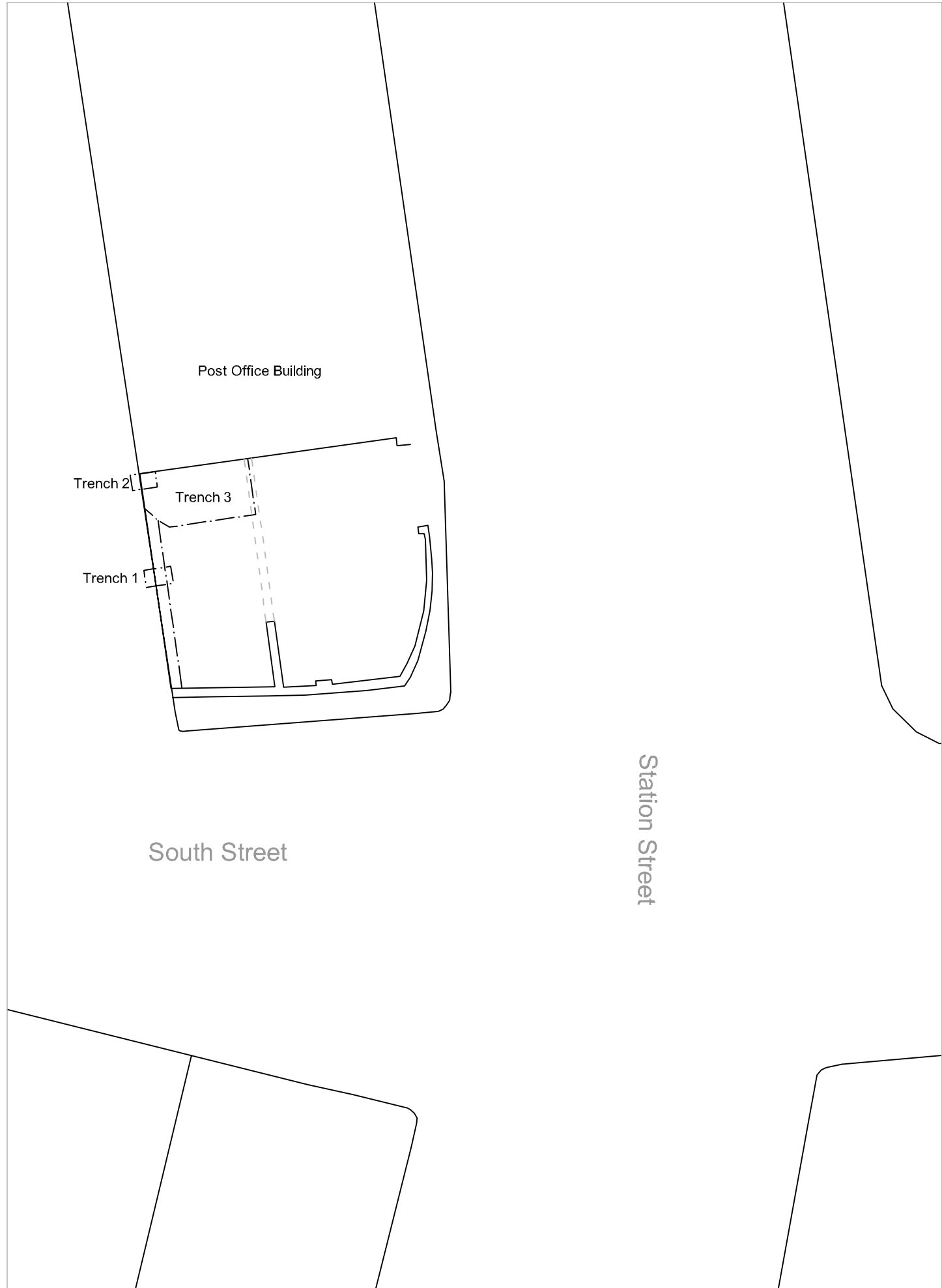

Figure 7: Extract of Third Edition Ordnance Survey map (1925)



▲ Reproduced from the Landranger 1:10,000 scale by permission of the Ordnance Survey on behalf of The Controller of Her Majesty's Stationery Office. © Crown copyright 1990. All rights reserved.
 N Licence No AL 100005569

0 10m
 Scale 1:500 at A4



Figure 8: Trench Location Plan

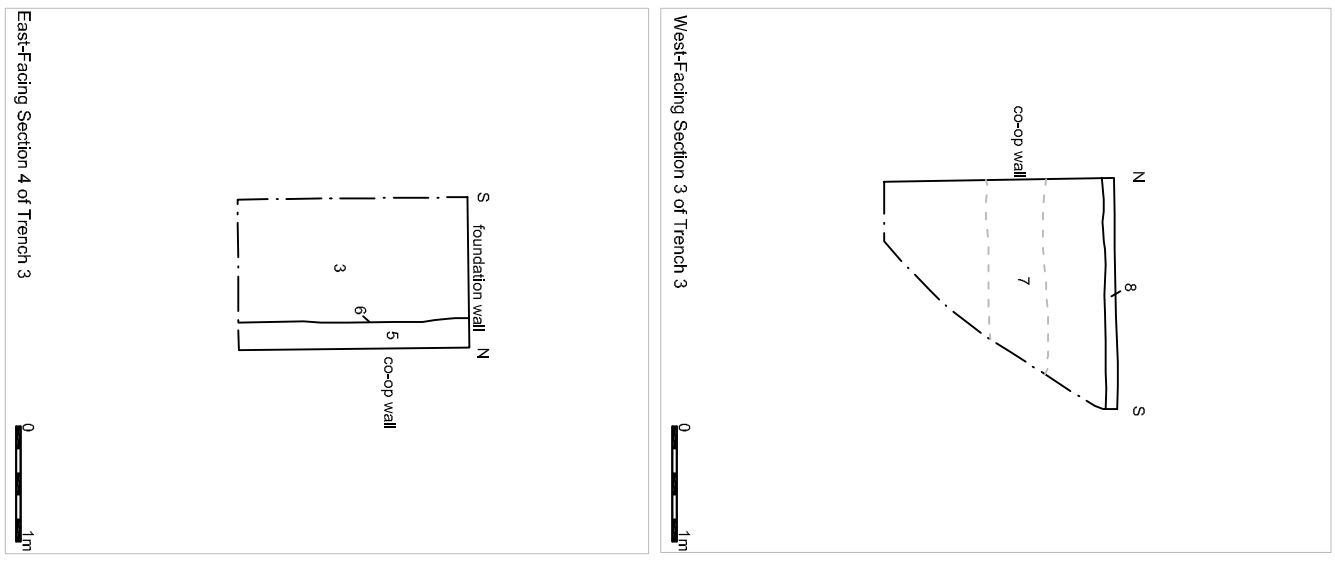
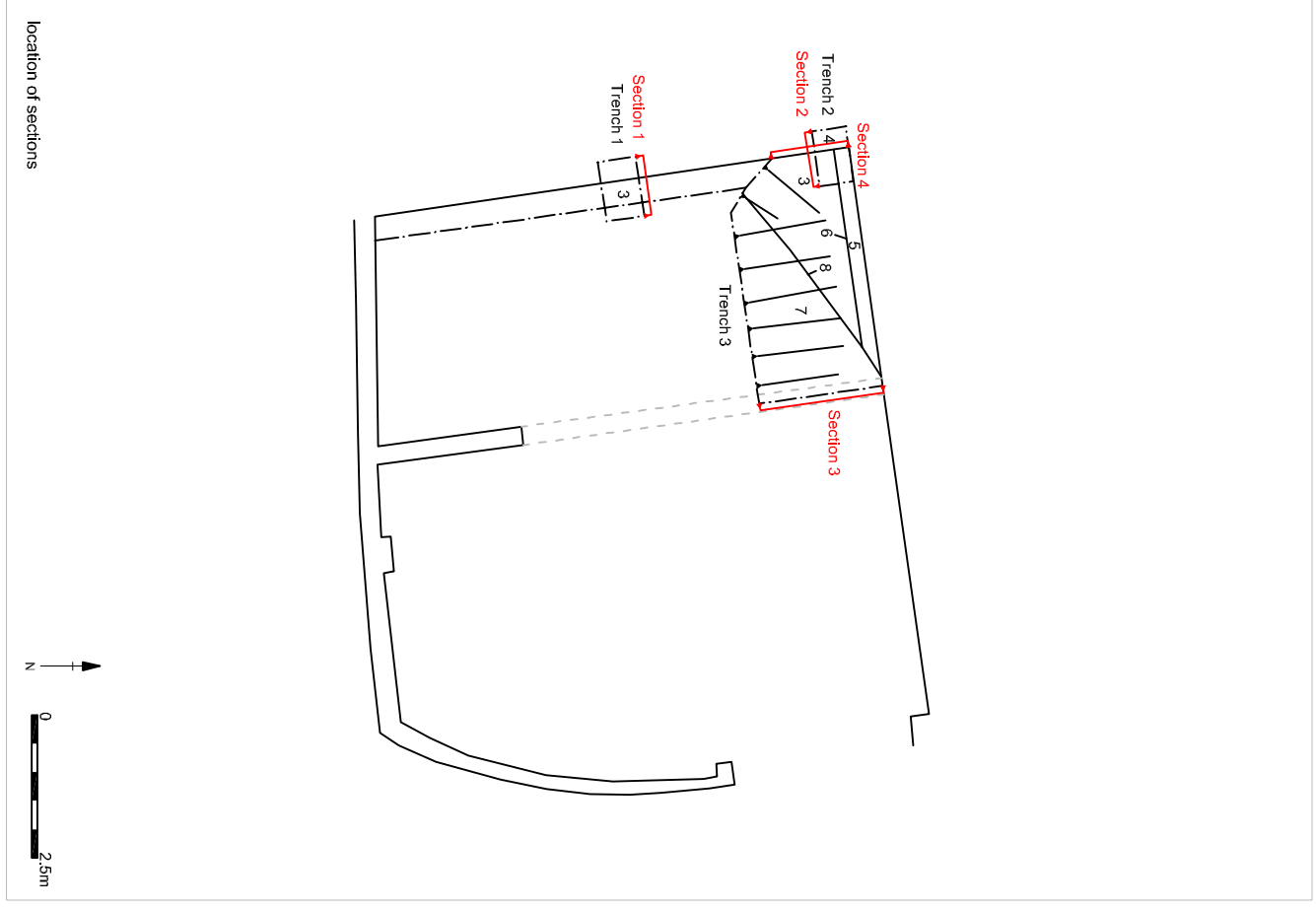
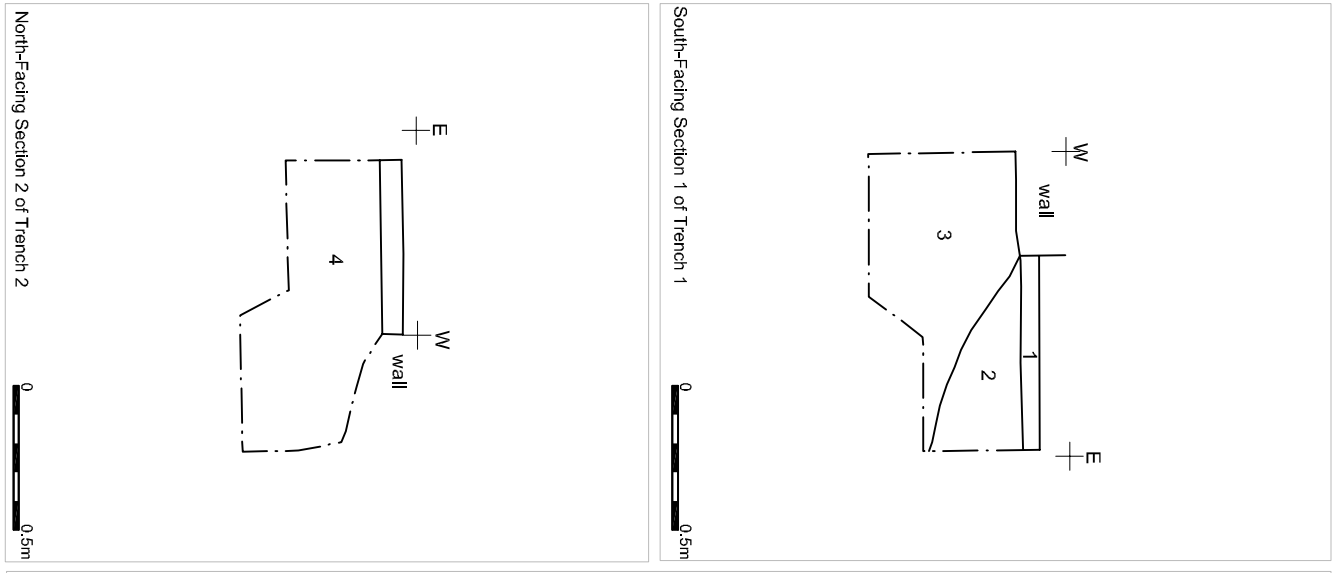

Figure 9: Plans and Sections of Trenches 1, 2 and 3 with Section Location Plan



Plate 1: South-facing Section 1 in Trench 1



Plate 2: Post Office wall showing blocked chute, and west-facing section



Plate 3: East-facing Section 4 in Trench 3 showing foundation trench and natural gravel



Plate 4: cut of Pit 8 in section within Trench 3, facing east

APPENDIX 1. PROJECT DESIGN

**Oxford
Archaeology
North**

May 2004

PROPOSED FLATS, STATION STREET, COCKERMOUTH, CUMBRIA

ARCHAEOLOGICAL DESK-BASED ASSESSMENT AND WATCHING BRIEF PROJECT DESIGN

Proposals

The following project design is offered in response to a request by Architects Plus for an archaeological desk-based assessment and watching brief of an area outlined for a proposed commercial and residential development on Station Street, Cockermouth, Cumbria.

1. INTRODUCTION

1.2 BACKGROUND

- 1.2.1 Architects Plus (hereafter the 'client') has requested that Oxford Archaeology North (OA North) submit proposals for an archaeological investigation of the Co-op and Post Office on Station Street, Cockermouth, Cumbria (centred NY 3120 3056), which is outlined for redevelopment as a retail unit and flats. These proposals have been prepared in accordance with a brief provided by Cumbria County Council Archaeology Service (CCCAS) in response to consultation with Allerdale Borough Council regarding the planning application (Planning Application No 2/03/1170) for the proposed development.
- 1.2.2 The area surrounding the site has been designated as an area of high archaeological importance by the Cumbria Extensive Urban Survey. The proposed development is situated within the medieval core of the town of Cockermouth, which grew up around the castle first erected by the Normans in 1134. The castle was constructed from stone mainly from the Roman fort of *Deventio* at Papcastle, approximately a mile to the north of the present town, on the intersection of roads from Maryport, Carlisle, and Penrith. Significant additions were made to the castle in the thirteenth and fourteenth centuries, mainly as a result of the wars with Scotland when it was sacked several times and the town plundered and put to the sword most notably by William Wallace and Robert the Bruce. The castle played a significant role in the Wars of the Roses, and the Civil Wars of the 1640's when it was besieged. After this it was dismantled on the orders of Parliament, and much of it is still in a ruinous condition.
- 1.2.3 The town received a borough charter in 1210, and much of the medieval street plan remains today. The site lies within an area of medieval tenements, and two archaeological investigations undertaken in the town centre have revealed medieval deposits and artefacts.
- 1.2.4 Cockermouth became prosperous much later, in the early part of the nineteenth century, with the advent of water mills. However, this fortune was reversed when steam overtook water power in later half of the same century.
- 1.2.5 Further afield, the earliest known activity in the surrounding area can be seen in the form of Elva Plain Stone Circle, which lies on a level terrace on the southern slope of Elva Hill. It consist of 15 of the original 30 stones, of which the tallest is just under one metre, to form an almost perfect circle some 40m in diameter. The site is likely to be of Neolithic origin, and has been linked with the trade in Neolithic axes. The route was from the factory sites in the central fells through Borrowdale and over the hills east of Bassenthwaite.

1.3 OXFORD ARCHAEOLOGY NORTH

- 1.3.1 OA North has considerable experience of the assessment of sites of all periods, having undertaken a great number of small and large-scale projects during the past 23 years. Such projects have taken place within the planning process, to fulfil the requirements of clients and planning authorities, to very rigorous timetables. In recent years OA North also has extensive experience of archaeological work in Northern England. Examples of work in the vicinity include investigations at Appleby, Brampton, Brougham Castle, Longtown, Penrith, Kendal, Hackthorpe, Dacre, Fremington, Eamont Bridge, as well as extensive investigations on Askham Fell. These investigations have been varied from desk-based studies and landscape surveys to excavations. More specifically, OA North has extensive experience of Carlisle through our work and expertise in the Carlisle Millennium Project, and of Hadrian's Wall both from the commercial aspect, ie water improvement projects, through to our Assistant Director, Rachel Newman, who is the consultant to the Countryside Agency in the development to the Hadrian's Wall National Trail.
- 1.3.2 OA North has the professional expertise and resources to undertake the project detailed below to a high level of quality and efficiency. OA North is **an Institute of Field Archaeologists (IFA) registered organisation, registration number 17**, and all its members of staff operate subject to the IFA Code of Conduct.

2 OBJECTIVES

- 2.1 The following programme has been designed according to a brief prepared by CCCAS to identify any surviving archaeological deposits and provide for accurate recording of any archaeological remains that are disturbed by ground works for the proposed development.
- 2.2 **Desk-based assessment:** to provide a low level desk-based assessment of the site.
- 2.3 **Watching brief:** to carry out a watching brief during associated ground disturbance, to determine the quality, extent and importance of any archaeological remains on the site.
- 2.4 **Report and Archive:** a report will be produced for the client within eight weeks of completion of the fieldwork. A site archive will be produced to English Heritage guidelines (MAP 2) and in accordance with the *Guidelines for the Preparation of Excavation Archives for Long Term Storage* (UKIC 1990).

3 METHOD STATEMENT

3.1 DESK-BASED ASSESSMENT

- 3.1.1 A rapid desk-based study will be undertaken as appropriate, depending on the availability of source material. The level of such work will be dictated by the timescale of the project.
- 3.1.2 **Documentary and cartographic material:** this work will consult the range of potential sources of information, both primary and secondary, at the Cumbria Sites and Monuments Record, including OS 1st Edition maps (both 6" to 1 mile and 25" to 1 mile). Published documentary sources will also be examined and assessed as appropriate.

3.2 WATCHING BRIEF

- 3.2.1 It is proposed that within the area of development all topsoil stripping, footings, service trenches and trench cutting will be undertaken during a programme of field observation. This will accurately record the location, extent, and character of any surviving archaeological features and/or deposits within the proposed ground disturbance. This work will comprise observation during the excavation for these works, the systematic examination of any subsoil horizons exposed during the course of the ground works, and the accurate recording of all archaeological features and horizons, and any artefacts, identified during observation.
- 3.2.2 Putative archaeological features and/or deposits identified by the machining process, together with the immediate vicinity of any such features, will be cleaned by hand, using either hoes, shovel scraping, and/or trowels depending on the subsoil conditions, and where appropriate sections will be studied and drawn. Any such features will be sample excavated (i.e. selected pits and postholes will normally only be half-sectioned, linear features will be subject to no more than a 10% sample, and extensive layers will, where possible, be sampled by partial rather than complete removal).
- 3.2.3 It is assumed that OA North will have the authority to stop the works for a sufficient time period to enable the recording of important deposits. It may also be necessary to call in additional archaeological support if a find of particular importance is identified or a high density of archaeology is discovered, but this would only be called into effect in agreement with the Client and the County Archaeology Service and will require a variation to costing.
- 3.2.4 During this phase of work, recording will comprise a full description and preliminary classification of features or materials revealed, and their accurate location (either on plan and/or section, and as grid co-ordinates where appropriate). Features will be planned accurately at appropriate scales and annotated on to a large-scale plan provided by the Client. A photographic record will be undertaken simultaneously.
- 3.2.5 A plan will be produced of the areas of ground works showing the location and extent of the ground disturbance and one or more dimensioned sections will be produced.

- 3.2.6 All information identified in the course of the site works will be recorded stratigraphically, using a system, adapted from that used by Centre for Archaeology Service of English Heritage, with sufficient pictorial record (plans, sections and both black and white and colour photographs) to identify and illustrate individual features. Primary records will be available for inspection at all times.
- 3.2.7 Results of all field investigations will be recorded on *pro forma* context sheets. The site archive will include both a photographic record and accurate large scale plans and sections at an appropriate scale (1:50, 1:20 and 1:10). All artefacts and ecofacts will be recorded using the same system, and will be handled and stored according to standard practice (following current Institute of Field Archaeologists guidelines) in order to minimise deterioration.
- 3.2.8 The deposition and disposal of any artefacts recovered in the evaluation will be agreed with the legal owner and an appropriate recipient museum prior to the work taking place.
- 3.2.9 Where environmental deposits are encountered, an appropriate sampling strategy will be agreed with CCCAS. (Environmental sampling would be subject to a variation to this project design).
- 3.2.10 **Human burials:** should evidence of burials be identified, the 1857 Burial Act would apply and a Home Office Licence would be sought. This would involve all work ceasing until the proper authorities were satisfied that the burials could be removed. In normal circumstances, field recording will also include a continual process of analysis, evaluation, and interpretation of the data, in order to establish the necessity for any further more detailed recording that may prove essential.
- 3.2.11 **Health and Safety:** OA North provides a Health and Safety Statement for all projects and maintains a Unit Safety policy. All site procedures are in accordance with the guidance set out in the Health and Safety Manual compiled by the Standing Conference of Archaeological Unit Managers (1997). A written risk assessment will be undertaken in advance of project commencement and copies will be made available on request to all interested parties.

3.3 ARCHIVE/REPORT

- 3.3.1 **Archive:** the results of all archaeological work carried out will form the basis for a full archive to professional standards, in accordance with current English Heritage guidelines (*Management of Archaeological Projects*, 2nd edition, 1991). The project archive represents the collation and indexing of all the data and material gathered during the course of the project. The deposition of a properly ordered and indexed project archive in an appropriate repository is considered an essential and integral element of all archaeological projects by the IFA in that organisation's code of conduct. OA North conforms to best practice in the preparation of project archives for long-term storage. This archive will be provided in the English Heritage Centre for Archaeology format and a synthesis will be submitted to the CSMR (the index to the archive and a copy of the report). OA North practice is to deposit the original record archive of projects (paper, magnetic and plastic media) with the County Record Office, and a full copy of the record archive (microform or microfiche) together with the material archive (artefacts, ecofacts, and samples) with an appropriate museum. Wherever possible, OA North recommends the deposition of such material in a local museum approved by the Museums and Galleries Commission, and would make appropriate arrangements with the designated museum at the outset of the project for the proper labelling, packaging, and accessioning of all material recovered.
- 3.3.2 The Arts and Humanities Data Service (AHDS) online database project *Online Access to index of Archaeological Investigations* (OASIS) will be completed as part of the archiving phase of the project.
- 3.3.3 **Report:** one bound and one unbound copy of a written synthetic report will be submitted to the client, and a further three copies submitted to the Cumbria SMR within eight weeks of

completion. A further copy will also be offered to the National Monuments Record. The report will include;

- a site location plan related to the national grid
- a front cover to include the planning application number and the NGR
- the dates on which the fieldwork was undertaken
- a concise, non-technical summary of the results
- an explanation to any agreed variations to the brief, including any justification for any analyses not undertaken
- a description of the methodology employed, work undertaken and results obtained
- plans and sections at an appropriate scale showing the location and position of deposits and finds located
- a list of and dates for any finds recovered and a description and interpretation of the deposits identified
- a description of any environmental or other specialist work undertaken and the results obtained
- a predictive model of surviving archaeological remains detailing zones of relative importance against known development proposals and an impact assessment will be provided, where possible. However, no recommendations regarding any subsequent mitigation will be included.
- a copy of this project design, and indications of any agreed departure from that design
- the report will also include a complete bibliography of sources from which data has been derived.

3.3.4 This report will be in the same basic format as this project design; a copy of the report can be provided on CD, if required.

3.3.5 The deposition and disposal of any artefacts recovered in the evaluation will be agreed with the legal owner and an appropriate recipient museum.

3.3.6 The Arts and Humanities Data Service (AHDS) online database project *Online Access to index of Archaeological Investigations* (OASIS) will be completed as part of the archiving phase of the project.

3.3.7 Provision will be made for a summary report to be submitted to a suitable regional or national archaeological journal within one year of completion of fieldwork, if relevant results are obtained.

3.3.8 **Confidentiality:** all internal reports to the client are designed as documents for the specific use of the Client, for the particular purpose as defined in the project brief and project design, and should be treated as such. They are not suitable for publication as academic documents or otherwise without amendment or revision.

4 PROJECT MONITORING

4.1 OA North will consult with the client regarding access to the site. Whilst the work is undertaken for the client, the County Archaeologist will be kept fully informed of the work and its results and will be notified a week in advance of the commencement of the fieldwork.

Any proposed changes to the project design will be agreed with CCCAS in consultation with the client.

5 WORK TIMETABLE

5.1 OA North could commence the archaeological programme of works within a week of receipt of written notification from the client.

5.2 *Desk-based assessment* one day will be required for this element.

5.3 *Watching brief*: the duration of the archaeological presence for the watching brief is thought to be one to two days, being dictated by the schedule of works.

5.4 *Archive/Report*: the report and archive will be produced following the completion of all the fieldwork. The final report will be submitted within eight weeks of completion of the fieldwork and the archive deposited within six months.

6 STAFFING

6.1 The project will be under the direct management of Stephen Rowland (OA North project manager) to whom all correspondence should be addressed

6.2 The watching brief will be supervised in the field by either an OA North supervisor experienced in this type of project. All OA North project officers and supervisors are experienced field archaeologists capable of carrying out projects of all sizes.

6.3 Present timetabling constraints preclude detailing at this stage exactly who will be undertaking the watching brief element of the project.

6.4 Assessment of the finds from the evaluation will be undertaken under the auspices of OA North's in-house finds specialist Sean McPhillips BA (OA North project supervisor). Sean has worked as a finds supervisor for English Heritage and MOLAS on a number of occasions and has extensive knowledge concerning finds.

7 INSURANCE

7.1 OA North has a professional indemnity cover to a value of £2,000,000; proof of which can be supplied as required.

REFERENCES

Association of County Archaeological Officers (ACAO) 1993 *Model briefs and specifications for Archaeological Assessments and Field Evaluations*, Bedford

English Heritage 1991 *Management of Archaeological Projects*, 2nd Edition London

Institute of Field Archaeologists (IFA), 1992 *Guidelines for data collection and compilation* London

SCAUM (Standing Conference of Archaeological Unit Managers), 1991 *Health and Safety Manual*, Poole

APPENDIX 2. CONTEXT LIST

Context	Trench	Description	Interpretation	Depth
<i>1</i>	1,2,3	Concrete	Modern yard surface	0-0.06m
<i>2</i>	1	Greyish-black friable slightly silty-sandy soil	Make-up deposit for <i>1</i>	0.06m-0.36m
<i>3</i>	1&3	Creamy-yellow loose sandy gravel	Natural drift geology	0.06m+
<i>4</i>	2	Friable silty-sandy soil mixed with loose mortar and ash with inclusions of small to medium sub-rounded stones	Make-up deposit for <i>1</i>	0.06m to c 0.5m
<i>5</i>	3	Cut	Foundation cut for southern wall of Post Office	0.06m - c 2m
<i>6</i>	3	Backfill of Cut <i>5</i>	Foundation backfill	0.06m-c 2m
<i>7</i>	3	Homogenous yellowish-brown friable sandy-clay soil with occasional pockets of gravel	Backfill of ?Pit <i>8</i>	0.06m- c 2m
<i>8</i>	3	Cut	Cut of possible pit	0.06m - c 2m

APPENDIX 3. FINDS SUMMARY

All the finds were ceramic, and were retrieved from pit/dump layer 9

Quantity	Description	Date range
1	Red earthenware flower pot base	Nineteenth - twentieth century
2	Black-glazed red earthenware crock base and body fragments	Late seventeenth - early twentieth century
1	Brown-glazed red earthenware hollow-ware base fragment	Late seventeenth - early twentieth century
1	Self-glazed buff-coloured earthenware fragment, abraded	Late eighteenth - early twentieth century
1	White bone china hollow-ware fragment	Nineteenth - twentieth century
1	White earthenware hollow-ware rim	Nineteenth - early twentieth century