

Windmill Farm Clanfield Oxfordshire



Archaeological Watching Brief Report



Oxford Archaeology

March 2004

Client: Westwaddy ADP

Issue N^o: 1

OA Job N^o: 2144

Planning Ref N^o: 01/0751

NGR: SP 2832 0136

Client Name: Westwaddy ADP

Client Ref No:

Document Title: Windmill Farm, Clanfield, Oxfordshire

Document Type: Watching Brief

Issue Number: 1

National Grid Reference: NGR SP 2832 0136

Planning Reference: 01/0751

OA Job Number: 2144

Site Code: BRCWIF 04

Invoice Code: BRCWIFWB

Receiving Museum: Oxfordshire County Museum Service

Museum Accession No: OXCMS 2004.22

Prepared by: James Mumford

Position: Supervisor

Date: 11th March 2004

Checked by: Alan Hardy

Position: Senior Project Manager

Date: 11th March 2004

Approved by: Nick Shepherd

Position: Head of Fieldwork

Date: 22nd March 2004

Signed.....



Document File Location U:/OAU/wbREPORTS/Oxfordshire/BRCWIF.doc

Graphics File Location Server10:/oaupubs 1/AtoH*BRCWIFWB*Windmill

Farm, Clanfield*CL*05.03.04

Illustrated by Christina Large

Disclaimer:

This document has been prepared for the titled project or named part thereof and should not be relied upon or used for any other project without an independent check being carried out as to its suitability and prior written authority of Oxford Archaeology being obtained. Oxford Archaeology accepts no responsibility or liability for the consequences of this document being used for a purpose other than the purposes for which it was commissioned. Any person/party using or relying on the document for such other purposes agrees, and will by such use or reliance be taken to confirm their agreement to indemnify Oxford Archaeology for all loss or damage resulting therefrom. Oxford Archaeology accepts no responsibility or liability for this document to any party other than the person/party by whom it was commissioned.

Oxford Archaeology

© Oxford Archaeological Unit Ltd 2004

Janus House

Osney Mead

Oxford OX2 0ES

t: (0044) 01865 263800

f: (0044) 01865 793496

e: info@oxfordarch.co.uk

w: www.oxfordarch.co.uk

Oxford Archaeological Unit Limited is a Registered Charity No: 285627

Windmill Farm, Clanfield, Oxfordshire

ARCHAEOLOGICAL WATCHING BRIEF REPORT

CONTENTS

Summary.....	1
1 Introduction	1
1.1 Location and scope of work	1
1.2 Geology and topography	1
1.3 Archaeological and historical background.....	1
2 Project Aims and Methodology.....	2
2.1 Aims	2
2.2 Methodology.....	2
3 Results	2
3.1 Description of deposits.....	2
3.2 Finds	2
3.3 Palaeo-environmental remains	2
4 Discussion and Conclusions	2
Appendix 1 Archaeological Context Inventory	3
Appendix 2 Bibliography and References	3
Appendix 3 Summary of Site Details.....	3

LIST OF FIGURES

- Fig. 1 Site location
Fig. 2 Site location of new building and new service trench.
Fig. 3 Plan of Proposed Building foundations and location of sections
Fig. 4 Sections 1 and 2

SUMMARY

From January to February 2004 Oxford Archaeology (OA) carried out an archaeological watching brief at Windmill Farm, Clanfield, Oxfordshire (NGR SP 2832 0136). The work was commissioned by Westwaddy ADP in advance of construction of ancillary accommodation, including a new residential block and conversion of an agricultural building into an activities and dining room. The watching brief revealed no archaeological features or deposits and suggests that the site was arable farmland prior to being covered by the present farmyard surface.

1 INTRODUCTION

1.1 Location and scope of work

1.1.1 From January to February 2004 Oxford Archaeology (OA) carried out an archaeological watching brief at Windmill Farm, Clanfield, Oxfordshire (Fig. 1). The work was commissioned by Westwaddy ADP in respect of a planning application for construction of ancillary accommodation, including a new residential block and conversion of an agricultural building into an activities and dining room (Planning Application No. 01/0751).

1.1.2 A project brief was set by Hannah Fluck, Planning Archaeologist for West Oxfordshire District Council (OCAS 2003).

1.1.3 OA prepared a Written Scheme of Investigation (WSI) detailing how it would meet the requirements of the brief.

1.2 Geology and topography

1.2.1 The site lies on Oxford Clay with Kellaway beds at 69.65 m above OD. The site is situated on the west side of the Main Street, Clanfield, and is presently utilised as the Windmill Barn Centre.

1.3 Archaeological and historical background

1.3.1 The archaeological background to the watching brief was prepared for the WSI for the project (OA 2004) and is reproduced below.

1.3.2 The first edition Ordnance Survey Map of 1881 shows a windmill on the site of the proposed development.

1.3.3 In the field to the west of the proposed development Romano-British coins and pottery have been found. The variation in pottery types suggests the presence of a settlement or farmstead in the near vicinity.

2 PROJECT AIMS AND METHODOLOGY

2.1 Aims

- 2.1.1 To identify and record the presence/absence, extent, condition, quality and date of archaeological remains in the areas affected by the development.
- 2.1.2 To make available the results of the archaeological investigation.

2.2 Methodology

- 2.2.1 The watching brief was maintained while a new service trench was excavated. The foundations were then excavated and concrete poured, followed by the ground reduction within the new building and hardcore laid. This was carried out with a JCB and mini excavator under archaeological observation (Fig. 2).
- 2.2.2 All archaeological features were planned at a scale of 1:100 and where excavated their sections drawn at scales of 1:20. All excavated features were photographed using colour slide and black and white print film. A general photographic record of the work was made. Recording followed procedures detailed in the *OAU Fieldwork Manual* (ed. D Wilkinson, 1992).

3 RESULTS

3.1 Description of deposits (Figs 3 and 4, Sections 1 and 2)

- 3.1.1 The service trench was 0.6 m wide and 1 m in depth and did not reveal any archaeological deposits or features and had the same series of deposits as the foundation trenches.
- 3.1.2 The foundation trenches were between 0.6 and 0.8 m wide and to a depth of 1 m to 1.1 m below the farmyard surface. They cut into a natural (4) of dark yellow brown sandy gravel with bands of clay. Overlying this was a 0.16 m - 0.4 m thick layer of dark brown silty sand loam (3), an old topsoil which was sealed by a 0.15 m compact layer of broken concrete, tarmac, brick and patches of gravel (2) representing hardcore to the concrete (1) surface of the farmyard.

3.2 Finds

- 3.2.1 No finds were recovered from the watching brief.

3.3 Palaeo-environmental remains

- 3.3.1 No deposits suitable for environmental sampling were identified during the watching brief.

4 DISCUSSION AND CONCLUSIONS

- 4.1.1 The results from the watching brief showed that there were no archaeological features or deposits within the area of development. This suggests that the site was arable farmland until covered as part of the farmyard.

APPENDICES

APPENDIX 1 ARCHAEOLOGICAL CONTEXT INVENTORY

<i>Context</i>	<i>Type</i>	<i>Depth</i>	<i>Width</i>	<i>Height</i>	<i>Comments</i>	<i>Finds</i>
1	Layer	0.15 m			Concrete	
2	Layer	0.15 m			Hardcore	
3	Layer	0.16 m - 0.40 m			Old Topsoil	
4	Natural				Gravel and silty clay	

APPENDIX 2 BIBLIOGRAPHY AND REFERENCES

OCAS 2003 *Windmill Barn, Windmill Farm, Clanfield* Design Brief for Archaeological Watching Brief

OA 2004 *Windmill Farm, Clanfield, Oxfordshire* Written Scheme of Investigation for an Archaeological Watching Brief

Wilkinson D (Ed), 1992 *Oxford Archaeological Unit Field Manual*

APPENDIX 3 SUMMARY OF SITE DETAILS

Site name: Windmill Farm, Clanfield, Oxfordshire

Site code: BRCWIF 04

Grid reference: NGR SP 2832 0136

Type of watching brief: Ground works for construction of new building and redevelopment of farm buildings.

Date and duration of project: A total of nine site visits from 26th January to 24th February 2004.

Area of site: 22 m x 25 m

Summary of results: The watching brief revealed no archaeological features or deposits and suggests that site was arable farmland prior to being covered by present farmyard surface.

Location of archive: The archive is currently held at OA, Janis House, Onset Mead, Oxford, OX2 0ES, and will be deposited with Oxfordshire County Museums Service in due course, under the following accession number: OXCMS 2004.22

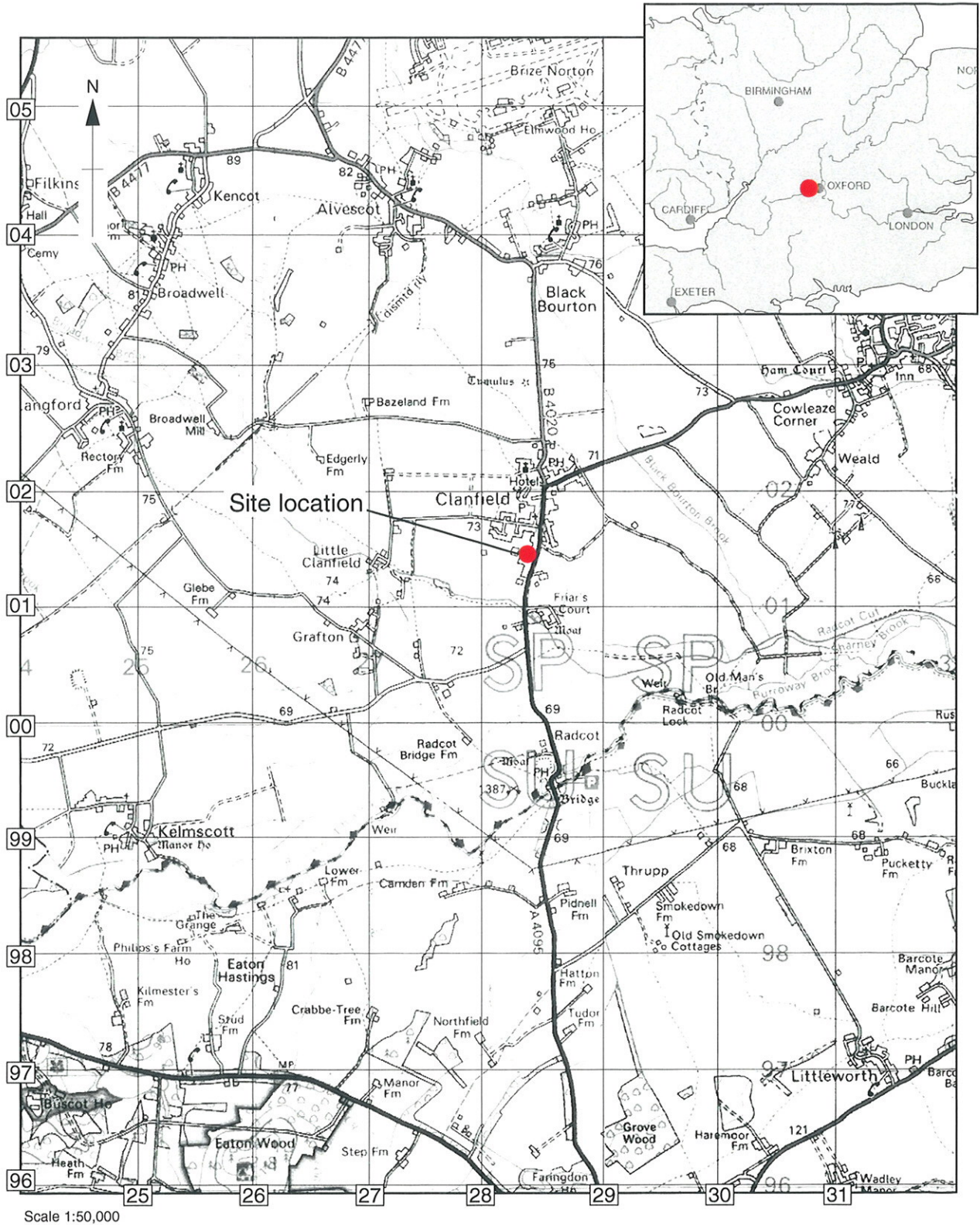

Scale 1:50,000

Reproduced from the Landranger 1:50,000 scale by permission of the Ordnance Survey on behalf of The Controller of Her Majesty's Stationery Office
© Crown Copyright 2000. All rights reserved. Licence No. AL 100005569

Figure 1: Site location

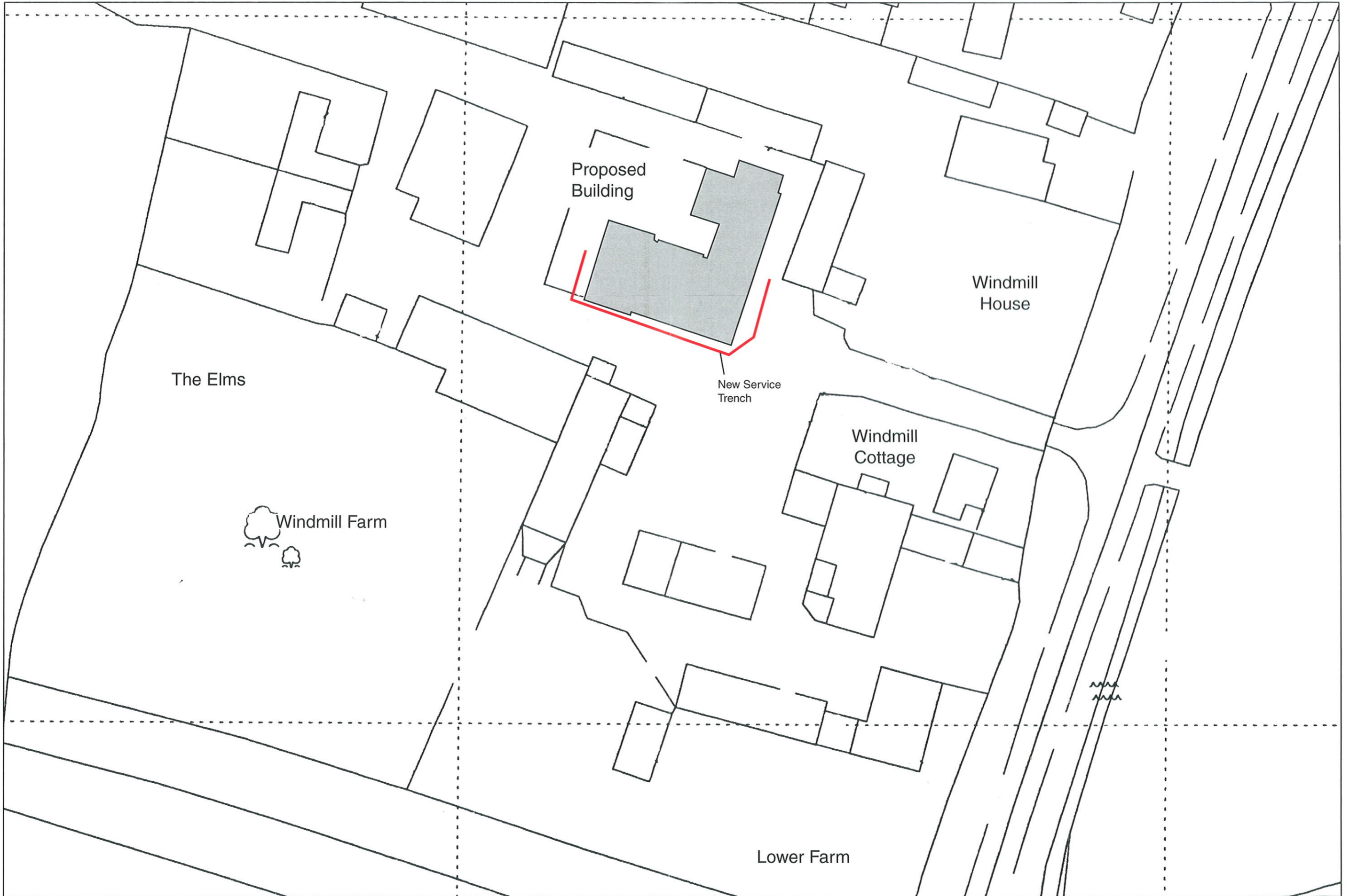

Figure 2: Location of new building and new service trench

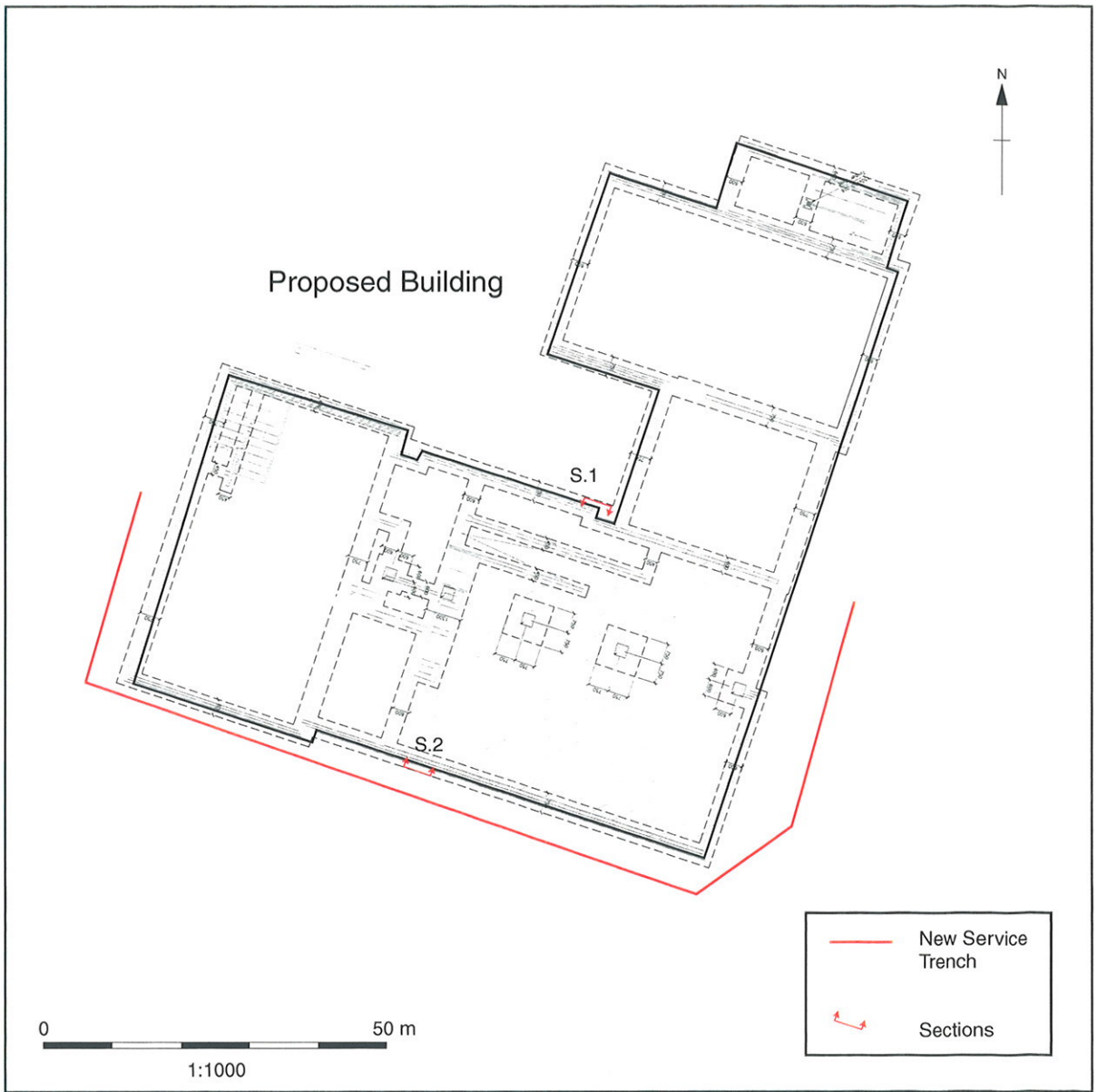
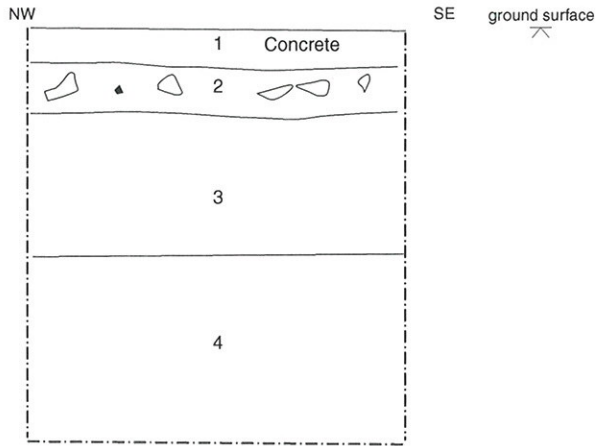

Figure 3: Plan of Proposed Building foundations and location of sections

Section 1



Section 2

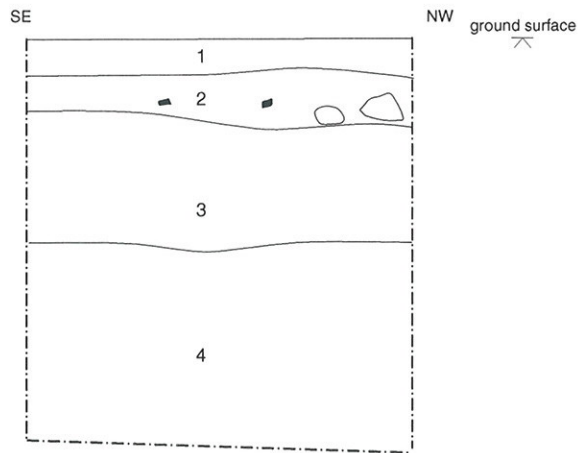

Figure 4: Sections 1 and 2



Oxford Archaeology

Janus House
Osney Mead
Oxford OX2 0ES

t: (0044) 01865 263800
f: (0044) 01865 793496
e: info@oxfordarch.co.uk
w: www.oxfordarch.co.uk



Oxford Archaeology North

Storey Institute
Meeting House Lane
Lancaster LA1 1TF

t: (0044) 01524 541000
f: (0044) 01524 848606
e: lancinfo@oxfordarch.co.uk
w: www.oxfordarch.co.uk



Director: David Jennings, BA MIFA FSA

Oxford Archaeological Unit is a
Private Limited Company, N^o: 1618597
and a Registered Charity, N^o: 285627

Registered Office:

Oxford Archaeological Unit
Janus House, Osney Mead, Oxford OX2 0ES