

Land adjacent to
Amwell Place
Cholsey
Oxfordshire

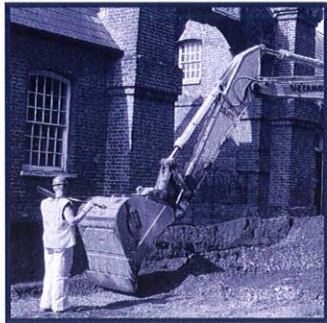

Archaeological Watching Brief



Oxford Archaeology

16th September 2002

Client Name: Domek & Co

Issue N^o: 1

OA Job N^o: 1509

Planning Ref N^o: P00/W0898

NGR: SU 589 865

Client Name: Domek & Co, Building & Planning Consultants
Client Ref No:
Document Title: Land Adjcent to Amwell Place, Cholsey, Oxfordshire
Document Type: Watching Brief
Issue Number: 1
National Grid Reference: NGR SU 589 865
Planning Reference: P00/W0898
OA Job Number: 1509
Site Code: CHAMP 02
Invoice Code: CHAMPWB
Receiving Museum: Oxfordshire County Museums Service
Museum Accession No: OXCMS 2002.178

Prepared by: James Mumford
Position: Supervisor
Date: 17th September 2002

Checked by: Greg Pugh
Position: Contracts Manager
Date: 20th September 2002

Approved by: Robert Williams
Position: Director, Head of Business and Operations
Date: 17th September 2002

Signed.....

Document File Location: U:\OAU\wbREPORTS\Oxfordshire\CHAMP.doc
Graphics File Location: Server 4(W):\oaupubs 1/All drawings*CHAMPWB02*Amwell Place*JM*16.09.02
Illustrated by: Julia Moxham

Disclaimer:

This document has been prepared for the titled project or named part thereof and should not be relied upon or used for any other project without an independent check being carried out as to its suitability and prior written authority of Oxford Archaeology being obtained. Oxford Archaeology accepts no responsibility or liability for the consequences of this document being used for a purpose other than the purposes for which it was commissioned. Any person/party using or relying on the document for such other purposes agrees, and will by such use or reliance be taken to confirm their agreement to indemnify Oxford Archaeology for all loss or damage resulting therefrom. Oxford Archaeology accepts no responsibility or liability for this document to any party other than the person/party by whom it was commissioned.

Oxford Archaeology

© Oxford Archaeological Unit Ltd 2002

Janus House
Osney Mead
Oxford OX2 0ES
t: (0044) 01865 263800
f: (0044) 01865 793496

e: info@oxfordarch.co.uk
w: www.oxfordarch.co.uk

Oxford Archaeological Unit Limited is a Registered Charity No: 285627

Land Adjacent to 10 Amwell Place, Cholsey, Oxfordshire

ARCHAEOLOGICAL WATCHING BRIEF REPORT

CONTENTS

Summary.....	2
1 Introduction	2
1.1 Location and scope of work	2
1.2 Geology and topography	2
1.3 Archaeological and historical background	2
2 Project Aims and Methodology.....	3
2.1 Aims	3
2.2 Methodology.....	3
3 Results	3
3.1 Description of deposits	3
3.2 Discussion And Conclusions.....	3
3.3 Finds	3
3.4 Palaeo-environmental remains	4
Appendix 1 Archaeological Context Inventory	5
Appendix 2 Bibliography and references.....	5
Appendix 3 Summary of Site Details.....	5

LIST OF FIGURES

- Fig. 1 OS Site location
- Fig. 2 Site location
- Fig. 3 Site Plan
- Fig. 4 Sections

SUMMARY

In September 2002 Oxford Archaeology carried out an archaeological watching brief at land adjacent to 10 Amwell Place, Cholsey, Oxfordshire (NGR SU 589 865). The work was commissioned by Domek & Co in advance of the construction of a house and services. The watching brief revealed no archaeological features other than 19th century garden features relating to reed beds for basket weaving.

1 INTRODUCTION

1.1 Location and scope of work

1.1.1 In September 2002 Oxford Archaeology (OA) carried out an archaeological watching brief at land adjacent to 10 Amwell Place, Cholsey, Oxfordshire (Fig. 1). The work was commissioned by Domek & Co in respect of a planning application for the construction of a house and services (Planning Application No. P00/W0898).

1.1.2 A project brief was set by Paul Smith, County Archaeological Officer for Oxfordshire County Council.

1.1.3 OA prepared a Written Scheme of Investigation detailing how it would meet the requirements of the brief.

1.2 Geology and topography

1.2.1 The site lies on Lower Chalk at c50 m above OD. The site is situated off Amwell Place to the west and is c0.1 hectares in area.

1.3 Archaeological and historical background

1.3.1 The archaeological background to the watching brief was prepared for the WSI for the project (OA, 2002) and is reproduced below.

1.3.2 The Dorchester-Silchester Roman Road runs less than 50 m to the west of the application area and Roman occupation remains have been found nearby. A coin of Constantine 1st (PRN 7638) was found less than 100 m north-west of the development site, whilst a number of Roman coins of 3rd-4th century date have been found to the west of Honey Lane (PRN 2686, 7953).

1.3.3 A Saxon glass bead was found in 1965 on the western side of Cholsey (PRN 7637). Medieval occupation evidence has been identified less than 50 m from the application area (PRN 879) and further medieval remains were recorded at Cholsey Vicarage in 1992 (PRN 5941).

1.3.4 In November 1999 the Oxford Archaeological Unit (OAU, now Oxford Archaeology) carried out a field evaluation at 10 Amwell Place, Cholsey (just to the south of the development) followed by a watching brief in 2001. A medieval pit and a medieval and post-medieval ditch were identified here. A watching brief at land to the rear of Paternoster Lane recorded a post medieval ditch enclosure (OA, 2001).

2 PROJECT AIMS AND METHODOLOGY

2.1 Aims

- 2.1.1 To identify and record the presence/absence, extent, condition, quality and date of archaeological remains in the areas affected by the development.
- 2.1.2 To make available the results of the archaeological investigation.

2.2 Methodology

- 2.2.1 The area of the development site was firstly cleared and about 0.1 m of topsoil was removed. The foundations of the new house were then marked out and excavated with a mini excavator using a 0.7 m wide toothless bucket. These were excavated to a depth of 7.5 m into the chalk or to the base of any feature.
- 2.2.2 All archaeological features were planned at a scale of 1:100 and where excavated their sections drawn at scales of 1:20. All excavated features were photographed using colour slide and black and white print film. A general photographic record of the work was made. Recording followed procedures detailed in the *OAU Fieldwork Manual* (ed D Wilkinson, 1992).

3 RESULTS

3.1 Description of deposits

- 3.1.1 The foundation trenches cut through a dark greyish brown silty clay loam garden topsoil (1). This overlay a number of features, which consisted of the following. The first was a garden feature (2) and was observed in section with a shallow concave profile which measured 0.7 x 2.8 x 0.3 m. It was filled by a loose silty clay (3) with a lot of flint nodules and gravel. This was cut by a hole for a garden plant (4) with near vertical sides and flat base measuring 0.6 m wide and 0.32 m deep. This was filled by a dark brown silty clay loam (5) (Fig. 4, Section 1).
- 3.1.2 The other features were four large circular pits (7, 9, 11 & 13) with very steep sloping sides and concave bases. These were all filled with a dark greyish brown silty clay loam (8, 10, 12 & 14). Fill 10 did contain some late 19th century garden rubbish of ash, brick and roofing slate fragments. These features were thought to be for reed beds for basket weaving (Figs 4, Section 2), which is known to have taken place on the site. All these features cut into the natural chalk (6) of the site.

3.2 Discussion And Conclusions

- 3.2.1 The results from the watching brief revealed no archaeological features other than 19th century garden features, which consisted of a number of large sub circular pits laid out in regular pattern and are thought to be for reed beds for basket weaving. This information was passed to the builder from an old villager who can remember this small cottage industry being carried out in the early to mid 20th century.

3.3 Finds

3.3.1 No finds were recovered from the watching brief.

3.4 **Palaeo-environmental remains**

3.4.1 No environmental samples were taken during the watching brief.

APPENDICES

APPENDIX 1 ARCHAEOLOGICAL CONTEXT INVENTORY

<i>Context</i>	<i>Type</i>	<i>Depth</i>	<i>Width</i>	<i>Length</i>	<i>Comments</i>	<i> Finds</i>
1	Layer	0.3-4 m			Garden Topsoil	None
2	Cut	0.3 m	0.7 m	2.8 m	Garden feature	
3	Fill				Fill of 2	None
4	Cut	0.32 m	0.6 m		Cut for plant	
5	Fill				Fill of 4	None
6	Natural				Chalk Natural	
7	Cut	0.7 m	0.3 m	1.3 m	Sub circular cut for reed bed in garden.	
8	Fill				Fill of feature 7	None
9	Cut	0.7 m	0.7 m	1.3 m	Sub circular cut for reed bed in garden.	
10	Fill				Fill of feature 9	None
11	Cut	1.2 m	0.7 m	3.5 m	Sub circular cut for reed bed in garden.	
12	Fill				Fill of feature 11	None
13	Cut	0.8 m	0.5 m	2.7 m	Sub circular cut for reed bed in garden.	
14	Fill				Fill of feature 13	None

APPENDIX 2 BIBLIOGRAPHY AND REFERENCES

OA 2002, *Land adjacent to 10 Amwell Place, Cholsey, Oxfordshire* Written Scheme of Investigation

OA 2001, *10 Amwell Place and land rear of Paternoster Lane, Wantage, Oxfordshire* Archaeological Watching Brief

D Wilkinson, 1992, *OAU Fieldwork Manual*

APPENDIX 3 SUMMARY OF SITE DETAILS

Site name: Land Adjacent to 10 Amwell Place, Cholsey, Oxfordshire

Site code: CHAMP 02

Grid reference: NGR SU 589 865

Type of watching brief: Ground work for the construction of new house.

Date and duration of project: Two site visits from the 5/9/2002 to 6/9/2002.

Area of site: 10 m x 15.5 m

Summary of results: The watching brief revealed no archaeological features other than 19th century garden features, possibly relating to reed beds for basket weaving.

Location of archive: The archive is currently held at OA, Janus House, Osney Mead, Oxford, OX2 0ES, and will be deposited with Oxfordshire County Museums Service in due course, under the following accession number: OXCMS 2002.178

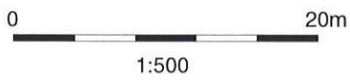
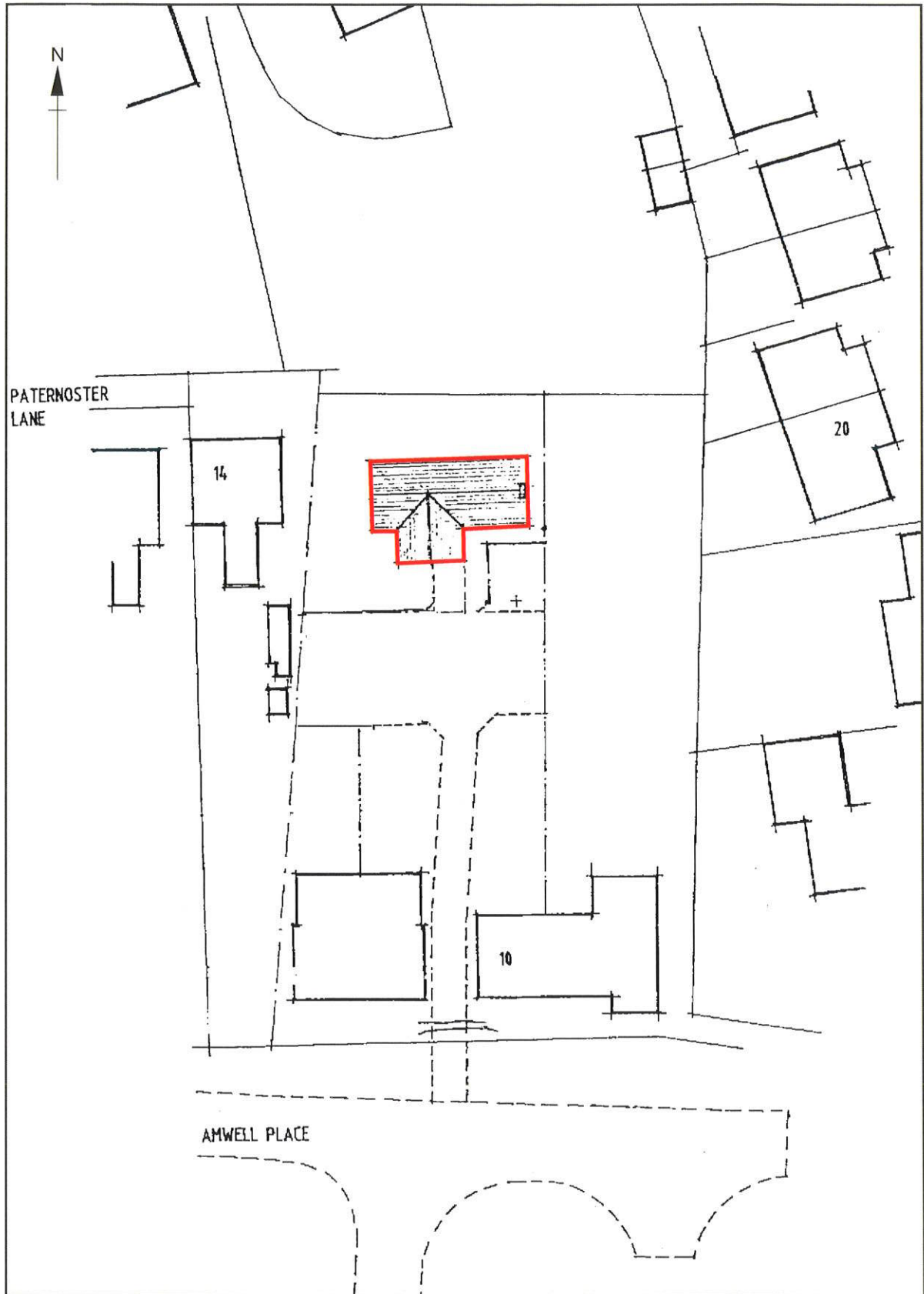

Figure 2 Site location.

Plan 1

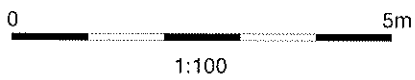
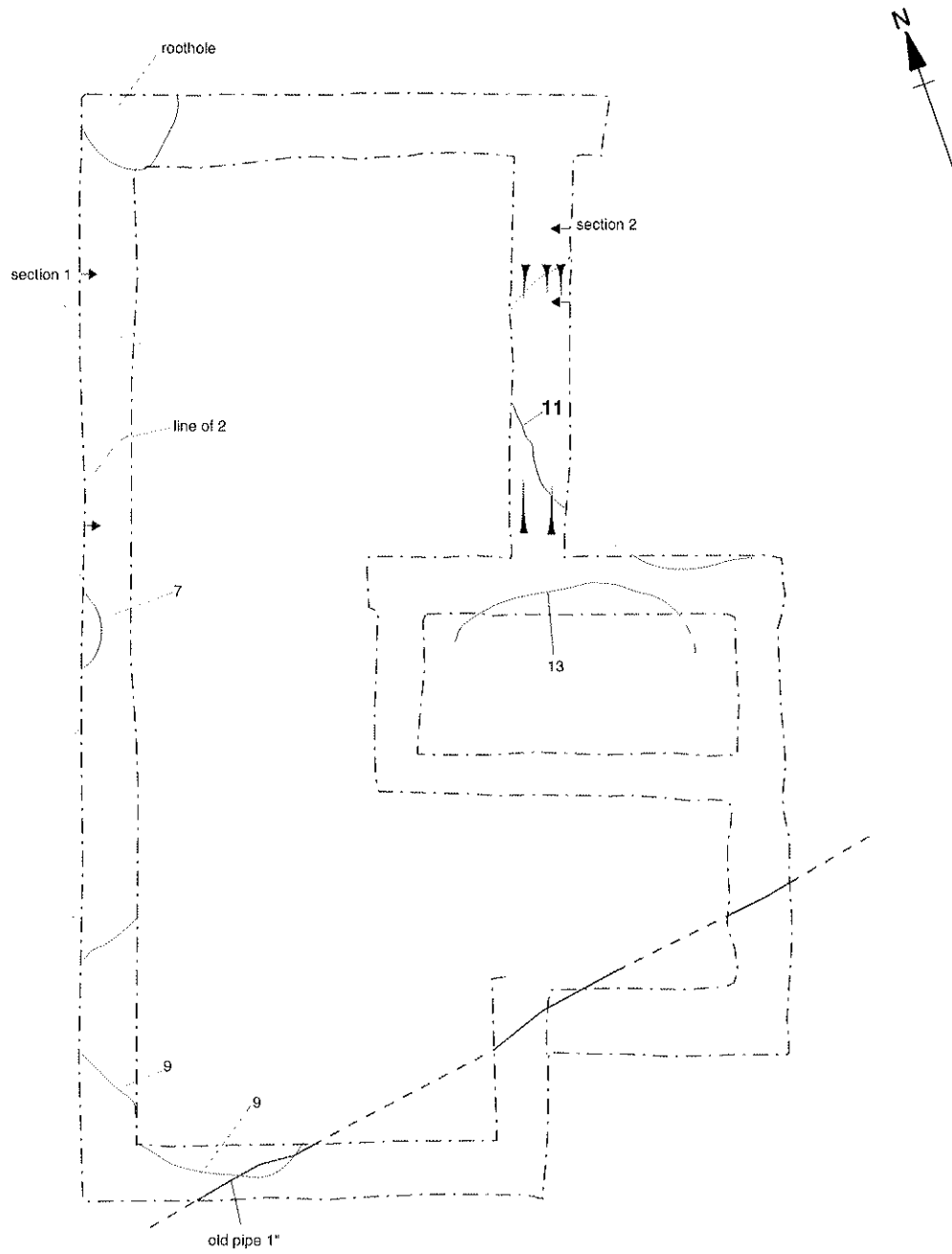
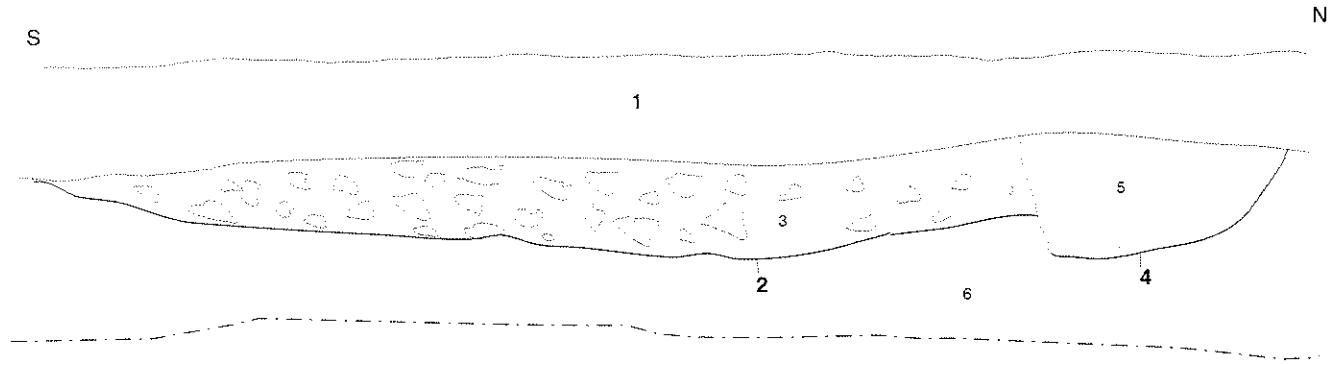

Figure 3 Site Plan.

Section 1



Section 2

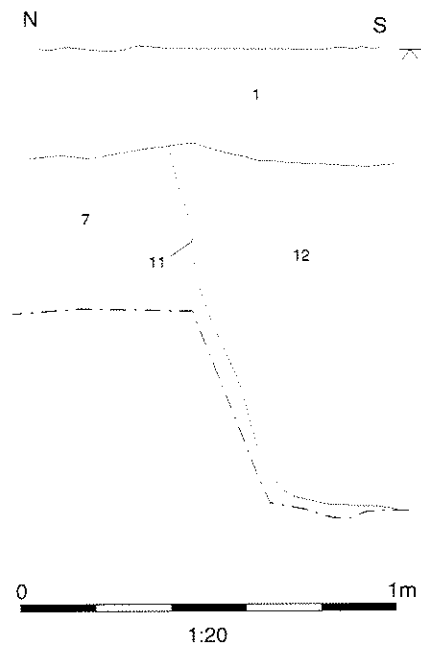

Figure 4 Sections.



Oxford Archaeology

Janus House
Osney Mead
Oxford OX2 0ES

t: (0044) 01865 263800
f: (0044) 01865 793496
e: info@oxfordarch.co.uk
w: www.oxfordarch.co.uk



Oxford Archaeology North

Storey Institute
Meeting House Lane
Lancaster LA1 1TF

t: (0044) 01524 848666
f: (0044) 01524 848606
e: lancinfo@oxfordarch.co.uk
w: www.oxfordarch.co.uk

Director: David Jennings, BA MIFA FSA



Oxford Archaeological Unit is a
Private Limited Company, N^o: 1618597
and a Registered Charity, N^o: 285627

Registered Office:

Oxford Archaeological Unit
Janus House, Osney Mead, Oxford OX2 0ES