



High Pow Farm, Wigton Cumbria

Revised Archaeological Assessment Report



Oxford Archaeology North

June 2004

National Wind Power Ltd

Issue No: 2002-4/255
OA North Job No: L9206
NGR: NY 245 425

Document Title: High Pow Farm, Wigton, Cumbria
Document Type: Revised Archaeological Assessment Report

Client Name: National Wind Power Ltd

Issue Number: 2002-4/255

OA Job Number: L9206

National Grid Reference: NY 245 425

Prepared by: Angela Boyle Vix Hughes
Position: Project Officer Project Supervisor
June 2004

Checked by: Jamie Quartermaine Signed.....
Position: Project Manager
Date: June 2004

Approved by: Alan Lupton Signed.....
Position: Operations Manager
Date: June 2004

Document File Location Jamie/Projects/9206wind/Highpow/Updated Report

Oxford Archaeology North

Storey Institute
Meeting House Lane
Lancaster
LA1 1TF
t: (0044) 01524 848666
f: (0044) 01524 848606

w: www.oxfordarch.co.uk
e: info@oxfordarch.co.uk

© Oxford Archaeological Unit Ltd 2003

Janus House
Osney Mead
Oxford
OX2 0EA
t: (0044) 01865 263800
f: (0044) 01865 793496

Oxford Archaeological Unit Limited is a Registered Charity No: 285627

Disclaimer:

This document has been prepared for the titled project or named part thereof and should not be relied upon or used for any other project without an independent check being carried out as to its suitability and prior written authority of Oxford Archaeology being obtained. Oxford Archaeology accepts no responsibility or liability for the consequences of this document being used for a purpose other than the purposes for which it was commissioned. Any person/party using or relying on the document for such other purposes agrees, and will by such use or reliance be taken to confirm their agreement to indemnify Oxford Archaeology for all loss or damage resulting therefrom. Oxford Archaeology accepts no responsibility or liability for this document to any party other than the person/party by whom it was commissioned.

CONTENTS

ACKNOWLEDGEMENTS	3
SUMMARY.....	4
1. INTRODUCTION.....	5
1.1 Circumstances of Project.....	5
1.2 Site Location, Topography and Geology.....	5
2. METHODOLOGY	6
2.1 Project Design	6
2.2 Desk-Based Study	6
2.3 Walk-Over Survey.....	6
2.4 Gazetteer of Sites	7
2.5 Archive	7
3. DESK-BASED SURVEY RESULTS	8
3.1 Introduction	8
3.2 Prehistoric Period	8
3.3 Roman Period	8
3.4 Medieval.....	9
3.5 Post-Medieval.....	9
4. WALK-OVER SURVEY RESULTS	11
4.1 Survey Results.....	11
5. ARCHAEOLOGICAL POTENTIAL AND IMPACT	13
5.1 Potential.....	13
5.2 Impact of the Proposed Development	13
5.3 Recommendations.....	14
6. BIBLIOGRAPHY	15
6.1 Primary and Cartographic Sources	15
6.1 Secondary Sources.....	15
APPENDIX 1	16
Project Design	
APPENDIX 2	20
Gazetteer of Sites	
ILLUSTRATIONS.....	23
Figure 1: Site location map	
Figure 2: Map of archaeological sites in the vicinity of the study area	
Figure 3: Hodgkinson and Donald map (1802)	
Figure 4: Manor of Bolton Enclosure Map (CRO(C) QRE/1/70 1781)	
Figure 5: Ordnance Survey 1st edition 6” map (1863)	

PLATES 24

- Plate 1: The western wall boundary of Field 1
- Plate 2: Site **09** Stock enclosure looking south

ACKNOWLEDGEMENTS

OA North would like to thank Clare Wilson of National Wind Power Limited for commissioning this work and for assistance in the setting up of the project. We would also like to thank the staff of the Cumbria Record Office (Carlisle) for their considerable efforts on behalf of the project, and to Bette Hopkins, Cumbria County Council, for providing the SMR information.

The documentary data was researched by Jo Dawson, and the desk-top study was written by Angela Boyle. The walk-over survey was undertaken and written by Vix Hughes. The report was edited by Jamie Quartermaine and Carol Allen. The report was managed by Jamie Quartermaine.

SUMMARY

Oxford Archaeology North were commissioned by National Wind Power Ltd to undertake a desk-based assessment to inform a planning application for a small wind power scheme at High Pow Farm, Wigton, Cumbria (NGR NY 245 425). The work involved a desk-based study in conjunction with a walk-over survey. The work was undertaken in the week of the 24th March 2003. This report comprises an update to a previously issued report (OA North 2003), following a change in the location of the wind turbines and their associated trackway.

The desk-based study demonstrated that the area had been unimproved common land until enclosure in the late eighteenth century and that there was a limited number of post-medieval agricultural monuments within the environs of the proposed wind farm site. No remains of prehistoric or Roman date have been found in the development area, although the proximity of the site to the Papcastle to Carlisle Roman road and to the Roman fort of Old Carlisle means that there is some potential for the existence of Roman remains.

The walk-over survey reinforced the desk-based study, finding post-medieval agricultural sites. It also showed that field boundaries were made up of very sizeable boulders, suggesting that the site has been subject to intensive stone clearance at the time the land was enclosed.

On the present evidence it is suggested that the proposed wind farm will impact an archaeological resource of low significance; however, there is, nevertheless, the potential for the survival of below ground remains. It is recommended that a topographic survey be completed for Site **11**, an area of ridge and furrow which will be significantly effected by the development. A putative drove way (Site **08**) and a possible pond (Site **10**) were also identified as under threat from the development, but an archaeological watching brief on the ground works associated with the proposed development is considered sufficient to locate and record any deposits associated with these structures.

1. INTRODUCTION

1.1 CIRCUMSTANCES OF PROJECT

- 1.1.1 Oxford Archaeology North have been commissioned by Claire Wilson of National Wind Power to undertake a desk-based assessment of a proposed small wind power scheme at High Pow Farm, Cumbria.
- 1.1.2 This desk-based assessment forms an initial stage of archaeological investigation. For the purposes of this report the archaeological and cartographic sources, including results from any archaeological investigations in the close proximity of the area of proposed development and a study area around it, were examined in order to determine the likely nature, extent, preservation and importance of any archaeological remains that may be present within the area of the proposed wind farm. The work was undertaken in the week of the 24th March. This report presents the results of the desk based assessment, and makes recommendations for archaeological work to be carried out as part of the development. This report forms an update to a previously issued report (OA North 2003), following a change in the location of the wind turbines and their associated trackway.

1.2 SITE LOCATION, TOPOGRAPHY AND GEOLOGY

- 1.2.1 The proposed power scheme lies entirely within the parish of Bolton at centre point NGR NY 245 425 (Fig 1). The turbines are to be located at NY 24878 42533, NY 24659 52713 and NY 24418 42916.
- 1.2.2 The parish of Bolton comprised the townships of Bolton Highside and Bolton Lowside whose inhabitants were principally located in the several hamlets of Boltonsgate, Mealsgate, Sandale, Bolton Lowhouses, Bolton Newhouses and Bolton Wood Lane, with a few scattered houses. The parish has a Roman road located towards its north-western edge. The southern portion of the parish is moorland with old enclosure in the middle and post-medieval enclosure in the northern sector. The proposed development site is located in the lower centre of this area of post-medieval enclosure.
- 1.2.3 The underlying solid geology comprises of Triassic (225 to 195 million years ago) mudstones, known as the Stanwix Shales and Keuper Marl, formed within the marine environment of the Carlisle Basin (Taylor *et al* 1971). Overlying these mudstones are deposits of Devensian (70,000 to 10,000 years ago) till, drift material of the last glacial period (Bewley 1994, 13).

2. METHODOLOGY

2.1 PROJECT DESIGN

- 2.1.1 A project design (*Appendix 1*) was submitted in April 2001 by OA North in response to a request from National Wind Power Ltd for a basic archaeological assessment in order to identify the archaeological potential of the study area.
- 2.1.2 The project design provided for an archaeological assessment involving a desk-based study and a written report, which would interpret the data discovered during the project in advance of the proposed construction of wind turbines. The assessment has been carried out in accordance with the project design.

2.2 DESK-BASED STUDY

- 2.2.1 Existing archaeological information was obtained from the Sites and Monuments Record (SMR) (Cumbria County Council Offices in Kendal). Manuscript maps and selected other documents were studied in the Cumbria County Record Office in Carlisle (CRO (C)). Available maps and plans included Hodgkinson and Donald's map of 1770-1 (Fig 3), an enclosure map (CRO(C) QRE/1/70 (1781): Fig 4), a tithe map (CRO(C) DRC 8/19 (1843)) and the OS 1st and 2nd edition maps of 1863 (Fig 5) and 1900, the Mutlow map of 1815. A list of the documents which were consulted is given in the bibliography.
- 2.2.2 ***Aerial Photographic Study:*** RAF vertical photographs were located and studied in the Cumbria County Council Offices in Kendal. Although these provided little information with regard to archaeological potential, some information on recent land-use could be ascertained. No oblique photography was available for the area in the Cumbria County Council records.

2.3 WALK-OVER SURVEY

- 2.3.1 A field walkover survey was conducted of the study area, the work was undertaken on 27th March 2003 when the site conditions were good. Its aim was to record the existence, location, and extent of any previously unrecorded sites, as well as to check the condition of the sites identified by the literature search. The survey was to OA North 'level 1' standard for the entire study area (OA North 2002). It involved a rapid site inspection, intended to identify and record the extant archaeological resource, and is appropriate to an exploratory survey. The extent of a site was defined for sites or features greater than 50m in size but others were recorded as a central point only. The reconnaissance was undertaken in a systematic fashion, walking on approximately 30m wide transects, within the extent of the defined study area. The emphasis for the recording was on a written description, which recorded the type and period of the site, in *c*50 words. The archaeological information was recorded in standardised form on *pro-forma* record sheets, and included accurate national grid references. A photographic record in black and white print and digital images was undertaken.
- 2.3.2 In order to locate the sites encountered, a combination of Global Positioning System (GPS) techniques and manual triangulation methods was used to record the

features. The GPS instrumentation uses electronic distance measurement along radio frequencies to satellites to enable a positional fix in latitude and longitude and altitude which can be converted mathematically to Ordnance Survey National Grid. The use of GPS techniques has proved to be an essential and extremely cost effective means of locating monuments, and under optimum conditions can achieve accuracies of better than +/- 1m.

- 2.3.3 The study area consists of nine fields, noted as Fields 1-9. Direct impact is only likely to occur in Fields 1-5 and these fields were walked in transects not more than 20m apart. The remaining four fields, Fields 6-9, were briefly scanned and visual observations made. In addition a cursory check was made of the nearby SMR sites, both of which were limekilns.

2.4 GAZETTEER OF SITES

- 2.4.1 All of the information concerning archaeological sites in the vicinity of the development site has been collated into a gazetteer (*Appendix 2*), which provides details of their location, origin, and character. Locations are given as eight-figure National Grid References where possible. A summary description of each site is provided in conjunction with a reference to the source of the information (SMR, cartographic and documentary) with references as appropriate, and an assessment has been given of the interpretation and archaeological potential of the site. The sites have been marked onto a digital map (Fig 2).
- 2.4.2 Other sites beyond the extent of the study area, which were considered to be of background relevance, are mentioned in the text with appropriate SMR references.

2.5 ARCHIVE

- 2.5.1 A full professional archive has been compiled in accordance with the project design (*Appendix 1*), and in accordance with current IFA and English Heritage guidelines (English Heritage 1991). The paper and digital archive will be deposited in the Cumbria Record Office (Carlisle) and an additional copy will be sent to the Cumbria SMR, with a summary being sent to the National Monuments Record on completion of the overall project.

3. DESK-BASED SURVEY RESULTS

3.1 INTRODUCTION

3.1.1 The following assessment of the archaeological resource examines the area within one kilometre radius of the development location. The study also encompasses significant archaeological monuments that are more remote but which may have an influence or bearing upon the archaeology of the area. A notable example of this is the Roman fort of Old Carlisle and its associated road, to the north of the study area. These were important parts of the Roman military infrastructure and would have provided a focus for rural settlement and activity. The known archaeological sites and finds within the study area are discussed by period below.

3.2 PREHISTORIC PERIOD

3.2.1 The study area is a raised area of gentle sloped marginal land overlooking the Solway Plain to the north, and was common land until subject to parliamentary enclosure in the late eighteenth century (CRO(C) QRE/1/70, 1781). Such a terrain, particularly in the area of the adjacent West Cumbria coastal plain, has considerable potential for the recovery of prehistoric agricultural remains (Quartermaine and Leech forthcoming). The aerial photographic work of Bob Bewley (1994) has identified considerable numbers of enclosed settlements on the lowlands of Solway Plain and the adjacent marginal lands; a limited number of these have been excavated, including one at Ewanrigg, near Maryport, which had an Iron Age settlement reused in the Roman period (Bewley 1992). The majority of the enclosed settlements, however, are dated typologically and suggest considerable activity in the Iron Age period (Hodgkinson *et al* 2000).

3.2.2 Despite the potential for prehistoric activity in the region, no sites of prehistoric date were identified within the study area.

3.3 ROMAN PERIOD

3.3.1 No sites of Roman date have been identified within the study area. However, the Roman road linking Carlisle to Papcastle is located *c*2km to the north-west of the proposed development area and the Old Carlisle fort, and associated extramural settlement, is located *c*3.5km to the north-east. Linked to the fort was an expansive field system identified by Higham and Jones (1975) from aerial photography; several acres of divisions were recorded within the fields to the south of the fort and settlement at Old Carlisle.

'Fields somewhat less than one acre in size proliferate ... in an agglomeration of rectangular boxes that at last give us some impression of the reality of Roman agriculture close to a fort' (Higham and Jones 1975, 25).

3.3.2 The aerial photographic work of Bob Bewley demonstrated considerable numbers of rectangular enclosed settlements within the Solway Plain, that are, in the

absence of more precise dating, typologically dated to the Roman period. The earlier work of Higham and Jones (1975) had also identified numerous enclosed 'native-style' settlements in the vicinity of the fort, as at Jenkin's Cross and Sandy Brow to the east, and concluded that

'the Old Carlisle fort accumulated a number of sites to create a rather denser infilling on the location map than is normally the case in this area' (ibid). Higham and Jones concluded that these settlements were attracted 'by the economic forces created by the Roman road and its attendant fort' (op cit, 26).

- 3.3.3 Despite the absence of identified Roman remains within the study area there is a potential for agricultural or settlement remains within the wider hinterland of the fort and in areas near to the Roman road.

3.4 MEDIEVAL

- 3.4.1 The Hodgkinson and Donald map of 1802 indicates that at that late date the development area was unenclosed land, which was spatially removed from any settlements, the nearest being 'Wall Rash' a kilometre to the south of the proposed turbines (Fig 3). This is confirmed by the enclosure map of 1781 (CRO(C) QRE/1/70 (1781)) which indicates that, prior to enclosure, the study area was common and essentially waste land (Fig 4). There is no direct evidence of intensive farming predating the enclosure. However, there are a number of place names suggestive of earlier activity, in particular the Binthwaite Field is suggestive of settlement associated with Scandinavian influence, the *thwaite* ending meaning a woodland clearance (Fig 5) (Armstrong *et al* 1950, 269). Catlands Field and Boltons are essentially of medieval date (*ibid*).

- 3.4.2 Carlisle Gate Farm, to the south of the site, is a long house with an extant cruck remaining (Site **04**). Such a structure is undoubtedly an early vernacular building, and its stone built character is normally indicative of an early post-medieval building. However, the presence of a cruck may be suggestive of the survival of a late medieval timber structure. The SMR entry indicates that the building has been subject to development and it is not known if any early fabric now survives. The 'Gate' element of the Carlisle Gate Farm placename derives from the word '*gata*', the Old Scandinavian for 'road' (Ekwall 1960). This would therefore indicate that the farm was on the line of an old road to Carlisle, and the road is shown on the Hodgkinson and Donald map (1802) extending north from the farm, past the site and eventually linking up with the Papcastle to Carlisle road. An off shoot from this road was shown as extending through the study area and crossing Pow Gill at Low Loughing Bridge and extending to the east past Thackthwaite Hall. The road is shown with dashed lines and was probably no more than a drove road; if it survived at all it would probably only be as a discontinuous hollow way (Site **08**).

3.5 POST-MEDIEVAL

- 3.5.1 The enclosure map (CRO(C) QRE/1/70/1781) shows a proposal for an intake of common land, and it would appear that, prior to that date, there was no enclosure within the environs of the study area. Significantly only some elements of the

enclosure proposal were enacted, and the final layout of the field system is shown on the OS 1st edition map (1863). The layout of the fields is very rectangular, with straight sided fields, and it is evident that the roads, Catlands Highway and Highside Highway, were constructed as part of this enclosure. The field boundaries in the area of the study area (Site **05**) are all shown on the OS 1st edition map (1863) and would appear to date back to the late eighteenth enclosure of the waste land. An old drainage channel (Site **06**) is shown on the Ordnance Survey 2nd edition map of 1899.

- 3.5.2 There is erratic industrial activity reflected in the environs of the study area. A post-medieval forge (Site **03**) is located within the area of the pre-enclosure field system to the south of the development area. Two lime kilns of uncertain date are located immediately beyond the proposed development area; Bolton New Houses lime kiln (Site **01**) to the north-east, and Hall Bank lime kiln (Site **02**) just west of the south-western corner of the site. The former is marked on the Ordnance Survey 6" map (1863). The existence of a third kiln may be indicated by the field name Kiln Field at the southern end of the site (Fig 5).
- 3.5.3 Wellrash Bridge, of uncertain date though marked on the Ordnance Survey 6" map of 1863, is located on the southern edge of the site.

4. WALK-OVER SURVEY RESULTS

4.1 SURVEY RESULTS

- 4.1.1 In total three sites were recorded within the five fields that were subject to detailed ground investigation (Fields 1-5: Fig 2). Each of the sites is described fully in the relevant section for each field and details are incorporated into the site gazetteer. The layout of the fields corresponds precisely with that shown on current 1:10,000 mapping and the field boundaries are all very regular and straight.
- 4.1.2 **Field 1:** this field, centred on NY 248 428, was under short improved grassland and had a gentle undulating topography, and was orientated approximately east / west. All the field boundaries were earthfast banks surmounted by somewhat dilapidated plashed, or laid, shrubs and reinforced with modern fencing. The western field boundary was slightly different as it contained a large number of very large, rounded boulders many over a metre in diameter (Plate 1); to the east of this was an associated drainage ditch. All the field boundaries were between 1m and 2m wide and between 0.5m and 1.0m in height. Along the south field boundary was evidence of recent disturbance as a result of the clearing out of a ditch running beside the boundary. A large number of variable sized boulders was scattered up to 5m from the remaining earthfast bank and hedge. The debris in this zone contained sherds of post-medieval ceramics, presumably from the ditch fills. Field 1 contained Site **09**, which was against the western edge of the field, and comprised an east/west alignment of large boulders built into a low free-standing wall, which had a 90° return at the eastern end (Plate 2). The wall had a loose construction and the northern arm of the wall barely survives. The wall was clearly associated with the field boundary to the immediate west. Within the area defined by the walls, which measured 5m by 5m, was a stone / concrete trough, which was very earthfast; it was evident that the wall was a stock shelter for animals while they were watering at this point.
- 4.1.3 **Field 2:** this field, centred on NY 245 428, was also under short improved grassland and had gently undulating topography. All the field boundaries were earthfast Cumbrian banks surmounted by plashed, or laid, shrubs and reinforced with modern fencing. The western field boundary was considerably neater than the others and had an associated drainage ditch running along the western side. The same recent clearing of the southern field boundary's drain and associated debris, was noted in this field. No sites were discovered in this field.
- 4.1.4 **Field 3:** this field, centred on NY 246 425, was under short improved grassland and had a slight crest running east / west halfway along its length from which point the ground sloped gently downwards to the north and south. All the field boundaries were earthfast Cumbrian banks surmounted by plashed, or laid, shrubs and reinforced with modern fencing. Along the eastern field boundary the majority of the vegetation was gorse and there were no drainage ditches visible along any of the boundaries.
- 4.1.5 **Field 4:** this field centred on NY 247 425 was an amalgamated field comprised of two smaller earlier fields. The field had muck spread recently which obscured any small scale details in the ground surface. A significant number of large boulders

were strewn along the western half of the north field boundary, although it was not clear where they had originated from since the field boundary between Field 1 and 4 was intact. It is possible that there was a second low bank at this point in the field since some of the boulders were earthfast. In the north-eastern corner of the field, and partially extending into Field 5, was a second site, Site **10**, which was possibly a pond or water collection point. The ground is damp and there is a distinct depression in the field which may have been made deliberately.

- 4.1.6 **Field 5:** this field, centred on NY 249 426, was under short improved grassland and there were several indications of the locations of hay dispensers. All the field boundaries were earthfast Cumbrian banks surmounted by plashed, or laid, shrubs and reinforced with modern fencing. Along the southern boundary was a drainage ditch associated with the field boundary. Within this field was an area of probable ridge and furrow, Site **11**, comprising at least six identifiable ephemeral linear earthworks, each roughly 3m wide, and would suggest that the area has been historically cultivated. The area of ridge and furrow was along the western part of the field and extending across most of the field in a north / south alignment. These ridges were disrupted at the southern end by six north-east / south-west aligned dumps of recently disturbed soil. These were probably the result of land drainage improvements and fragments of older red ceramic drains were noted within the debris. Several other identical features were seen along the eastern edge of Field 5.
- 4.1.7 **Fields 6-9:** these fields were all under short improved grassland and all gently sloped. All the field boundaries were earthfast stone banks surmounted by plashed, or laid, shrub hedges and reinforced with modern fencing. There were no obvious signs of the fields having been ploughed at any time.
- 4.1.8 The two lime kilns identified in the area by the documentary study were visited, even though they are outside the study area. They were found to be both still in existence as partial structures and retaining their overall form but much of the detailed structure has been lost. Site **01** survives adjacent to the field boundary and has a north / south ramp leading up to the main structure from the north; the eastern wall of the ramp is composed of huge rounded boulders. Little other stone work could be seen through the vegetation. Site **02** is located on private property and was visible as an evident earthwork but that had been fully incorporated into the garden.

5. ARCHAEOLOGICAL POTENTIAL AND IMPACT

5.1 POTENTIAL

- 5.1.1 ***The Landscape:*** the area of the study area was, on the present evidence, formerly common wasteland, which was enclosed in the late eighteenth century. The field boundaries were for the most part Cumbrian banks, which are not uncommon types of post-medieval field boundaries (LUAU 1997). What is perhaps more significant is that some of the walled boundaries incorporated very large unworked boulders in their foundations, and must be an indication that the walls have incorporated large stones, as a result of stone clearance. This would suggest that the area has been subject to intensive land improvement at the time of the walls construction, presumably in the late eighteenth century when the land was enclosed.
- 5.1.2 ***The Archaeological Resource:*** no remains of prehistoric or Roman date have been found in the development area, although the proximity of the site to the Papcastle to Carlisle Roman road and to the Old Carlisle fort means that there is some potential for the existence of below ground Roman remains.
- 5.1.2 The only sites that were potentially of medieval origin are the cruck-framed farmhouse (Site **04**) and the putative drove route (Site **08**) across the study area. The first of these was within the area of old enclosure to the south of the study area and is remote from the site of the proposed turbines. The second site was a possible medieval drove route that was shown as extending through the study area on the Hodgkinson and Donald map of 1802 (Fig 3). This was looked for in the course of the field survey but no evidence for it was discovered. It is possible that the remains of any road were destroyed as a result of land improvement within the enclosed lands.
- 5.1.3 The only remains within the study area or its immediate environs were of post-medieval date, and are of low significance.

5.2 IMPACT OF THE PROPOSED DEVELOPMENT

- 5.2.1 The proposed development will comprise three turbines and associated tracks. The turbines are located in one field known as Stony Close, and two fields both called Catlands Field (Fig 5). Turbine 1 is located in a area of ridge and furrow (Site **11**; Fig 2) and Turbine 2 on the line of the putative drove road (Site **08**; Fig 2), although this is not visible at ground level. The access track between the turbines will be on a north-west/south-east alignment, running directly between the turbines. The east/west aligned track allowing access to the public highway follows the still extant southern field boundary of Stony Close and Catlands Field. The trackway will potentially impact on the previously mentioned drove road (Site **08**) and the area of ridge and furrow (Site **11**), as well as a possible pond (Site **10**; Fig 2).
- 5.2.2 Any surviving archaeology is likely to have suffered as a result of land improvement and ploughing in the past and the proposed development will probably impact on a resource of low significance. Nevertheless, there is the

possibility that presently unknown sub-surface archaeological remains may be impacted upon.

5.3 RECOMMENDATIONS

- 5.3.1 The development has the potential to effect the three sites described above. It is recommended that a topographic survey be completed on the area of ridge and furrow (Site **11**) prior to the commencement of works. The proposed location of Turbine 2 is on the line of the putative drove road (Site **08**) as shown on the Hodgkinson and Donald map of 1802 (Fig 3), but there was no surface expression for the track identified during the site investigation. There is a possibility that any remains of the track have been lost to land improvement, and in any case there is a degree of imprecision as to the location of the former track; it would therefore be inappropriate to recommend a minor relocation of the turbine unless there was some degree of confidence as to the position of the drove route. It is therefore recommended that an evaluation trench be excavated on the position of the proposed turbine and if this reveals evidence for the track then the turbine should be accordingly relocated.
- 5.3.2 It is also recommended that an archaeological watching brief is carried out in the course of the groundworks for the construction of the turbines and the access track, to record any archaeological deposits or features associated with the three identified sites or any unknown sites.

6. BIBLIOGRAPHY

6.1 PRIMARY AND CARTOGRAPHIC SOURCES

CRO(C) QRE/1/70, 1781 Plan of the manor of Bolton including common land within the same manor

CRO (C) DRC 8/19, 1843 *Township of Bolton High Quarter in the parish of Bolton, Cumberland*

Hodgkinson, K, and Donald, T, 1802 *The county of Cumberland, Surveyed 1770-1771*, London

Ordnance Survey (1863) Cumberland Sheet 37.5, 1st edition, 1:10560

Ordnance Survey (1900) Cumberland Sheet 37.5, 2nd edition, 1:2500

6.2 SECONDARY SOURCES

Armstrong, A M, Mawer, A, Stenton, F M and Dickens, B 1950 *The place names of Cumberland Part II: Allerdale below Derwent and Allerdale above Derwent wards*, English Place Name Society Vol 21, for 1943-4, Cambridge

Bewley, RH, 1992 Excavation of two cropmark sites in the Solway Plain, Cumbria: Ewanrigg Settlement and Swarthy Hill 1986-1988, *Trans Cumberland Westmorland Antiq Archaeol Soc, nser*, **86**, 19-38

Bewley, RH, 1994 *Prehistoric and Romano-British Settlement in the Solway Plain*, Cumbria, Oxbow monog **36**, Oxford

Ekwall, E, 1960 *The Concise Oxford Dictionary of English Place-Names*, 4 edn, Oxford

English Heritage, 1991 *Management of Archaeological Projects*, 2nd edn, London

Higham, NJ, and Jones, GDB, 1975 Frontier, Forts and Farmers, *Archaeol J*, **132**, 1-53

Hodgkinson, D, Huckerby, E, Middleton, R and Wells, C, 2000 *The Lowland Wetlands of Cumbria*, Lancaster Imprints, **8**, Lancaster

Hutchinson, W, 1794 *The history of the county of Cumberland*, Wakefield

Lancaster University Archaeological Unit (LUAU) 1997 *Sellafield Tip Extension, Cumbria: Evaluation Report*, unpubl rep

Oxford Archaeology North (OA North) 2002 *Survey Levels*, unpubl rep

Oxford Archaeology North (OA North) 2003 *High Pow Farm, Wigton, Cumbria: Archaeological Assessment Report*, unpubl rep

Quartermaine, J, and Leech, R, forthcoming *The later prehistory of the Lake District, the results of recent surveys*

Taylor, BJ, Burgess, IC, Land, DH, Mills, DAC, Smith, DB and Warren, PT 1971 *British Regional Geology: Northern England*, London

Whellan, W, 1860 *The history and topography of the counties of Cumberland and Westmorland*, Pontefract

APPENDIX 2 GAZETTEER OF SITES

Site number 01
Site name Bolton New Houses
NGR NY 2494 4307
Site type Lime Kiln
Period Post-Medieval
SMR No 10290
Sources 1st ed OS 1:10 560 (1863)
Description A lime kiln shown on the OS 1st edition map.

Site number 02
Site name Hall Bank
NGR NY 2437 4195
Site type Lime Kiln
Period Post-Medieval
SMR No 10615
Sources 1st ed OS 1:10 560 (1863)
Description A lime kiln shown on the OS 1st edition map.

Site number 03
Site name Catlands Foot
NGR NY 2486 4156
Site type Forge
Period Post-Medieval
SMR No 10615
Sources 2nd ed OS 1:2500 (1900)
Description Site of an old smithy.

Site number 04
Site name Carlisle Gate
NGR NY 2382 4170
Site type Crucked Building
Period Post-Medieval / Medieval ?
SMR No 19812
Sources B Hopkins
Description A long house with a surviving cruck. The buildings were surrounded by what appeared to be the original garth.

Site number 05
Site name Catlands Field
NGR NY 2497 4252
Site type Field Boundaries
Period Post-Medieval
Sources 1st ed OS 1:10 560 (1863)
Description A series of old boundaries shown on the OS 1st edition map.

Site number 06
Site name Wellrash Bridge
NGR NY 2478 4195

Site type Drainage Channel
Period Post-Medieval
Sources 1st ed OS 1:10 560 (1863)
Description A drainage channel shown on the OS 2nd edition map.

Site number 07
Site name Wellrash Bridge
NGR NY 2477 4180
Site type Bridge
Period Post-Medieval
Sources 1st ed OS 1:10 560 (1863)
Description The Wellrash bridge which is of unknown date.

Site number 08
Site name Carlisle Gate to Thackwaite Road / drove route
NGR NY 247 427
Site type Road / Drove Route
Period Post-Medieval /Medieval ?
Sources Hodgkinson and Donald map (1802); Site visit
Description A possible drove route / road drainage channel shown on the Hodgkinson and Donald map. No evidence was found for a road in this position during the site visit.

Site number 09
Site name Catlands Field
NGR NY 2463 4273
Site type Stock Shelter
Period Post-Medieval
Sources Site Visit
Description Set against the western edge of the field, this comprised an east/west alignment of large boulders built into a low free-standing wall, with a 90^o return at the eastern end. The wall had a loose construction and the northern arm of the wall barely survives. Within the area defined by the walls, which measured 5m by 5m, was a stone / concrete trough, which was very earthfast; it was evident that the wall was a stock shelter for animals while they were watering at this point.

Site number 10
Site name Catlands Field
NGR NY 2479 4267
Site type Pond ?
Period Post-Medieval
Sources Site Visit
Description In the north-eastern corner of Field 1, and extending into Field 5, was a possible pond or water collection point. The ground is damp and there is a distinct depression in the field which may have been made deliberately.

Site number 11
Site name Catlands Field
NGR NY 2485 4260
Site type Ridge and Furrow
Period Post-Medieval
Sources Site Visit
Description An area of probable ridge and furrow comprising at least six identifiable ephemeral linear earthworks, each roughly 3m wide. The area of ridge and furrow was along the

western part of the field and extending across most of the field in a north / south alignment.

ILLUSTRATIONS

Figure 1: Site location map

Figure 2: Map of archaeological sites in the vicinity of the study area

Figure 3: Hodgkinson and Donald map (1802)

Figure 4: Manor of Bolton Enclosure Map (CRO(C) QRE/1/70 1781)

Figure 5: Ordnance Survey 1st edition 6" map (1863)

PLATES

Plate 1: The western wall boundary of Field 1

Plate 2: Site 09 Stock enclosure looking south

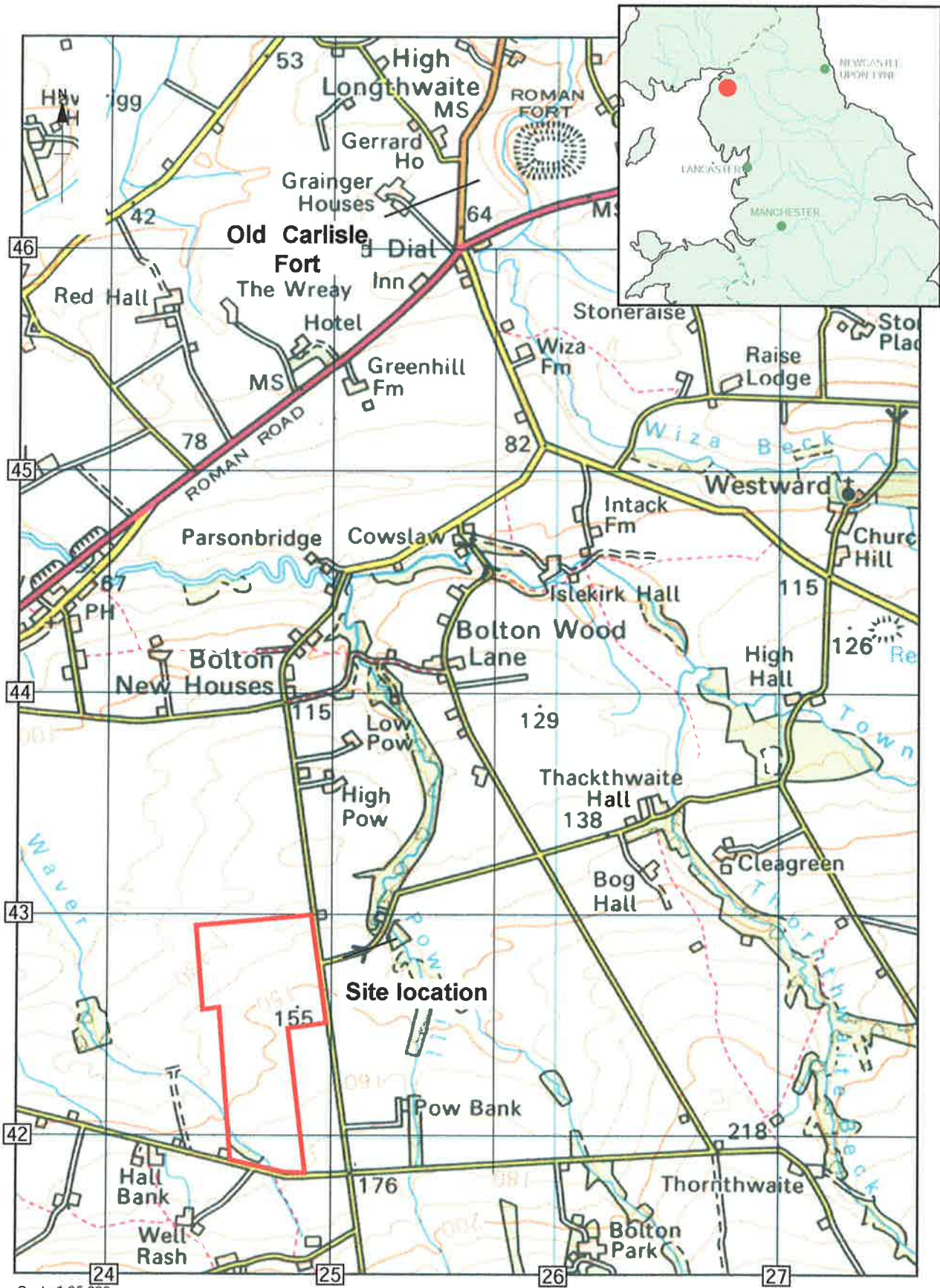

Scale 1:25,000

Reproduced from the Landranger 1:50,000 scale by permission of the Ordnance Survey on behalf of The Controller of Her Majesty's Stationery Office
© Crown Copyright 1992. All rights reserved. Licence No. AL 100005569



Figure 1: Site location map

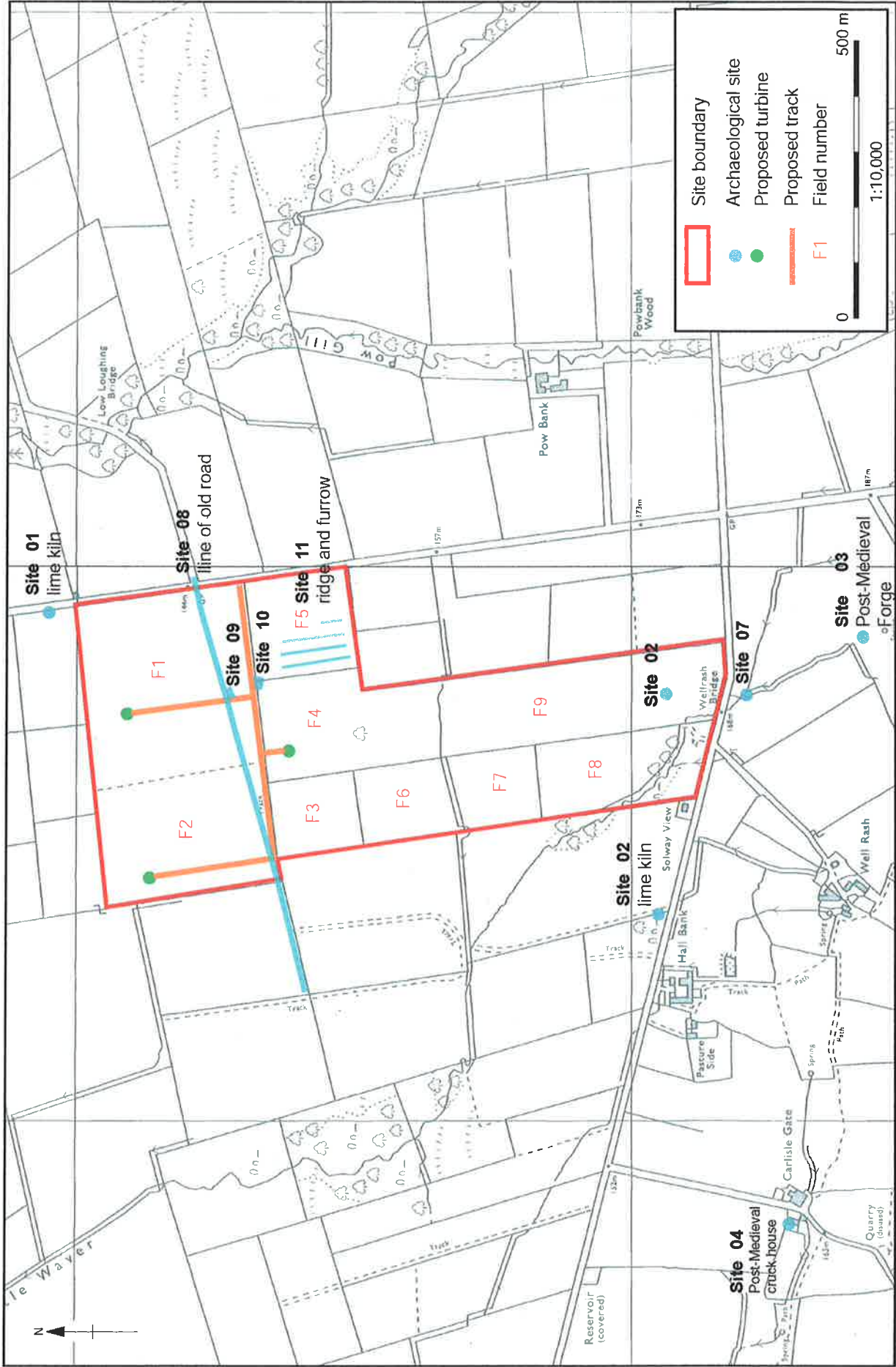

Figure 2: Map of archaeological sites in the vicinity of the study area



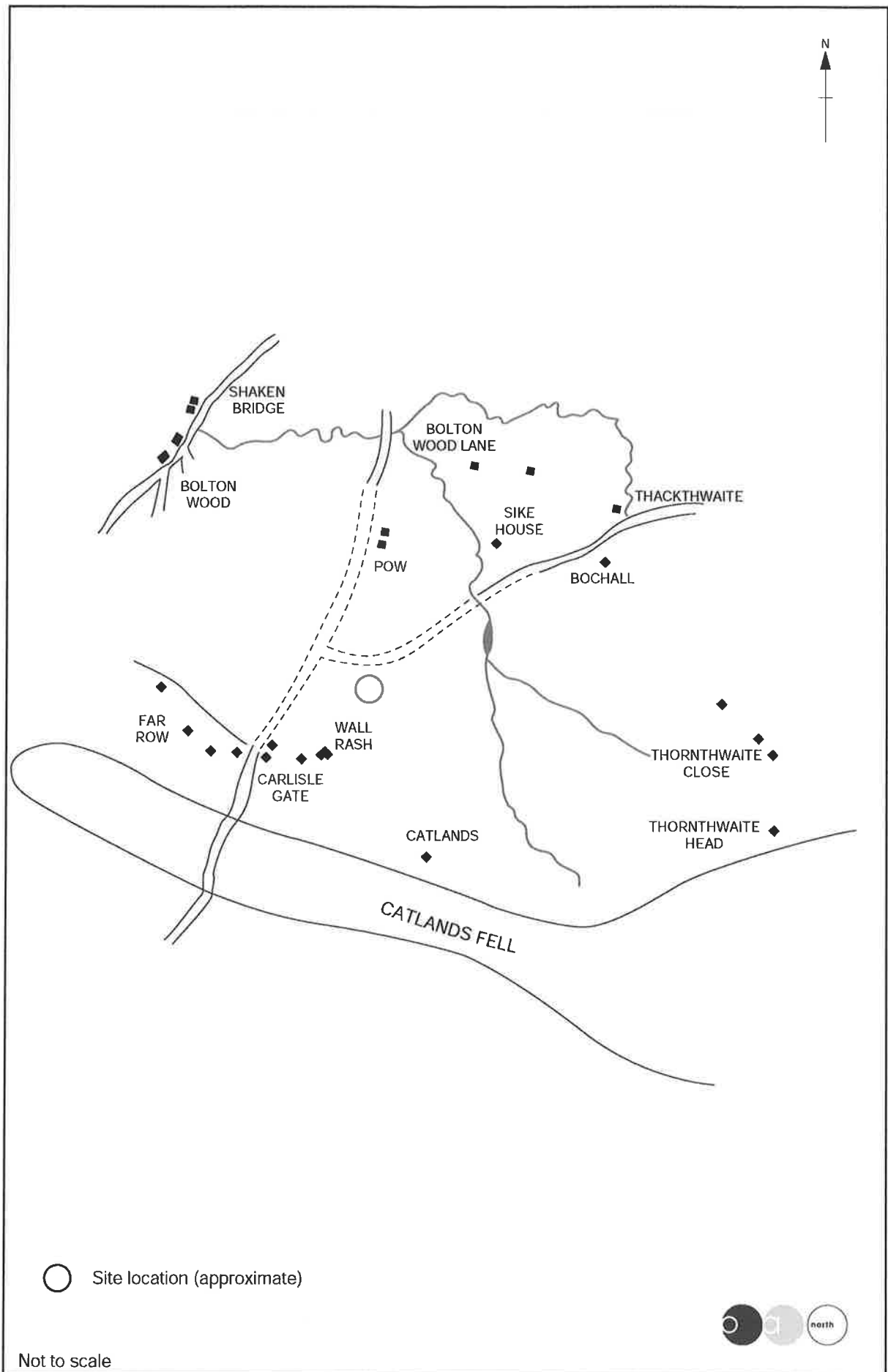

Figure 3: Hodgkinson and Donald map (1802)



Figure 4: Manor of Bolton enclosure map (CRO(C) QRE/1/70 1781)

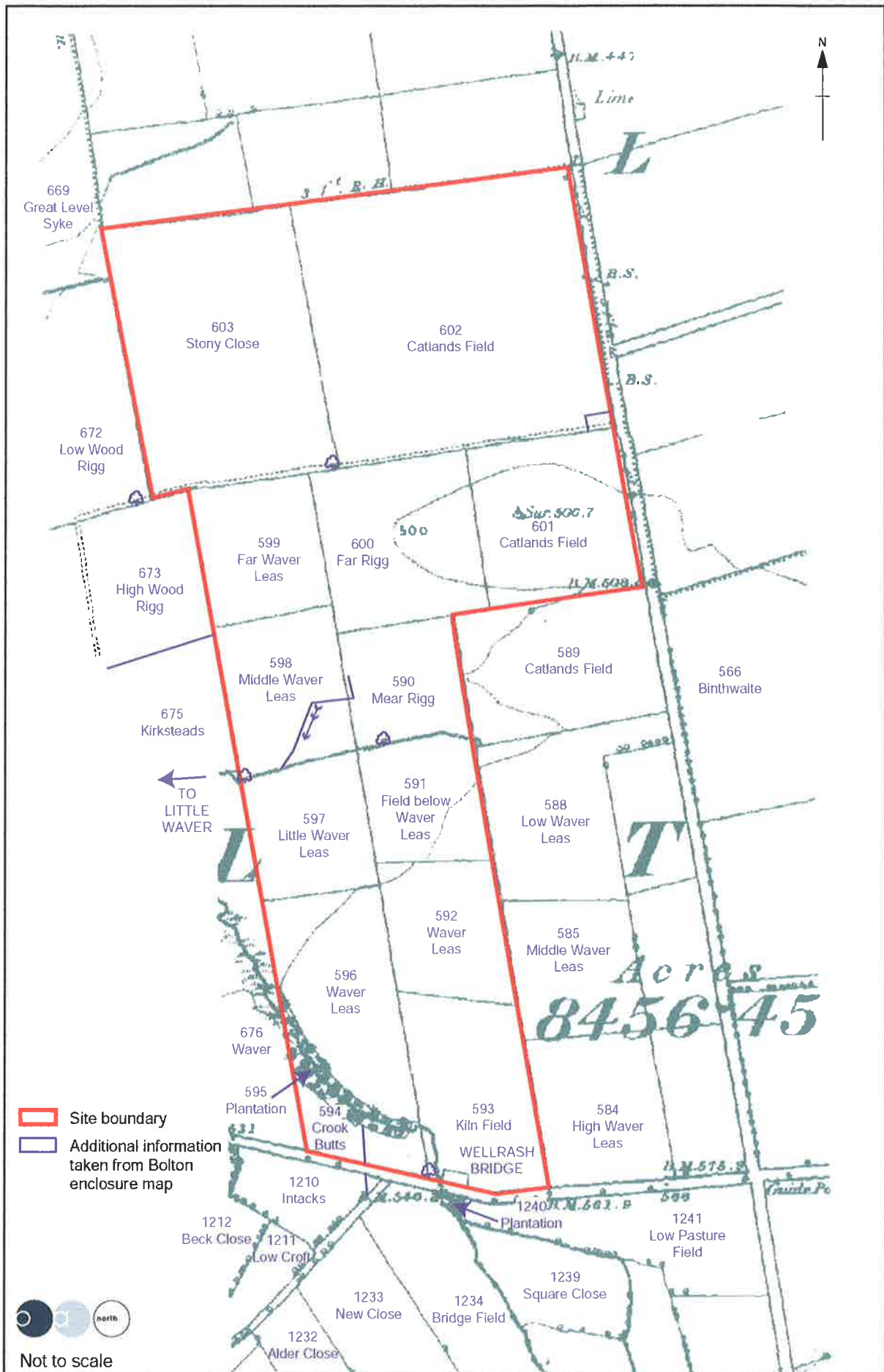

Figure 5: Ordnance Survey 1st edition 6" map (1863)



Plate 1: The western wall boundary of Field 1



Plate 2: Site 09 Stock enclosure looking south