

Clattercote Priory Farm, Claydon, Oxfordshire.



Archaeological Watching Brief Report

February 2012

Client: ARM Buildings Ltd.



Issue: 1
OA Job No: 5266
NGR: SP 4564 4902



Client Name: ARM Buildings Ltd.
Client Ref No: N/A
Document Title: Clattercote Priory Farm, Claydon, Oxfordshire
Document Type: Archaeological Watching Brief Report
Issue/Version Number: 1
Grid Reference: SP 4564 4902
Planning Reference: 11/01733/F
Invoice Code: CLCAP WB
OA Job Number: 5266
Site Code: CLCAP 12
Receiving Museum: Oxfordshire County Museum Service
Museum Accession No.: OXCMS:2012.32
Event No.: N/A

Issue	Prepared by	Checked by	Approved by	Signature
1	Brian Dean Project Officer	Edward Biddulph Senior Project Manager	Edward Biddulph Senior Project Manager	

Document File Location: Server 1\Clattercote Priory, Claydon\CLCAP_WBReport.odt
Graphics File Location: \\Server8\invoice codes a thru c\C_invoice codes\CLCAPWB"Clattercote Priory Farm"
Illustrated by: Conan Parsons

Disclaimer:

This document has been prepared for the titled project or named part thereof and should not be relied upon or used for any other project without an independent check being carried out as to its suitability and prior written authority of Oxford Archaeology being obtained. Oxford Archaeology accepts no responsibility or liability for the consequences of this document being used for a purpose other than the purposes for which it was commissioned. Any person/party using or relying on the document for such other purposes agrees, and will by such use or reliance be taken to confirm their agreement to indemnify Oxford Archaeology for all loss or damage resulting therefrom. Oxford Archaeology accepts no responsibility or liability for this document to any party other than the person/party by whom it was commissioned.

© Oxford Archaeological Unit Ltd 2012

Janus House

Osney Mead

Oxford OX2 0ES

t: +44 (0) 1865 263800

e: oasouth@thehumanjourney.net

f: +44 (0) 1865 793496

w: oasouth.thehumanjourney.net

Oxford Archaeological Unit Limited is a Registered Charity No: 285627



Clattercote Priory Farm, Claydon, Oxfordshire

Archaeological Watching Brief Report

Written by Brian Dean

and illustrated by Conan Parsons

Table of Contents

Summary.....	2
1 Location and scope of work.....	2
2 Methodology.....	2
3 Description of deposits.....	2
4 Discussion and conclusions.....	3
5 Bibliography and references.....	3

List of Figures

Fig. 1 Site location

Fig. 2 Excavation site location



Summary

On 6th February 2012 Oxford Archaeology was commissioned on behalf of ARM Buildings Ltd. to carry out an archaeological watching brief on the site of a proposed new weaner building on Clattercote Priory Farm, Claydon, Oxfordshire. A total area of 341.31m² was excavated to a maximum depth of 1.14m. The area encompassed the entirety of the footprint of the weaner building. No archaeological deposits were observed within the excavated area.

1 LOCATION AND SCOPE OF WORK

- 1.1.1 The project was carried out in accordance with the Written Scheme of Investigation (Oxford Archaeology 2012) and the archaeological brief provided by Richard Oram, the Planning Archaeologist for Oxfordshire County Council (OCAS 2012).
- 1.1.2 The site was located c 1km south of Claydon and to the north of Cropredy (SP 4564 4902) to the west of the Oxford Canal (Fig. 1).
- 1.1.3 The underlying geology is shown as Lower Lias but the site is located near a band of alluvium.
- 1.1.4 The development is to be on an undeveloped area within a current working farm. It lies at approximately 109m OD
- 1.1.5 The scope of the project covered the observation of the excavation of the footprint of the weaner building comprising an area of 341.31m² (Fig 2). An archaeological watching brief was maintained until the full extent of the undisturbed geology was revealed to ensure any archaeological deposits would be exposed prior to full excavation to the buildings impact level of 1.68m.
- 1.1.6 A planning condition was attached due to the potential disturbance of archaeological deposits related to the proximity of a prehistoric enclosure, a deserted medieval village and the Gilbertine Priory (OCAS 2012)

2 METHODOLOGY

- 2.1.1 A summary of Oxford Archaeology's general approach to excavation and recording was included in Appendix A of the Written Scheme of Investigation (WSI).
- 2.1.2 The area was excavated by a mechanical excavator using a toothless ditching bucket under the observation of an archaeological supervisor.
- 2.1.3 Ground deposits were recorded via a scale drawing and in the form of written and photographic records.

3 DESCRIPTION OF DEPOSITS

- 3.1.1 The area under excavation had a marked downward slope from west to east.
- 3.1.2 The deposits consisted of a topsoil deposit of moderately compact dark greyish brown clayey silt with frequent stone and rubble inclusions and ranged in thickness from 0.3m to 0.2m
- 3.1.3 Underlying this was a subsoil deposit of compact mid yellowish brown silty clay. This deposit was between 0.46m and 0.15m thick.



- 3.1.4 The underlying geology was a compact light yellow clay with occasional manganese inclusions.

4 DISCUSSION AND CONCLUSIONS

- 4.1.1 The marked slope in the area's topography and the reduction in the thickness of the subsoil deposits suggests a degree of landscaping which may relate to either the construction of current farm buildings to the east or the construction of the railway line to the west.
- 4.1.2 No archaeological deposits were observed within the excavated area. No artefactual evidence was recovered from either the topsoil deposit or the subsoil deposit. The presence overall of a substantial subsoil deposit would suggest that any previous landscaping and/or construction had minimal impact upon the excavated area.

5 BIBLIOGRAPHY AND REFERENCES

OCAS 2012 Clattercote Priory Farm, Lower Boddington Road, Claydon: A Design Brief for Archaeological Watching Brief

Oxford Archaeology 2012 Clattercote Priory Farm, Lower Boddington, Claydon. Written Scheme of Investigation for a Watching Brief.



Reproduced from the Landranger 1:50,000 scale by permission of the Ordnance Survey on behalf of The Controller of Her Majesty's Stationery Office © Crown Copyright 2005. All rights reserved. Licence No. AL 100005569

Figure 1: Site location

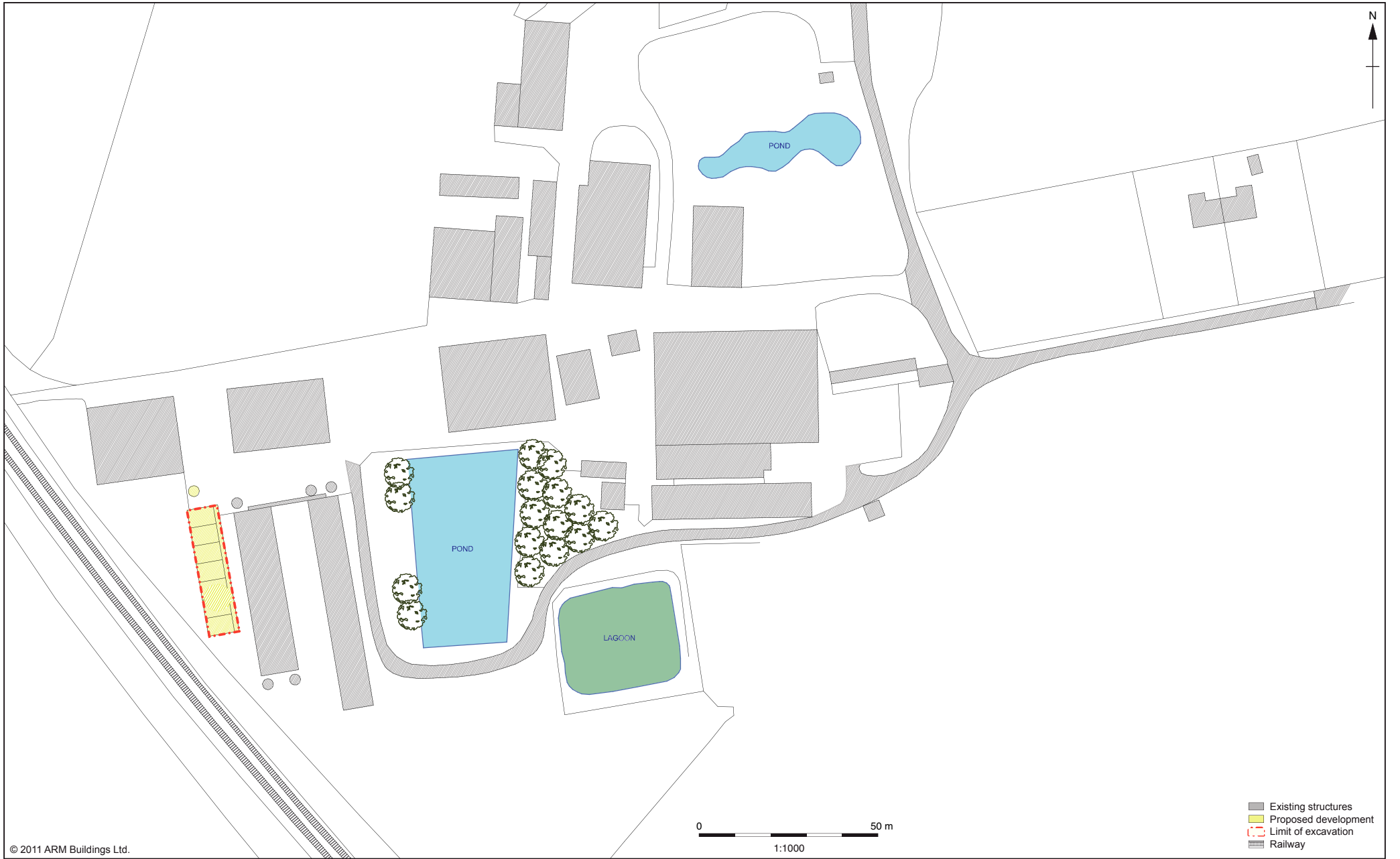

Figure 2: Trench location



**Head Office/Registered Office/
OA South**

Janus House
Osney Mead
Oxford OX2 0ES

t: +44 (0) 1865 263 800
f: +44 (0) 1865 793 496
e: info@oxfordarch.co.uk
w: <http://thehumanjourney.net>

OA North

Mill 3
Moor Lane
Lancaster LA1 1GF

t: +44 (0) 1524 541 000
f: +44 (0) 1524 848 606
e: [oanorth@thehumanjourney.net](mailto: oanorth@thehumanjourney.net)
w: <http://thehumanjourney.net>

OA East

15 Trafalgar Way
Bar Hill
Cambridgeshire
CB23 8SQ

t: +44 (0) 1223 850500
f: +44 (0) 1223 850599
e: [oaeast@thehumanjourney.net](mailto: oaeast@thehumanjourney.net)
w: <http://thehumanjourney.net>



Director: David Jennings, BA MIFA FSA

*Oxford Archaeology Ltd is a
Private Limited Company, N^o: 1618597
and a Registered Charity, N^o: 285627*