

Site/Project Name: **OXFORD, Lawn Upton School, Littlemore**

Site Code: LILUH10

Site/Project Type: Watching brief

Year(s): 2010

Accession Number: OXCMS:2010.54

Record Group	Contents	Comments	Box/File Number
	INTRODUCTION Brief Written scheme of investigation	See digital versions	Box 1 file 1
A	REPORT Watching brief report Oasis data collection form	See: http://library.thehumanjourney.net/866 3 sheets	Box 1 file 2
B	PRIMARY SITE DATA Watching brief record sheets Site notes	5 sheets 2 sheets	Box 1 file 3
B	CATALOGUE OF DRAWINGS Plan record sheet Plans	1 sheet 4 sheets	Box 1 file 4
D	CATALOGUE OF PHOTOGRAPHS Digital photo index Digital photo contact sheet	1 sheet 1 sheet	Box 1 file 5

PDF/A SCAN

FILMING INSTRUCTIONS

Submitter OA South

Headings

Site information

Line 1: [OASouth] County[Oxfordshire] Parish:[Littlemore]

Site[OXFORD: Lawn Upton House, Littlemore – OXCMS:2010.54

Site code[LILUH10]

Line 2: Excavators name[Nick Shepherd]

Line 3:

Classification of material

Tick if present

Classification of material	Tick if present
Index to archive	<input checked="" type="checkbox"/>
Introduction	<input type="checkbox"/>
A: Final Report	<input type="checkbox"/>
A: Publication Report	<input type="checkbox"/>
B: Site Data – Text: Diary/Daybook/Fieldnotes	<input type="checkbox"/>
B: Site Data – Text: General Summaries	<input type="checkbox"/>
B: Site Data – Text: Primary Context Records	<input type="checkbox"/>
B: Site Data – Text: Synthesised Context Records	<input type="checkbox"/>
B: Site Data – Text: Survey Reports	<input type="checkbox"/>
B: Site Data – Text: Catalogue of Drawings	<input type="checkbox"/>
B: Site Data – Text: Primary Drawings	<input type="checkbox"/>
B: Site Data – Text: Synthesised Drawings	<input type="checkbox"/>
C: Finds Data – Text: Primary Finds Data	<input type="checkbox"/>
C: Finds Data – Text: Synthesised Finds Data	<input type="checkbox"/>
C: Finds Data – Text: Specialist Reports	<input type="checkbox"/>
C: Finds Data – Text: Box/Bag List	<input type="checkbox"/>
D: Catalogue of Photos/Slides/Videos/X--rays	<input type="checkbox"/>
E: Environmental/Ecofact Data: Primary Records	<input type="checkbox"/>
E: Environmental/Ecofact Data: Synthesised Records	<input type="checkbox"/>
E: Environmental/Ecofact Data: Specialist Reports	<input type="checkbox"/>
F: Documentary	<input type="checkbox"/>
F: Press and Publicity	<input type="checkbox"/>
G: Correspondence	<input type="checkbox"/>
H: Miscellaneous	<input type="checkbox"/>

LITTLEMORE: Lawn Upton House, Littlemore,
Oxon

BOX 1 FILE 1

Introduction

--	--	--	--	--

PDF/A SCAN

FILMING INSTRUCTIONS

Submitter OA South

Headings

Site information

Line 1: [OASouth] County[Oxfordshire] Parish:[Littlemore]

Site[OXFORD: Lawn Upton House, Littlemore – OXCMS:2010.54

Site code[LILUH10]

Line 2: Excavators name[Nick Shepherd]

Line 3:

Classification of material

Tick if present

Index to archive	
Introduction	✓
A: Final Report	
A: Publication Report	
B: Site Data – Text: Diary/Daybook/Fieldnotes	
B: Site Data – Text: General Summaries	
B: Site Data – Text: Primary Context Records	
B: Site Data – Text: Synthesised Context Records	
B: Site Data – Text: Survey Reports	
B: Site Data – Text: Catalogue of Drawings	
B: Site Data – Text: Primary Drawings	
B: Site Data – Text: Synthesised Drawings	
C: Finds Data – Text: Primary Finds Data	
C: Finds Data – Text: Synthesised Finds Data	
C: Finds Data – Text: Specialist Reports	
C: Finds Data – Text: Box/Bag List	
D: Catalogue of Photos/Slides/Videos/X--rays	
E: Environmental/Ecofact Data: Primary Records	
E: Environmental/Ecofact Data: Synthesised Records	
E: Environmental/Ecofact Data: Specialist Reports	
F: Documentary	
F: Press and Publicity	
G: Correspondence	
H: Miscellaneous	

LITTLE MORE: Linn Vpton House, Littlemore,
Oxon

BOL 1 FILE 2

A: Report

--	--	--	--	--

PDF/A SCAN

FILMING INSTRUCTIONS

Submitter OA South

Headings

Site information

Line 1: [OASouth] County[Oxfordshire] Parish:[Littlemore]

Site[OXFORD: Lawn Upton House, Littlemore – OXCMS:2010.54

Site code[LILUH10]

Line 2: Excavators name[Nick Shepherd]

Line 3:

Classification of material

Tick if present

Classification of material	Tick if present
Index to archive	
Introduction	
A: Final Report	✓
A: Publication Report	
B: Site Data – Text: Diary/Daybook/Fieldnotes	
B: Site Data – Text: General Summaries	
B: Site Data – Text: Primary Context Records	
B: Site Data – Text: Synthesised Context Records	
B: Site Data – Text: Survey Reports	
B: Site Data – Text: Catalogue of Drawings	
B: Site Data – Text: Primary Drawings	
B: Site Data – Text: Synthesised Drawings	
C: Finds Data – Text: Primary Finds Data	
C: Finds Data – Text: Synthesised Finds Data	
C: Finds Data – Text: Specialist Reports	
C: Finds Data – Text: Box/Bag List	
D: Catalogue of Photos/Slides/Videos/X--rays	
E: Environmental/Ecofact Data: Primary Records	
E: Environmental/Ecofact Data: Synthesised Records	
E: Environmental/Ecofact Data: Specialist Reports	
F: Documentary	
F: Press and Publicity	
G: Correspondence	
H: Miscellaneous	

OASIS DATA COLLECTION FORM: England

[List of Projects](#) | [Manage Projects](#) | [Search Projects](#) | [New project](#) | [Change your details](#) | [HER coverage](#) | [Change country](#) | [Log out](#)

Printable version

OASIS ID: oxfordar1-173257

Project details

Project name	Lawn Upton House, Littlemore, Oxon
Short description of the project	In November 2010 Oxford Archaeology carried out a archaeological watching brief at Lawn Upton house, Littlemore, Oxford. The work was commissioned by Hives Planning on behalf of the Oxford Diocesan Trust. The watching brief covered the initial connection of drainage works and the formation of an access road to proposed new buildings within the western side of the site. No archaeological features or finds were encountered.
Project dates	Start: 15-11-2010 End: 22-11-2010
Previous/future work	Not known / Not known
Any associated project reference codes	LILUH 10 - Sitecode
Any associated project reference codes	OXCMS:2010.54 - Museum accession ID
Type of project	Recording project
Current Land use	Other 5 - Garden
Monument type	NONE None
Significant Finds	NONE None
Investigation type	""Watching Brief""
Prompt	Planning condition

Project location

Country	England
Site location	OXFORDSHIRE OXFORD LITTLEMORE Lawn Upton House, Littlemore, Oxon
Study area	0.20 Hectares
Site coordinates	SP 5374 0263 51.7193592059 -1.22196987527 51 43 09 N 001 13 19 W Point

Project creators

Name of Organisation	Oxford Archaeology
Project brief originator	Oxford City Council
Project design originator	Oxford Archaeology
Project director/manager	N. Shepherd
Project supervisor	B. Matthews
Type of sponsor/funding body	Landowner
Name of sponsor/funding body	Oxford Diocesan Trust

Project archives

Physical Archive Exists?	No
Digital Archive recipient	Oxford Archaeology
Digital Archive ID	LILUH 10
Digital Contents	"other"
Digital Media available	"Images raster / digital photography", "Spreadsheets", "Text"
Paper Archive recipient	Oxfordshire County Museum Service
Paper Archive ID	OXCMS:2010.54
Paper Contents	"other"
Paper Media available	"Diary", "Plan", "Report", "Section", "Unpublished Text"

Project bibliography 1

Publication type	Grey literature (unpublished document/manuscript)
Title	Lawn Upton House, Littlemore, Oxon
Author(s)/Editor(s)	Matthews, B.
Date	2010
Issuer or publisher	Oxford Archaeology
Place of issue or publication	Oxford, England
Description	Client report
URL	http://library.thehumanjourney.net/866
Entered by	Victoria Skipper (victoria.skipper@oxfordarch.ac.uk)
Entered on	5 March 2014

OASIS:

Please e-mail English Heritage for OASIS help and advice

© ADS 1996-2012 Created by Jo Gilham and Jen Mitcham, email Last modified Wednesday 9 May 2012

Cite only: <http://www.oasis.ac.uk/form/print.cfm> for this page

LITTLEMORE: Lawn Upton House, Littlemore,
Oxon.

Box 1 FILE ~~2~~ 3

D: Primary Context Records

--	--	--	--	--

PDF/A SCAN

FILMING INSTRUCTIONS

Submitter OA South

Headings

Site information

Line 1: [OASouth] County[Oxfordshire] Parish:[Littlemore]

Site[OXFORD: Lawn Upton House, Littlemore – OXCMS:2010.54

Site code[LILUH10]

Line 2: Excavators name[Nick Shepherd]

Line 3:

Classification of material

Tick if present

	Tick if present
Index to archive	
Introduction	
A: Final Report	
A: Publication Report	
B: Site Data – Text: Diary/Daybook/Fieldnotes	
B: Site Data – Text: General Summaries	
B: Site Data – Text: Primary Context Records	✓
B: Site Data – Text: Synthesised Context Records	
B: Site Data – Text: Survey Reports	
B: Site Data – Text: Catalogue of Drawings	
B: Site Data – Text: Primary Drawings	
B: Site Data – Text: Synthesised Drawings	
C: Finds Data – Text: Primary Finds Data	
C: Finds Data – Text: Synthesised Finds Data	
C: Finds Data – Text: Specialist Reports	
C: Finds Data – Text: Box/Bag List	
D: Catalogue of Photos/Slides/Videos/X--rays	
E: Environmental/Ecofact Data: Primary Records	
E: Environmental/Ecofact Data: Synthesised Records	
E: Environmental/Ecofact Data: Specialist Reports	
F: Documentary	
F: Press and Publicity	
G: Correspondence	
H: Miscellaneous	



WATCHING BRIEF RECORD

Monday

SITE CODE LILUM '10

SITE NAME Lawn Upton House, Littlemore.

DATE 15th Nov. 2010.

NGR

County

Start Time

10.45am

Oxford

Finish Time

12noon.

Milage

Previous Visit

Visit By

First Visit

B. Matthews.

Type of construction work

Initial assessment of drainage runs.

Contacts made

Spoke to Brian Johnson (foreman) workmen on site.

Archaeology present?

Yes:

No:

Undated:

Other:

COMMENTS

Arriving on site 11am.

Mostly un-loading scaffolding & materials at the moment. Brian explains that they've lifted the drain cover but now need to clear 'part-water' deposits before other work can commence. - Possibly to excavate a 1x1m test-pit this afternoon to trace drainage run - otherwise not due to re-commence until tomorrow morning

I have a look around the site - noting a large hollow & bank on the southern side of the school.

Departing @ 12 noon

Records?



WATCHING BRIEF RECORD

Tuesday

SITE CODE L1LUH'10

SITE NAME Lawn Upon Horse, Littlemore, Oxford

DATE 16th Nov. 2010

NGR

County

Start Time

8am

Oxon

Finish Time

3.15pm

Milage

Previous Visit

Yesterday

Visit By

B. Matthews

Type of construction work

Excavation of manhole pit & part of drainage run

Contacts made

Archaeology present?

Yes:

No: /

Undated:

Other:

COMMENTS

To site 8am. At first just fencing & constructing trench boxes in advance of digging drainage trench

Excavating a Manhole Pit (Pit 1) to connect to existing foul-water pipes - a 2m x 3m Box - 2m deep - no archaeology seen, just topsoil (100), subsoil (101), and a angular limestone soil (102) above natural sand (103). A scale section produced (on gridded paper) with context notes. No finds - no archaeology - this pit located on copy of 1:100 plan. Digi record photo of opened pit taken 1:2-3, with 2m scale.

Some pipe-cutting & then starting to pull the main N-S run - but only managing to do 3m of this - with the same result - no archaeology before dropping more shoring pieces. After lunch they discover that they don't have the correct pipe connections - I go off to buy more - asking at 2.15pm to be told that there would be no further excavation today.

Records?

One sheet with scale section & context notes + a few digital photos.



WATCHING BRIEF RECORD

Wednesday

SITE CODE LILUM '10

SITE NAME Lawn Upton House Littlemore, Oxford

DATE 17th Nov. 2010

NGR

County

Start Time

8am.

Oxon

Finish Time

3pm

Milage

Previous Visit

Visit By

Yesterday

B. Matthews

Type of construction work

Excavation of drainage - run.

Contacts made

Archaeology present?

Yes:

No:

Undated:

Other:

COMMENTS

~~Approx~~ Arriving 8am. Digging out a N-S drainage run today (See Add Sheet 2) - about 20m done in sections, with shuffling.

No archaeology found - stoney interface layer (102) continuing for about 6m to south, becoming stonier & thicker within east facing section & then stopping - this looks very much like a natural deposit - at its southern/S.W extend its more like 'com-brush' - not a structure. No finds.

This afternoon, testing drain connections - & the workmen decide that they will then backfill, rather than pull the last little bit - about another 4-5m under the proposed flats to connect to the bathroom service - until tomorrow morning.

8m leaving site at 3pm

Weather - rainy/overcast all day

Records?



WATCHING BRIEF RECORD

Thursday

SITE CODE **L144110**

SITE NAME **LAWN UPON HOUSE, LITTLEMOORE, OXFORD**

DATE **18th Nov 2010**

NGR

County

Start Time

8am - 9 | 2-3pm

Oxon.

Finish Time

Approx 3.30pm.

Milage

Previous Visit

Yesterday

Visit By

B. Matthews

Type of construction work

Major backfilling & tidying up this morning - ie sorting shattering boxes

Contacts made

& laying out access road to East.

Archaeology present?

Yes:

No:

Undated:

Other:

COMMENTS

Bm on site first thing - it quickly transpired that they aren't intending to put the last 4-5m of trench until either later this morning or this afternoon. -> leaving site to come back later

Returning ~~2pm~~ 2pm-3pm

The southern extension of the drainage trench dug - basically extending for another 10m beneath the foundations of one of the flats. Very similar stratigraphy seen - 0.2-0.3m topsoil (100) & up to 0.5m of orange brown subsoil (101) - with patchy platy limestone. - no archaeology or finds seen. - see Add sheet 2 for sketch

Apart from these works, there should be the underpin of a roadway between the flats - just to the East of the present drainage runs. These should be 0.15-0.2 deep - & there unpausing topsoil levels only. These to commence next Monday (22/11/10).

Records?



WATCHING BRIEF RECORD

B. Men.

SITE CODE LIW11'10

SITE NAME Lawn Upton School, Littlemore

DATE 22-11-10

NGR

County

Start Time

9am

Oxon

Finish Time

10 ..

Milage

Previous Visit

Visit By

Friday 19th Nov '10

B. Matthews

Type of construction work

Preparation for access road

Contacts made

Archaeology present?

Yes:

No: / — No dig — most of this access route is based on levelled up ground

Undated: — some small impact around original manhole — up to 0.15m

Other: but this a very small area & all in topsoil

COMMENTS

Apart from a very small area around the existing drive there was no impact — or only into topsoil — most of the access road based on levelled up ground in hollow to SE — 'no dig' ie no impact here. No archaeology or finds found.

Taking a few digi photos & then away...

Records?



CONTEXT RECORD ADDITIONAL SHEET

Context No.

SITE CODE **L11WH'10**

SITE NAME **Lawn Upon Horse, Littlemore Oxford**

SHEET NO. **1**

Section No 1 1:20 scale

WEST

EAST

9.65m OD

8.75m OD

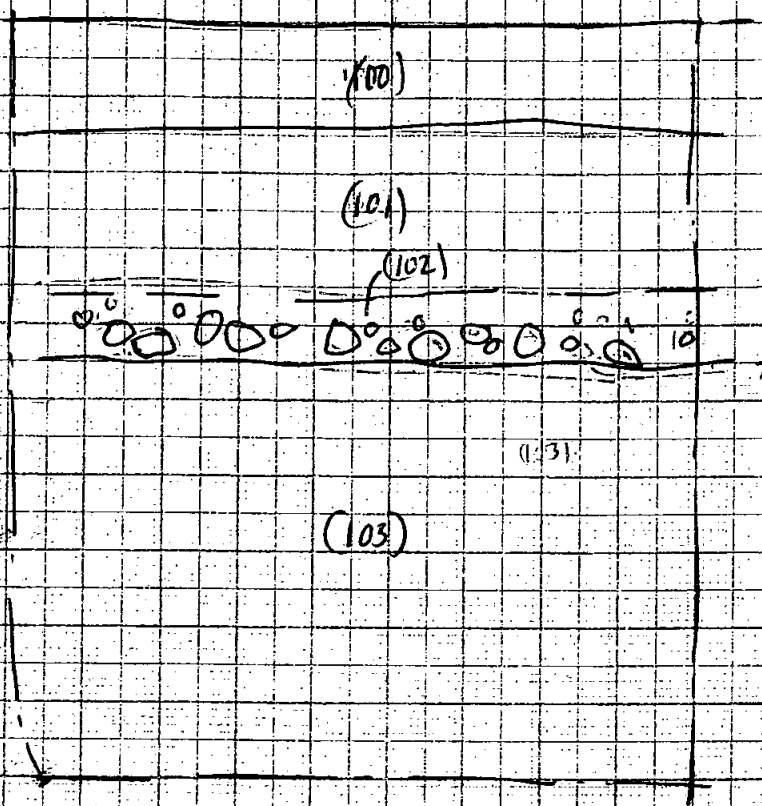

- (100) Topsoil, 0.3m thick
Dk brown loam, 3% small stone
- (101) Subsoil = 0.4m thick
Pale brown loam
fairly clean - 1% small stone
- (102) Inter-limestone fragments
in soil (as 101) - up to 20%
Angular brashy limestone
- either from natural outcrop
or possibly as a stony
deposit before leveling up
- this interface larger
up to 0.2m thick
- (103) Pale orange soft sand
= the natural
- seen between 0.9 - 2m
down

Fig 1 - South-facing sketch section
on pit for new (connecting)
man-hole cover Scale = 1:20

(102) - this deposit continues for approx
another 10m to South (see scale sketch
on grid sheet - Rough plan & section)
- becoming more stony at end - like cornbrash
- not a wall or archaeological feature
- just natural variations

6.2
8.2 x 3mlang

9.43
-0.70
8.73



CONTEXT RECORD ADDITIONAL SHEET

Context No.

1008

SITE CODE **LLWYD**

SITE NAME **Lawn Upton House, Littlemore, Oxford**

SHEET NO. **2**

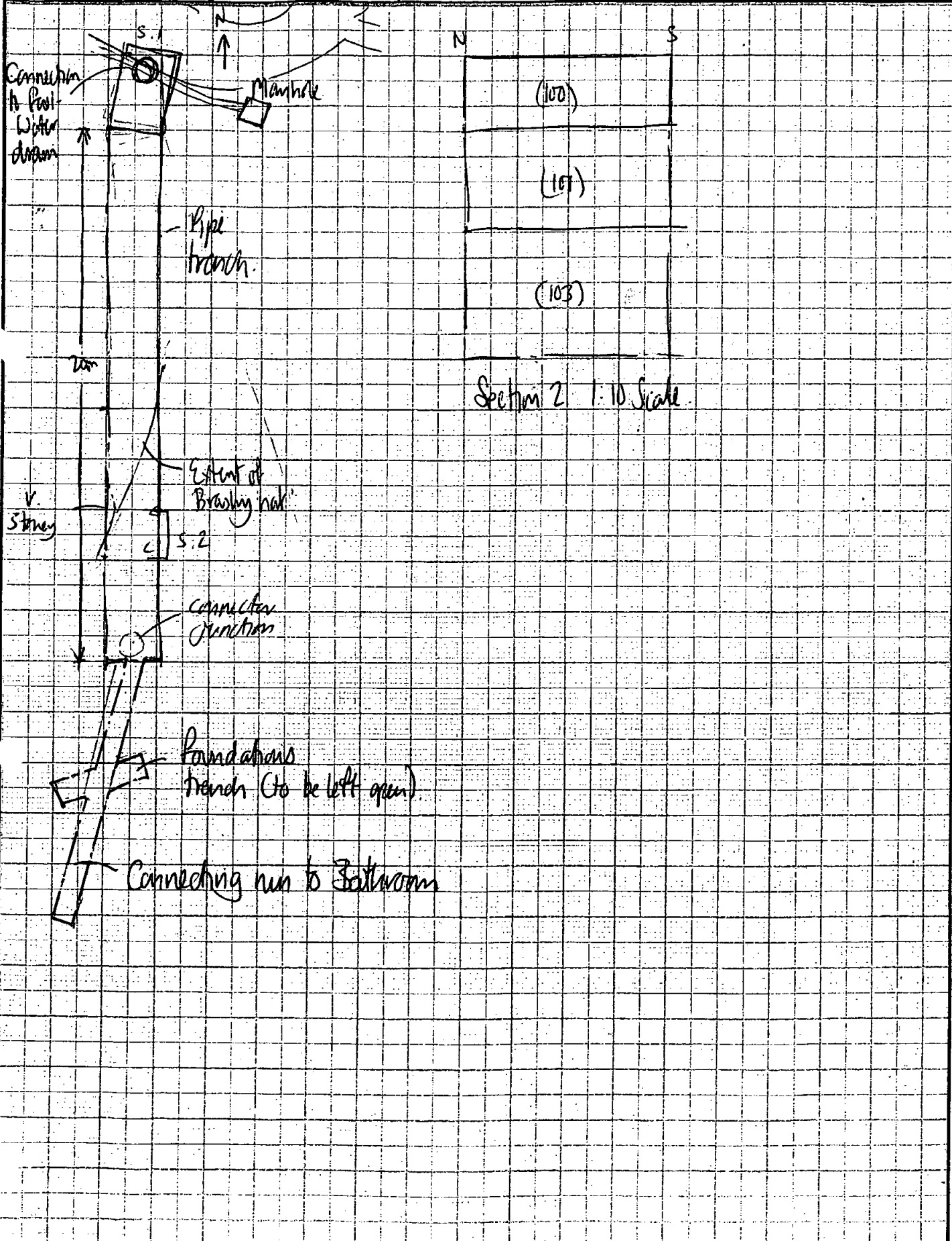

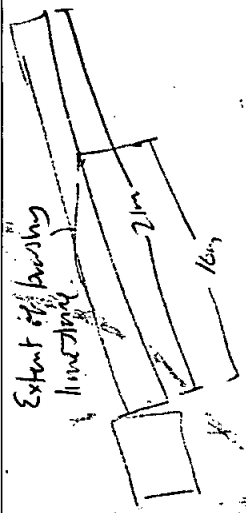

LITTLEMORE: Lawn Vpton House, Littlemore,
Oxon.

BOX 1 FILE 4

B: Catalogue of + Primary Drawings

PDF/A SCAN

FILMING INSTRUCTIONS

Submitter OA South

Headings

Site information

Line 1: [OASouth] County[Oxfordshire] Parish:[Littlemore]

Site[OXFORD: Lawn Upton House, Littlemore – OXCMS:2010.54

Site code[LILUH10]

Line 2: Excavators name[Nick Shepherd]

Line 3:

Classification of material

Tick if present

Index to archive	
Introduction	
A: Final Report	
A: Publication Report	
B: Site Data – Text: Diary/Daybook/Fieldnotes	
B: Site Data – Text: General Summaries	
B: Site Data – Text: Primary Context Records	
B: Site Data – Text: Synthesised Context Records	
B: Site Data – Text: Survey Reports	
B: Site Data – Text: Catalogue of Drawings	✓
B: Site Data – Text: Primary Drawings	
B: Site Data – Text: Synthesised Drawings	
C: Finds Data – Text: Primary Finds Data	
C: Finds Data – Text: Synthesised Finds Data	
C: Finds Data – Text: Specialist Reports	
C: Finds Data – Text: Box/Bag List	
D: Catalogue of Photos/Slides/Videos/X--rays	
E: Environmental/Ecofact Data: Primary Records	
E: Environmental/Ecofact Data: Synthesised Records	
E: Environmental/Ecofact Data: Specialist Reports	
F: Documentary	
F: Press and Publicity	
G: Correspondence	
H: Miscellaneous	

LOCATION OF DRAINAGE TRENCHES.

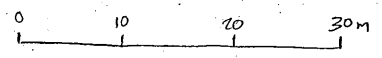

(4mm-10m)

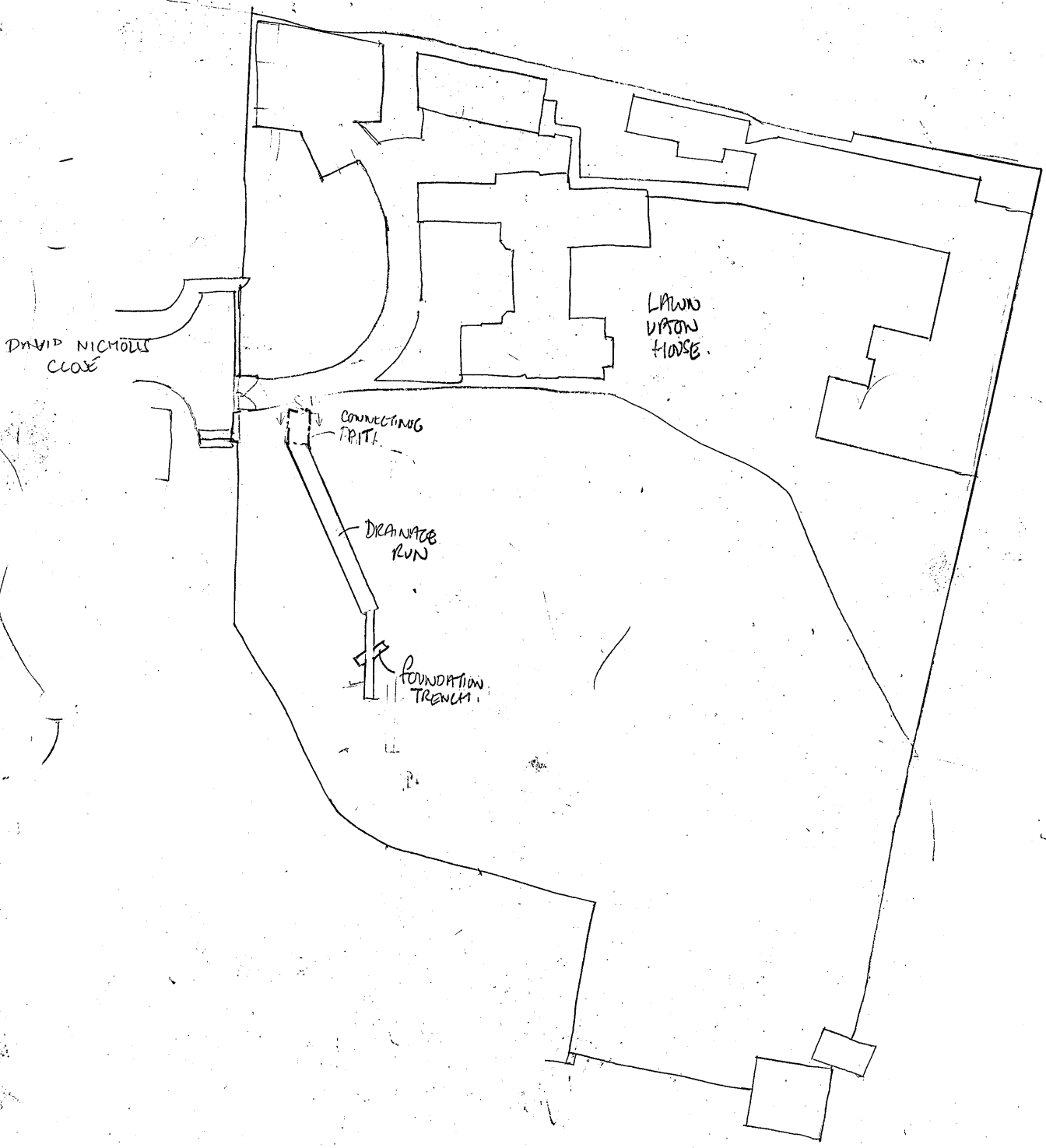

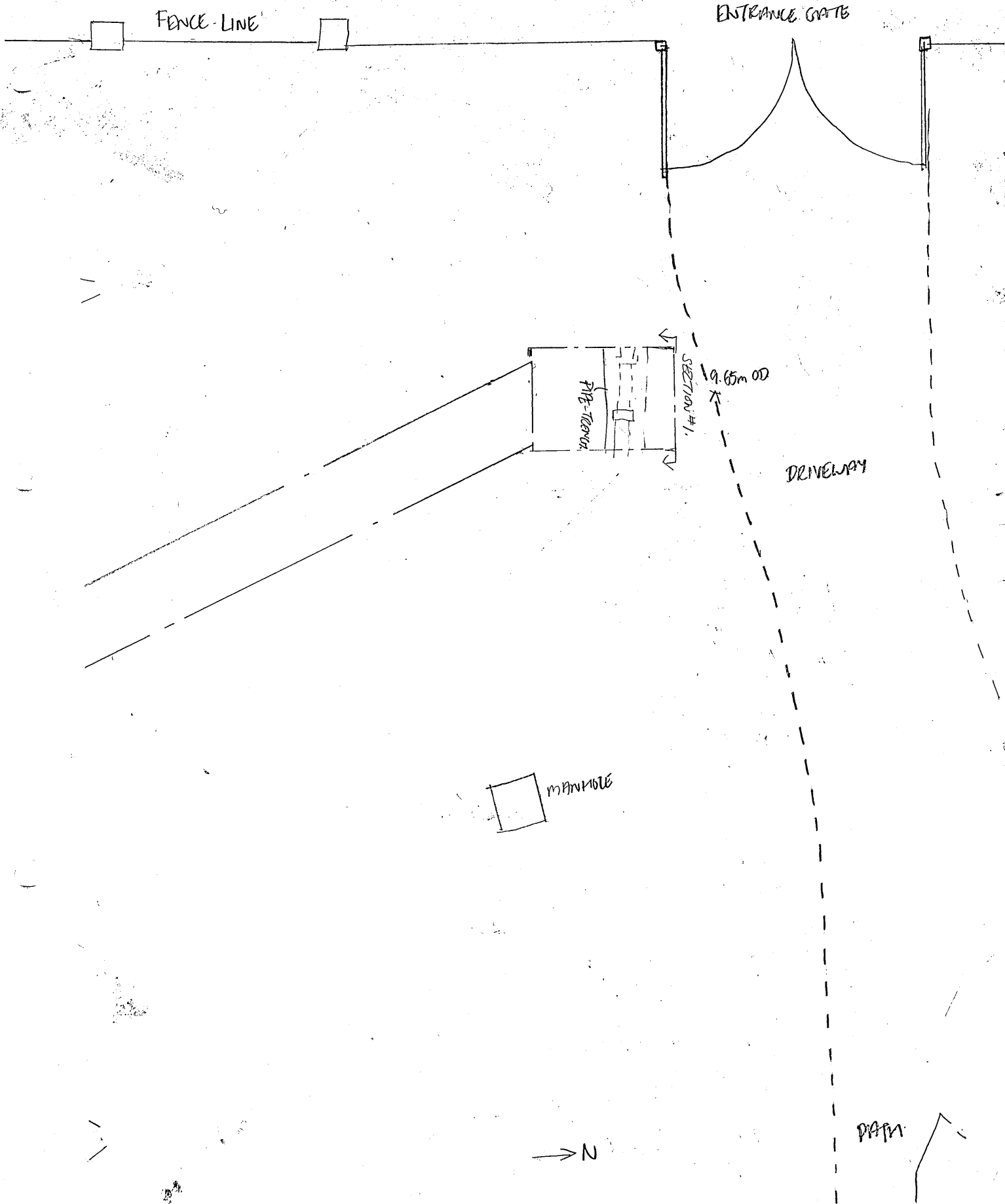

LILUH'10
 TRENCH PLAN (PLAN 2.)
 PT I OF III
 1:100 SCALE

SCALE 1:100
OF III
TRENCH PLAN
LILDM '10

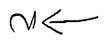

ALIGNMENT
MARKS

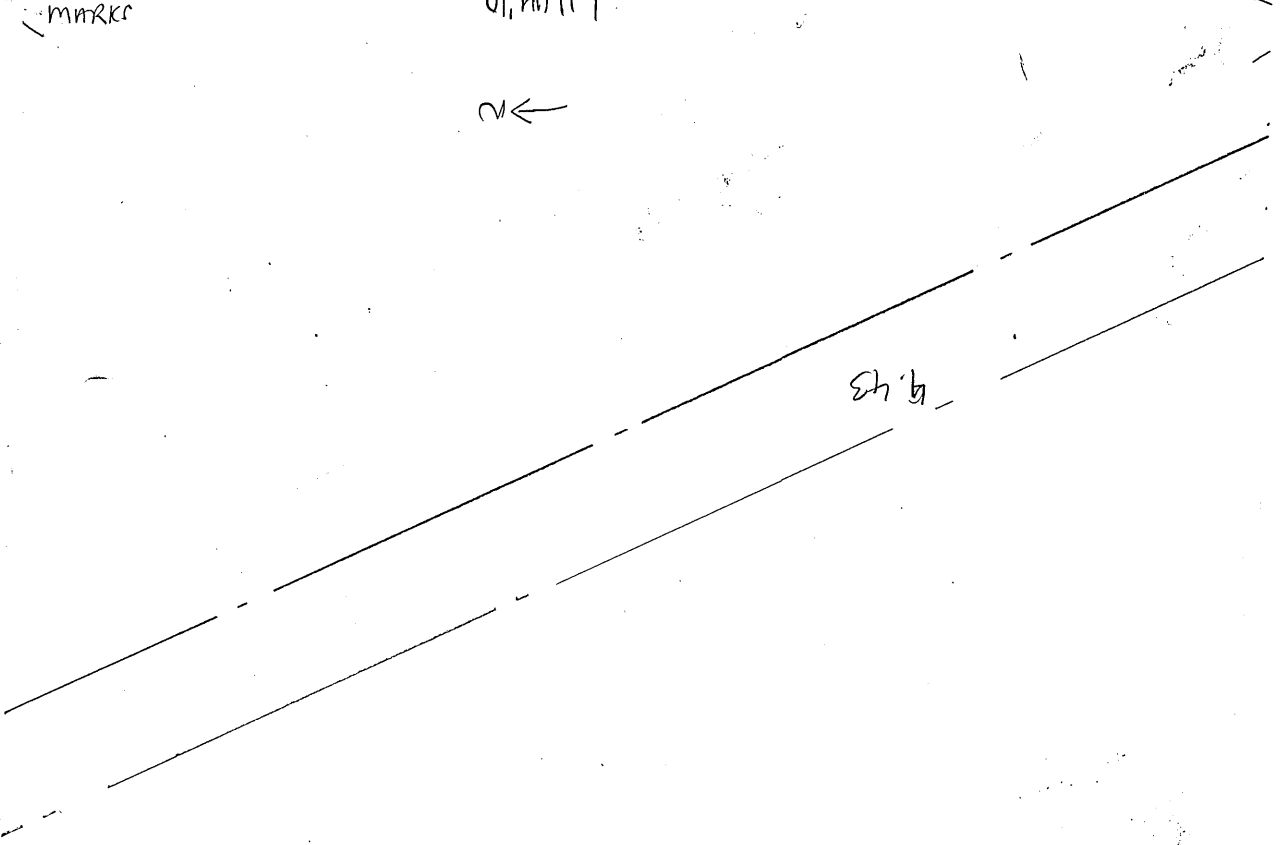

9.43

ALIGNMENT
MARKS

LILDM '10
PLAN 3
1:100 SCALE
OF III

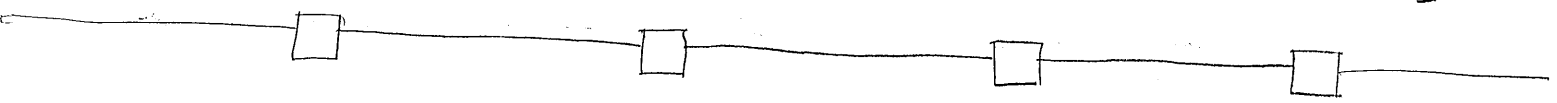

875. in hollow
16.77 on southern bank

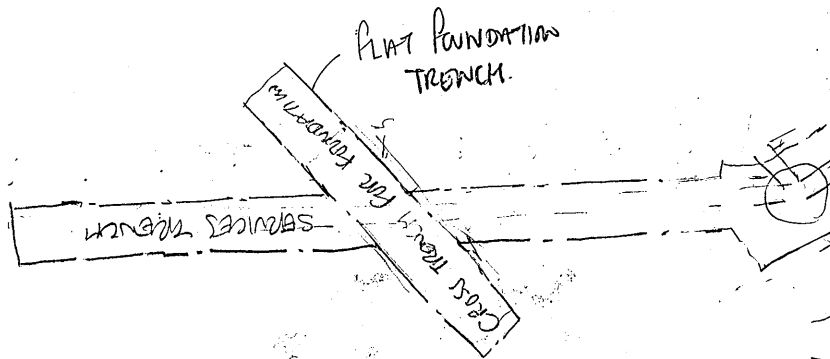
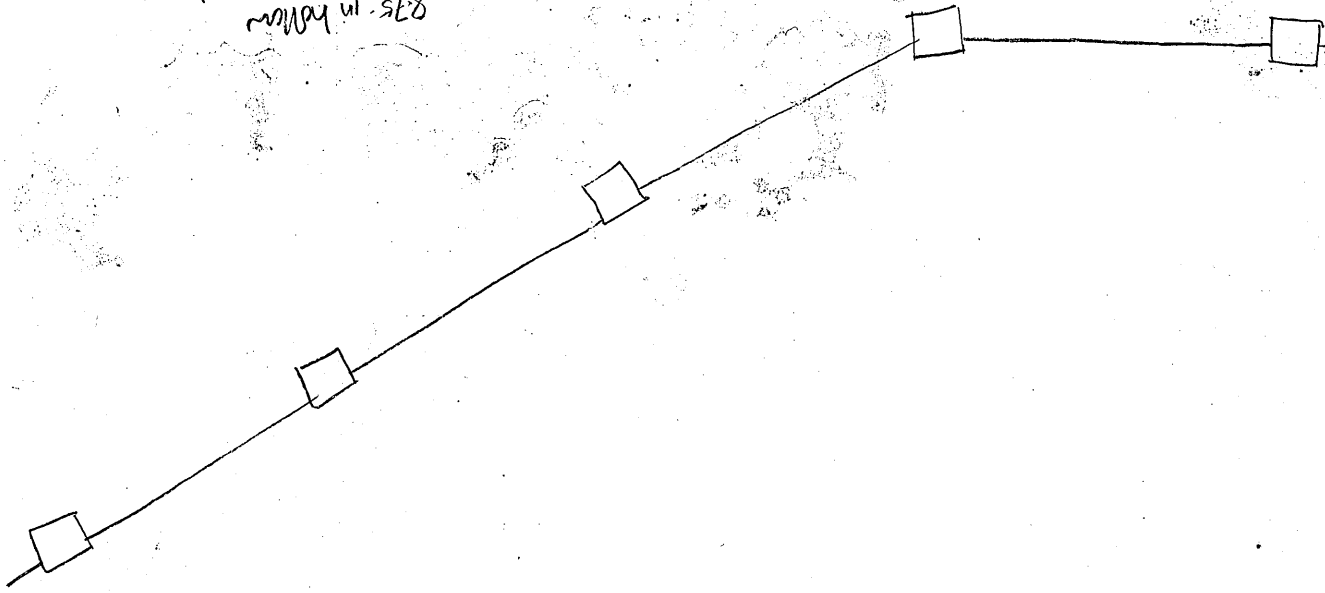

→ N
LILUH'10 PLAN No. 6
TRENCH PLAN
II OF III
1:100 SCALE

LITTLEMORE: Lawn Uphol House, Littlemore, Conn.

BOX 1 FILE 15

D: Catalogue of Photos

--	--	--	--	--

PDF/A SCAN

FILMING INSTRUCTIONS

Submitter OA South

Headings

Site information

Line 1: [OASouth] County[Oxfordshire] Parish:[Littlemore]

Site[OXFORD: Lawn Upton House, Littlemore – OXCMS:2010.54

Site code[LILUH10]

Line 2: Excavators name[Nick Shepherd]

Line 3:

Classification of material

Tick if present

Index to archive	
Introduction	
A: Final Report	
A: Publication Report	
B: Site Data – Text: Diary/Daybook/Fieldnotes	
B: Site Data – Text: General Summaries	
B: Site Data – Text: Primary Context Records	
B: Site Data – Text: Synthesised Context Records	
B: Site Data – Text: Survey Reports	
B: Site Data – Text: Catalogue of Drawings	
B: Site Data – Text: Primary Drawings	
B: Site Data – Text: Synthesised Drawings	
C: Finds Data – Text: Primary Finds Data	
C: Finds Data – Text: Synthesised Finds Data	
C: Finds Data – Text: Specialist Reports	
C: Finds Data – Text: Box/Bag List	
D: Catalogue of Photos/Slides/Videos/X--rays	✓
E: Environmental/Ecofact Data: Primary Records	
E: Environmental/Ecofact Data: Synthesised Records	
E: Environmental/Ecofact Data: Specialist Reports	
F: Documentary	
F: Press and Publicity	
G: Correspondence	
H: Miscellaneous	

Sheet1

	A	B	C	D	E	F
1	Site Code: LILUH10		Site Name: Littlemore Lawn Upton School			
2	Site shot Number	Archive Shot Number	View	Description	Initials	Date
3						
4		0001	E	View on eastern side of drain pit	BM	16/11/10
5		0002	E	View on eastern side of drain pit	BM	16/11/10
6		0003	E	View on eastern side of drain pit	BM	16/11/10
7		0004		View of borrowed 1:100 plan of works	BM	16/11/10
8		0005		View of the title box of 1:100 plan	BM	16/11/10
9		0006	S	View along southern end if drainage trench	BM	17/11/10
10		0007	N	View along southern end if drainage trench	BM	17/11/10
11		0008	NNE	View along southern end if drainage trench	BM	17/11/10
12		0009	NNW	View along southern end if drainage trench	BM	17/11/10
13		0010	E	Bell tower of Lawn Upton School	BM	20/11/10
14		0011	E	View of new access road	BM	20/11/10
15		0012	SE	View of new access road	BM	20/11/10
16		0013	E	View of new access road	BM	20/11/10
17		0014	W	View of works compound next to site entrance	BM	20/11/10
18		0015	W	View of works compound next to site entrance	BM	20/11/10
19		0016	E	Bell tower building, Lawn Upton School	BM	20/11/10
20						
21						
22						
23						
24						
25						
26						
27						
28						
29						
30						
31						
32						
33						
34						
35						
36						
37						
38						
39						
40						
41						
42						
43						
44						
45						
46						
47						
48						
49						
50						
51						
52						
53						
54						
55						
56						
57						



LILUH10_0001.JPG



LILUH10_0002.JPG



LILUH10_0003.JPG



LILUH10_0004.JPG



LILUH10_0005.JPG



LILUH10_0006.JPG



LILUH10_0007.JPG



LILUH10_0008.JPG



LILUH10_0009.JPG



LILUH10_0010.JPG



LILUH10_0011.JPG



LILUH10_0012.JPG



LILUH10_0013.JPG



LILUH10_0014.JPG



LILUH10_0015.JPG



LILUH10_0016.JPG