

Site/Project Name: **Easthampstead, Bracknell, South Hill Farm**

Site Code: BRSOHP 08

Site/Project Type: Watching Brief

Year(s): 2008

Accession Number: REDMG:2009.101

| Record Group | Contents  | Comments                        | Box/File Number |
|--------------|---|---------------------------------|-----------------|
|              | <b>INTRODUCTION</b><br>Written Scheme of Investigation  | 1 bound copy                    | Box 1 file 1    |
| A            | <b>REPORT</b><br>Archaeological watching brief report<br>OASIS form printout  | 1 bound copy<br>3 sheets        | Box 1 file 2    |
| B            | <b>PRIMARY CONTEXT DATA</b><br>Watching brief record sheet<br>Context checklist<br>Context record sheets  | 1 sheet<br>1 sheet<br>13 sheets | Box 1 file 3    |
| B            | <b>CATALOGUE OF DRAWINGS</b><br>Section record sheet  | 1 sheet                         | Box 1 file 4    |
| B            | <b>PRIMARY DRAWINGS</b><br>Annotated developers plan<br>Section drawings  | 1 A4 sheet<br>1 A4 sheet        | Box 1 file 5    |
| D            | <b>CATALOGUE OF PHOTOGRAPHS</b><br>Black & white photographic record sheet<br>Colour photographic record sheet<br>Digital photographic record sheet | 1 sheet<br>1 sheet<br>1 sheet   | Box 1 file 6    |
|              |   |                                 |                 |

The following items have been included within this archive as they are an integral part of the project information. Permission was granted for the use of these documents within the project, however anyone wishing to reproduce these items for any other reason will need to contact the appropriate copyright holder

**Annotated developers plan:** © The Morton Partnership Ltd

SCAN PDF

FILMING INSTRUCTIONS

Submitter OASouth

No. of CD copies: 2

Headings

Site information

Line 1: [OASouth] County:[Berkshire] Parish:[Easthampstead] Site:[Bracknell, South Hill Farm ]  
Site code[BRSOHP08]

Line 2: Excavators name[D. Dodds]

Line 3:

Classification of material

Tick if present

| Classification of material                         | Tick if present                     |
|--|-------------------------------------|
| Index to archive                                   | <input checked="" type="checkbox"/> |
| Introduction                                       | <input type="checkbox"/>            |
| A:Final Report                                     | <input type="checkbox"/>            |
| A:Publication Report                               | <input type="checkbox"/>            |
| B:Site Data – Text: Diary/Daybook/Fieldnotes       | <input type="checkbox"/>            |
| B: Site Data – Text: General Summaries             | <input type="checkbox"/>            |
| B: Site Data – Text: Primary Context Records       | <input type="checkbox"/>            |
| B: Site Data – Text: Synthesised Context Records   | <input type="checkbox"/>            |
| B: Site Data – Text: Survey Reports                | <input type="checkbox"/>            |
| B: Site Data – Text: Catalogue of Drawings         | <input type="checkbox"/>            |
| B: Site Data – Text: Primary Drawings              | <input type="checkbox"/>            |
| B: Site Data – Text: Synthesised Drawings          | <input type="checkbox"/>            |
| C: Finds Data – Text: Primary Finds Data           | <input type="checkbox"/>            |
| C: Finds Data – Text: Synthesised Finds Data       | <input type="checkbox"/>            |
| C: Finds Data – Text: Specialist Reports           | <input type="checkbox"/>            |
| C: Finds Data – Text: Box/Bag List                 | <input type="checkbox"/>            |
| D: Catalogue of Photos/Slides/Videos/X--rays       | <input type="checkbox"/>            |
| E: Environmental/Ecofact Data: Primary Records     | <input type="checkbox"/>            |
| E: Environmental/Ecofact Data: Synthesised Records | <input type="checkbox"/>            |
| E: Environmental/Ecofact Data: Specialist Reports  | <input type="checkbox"/>            |
| F: Documentary                                     | <input type="checkbox"/>            |
| F: Press and Publicity                             | <input type="checkbox"/>            |
| G: Correspondence                                  | <input type="checkbox"/>            |
| H: Miscellaneous                                   | <input type="checkbox"/>            |

EASTHAMPSTEAD BRACKNELL  
SOUTH HILL FARM

BR50HP08

Box 1 FILE 1

● INTRODUCTION

**SCAN PDF**

**FILMING INSTRUCTIONS**

Submitter OASouth

No. of CD copies: 2

Headings

Site information

Line 1: [OASouth] County:[Berkshire] Parish:[Easthampstead] Site:[Bracknell, South Hill Farm ]

Site code[BRSOHP08]

Line 2: Excavators name[D. Dodds]

Line 3:

Classification of material

Tick if present

| Classification of material                         | Tick if present                     |
|--|-------------------------------------|
| Index to archive                                   |                                     |
| Introduction                                       | <input checked="" type="checkbox"/> |
| A:Final Report                                     |                                     |
| A:Publication Report                               |                                     |
| B:Site Data – Text: Diary/Daybook/Fieldnotes       |                                     |
| B: Site Data – Text: General Summaries             |                                     |
| B: Site Data – Text: Primary Context Records       |                                     |
| B: Site Data – Text: Synthesised Context Records   |                                     |
| B: Site Data – Text: Survey Reports                |                                     |
| B: Site Data – Text: Catalogue of Drawings         |                                     |
| B: Site Data – Text: Primary Drawings              |                                     |
| B: Site Data – Text: Synthesised Drawings          |                                     |
| C: Finds Data – Text: Primary Finds Data           |                                     |
| C: Finds Data – Text: Synthesised Finds Data       |                                     |
| C: Finds Data – Text: Specialist Reports           |                                     |
| C: Finds Data – Text: Box/Bag List                 |                                     |
| D: Catalogue of Photos/Slides/Videos/X--rays       |                                     |
| E: Environmental/Ecofact Data: Primary Records     |                                     |
| E: Environmental/Ecofact Data: Synthesised Records |                                     |
| E: Environmental/Ecofact Data: Specialist Reports  |                                     |
| F: Documentary                                     |                                     |
| F: Press and Publicity                             |                                     |
| G: Correspondence                                  |                                     |
| H: Miscellaneous                                   |                                     |

Chris Blandford Associates

**South Hill Park,  
Bracknell,  
Berkshire**

NGR: SU 870 667

**Written Scheme of Investigation for  
an Archaeological Watching Brief****1 Introduction**

- 1.1 Oxford Archaeology has been commissioned by The Morton Partnership on behalf of Chris Blandford Associates to undertake an Archaeological Watching Brief during ground investigation works at South Hill Park, Bracknell, Berkshire. The site has the potential to contain archaeological and architectural data, which may be affected by the proposed development.
- 1.2 This Written Scheme of Investigation details how Oxford Archaeology (OA) would implement the watching brief. The work will be carried out in line with PPG 16 and the local Plan. Oxford Archaeology will meet at least the minimum standards as laid down by the Institute of Field Archaeologists (*Standards and Guidance for Watching Briefs 2001*). The first part is site specific while the Appendices detail general OA standards and procedures.

**2 Location, Geology and Topography**

- 2.1 South Hill Park mansion occupies an area of open park land including lakes. The underlying geology is alluvium over pebble gravel of the "Bagshot" series (Geological Survey of Great Britain sheet no. 268). The site lies at approximately 88 m OD.

**3 Archaeological Background**

- 3.1 South Hill Park mansion is a red brick building, mostly now in Victorian style. It lies within the remnants of its original 800 acre park, which still hold two lakes.
- 3.2 The first house on the site was constructed in 1760, in Italianate style with a baroque tower and decorated with stucco. This house was enclosed in 30 acres of park. The house was altered at the turn of the 19th century in preparation for a change of ownership.
- 3.3 Towards the end of the 19th century the house was largely rebuilt following fire. The rebuild left the house as seen today, however, the original east wing

was retained and incorporated in to the new Lawrence brick and Bath stone built mansion.

- 3.4 Since the turn of the 20th century the house has been in the ownership of various bodies including the Royal Sea Bathing Hospital, and the BBC. The site became the present day Arts Centre in 1973.

#### **4 Scope of works**

- 4.1 The proposed investigation are to comprise monitoring of partial removal of the steps on the South Terrace located immediately south of the building. The investigations are to examiner the nature of the voids below the steps.
- 4.2 Two trial pits are to be excavated up against the base of the South Terrace, where it is proposed to construct disabled access ramps.
- 4.3 Finally, a visible recording exercise will be carried out on the fabric of the wall and inlet to the Southern Lake. This will likely be restricted to a photographic record with accompanying notes. The inspection will be undertaken from a boat on the lake.

#### **5 Aims**

- 5.1 To preserve by record archaeological remains of any period that the works may remove or damage within the haulage road and contractor's enclave.
- 5.2 To determine the extent, condition, nature, character, quality and date of any archaeological remains affected by the proposed works.
- 5.3 To establish the ecofactual and environmental potential of archaeological deposits and features within the site and to take samples where appropriate.
- 5.4 To make available the results of the investigation

#### **6 Methodology**

- 6.1 Any archaeological features will be hand sampled. General site procedures are as defined in the Appendices to this document. All features and deposits will be issued with unique context numbers, and context recording will be in accordance with established OA practice as detailed in the OA Field Manual (OA 1992). All contexts, and any small finds and samples from them will be allocated unique numbers. Bulk finds will be collected by context. All excavation and recording will meet the requirements of the *IFA Standard and Guidance for Archaeological Watching Briefs* (IFA, 2001).
- 6.2 Any and all finds of gold and silver will be removed to a safe place at South Hill Park and reported to the Client who will inform the Ministry of Justice according to the procedures relating to the Treasure Act of 1996.

- 6.3 Digital photographs will be taken during the groundworks of any archaeological features and deposits. Site plans will be drawn at a scale of 1:50 (or 1:100 if void of archaeology) with larger scale plans of features as necessary. Section drawings of features and sample sections of stratigraphy will be drawn at a scale of 1:20.
- 6.4 Environmental sampling will be as defined in Appendix 2.
- 6.5 Fiona MacDonald of Berkshire Archaeology will be kept informed as to the progress of the fieldwork; site visits for monitoring will be arranged by OA.
- 6.6 The fieldwork will be undertaken by a project officer and an archaeologist under the direction of Dan Dodds, project manager. The overall direction of the project will be met by Nick Shepherd (OA, Head of Fieldwork).

## 7 Report and archive

- 7.1 A client report (appendix 8) on the results of the investigation will be completed within four weeks of the end of the fieldwork. The Project Officer and OA finds specialists will undertake the report stage under the direction of the Project Manager. Copies of the report will be submitted to Atkins Heritage for dissemination to the client and relevant bodies. OA will meet all the requirements of section 6 the brief.
- 7.2 The content and style of the report will be as defined in Appendix 8.
- 7.3 The site archive will be created in accordance with the guidelines published in Guidelines for the preparation of Excavation Archives for long-term storage (UK Inst. for Conservation 1990) and standards in the museum care of archaeological collections - see Appendix 8.
- 7.4 The project archive including finds (subject to the landowner's agreement) will be deposited with an appropriate repository agreed by the landowner in accordance with Berkshire Museum Service's requirements.
- 7.5 A fieldwork summary form shall be submitted to the Archaeology Data Service as part of the OASIS scheme.
- 7.6 The project archive including finds (subject to the landowner's agreement) will be deposited with an appropriate repository agreed by the landowner in accordance with Reading Museum and Central Library's requirements.
- 7.7 A list of specialists used by OA is presented below:

| Specialist                               | Subject                |
|--|------------------------|
| Liz Stafford (OA)                        | Geoarchaeologist       |
| Richard McPhail (UCL)                    | Soil micromorphologist |
| Mark Robinson (Oxford University Museum) | Plant remains analysis |
| Mark Robinson (Oxford University)        | Molluscs               |
| Rob Scaife (Freelance)                   | Pollen analysis        |



| Specialist   | Subject                              |
|--|--------------------------------------|
| Louise Loe (OA)  | Head of Burials Archaeology          |
| Faye Worley (OA)                                       | Animal bone analysis                 |
| Paul Miles (OA)  | Computer manager                     |
| Chris Puttick (OA)                                     | Head of Geomatics                    |
| Leigh Allen (OA)                                       | Finds manager                        |
| Rebecca Nicholson (OA)                                 | Environmental manager                |
| Jane Baldwin (OA)                                      | Community Relations Officer          |
| Vanessa Fell (Oxford Institute of Archaeology)         | Conservator                          |
| Kate Cramp (OA)  | Lithic analysis                      |
| Alistair Barclay (OA)                                  | Prehistoric pottery                  |
| Alistair Barclay (OA)                                  | Daub and other building materials    |
| Paul Booth (OA)  | Roman pottery                        |
| Paul Blinkhorn/Duncan Brown (Freelance)                | Saxon/medieval/post-medieval pottery |
| Chris Salter (Oxford University)                       | Slag                                 |
| Cecily Cropper (Freelance)                             | Glass                                |
| Ian Scott (Freelance)                                  | Metalwork                            |
| Dan Miles (Freelance)                                  | Worked wood/Dendrochronology         |
| Belfast Laboratory                                     | C14 dating                           |
| Sarah Hall (Oxford Archaeological Research Laboratory) | Thermoluminescence dating            |

## 8 Health and Safety

- 8.1 All OA project fieldwork is undertaken in accordance with all relevant current Health and Safety Legislation. This includes in particular the following regulations (the list is not intended to be exhaustive):

*Health and Safety at Work Act 1974*  
*Construction (Design and management) Regulations 1994*  
*The management of Health and Safety at Work Regulations 1992*  
*Personal Protective Equipment at Work Regulations 1992*  
*Work Equipment Regulations 1992*  
*Manual Handling Operations Regulations 1992*  
*Workplace (Health, Safety and Welfare) Regulations 1992*

- 8.2 The OA has its own Health and Safety Policy which refers to the manual Health and Safety in Field Archaeology (SCAUM 1997), and these two documents constitute the Health and Safety arrangements of the OA. The Director of OA is ultimately responsible under the terms of the Health and Safety Act (1974) for ensuring the safety of employees. He must know the broad requirements of relevant legislation; attend meetings of the OA Health and Safety Committee; ensure that responsibility for health and safety is properly assigned and accepted at all levels. The Director of the OA is David Jennings.
- 8.3 The Safety Co-ordinator of the OA: represents the director on matters of health and safety; keeps abreast of relevant legislation and approved practice, and disseminates this information to OA staff; advises staff as required on matters of health and safety; maintains the OA health and safety records; calls and chairs meetings of the OA Health and Safety Committee. The Safety Co-ordinator of the OA is Dan Poore.

- 8.4 The Project Director is the person delegated to take overall charge of a particular project. She/he is responsible for health and safety matters on the projects that they manage, reporting to the Safety Co-ordinator in the first instance, and ultimately to OA's Director. She/he must be satisfied that an adequate safety plan has been drawn up for the project, or for each phase of the project. The Project Director may also be the Project Manager in some cases (see below).
- 8.5 Individual Project Supervisors/Managers are the persons delegated to take charge of a particular phase or part of the overall project. They are responsible for ensuring that for each site that they are in charge of an adequate Risk Assessment and any amendments or additions to the Site Safety Plan have been drawn up prior to work starting on site, and they are immediately responsible for the Health and Safety of employees and sub-contractors under their supervision. They report directly to the Project Director and OA Safety Co-ordinator. The manager for this evaluation project will be Dan Dodds.
- 8.6 The OA Health and Safety Committee consist of the Director, Safety Co-ordinator, OA Manager and the Site Staff Representative. The Safety Officer normally calls meetings of the Committee when there is business for discussion, but may be called by other members of the committee.
- 8.7 OA's independent Health and Safety Consultants are Safety Services Ltd, Stanton Harcourt, Oxon, who are consulted with regard to matters such as deep trenching, shoring and working in confined spaces.
- 8.8 Prior to the project a pro-forma OA Health and Safety audit checklist is completed by the project manager/supervisor and passed to the OA Safety Co-ordinator for comment. A Risk Assessment document may also be completed. The Project Manager/supervisor ensures that the following information is available to the excavation team copy of the HSE poster 'Health and Safety Law - What You should Know', copy of the Safety Plan and Risk Assessment, Emergency Information Sheet giving details of nearest hospital etc, copy of the Notification of Project to HSE, location of an accident book.

## 9 General

- 9.1 General appendices relating to OA practices apply. Appendices 2, 8 and 11 are relevant to this particular project.

## 10 References

- IFA, 2001 *Standard and Guidance for Archaeological Watching Brief*
- OA, 1992 *Field Manual* (ed. D Wilkinson)
- SCAUM, 2006 *Health and Safety in Field Archaeology Manual*

---

---

## OA Standard Fieldwork Methodology Appendices

---

---

The following methods and terms will apply, where appropriate, to all OA fieldwork unless varied by undertakings specified in a detailed Written Scheme of Investigation.

---

---

### 7 WATCHING BRIEFS

- 7.1 Ground disturbances (demolition, general site strip and levelling, reduction for roads, excavation for service trenches and foundation trenches) will be monitored by an archaeological supervisor assisted, where necessary, by archaeological technicians and under the overall guidance of a project manager.
- 7.2 All archaeological features and deposits exposed will be recorded.
- 7.3 Where only the tops of features or deposits are exposed, these will be located on a site plan, planned, and recorded by written description and by photographs.
- 7.4 Visible artefacts will be collected in order to assist in the dating of features and deposits.
- 7.5 Where trenches are excavated through cut features (pits, ditches, etc.) and vertical stratigraphy is not present, the features will be recorded in section with appropriate collection of finds.
- 7.6 Where ground disturbance exposes stratified remains or significant features, these will be hand excavated by the archaeologist and recorded.
- 7.7 The archaeological curator will be advised at the earliest opportunity of any archaeological features or deposits that appear worthy of preservation *in situ*.
- 7.8 On completion of the fieldwork the site archive will be compiled and security copied.
- 7.9 Proposals for analysis and publication will be determined in the light of the results of the fieldwork.

### RECORDING

- 7.10 All on-site recording will be undertaken in accordance with the OA *Field Manual* (ed. D Wilkinson 1992).
- 7.11 A continuous unique numbering system will be operated. Written descriptions will be recorded on proforma sheets comprising factual data and interpretative elements.
- 7.12 Plans will normally be drawn at 1:50 but in urban or deeply stratified sites a scale of 1:20 will be used. Detailed plans will be at an appropriate scale. Burials will be drawn at 1:10.
- 7.13 A register of plans will be kept.
- 7.14 Sections of features or trenches showing stratigraphy will be drawn at 1:20 or 1:10.
- 7.15 A register of sections will be kept.
- 7.16 All sections will be tied in to Ordnance Datum if possible or into the contractors TBM.
- 7.17 A black and white and colour (35 mm transparency) photographic record, illustrating in both detail and general context the principal features and finds discovered will be maintained. The photographic record will also include working shots to illustrate more generally the nature of the archaeological work.

- 7.18 Photographs will be recorded on OA Photographic Record Sheets.
- 7.19 All identified finds and artefacts from stratified archaeological deposits will be retained, although certain classes of building material or post medieval pottery may sometimes be discarded after recording if an appropriate sample is retained.

## 8 EVALUATION AND WATCHING BRIEF REPORTS

- 8.1 Style and format of the report will be determined by OA, but will include as a minimum the following:
- A location plan of trenches and/or other fieldwork in relation to the proposed development.
  - Plans and sections of features as appropriate located at an appropriate scale.
  - A section drawing showing depth of significant deposits (if encountered) including present ground level with Ordnance Datum, vertical and horizontal scale.
  - A summary statement of the results.
  - A table summarising per trench the features, classes and numbers of artefacts contained within, spot dating of significant finds and an interpretation.
  - A reconsideration of the methodology used, and a confidence rating for the results.
  - An interpretation of the archaeological findings within both the site and their wider landscape/townscape setting.
- 8.2 Copies of the report will be supplied to the client and the Archaeological Officer monitoring the works. Copies of the report will also be supplied to the County Sites and Monuments Record on the understanding that it will become a public document after an appropriate period of time (normally six months).
- 8.3 If the evaluation works generate archaeological results of importance which merit wider publication, the client will be consulted about further arrangements.

### ARCHIVES

- 8.4 The site archive, including finds and environmental material, will be ordered, catalogued, labelled and conserved and stored according to the UKIC Guidelines for the preparation of excavation archives for long-term storage.
- 8.5 The site archive will be prepared to at least the minimum acceptable standard defined in Management of Archaeological Projects 2, English Heritage 1991.
- 8.6 The site archive will be microfilmed by the RCHME National Archaeological Record as a safeguard against the accidental loss and the long-term degeneration of paper records and photographs.
- 8.7 The site archive will be deposited with the relevant receiving Museum at the earliest opportunity unless further archaeological work on the site is expected within one year of completion of the archive. The OA will advise the landowner that any artefacts resulting from the project work should be given to the relevant Museum.

## 11 GENERAL

- 11.1 The requirements of the Brief will be met in full where reasonably practicable.
- 11.2 Any significant variations to the proposed methodology will be agreed with the local authority's archaeological representative in advance.
- 11.3 The scope of work detailed in the main part of the Written Scheme of Investigation is aimed at meeting the aims of the project in a cost effective manner. The Oxford Archaeological Unit attempts to foresee possible site specific problems and resource these. However there may be unusual circumstances which have not been included in the costing and programme.

- Unavoidable delays due to extreme bad weather, vandalism, etc.
- Complex structures or objects, including those in waterlogged conditions, requiring specialist removal.
- Extensions to specified trenches or feature sample sizes requested by the archaeological curator.
- Trenches requiring shoring or stepping, ground contamination, unknown services, poor ground conditions requiring additional plant, specialist reinstatement of surfaces (i.e. tarmac, turf).

#### HEALTH AND SAFETY and INSURANCE

- 11.4 All work will be carried out to the requirements of *Health and Safety at Work, etc. Act 1974*, *The Management of Health and Safety Regulations 1992*, the SCAUM (Standing Conference of Archaeological Unit Managers) H & S manual *Health and Safety in Field Archaeology 1991*, the OA Health and Safety Policy, and any main contractors requirements.
- 11.5 A copy of the OA's Health and Safety Policy is available on request. OA will require copies of the H & S policies of all other contractors and operators present on site in compliance with *The Manual of H & S Regulations 1992*.
- 11.6 The OA holds Employers Liability Insurance, Public Liability Insurance and Professional Indemnity Insurance. Details will be supplied on request.
- 11.7 The OA will not be liable to indemnify the client against any compensation or damages for or with respect to:
- Damage to crops being on the Area or Areas of Work (save in so far as possession has not been given to the Archaeological Contractor);
  - The use or occupation of land (which has been provided by the Client) by the Project or for the purposes of completing the Project (including consequent loss of crops) or interference whether temporary or permanent with any right of way, light, air or water or other easement or quasi easement which are the unavoidable result of the Project in accordance with the Agreement;
  - Any other damage which is the unavoidable result of the Project in accordance with the Agreement;
  - Injuries or damage to persons or property resulting from any act or neglect or breach of statutory duty done or committed by the client or his agents, servants or their contractors (not being employed by the Oxford Archaeological Unit) or for or in respect of any claims demands proceedings damages costs charges and expenses in respect thereof or in relation thereto.

#### COPYRIGHT and CONFIDENTIALITY

- 11.8 Oxford Archaeology will retain full copyright of any commissioned reports, tender documents or other project documents, under the Copyright, Designs and Patents Act 1988 with all rights reserved; excepting that it will provide an exclusive licence to the client in all matters directly relating to the project as described in the Written Scheme of Investigation.
- 11.9 Oxford Archaeology will assign copyright to the client upon written request but retains the right to be identified as the author of all project documentation and reports as defined in the Copyright, Designs and Patents Act 1988 (Chapter IV, s.79).
- 11.10 OA will advise the client of any such materials supplied in the course of projects which are not OA's copyright.
- 11.11 OA undertakes to respect all requirements for confidentiality about the client's proposals provided that these are clearly stated. It is expected that such conditions shall not unreasonably impede the satisfactory performance of the services required. OA further undertake to keep confidential any conclusions about the likely implications of such proposals for the historic

environment. It is expected that clients respect OA's general ethical obligations not to suppress significant archaeological data for an unreasonable period.

#### OA STANDARDS AND PROCEDURES

- 11.12 OA shall conform to the standards of professional conduct outlined in the Institute of Field Archaeologists' Code of Conduct, the IFA Code of Approved Practice for the Regulation of Contractual Arrangements in Field Archaeology, the IFA Standards and Guidance for Field Evaluations, Desk Based Assessments, etc. and the British Archaeologists and Developers Liaison Group Code of Practice.
- 11.13 OA is a member of the Institute of Environmental Assessment and the Council for British Archaeology.
- 11.14 Project Directors normally will be recognised in an appropriate Area of Competence by the IFA. For more extensive and complicated evaluation projects especially where they are part of large-scale programmes of work in historic urban centres, the procedures outlined in English Heritage's *Management of Archaeological Projects* 2nd Edition 1991 (MAP 2) will be followed for immediate post-field archive preparation and initial assessment. Agreement to then be reached, in collaboration with the local authority's archaeological representative, about what aspects will need to be taken forward to provide a report in the required format containing the information needed for planning purposes.

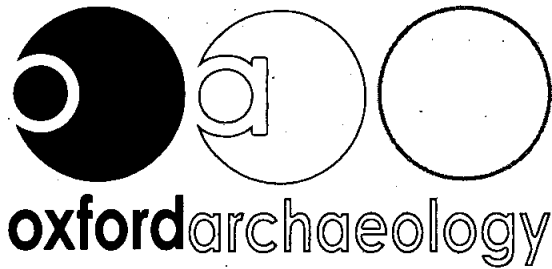

**OA South**

Janus House  
Osney Mead  
Oxford OX2 0ES

t: +44 (0) 1865 263 800  
f: +44 (0) 1865 793 496  
e: info@oxfordarch.co.uk  
w: <http://thehumanjourney.net>

**OA North**

Mill 3  
Moor Lane Mills  
Moor Lane  
Lancaster LA1 1GF

t: +44 (0) 1524 541 000  
f: +44 (0) 1524 848 606  
e: oanorth@thehumanjourney.net  
w: <http://thehumanjourney.net>

**OA East**

15 Trafalgar Way  
Bar Hill  
Cambridgeshire  
CB23 8SQ

t: +44 (0) 1223 850 500  
f: +44 (0) 1223 850 599  
e: oaeast@thehumanjourney.net  
w: <http://thehumanjourney.net>

**OA Méditerranée**

115 Rue Merlot  
ZAC La Louvade  
34 130 Mauguio  
France

t: +33 (0) 4.67.57.86.92  
f: +33 (0) 4.67.42.65.93  
e: oamed@thehumanjourney.net  
w: <http://oamed.fr/>

**Director:** David Jennings, BA MIFA FSA



*The Oxford Archaeological Unit Ltd is a  
Private Limited Company, No: 1618597  
and a Registered Charity, No: 285627  
Registered Office: Janus House,  
Osney Mead, Oxford, OX2 0ES*

EASTHAMPSTEAD BRACKNELL  
SOUTH HILL FARM

BRSOHP08

Box 1 FILE 2

A. REPORT



**SCAN PDF**

**FILMING INSTRUCTIONS**

Submitter OASouth

No. of CD copies: 2

Headings

Site information

Line 1: [OASouth] County:[Berkshire] Parish:[Easthampstead] Site:[Bracknell, South Hill Farm ]

Site code[BRSOHP08]

Line 2: Excavators name[D. Dodds]

Line 3:

Classification of material

Tick if present

| Classification of material                         | Tick if present |
|--|-----------------|
| Index to archive                                   |                 |
| Introduction                                       |                 |
| A:Final Report                                     | ✓               |
| A:Publication Report                               |                 |
| B:Site Data – Text: Diary/Daybook/Fieldnotes       |                 |
| B: Site Data – Text: General Summaries             |                 |
| B: Site Data – Text: Primary Context Records       |                 |
| B: Site Data – Text: Synthesised Context Records   |                 |
| B: Site Data – Text: Survey Reports                |                 |
| B: Site Data – Text: Catalogue of Drawings         |                 |
| B: Site Data – Text: Primary Drawings              |                 |
| B: Site Data – Text: Synthesised Drawings          |                 |
| C: Finds Data – Text: Primary Finds Data           |                 |
| C: Finds Data – Text: Synthesised Finds Data       |                 |
| C: Finds Data – Text: Specialist Reports           |                 |
| C: Finds Data – Text: Box/Bag List                 |                 |
| D: Catalogue of Photos/Slides/Videos/X--rays       |                 |
| E: Environmental/Ecofact Data: Primary Records     |                 |
| E: Environmental/Ecofact Data: Synthesised Records |                 |
| E: Environmental/Ecofact Data: Specialist Reports  |                 |
| F: Documentary                                     |                 |
| F: Press and Publicity                             |                 |
| G: Correspondence                                  |                 |
| H: Miscellaneous                                   |                 |

# South Hill Park Bracknell Berkshire



Archaeological  
Watching Brief Report



February 2009

**Client: Chris Blandford Associates**

Issue No: 1

OA Job No: 4272

NGR: SU 870 667

Archaeological Watching Brief Report

**Client Name:** Chris Blandford Associates  
**Client Ref No:**  
**Document Title:** South Hill Park, Bracknell, Berkshire

**Document Type:** Watching Brief

**Issue Number:** 1

**National Grid Reference:** SU 870 667  
**Planning Reference:**

**OA Job Number:** 4272  
**Site Code:** BRSOHP 08  
**Invoice Code:** BRSOHPWB  
**Receiving Museum:** Reading Museum Service  
**Museum Accession No:** tbc

**Prepared by:** Mike Sims  
**Position:** SWD Supervisor  
**Date:** 30th January 2009

**Checked by:** Dan Dodds  
**Position:** Head of Small Works  
**Date:** 3rd February 2009

**Approved by:** Alan Hardy  
**Position:** Head of Fieldwork  
**Date:** 16th February 2009

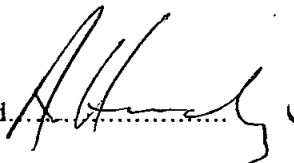
Signed 

**Document File Location** W:PROJECTS Berkshire BR/Bracknell Forest BF/10013  
South Hill Park WB/wbREP.doc  
**Graphics File Location** Severgo:/oaupubs  
1\_AtoH\*BRSOHP08\*BRSOHPWB\*South Hill Park,  
Bracknell\*AH\*05.02.09  
**Illustrated by** Amy Hemingway

**Disclaimer:**

*This document has been prepared for the titled project or named part thereof and should not be relied upon or used for any other project without an independent check being carried out as to its suitability and prior written authority of Oxford Archaeology being obtained. Oxford Archaeology accepts no responsibility or liability for the consequences of this document being used for a purpose other than the purposes for which it was commissioned. Any person/party using or relying on the document for such other purposes agrees, and will by such use or reliance be taken to confirm their agreement to indemnify Oxford Archaeology for all loss or damage resulting therefrom. Oxford Archaeology accepts no responsibility or liability for this document to any party other than the person/party by whom it was commissioned.*

**Oxford Archaeology**  
© Oxford Archaeological Unit Ltd 2009  
Janus House  
Osney Mead  
Oxford OX2 0ES  
t: (0044) 01865 263800  
f: (0044) 01865 793496

e: info@oxfordarch.co.uk  
w: www.oxfordarch.co.uk

Oxford Archaeological Unit Limited is a Registered Charity No: 285627

## South Hill Park Bracknell, Berkshire

### *ARCHAEOLOGICAL WATCHING BRIEF REPORT*

#### CONTENTS

|  |   |
|--|---|
| Summary .....                                      | 1 |
| 1 Introduction.....                                | 1 |
| 1.1 Scope of work.....                             | 1 |
| 1.2 Location, geology and topography .....         | 1 |
| 1.3 Archaeological and historical background ..... | 1 |
| 2 Project Aims and Methodology.....                | 2 |
| 2.1 Aims.....                                      | 2 |
| 2.2 Methodology.....                               | 2 |
| 3 Results .....                                    | 3 |
| 3.1 Description of deposits .....                  | 3 |
| 3.2 Finds .....                                    | 4 |
| 3.3 Palaeo-environmental remains.....              | 4 |
| 4 Discussion and Conclusions .....                 | 4 |
| Appendix 1 Archaeological Context Inventory.....   | 5 |
| Appendix 2 Bibliography and References.....        | 5 |
| Appendix 3 Summary of Site Details.....            | 6 |

#### LIST OF FIGURES

- Fig. 1 Site location  
 Fig. 2 Site plan  
 Fig. 3 Sections  
 Plate 1 Southern lake inlet and wall  
 Plate 2 West wall of southern inlet, showing subsidence
- Front cover: Southern terrace of main building

## SUMMARY

*On 1st December 2008, Oxford Archaeology (OA) carried out an archaeological watching brief during geotechnical test pitting at South Hill Park, Bracknell, Berkshire (NGR: SU 870 667). The work was commissioned by Chris Blandford Associates in advance of the proposed construction of a disabled access ramp. A photographic record of the southern lake inlet wall was also undertaken at the same time. The watching brief revealed details of the construction of the south terrace walls and deposits of made ground associated with landscaping of the grounds. No other significant archaeology was observed.*

## 1 INTRODUCTION

### 1.1 Scope of work

- 1.1.1 On the 1st December 2008 Oxford Archaeology (OA) carried out an archaeological watching brief at South Hill Park, Bracknell, Berkshire (NGR: SU 870 667). The work was commissioned by Chris Blandford Associates, in respect of a proposal to construct a new disabled access ramp onto the south terrace. Work was also carried out recording the walls at the southern lake inlet.
- 1.1.2 The excavation of the geotechnical test pits dug in order to investigate the construction of the south terrace wall had the potential to affect archaeological deposits and an archaeological watching brief was attached to the works.
- 1.1.3 OA produced a Written Scheme of Investigation (WSI) showing how it would meet the requirements of the watching brief (OA, 2008).

### 1.2 Location, geology and topography

- 1.2.1 South Hill Park lies on the southern edge of the town of Bracknell (Fig. 1) and comprises a mansion, landscaped gardens including a southern terrace and an area of open park land including lakes occupying an area of c3.5 hectare. The northern lake and grounds slope gently to the north, while the southern grounds and lake are roughly level.
- 1.2.2 The underlying geology is alluvium over pebble gravel of the "Bagshot" series (Geological Survey of Great Britain sheet no. 269). The site lies at approximately 88 m OD.

### 1.3 Archaeological and historical background

#### *Summary*

- 1.3.1 The archaeological background to the watching brief was prepared for the WSI for the project (OA, 2008) and is reproduced overleaf.

- 1.3.2 South Hill Park mansion is a red brick building, mostly now in Victorian style. It lies within the remnants of its original 800 acre park, which still holds two lakes.
- 1.3.3 The first house on the site was constructed in 1760, in Italianate style with a baroque tower and decorated with stucco. This house was enclosed in 30 acres of park. The house was altered at the turn of the 19th century in preparation for a change of ownership.
- 1.3.4 Towards the end of the 19th century the house was largely rebuilt following fire. The rebuild left the house as seen today, however, the original east wing was retained and incorporated into the new Lawrence mansion of brick and Bath stone.
- 1.3.5 Since the turn of the 20th century the house has been in the ownership of various bodies including the Royal Sea Bathing Hospital, and the BBC. The site became the present day Arts Centre in 1973.

## 2 PROJECT AIMS AND METHODOLOGY

### 2.1 Aims

- 2.1.1 To identify and record the presence or absence, extent, condition, quality and date of archaeological remains in the areas affected by the development.
- 2.1.2 To preserve by record any archaeological deposits or features that may be disturbed or destroyed during the course of this phase of ground works.
- 2.1.3 To provide information to determine a mitigation strategy for the main phase of construction.
- 2.1.4 To make available the results of the archaeological investigation.

### 2.2 Methodology

- 2.2.1 The watching brief was conducted as an archaeological presence during the hand excavation of the geotechnical pits adjacent to the terrace. The recording of the walls at the southern lake inlet was accomplished using a photographic survey.
- 2.2.2 A plan showing the location of the test pits and the extent of the walls at the southern lake was maintained at a scale of 1:100 and 1:500 respectively (Fig. 2). The recorded sections were drawn at a scale of 1:20. All excavations and any recorded sections were photographed using digital photography, colour slide and black and white print film and the photographic survey was accomplished similarly. A general photographic record of the work was also made. Recording followed procedures detailed in the *OA Field Manual* (ed D Wilkinson, 1992).

### 3 RESULTS

#### 3.1 Description of deposits

##### *Test Pit 1*

- 3.1.1 This was located to the north of the west wall steps leading onto the south terrace (Fig. 2, Test Pit 1; Fig. 3, Section 1).
- 3.1.2 The underlying natural, an orange-brown sandy clay (12) was encountered at a depth of 0.5 m below the current ground level. This was overlaid by a 0.3 m deep layer of grey-brown clay silt (11), a probable alluvium layer. Cutting this deposit was a north-south linear feature, running parallel with the west wall of the south terrace (16). This cut was 0.95 m deep and had a vertical face and a flat base.
- 3.1.3 The bottom 0.8 m of this feature was filled with a compact masonry layer composed of small to medium sized sandstone fragments and lime mortar (14). Built upon this was a brick wall (13) whose bottom four courses were composed of red hand moulded bricks measuring 0.228 m x 0.105 m x 0.065 m. these were laid using lime mortar and English stretcher bond. The wall above these courses had been rebuilt using modern machine made red bricks. These measured 0.225 m x 0.115 m x 0.072 m and were laid using a cement mortar and English stretcher bond.
- 3.1.4 A light grey-brown clay silt (15) had been used to backfill the remainder of the foundation trench. This was sealed by a 0.22 m deep layer of dark brown clay loam (10), a landscaping layer of topsoil and turf.

##### *Test Pit 2*

- 3.1.5 This was located against the south wall of the south terrace midway between the two sets of steps (Fig. 2, Test Pit 2; Fig. 3, Section 2).
- 3.1.6 A layer of natural, a yellow-brown sandy clay containing numerous yellow flint pebbles (22) was encountered at a depth of 0.4 m below the current ground level. This was overlaid by a 0.15 m deep layer of grey-brown clay silt (21), a probable alluvial deposit similar to layer 11 in Pit 1. This was cut by an east-west running foundation trench (24), running parallel to the south wall of the terrace. This was 0.25 m deep and had a vertical face and a flat base. Poured within this cut was a weak concrete composed of pebbles, fragments of brick and lime mortar (23), 0.15 m deep. Built onto the top of this foundation was a brick wall (25) forming the southern edge of the terrace. This was built using red hand moulded bricks measuring 0.228 m x 0.105 m x 0.065 m laid in a lime mortar using English stretcher bond.
- 3.1.7 Overlying the footings and the alluvium was a 0.15 m deep layer of dark brown clay loam (20), which produced examples of modern coins (2 p pieces) and plastic, and which represents a modern landscaping layer.

***Structural recording on the inlet of the south lake***

- 3.1.8 The masonry comprising the inlet to the southern lake was composed of a stone wall enclosing the southern end of the lake, with a concrete pipe projecting out of its southern extent (Plate 1).
- 3.1.9 The stone wall was built using dressed sandstone blocks measuring on average 0.25 m x 0.18 m x 0.15 m. The wall consisted of 4 courses. The bottom 3 courses were laid using Flemish bonding, while the upper course was laid using the blocks on edge and running the width of the wall, the total height measuring 0.62 m. This was constructed on a concrete foundation which projected 0.2 m in front of the wall.
- 3.1.10 Because of silting it was impossible to determine the thickness of the concrete foundations.
- 3.1.11 The south wall ran round all three sides of the southern end of the lake. The wall flanking the west side was only 13.2 m long (Plate 2) while the wall on the eastern side was in excess of 70 m long. All construction seems to have been part of the same phase of work with a similar style of construction and materials being used throughout.
- 3.1.12 The wall is in a generally good state of repair, however within a 3 m long stretch of wall along the western edge of the lake, the concrete footing has partially subsided (possibly in the silts forming the sides of the lake) leaving the stone wall unsupported (Plate 2).

**3.2 Finds**

- 3.2.1 No dating evidence other than modern finds were recovered during the course of the watching brief. The presence of these artefacts was recorded but they were not retained.

**3.3 Palaeo-environmental remains**

- 3.3.1 No deposits suitable for palaeo-environmental sampling were observed during the course of the watching brief.

**4 DISCUSSION AND CONCLUSIONS**

- 4.1.1 All the archaeologically significant deposits observed relate to the 18th-and 19th-century construction of the house or to the modern day use of the site. This can be accounted for by both the limited area exposed and the proximity of the test pits to the standing structures. The walls forming the water inlet of the southern lake are of probable 20th-century construction.



## APPENDICES

## APPENDIX 1 ARCHAEOLOGICAL CONTEXT INVENTORY

| <i>Context</i> | <i>Type</i> | <i>Depth</i> | <i>Width</i> | <i>Comments</i>                   | <i>Finds</i>             | <i>Date</i>     |
|----------------|-------------|--------------|--------------|-----------------------------------|--------------------------|-----------------|
| Test Pit 1     |             |              |              |                                   |                          |                 |
| 10             | Layer       | 0.25 m       | -            | Topsoil and turf                  | -                        | C20th           |
| 11             | Layer       | 0.25 m       | -            | Alluvial deposit                  | -                        | -               |
| 12             | Layer       | > 0.85 m     | -            | Bagshot Gravels                   | -                        | -               |
| 13             | Wall        | > 1 m        | -            | West wall of terrace              | Brick                    | C18th/<br>C19th |
| 14             | Structure   | 0.75 m       | -            | Foundations for terrace wall      | -                        | C18th/<br>C19th |
| 15             | Fill        | 0.25 m       | -            | Backfill of construction cut      | -                        | C18th/<br>C19th |
| 16             | Cut         | 0.95 m       | -            | Construction cut for terrace wall | -                        | C18th/<br>C19th |
| Test Pit 2     |             |              |              |                                   |                          |                 |
| 20             | Layer       | 0.15 m       | -            | Topsoil and turf                  | Plastic,<br>modern coins | C20th           |
| 21             | Layer       | 0.25 m       | -            | Alluvial deposit                  | -                        | -               |
| 22             | Layer       | > 0.2 m      | -            | Bagshot Gravels                   | -                        | -               |
| 23             | Structure   | 0.38 m       | -            | Wall foundations                  | Brick                    | C18th/<br>C19th |
| 24             | Cut         | 0.3 m        | -            | Construction cut                  | -                        | C18th/<br>C19th |
| 25             | Wall        | > 1 m        | -            | South wall of terrace             | Brick                    | C18th/<br>C19th |

## APPENDIX 2 BIBLIOGRAPHY AND REFERENCES

IFA, 2001 *Standards and Guidelines for Archaeological Watching Briefs*

OA, 2008 *South Hill Park, Bracknell, Berkshire: Written Scheme of Investigation for an Archaeological Watching Brief*

OAU, 1992 *Field Manual* (ed. D Wilkinson)

**APPENDIX 3 SUMMARY OF SITE DETAILS**

**Site name:** South Hill Park, Bracknell, Berkshire

**Site code:** BRSOHP 08

**Grid reference:** SU 870 667

**Type of watching brief:** Hand excavation of 2 test pits and structural recording of a standing wall and water inlet.

**Date and duration of project:** 1st December 2008, one day on site

**Area of site:** c5,000 m<sup>2</sup>

**Summary of results:** The watching brief observed deposits and structures relating to the 19th and 20th-century construction of the college and the landscaping of the grounds. No other significant archaeology was encountered.

**Location of archive:** The archive is currently held at OA, Janus House, Osney Mead, Oxford, OX2 0ES, and will be deposited with Oxfordshire County Museums Service in due course, under the following accession number: OXCMS:2008.38

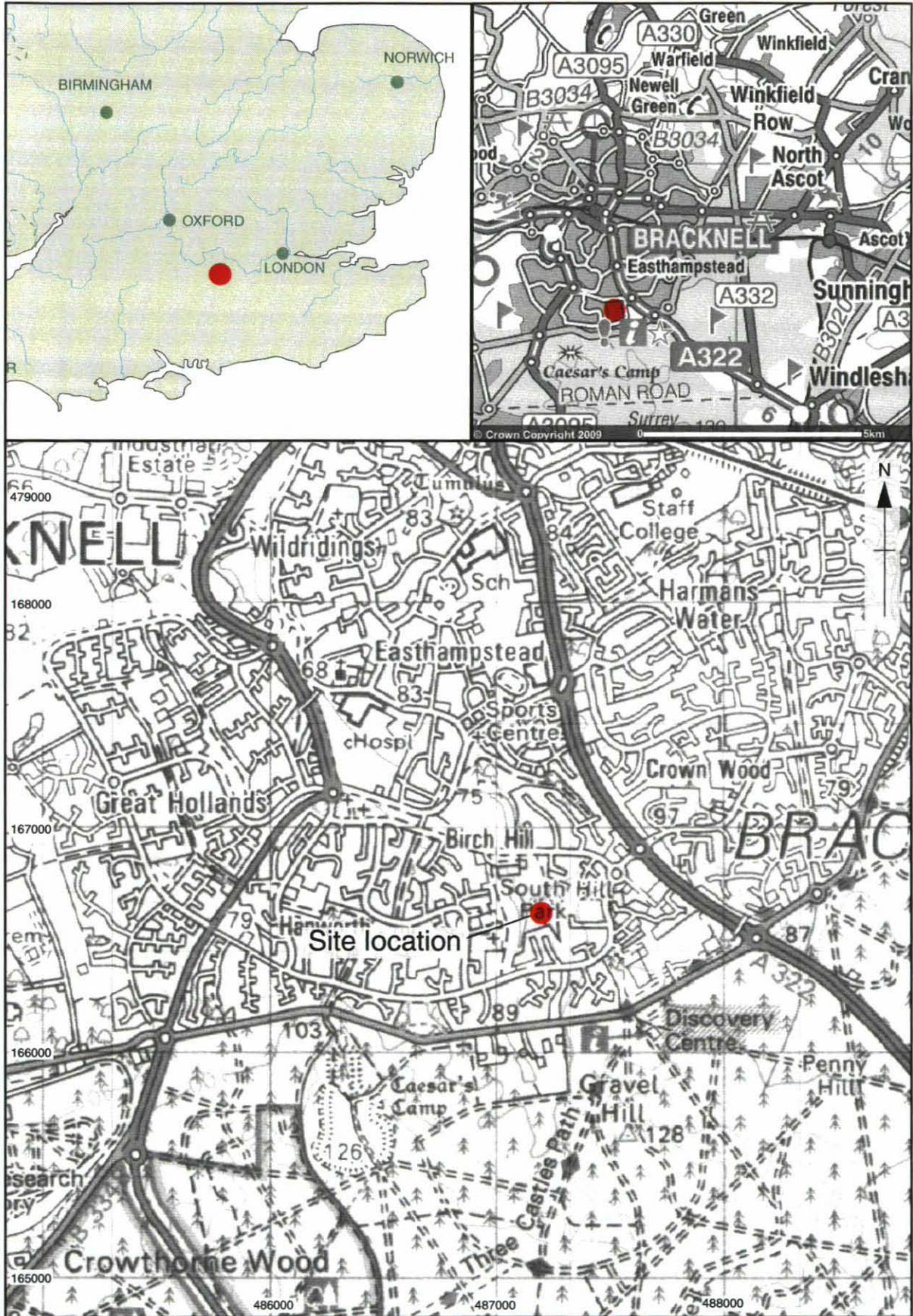

Reproduced from the Landranger 1:50,000 scale by permission of the Ordnance Survey on behalf of The Controller of Her Majesty's Stationery Office  
© Crown Copyright 1998. All rights reserved. Licence No. AL 100005569

Figure 1: Site location

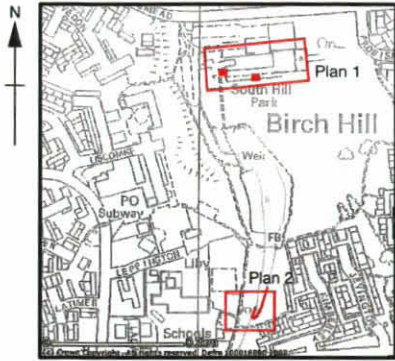

### Southern Terrace Ground Investigation Plan 1

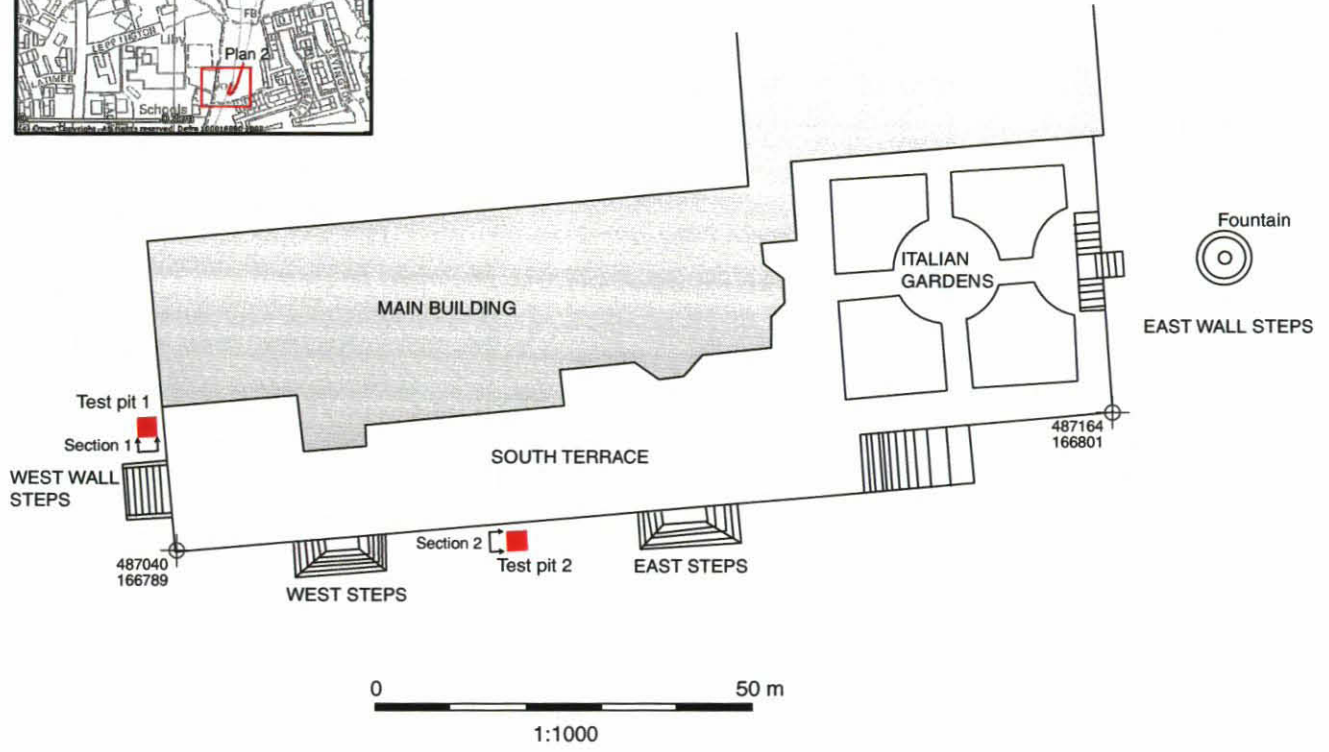

### Southern Lake Inlet Retaining Walls Plan 2

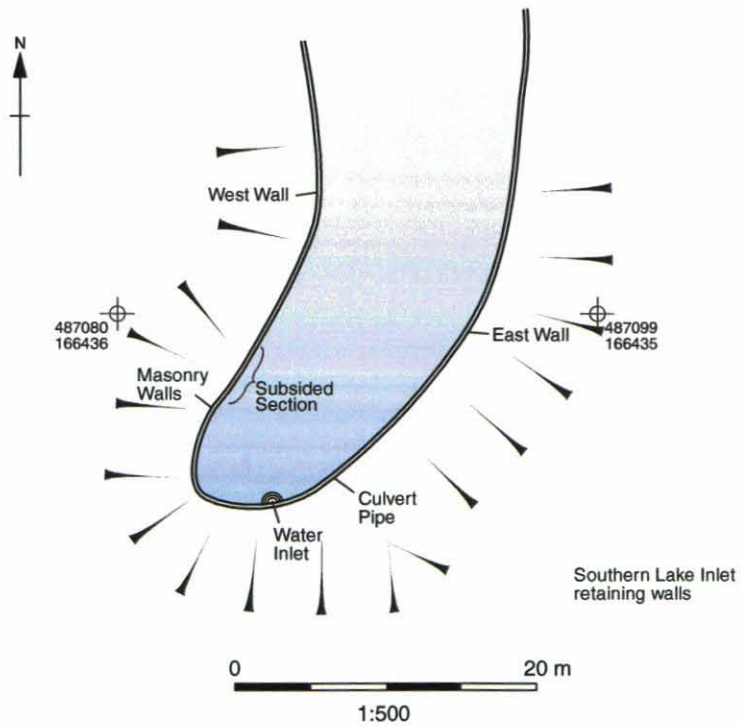
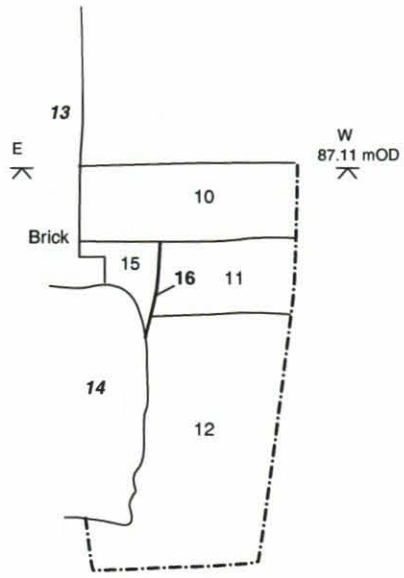

Figure 2 : Site plans

Test Pit 1  
Section 1



Test Pit 2  
Section 2

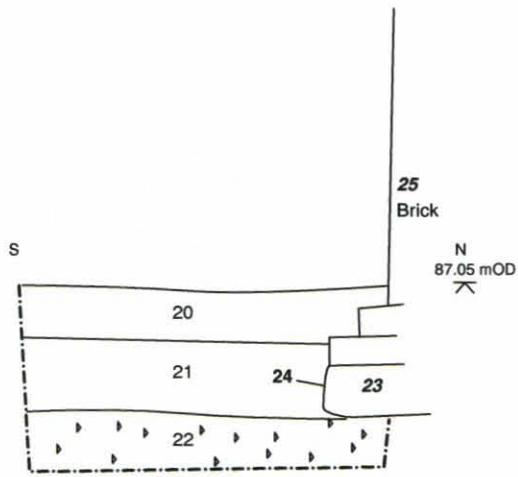

Figure 3 : Sections



Plate 1: Southern lake inlet and wall



Plate 2: West wall of Southern inlet, showing subsidence



**OA South**

Janus House  
Osney Mead  
Oxford OX2 0ES

t: +44 (0) 1865 263 800  
f: +44 (0) 1865 793 496  
e: [info@oxfordarch.co.uk](mailto:info@oxfordarch.co.uk)  
w: <http://thehumanjourney.net>

**OA North**

Mill 3  
Moor Lane Mills  
Moor Lane  
Lancaster LA1 1GF

t: +44 (0) 1524 541 000  
f: +44 (0) 1524 848 606  
e: [oanorth@thehumanjourney.net](mailto: oanorth@thehumanjourney.net)  
w: <http://thehumanjourney.net>

**OA East**

15 Trafalgar Way  
Bar Hill  
Cambridgeshire  
CB23 8SQ

t: +44 (0) 1223 850500  
f: +44 (0) 1223 850599  
e: [oaeast@thehumanjourney.net](mailto: oaeast@thehumanjourney.net)  
w: <http://thehumanjourney.net>

**OA Méditerranée**

115 Rue Merlot  
ZAC La Louvade  
34 130 Mauguio  
France

t: +33 (0) 4.67.57.86.92  
f: +33 (0) 4.67.42.65.93  
e: [oamed@thehumanjourney.net](mailto: oamed@thehumanjourney.net)  
w: <http://oamed.fr/>

**Director:** David Jennings, BA MIFA FSA



*The Oxford Archaeological Unit Ltd is a  
Private Limited Company, N<sup>o</sup>: 1618597  
and a Registered Charity, No: 285627  
Registered Office: Janus House,  
Osney Mead, Oxford, OX2 0ES*

# OASIS DATA COLLECTION FORM:

## England

[List of Projects](#) | [Search Projects](#) | [New project](#) | [Change your details](#) | [HER coverage](#) | [Change country](#) | [Log out](#)

**Printable version**

**OASIS ID: oxfordar1-57912**

### Project details

|  |  |
|--|--|
| Project name                           | Easthampstead Bracknell South Hill Farm  |
| Short description of the project       | On 1st December 2008, Oxford Archaeology (OA) carried out an archaeological watching brief during geotechnical test pitting at South Hill Park, Bracknell, Berkshire (NGR: SU 870 667). The work was commissioned by Chris Blandford Associates in advance of the proposed construction of a disabled access ramp. A photographic record of the southern lake inlet wall was also undertaken at the same time. The watching brief revealed details of the construction of the south terrace walls and deposits of made ground associated with landscaping of the grounds. No other significant archaeology was observed. |
| Project dates                          | Start: 01-12-2008 End: 02-12-2008  |
| Previous/future work                   | Not known / Not known  |
| Any associated project reference codes | BRSOHP 08 - Sitecode   |
| Any associated project reference codes | REDMG:2009.101 - Museum accession ID   |
| Type of project                        | Recording project  |
| Site status                            | None   |
| Current Land use                       | Other 2 - In use as a building   |
| Monument type                          | NONE None  |
| Significant Finds                      | NONE None  |
| Investigation type                     | 'Test-Pit Survey'  |
| Prompt                                 | Direction from Local Planning Authority - PPG16  |

### Project location

|                  |  |
|------------------|--|
| Country          | England  |
| Site location    | BERKSHIRE BRACKNELL FOREST BRACKNELL Easthampstead Bracknell South Hill Farm |
| Study area       | 5000.00 Square metres  |
| Site coordinates | SU 870 667 51.3921624446 -0.749434403612 51 23 31 N 000 44 57 W Point        |



**Project creators**

|                           |                             |
|---------------------------|-----------------------------|
| Name of Organisation      | Oxford Archaeology          |
| Project brief originator  | Chris Blandford Association |
| Project design originator | Mike Sims                   |
| Project director/manager  | D. Dodds                    |
| Project supervisor        | M. Simms                    |

**Project archives**

|                           |   |
|---------------------------|---|
| Physical Archive Exists?  | No  |
| Digital Archive recipient | Oxford Archaeology  |
| Digital Archive ID        | BRSOHP 08   |
| Digital Contents          | 'none'  |
| Digital Media available   | 'Images raster / digital photography'   |
| Paper Archive recipient   | Reading Museum  |
| Paper Archive ID          | REDMG:2009.101  |
| Paper Contents            | 'none'  |
| Paper Media available     | 'Context sheet', 'Diary', 'Drawing', 'Microfilm', 'Plan', 'Report', 'Section' |

**Project bibliography 1**

|                               |   |
|-------------------------------|---|
| Publication type              | Grey literature (unpublished document/manuscript)                         |
| Title                         | South Hill Park Bracknell Berkshire, Archaeological Watching Brief Report |
| Author(s)/Editor(s)           | OXFORD ARCHAEOLOGY  |
| Date                          | 2009  |
| Issuer or publisher           | OXFORD ARCHAEOLOGY  |
| Place of issue or publication | OXFORD  |
| Description                   | A4 Plastic bound copy   |
| Entered by                    | Wajdan Majeed (w.majeed@oxfordarch.co.uk)                                 |
| Entered on                    | 7 April 2009  |

# OASIS:

Please e-mail English Heritage for OASIS help and advice

© ADS 1996-2006 Created by Jo Gilham and Jen Mitcham, email Last modified Friday 3 February 2006

Cite only: /dl/export/home/web/oasis/form/print.cfm for this page

EASTHAMPSTEAD BRACKNELL  
SOUTH HILL FARM

BR50HP 08

Box 1 FILE 3

B. PRIMARY CONTEXT DATA

**SCAN PDF**

**FILMING INSTRUCTIONS**

Submitter OASouth

No. of CD copies: 2

Headings

Site information

Line 1: [OASouth] County:[Berkshire] Parish:[Easthampstead] Site:[Bracknell, South Hill Farm ]

Site code[BRSOHP08]

Line 2: Excavators name[D. Dodds]

Line 3:

Classification of material

Tick if present

|  |   |
|--|---|
| Index to archive                                   |   |
| Introduction                                       |   |
| A:Final Report                                     |   |
| A:Publication Report                               |   |
| B:Site Data – Text: Diary/Daybook/Fieldnotes       |   |
| B: Site Data – Text: General Summaries             |   |
| B: Site Data – Text: Primary Context Records       | ✓ |
| B: Site Data – Text: Synthesised Context Records   |   |
| B: Site Data – Text: Survey Reports                |   |
| B: Site Data – Text: Catalogue of Drawings         |   |
| B: Site Data – Text: Primary Drawings              |   |
| B: Site Data – Text: Synthesised Drawings          |   |
| C: Finds Data – Text: Primary Finds Data           |   |
| C: Finds Data – Text: Synthesised Finds Data       |   |
| C: Finds Data – Text: Specialist Reports           |   |
| C: Finds Data – Text: Box/Bag List                 |   |
| D: Catalogue of Photos/Slides/Videos/X--rays       |   |
| E: Environmental/Ecofact Data: Primary Records     |   |
| E: Environmental/Ecofact Data: Synthesised Records |   |
| E: Environmental/Ecofact Data: Specialist Reports  |   |
| F: Documentary                                     |   |
| F: Press and Publicity                             |   |
| G: Correspondence                                  |   |
| H: Miscellaneous                                   |   |



# WATCHING BRIEF RECORD

SITE CODE *BRS04P.08*

SITE NAME *South Hill Park Bracknell*

DATE *1/12/08*

NGR

County *Berk*

Start Time

Finish Time

Milage

Previous Visit

Visit By

Type of construction work

*Excavation of test pits, Building recording*

Contacts made

Archaeology present?

Yes:

*(18<sup>th</sup>/19<sup>th</sup> Building work.*

No:

Undated:

Other:

## COMMENTS

*On site to monitor excavation of 2 test pits against West and South Walls along South terrace.*

*Test Pit 1 Details of terrace wall construction landscaping, no earlier archaeology*

*Test Pit 2 Details of terrace wall. No earlier archaeology*

*Recording of walls at inlet of southern lake*

Records? *Plan section ext Photos.*





# CONTEXT RECORD

Context No.

10

SITE BRSON P 090

ADDITIONAL SHEETS:

TYPE Layer

Trench

Context Type: Deposit / Cut / Structure

Check Lists:

Site sub-div

Overlain by:

DEPOSIT:

Structure No.

Abutted by:

1. compaction 2. colour  
3. composition 4. inclusion  
5. thickness 6. extent  
7. comments 8. method & conditions

Plan No.

Cut by:

Filled by:

Section No.

10

Same as:

Part of:

CUT:

1. shape in plan  
2. base/sides/top profile  
3. dimension and depth  
4. sketch 5. truncation 6. fill nos 7. other comments

Co-Ordinates

Consists of:

Overlies: 11 : 15 : 16

Level

Butts:

MASONRY:

1. materials 2. size of bricks etc  
3. finish of stones 4. coursing/bond 5. form 6. faces  
7. bond 8. dimensions as found  
9. other comments

Slide No.

Cuts:

Neg No.

Fill of:

Matrix location

Relationships uncertain

Description (See check lists):

STRATIGRAPHIC MATRIX

- 1) Friable
- 2) Dark brown
- 3) Clay loam
- 4) Occ gravels
- 5) Depth 0.25m

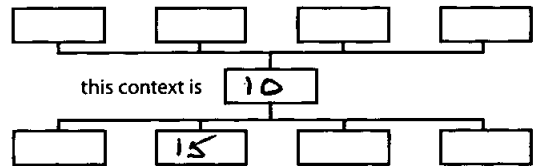

Interpretation/Discussion

Landscaping deposit, topsoil and turf  
Prob modern to origin

Finds (tick): None [ ] Pot [ ] Bone [ ] Flint [ ] Stone [ ] Burnt stone [ ] Glass  Metal [ ]  
CBM [ ] Wood [ ] Leather [ ]

 Small Finds
Recorder *MS*
 Samples

Date

 Building Materials

Initials



# CONTEXT RECORD

Context No.

11

SITE **BRSONP 08**

ADDITIONAL SHEETS:

TYPE *Layer*Trench **TPI**Context Type: Deposit / ~~Cut~~ / ~~Structure~~

Check Lists:

Site sub-div

Overlain by: **11:15**

DEPOSIT:

1. compaction
2. colour
3. composition
4. inclusion
5. thickness
6. extent
7. comments
8. method & conditions

Structure No.

Abutted by:

Plan No.

Cut by: **16**

Filled by:

Section No.

1

Same as:

Part of:

CUT:

1. shape in plan
2. base/sides/top profile
3. dimension and depth
4. sketch
5. truncation
6. fill nos
7. other comments

Co-Ordinates

Consists of:

Overlies: **12**

Level

Butts:

MASONRY:

1. materials
2. size of bricks etc
3. finish of stones
4. coursing/bond
5. form
6. faces
7. bond
8. dimensions as found
9. other comments

Slide No.

Cuts:

Neg No.

Fill of:

Matrix location

Relationships uncertain

Description (See check lists):

- 1) Tenacious
- 2) Grey-brown
- 3) Clay silt
- 4) Some gravels
- 5) Depth 0.25m

STRATIGRAPHIC MATRIX

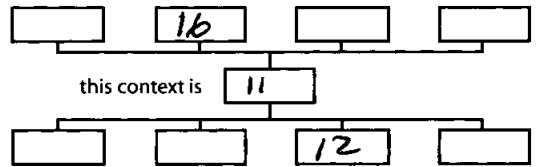

Interpretation/Discussion

*Probably Probable alluvial deposit.*

**Finds** (tick): None  Pot  Bone  Flint  Stone  Burnt stone  Glass  Metal   
 CBM  Wood  Leather

 Small FindsRecorder *[Signature]* Samples

Date

 Building Materials

Initials





# CONTEXT RECORD

Context No.

12

SITE *BR50HP 08*

ADDITIONAL SHEETS:

TYPE *Layer*

Trench

Context Type: Deposit / ~~Cut~~ / ~~Structure~~

Check Lists:

Site sub-div

Overlain by: *11*

DEPOSIT:

Structure No.

Abutted by:

1. compaction 2. colour  
3. composition 4. inclusion  
5. thickness 6. extent  
7. comments 8. method & conditions

Plan No.

Cut by: *16*

Filled by:

Section No.

*1*

Same as:

Part of:

CUT:

1. shape in plan  
2. base/sides/top profile  
3. dimension and depth  
4. sketch 5. truncation 6. fill nos 7. other comments

Co-Ordinates

Consists of:

Overlies:

Level

Butts:

MASONRY:

1. materials 2. size of bricks etc  
3. finish of stones 4. coursing/bond 5. form 6. faces  
7. bond 8. dimensions as found  
9. other comments

Slide No.

Cuts:

Neg No.

Fill of:

Matrix location

Relationships uncertain

Description (See check lists):

STRATIGRAPHIC MATRIX

- 1) *Terracotta*
- 2) *Orange brown*
- 3) *Silty clay*
- 4) *thin sub-angular gravel*
- 5) *Depth > 0.95m*

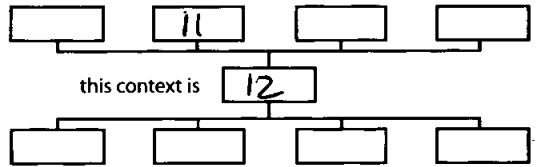

Interpretation/Discussion

*Natural terracotta gravel.*

Finds (tick): None  Pot  Bone  Flint  Stone  Burnt stone  Glass  Metal   
 CBM  Wood  Leather

 Small Finds Samples Building MaterialsRecorder *WJ*

Date

Initials



# CONTEXT RECORD

Context No.

13

SITE BRSONP 08

ADDITIONAL SHEETS:

TYPE Wall

Trench TP1

Context Type: Deposit / Cut / Structure

Check Lists:

Site sub-div

Overlain by: 10:15

DEPOSIT:

Structure No.

Abutted by:

1. compaction 2. colour  
3. composition 4. inclusion  
5. thickness 6. extent  
7. comments 8. method & conditions

Plan No.

Cut by:

Filled by:

Section No. 1

Same as:

Part of:

CUT:

Co-Ordinates

Consists of:

Overlies:

1. shape in plan  
2. base/sides/top profile  
3. dimension and depth  
4. sketch 5. truncation 6. fill nos  
7. other comments

Level

Butts: 14

MASONRY:

Slide No.

Cuts:

1. materials 2. size of bricks etc  
3. finish of stones 4. coursing/bond  
5. form 6. faces 7. bond 8. dimensions as found  
9. other comments

Neg No.

Fill of: 16

Matrix location

Relationships uncertain

Description (See check lists):

1) Red hand moulded brick

2) 0.228m x 0.105m x 0.065m

4) English stretcher bond

5) Vertical wall

7) Lime mortar

8) Approx 1.8m high, 0.5m thick.

STRATIGRAPHIC MATRIX

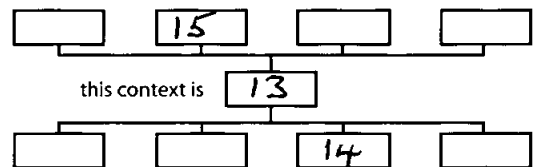

Interpretation/Discussion

West wall of southern terrace.

Finds (tick): None  Pot  Bone  Flint  Stone  Burnt stone  Glass  Metal   
 CBM  Wood  Leather

 Small Finds

Recorder

 Samples

Date

 Building Materials

Initials



# CONTEXT RECORD

Context No.  
**14**

SITE **BRSONP 08**

ADDITIONAL SHEETS:

TYPE **Structure**

Trench **TP1**

Context Type: **Deposit / Cut / Structure**

Check Lists:

Site sub-div

Overlain by: **15**

DEPOSIT:

Structure No.

Abutted by: **10: 1413**

- 1. compaction 2. colour
- 3. composition 4. inclusion
- 5. thickness 6. extent
- 7. comments 8. method & conditions

Plan No.

Cut by:

Filled by:

Section No.  
**10**

Same as:

Part of:

CUT:

- 1. shape in plan
- 2. base/sides/top profile
- 3. dimension and depth
- 4. sketch 5. truncation 6. fill no
- 7. other comments

Co-Ordinates

Consists of:

Overlies:

Level

Butts:

MASONRY:

Slide No.

Cuts:

- 1. materials 2. size of bricks etc
- 3. finish of stones 4. coursing/bond
- 5. form 6. faces 7. bond 8. dimensions as found
- 9. other comments

Neg No.

Fill of: **16**

Matrix location

Relationships uncertain

Description (See check lists):

STRATIGRAPHIC MATRIX

- 1) Sandstone
- 3) As quarried
- 4) N/A
- 5) Mass block of material filling trench
- 7) Lime mortar
- 8) 0.75m thick.

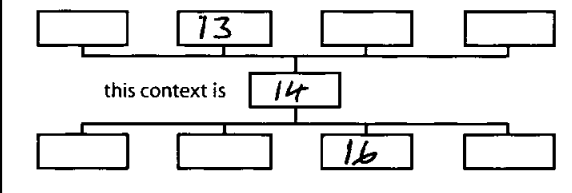

Interpretation/Discussion

Mass concrete (sandstone fragments in lime cement matrix) foundations for west wall of terrace.

Finds (tick): None  Pot  Bone  Flint  Stone  Burnt stone  Glass  Metal  CBM  Wood  Leather

Small Finds

Recorder *[Signature]*

Samples

Date

Building Materials

Initials



# CONTEXT RECORD

Context No.

15

SITE BRSONP 00

ADDITIONAL SHEETS:

TYPE *Fill*Trench *Test P4 1*

Context Type: Deposit / Cut / Structure

Check Lists:

Site sub-div

Overlain by: *10*

DEPOSIT:

1. compaction
2. colour
3. composition
4. inclusion
5. thickness
6. extent
7. comments
8. method & conditions

Structure No.

Abutted by:

Plan No.

Cut by:

Filled by:

Section No.

*1*

Same as:

Part of:

CUT:

1. shape in plan
2. base/sides/top profile
3. dimension and depth
4. sketch
5. truncation
6. fill nos
7. other comments

Co-Ordinates

Consists of:

Overlies: *13: 14*

Level

Butts:

MASONRY:

1. materials
2. size of bricks etc
3. finish of stones
4. coursing/bond
5. form
6. faces
7. bond
8. dimensions as found
9. other comments

Slide No.

Cuts:

Neg No.

Fill of: *16*

Matrix location

Relationships uncertain

Description (See check lists):

STRATIGRAPHIC MATRIX

- 1) Friable
- 2) Dark grey
- 3) clay silt loam
- 4) some gravels
- 5) Depth 0.25m
- 6) Fill top of construction cut *[16]*

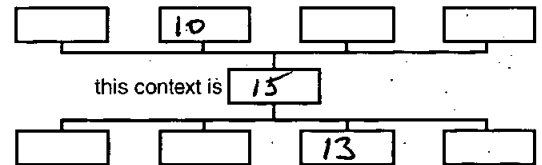

Interpretation/Discussion:

*Backfill of [16] after construction of [13] and [14]*

Finds (tick): None  Pot  Bone  Flint  Stone  Burnt stone  Glass   
 Metal  CBM  Wood  Leather

 Small Finds
Recorder *[Signature]*
 Samples

Date

 Building Materials

Initials



# CONTEXT RECORD

Context No.

16

SITE BR SOPH 08

ADDITIONAL SHEETS:

TYPE CA

Trench Test Pit 1

Context Type: Deposit / Cut / Structure

Check Lists:

Site sub-div

Overlain by: 10

DEPOSIT:

1. compaction
2. colour
3. composition
4. inclusion
5. thickness
6. extent
7. comments
8. method & conditions

Structure No.

Abutted by:

Plan No.

Cut by:

Filled by: 13; 14; 15

Section No.

Same as:

CUT:

1. shape in plan
2. base/sides/top profile
3. dimension and depth
4. sketch
5. truncation
6. fill nos
7. other comments

Co-Ordinates

Consists of:

Overlies:

Level

Butts:

MASONRY:

1. materials
2. size of bricks etc
3. finish of stones
4. coursing/bond
5. form
6. faces
7. bond
8. dimensions as found
9. other comments

Slide No.

Cuts: 11; 12

Neg No.

Fill of:

Matrix location

Relationships uncertain

Description (See check lists):

- 1) Straight edged linear
- 2) Vertical sides, flat base
- 3) 0.95m deep width 0.9m?

STRATIGRAPHIC MATRIX

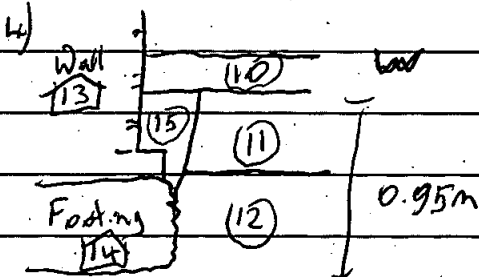
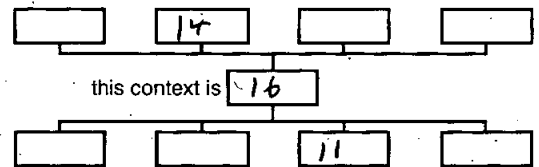

5) N/A

6) Filled by 13, 14 &amp; 15

Interpretation/Discussion:

Construction cut for west wall of southern terrace.

Finds (tick): None  Pot  Bone  Flint  Stone  Burnt stone  Glass   
 Metal  CBM  Wood  Leather

△ Small Finds

Recorder *PLG*

◇ Samples

Date

⬆ Building Materials

Initials



# CONTEXT RECORD

Context No.

20

SITE BR50HP 08

ADDITIONAL SHEETS:

TYPE Layer

Trench Test Pit 2

Context Type: Deposit / Cut / Structure

Check Lists:

Site sub-div

Overlain by:

DEPOSIT:

1. compaction
2. colour
3. composition
4. inclusion
5. thickness
6. extent
7. comments
8. method & conditions

Structure No.

Abutted by:

Plan No.

Cut by:

Filled by:

Section No.

2

Same as:

Part of:

CUT:

1. shape in plan
2. base/sides/top profile
3. dimension and depth
4. sketch
5. truncation
6. fill nos
7. other comments

Co-Ordinates

Consists of:

Overlies: 24 : 25 : 21

Level

Butts:

MASONRY:

1. materials
2. size of bricks etc
3. finish of stones
4. coursing/bond
5. form
6. faces
7. bond
8. dimensions as found
9. other comments

Slide No.

Cuts:

Neg No.

Fill of:

Matrix location

Relationships uncertain

Description (See check lists):

- 1) Friable
- 2) Dark brown
- 3) Clay silty loam
- 4) Some gravels
- 5) Depth 0.15m

STRATIGRAPHIC MATRIX

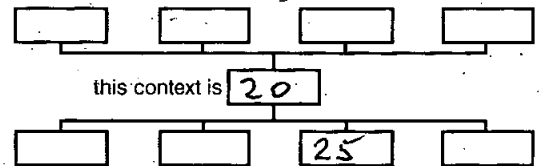

Interpretation/Discussion:

Landscaping deposit of topsoil and turf  
modern deposit.

Finds (tick): None  Pot  Bone  Flint  Stone  Burnt stone  Glass   
 Metal  CBM  Wood  Leather  Plastic

 Small Finds
Recorder *[Signature]*
 Samples

Date

 Building Materials

Initials



# CONTEXT RECORD

Context No.

21

SITE *BRS OHP008*

ADDITIONAL SHEETS:

TYPE *Layer*Trench *TP 2*Context Type: Deposit / ~~Cut~~ / Structure

Check Lists:

Site sub-div

Overlain by: *20*

DEPOSIT:

1. compaction
2. colour
3. composition
4. inclusion
5. thickness
6. extent
7. comments
8. method & conditions

Structure No.

Abutted by:

Plan No.

Cut by: *24*

Filled by:

Section No.

*2*

Same as:

Part of:

CUT:

1. shape in plan
2. base/sides/top profile
3. dimension and depth
4. sketch
5. truncation
6. fill nos
7. other comments

Co-Ordinates

Consists of:

Overlies: *22*

Level

Butts:

MASONRY:

1. materials
2. size of bricks etc
3. finish of stones
4. coursing/bond
5. form
6. faces
7. bond
8. dimensions as found
9. other comments

Slide No.

Cuts:

Neg No.

Fill of:

Matrix location

Relationships uncertain

Description (See check lists):

STRATIGRAPHIC MATRIX

- 1) *Tenaxos*
- 2) *Grey brown*
- 3) *silt clay*
- 4) *Some gravel*
- 5) *Depth 0.25m*

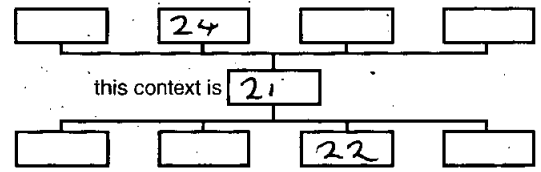

Interpretation/Discussion:

*Alluvial deposit*

Finds (tick): None  Pot  Bone  Flint  Stone  Burnt stone  Glass   
 Metal  CBM  Wood  Leather

 Small Finds
Recorder *[Signature]*
 Samples

Date

 Building Materials

Initials



# CONTEXT RECORD

Context No.

22

SITE BRSONP08

ADDITIONAL SHEETS:

TYPE *Lagerjo*Trench *Test Pit 2*

Context Type: Deposit / Cut / Structure

Check Lists:

Site sub-div

Overlain by: *AD 21*

DEPOSIT:

1. compaction
2. colour
3. composition
4. inclusion
5. thickness
6. extent
7. comments
8. method & conditions

Structure No.

Abutted by:

Plan No.

Cut by: *24*

Filled by:

Section No. *2*

Same as:

CUT:

1. shape in plan
2. base/sides/top profile
3. dimension and depth
4. sketch
5. truncation
6. fill nos
7. other comments

Co-Ordinates

Consists of:

Overlies: *23*

Level

Butts:

MASONRY:

1. materials
2. size of bricks etc
3. finish of stones
4. coursing/bond
5. form
6. faces
7. bond
8. dimensions as found
9. other comments

Slide No.

Cuts:

Neg No.

Fill of:

Matrix location

Relationships uncertain

Description (See check lists):

STRATIGRAPHIC MATRIX

- 1) *Teracots*
- 2) *Yellow - brown*
- 3) *silt sandy clay*
- 4) *many pebbles.*
- 5) *Depth > 0.15m*

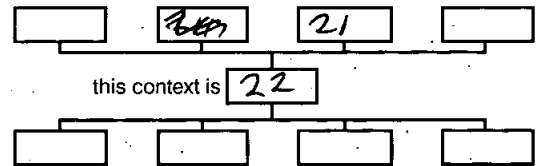

Interpretation/Discussion:

*Normal / Alluvial? deposit.*

Finds (tick): None  Pot  Bone  Flint  Stone  Burnt stone  Glass   
 Metal  CBM  Wood  Leather

 Small FindsRecorder *[Signature]* Samples

Date

 Building Materials

Initials





# CONTEXT RECORD

Context No.

23

SITE *BRSONP 08*

ADDITIONAL SHEETS:

TYPE *Structure*Trench *TP2*

Context Type: Deposit / Cut / Structure

Check Lists:

Site sub-div

Overlain by: *22*

DEPOSIT:

1. compaction
2. colour
3. composition
4. inclusion
5. thickness
6. extent
7. comments
8. method & conditions

Structure No.

Abutted by: *25*

Plan No.

Cut by:

Filled by:

Section No.

*2*

Same as:

Part of:

CUT:

1. shape in plan
2. base/sides/top profile
3. dimension and depth
4. sketch
5. truncation
6. fill nos
7. other comments

Co-Ordinates

Consists of:

Overlies:

Level

Butts:

MASONRY:

1. materials
2. size of bricks etc
3. finish of stones
4. coursing/bond
5. form
6. faces
7. bond
8. dimensions as found
9. other comments

Slide No.

Cuts:

Neg No.

Fill of: *24*

Matrix location

Relationships uncertain

Description (See check lists):

STRATIGRAPHIC MATRIX

- 1) Pebbles, CBM fragments
- 5) Rectangular mass
- 7) Lime mortar
- 8) 0.15m deep

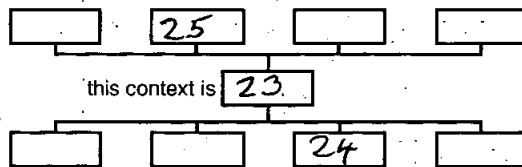

Interpretation/Discussion:

*Mass concrete foundations for south wall of terrace.*

Finds (tick): None  Pot  Bone  Flint  Stone  Burnt stone  Glass   
 Metal  CBM  Wood  Leather

 Small Finds
Recorder *APY*
 Samples

Date

 Building Materials

Initials



# CONTEXT RECORD

Context No.

24.

SITE BR50HP08

ADDITIONAL SHEETS:

TYPE CA

Trench

Context Type: Deposit / Cut / Structure

Check Lists:

Site sub-div

Overlain by: 20

DEPOSIT:

1. compaction
2. colour
3. composition
4. inclusion
5. thickness
6. extent
7. comments
8. method & conditions

Structure No.

Abutted by:

Plan No.

Cut by:

Filled by: 25, 23

Section No.

Same as:

Part of:

CUT:

1. shape in plan
2. base/sides/top profile
3. dimension and depth
4. sketch
5. truncation
6. fill nos
7. other comments

Co-Ordinates

Consists of:

Overlies:

Level

Butts:

MASONRY:

1. materials
2. size of bricks etc
3. finish of stones
4. coursing/bond
5. form
6. faces
7. bond
8. dimensions as found
9. other comments

Slide No.

Cuts: 21

Neg No.

Fill of:

Matrix location

Relationships uncertain

Description (See check lists):

- 1) Straight edged linear
- 2) Vertical sides, flat base
- 3) 0.3m deep width > 0.8m
- 4)

STRATIGRAPHIC MATRIX

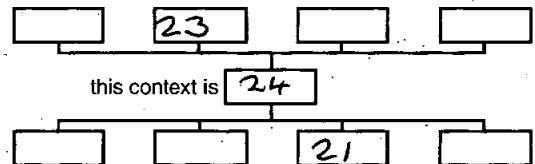

- 5) Nil
- 6) Filled by 23 and 25

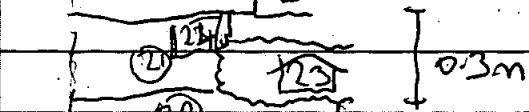

Interpretation/Discussion:

Construction cut for south wall of southern terrace.

Finds (tick): None  Pot  Bone  Flint  Stone  Burnt stone  Glass   
 Metal  CBM  Wood  Leather

 Small Finds
Recorder *MC*
 Samples

Date

 Building Materials

Initials



# CONTEXT RECORD

Context No.

25

SITE BRSOHP 08

ADDITIONAL SHEETS:

TYPE Wall

Trench Test Pit 2

Context Type: Deposit / Cut / Structure

Check Lists:

Site sub-div

Overlain by: 20

DEPOSIT:

1. compaction
2. colour
3. composition
4. inclusion
5. thickness
6. extent
7. comments
8. method & conditions

Structure No.

Abuted by:

Plan No.

Cut by:

Filled by:

CUT:

1. shape in plan
2. base/sides/top profile
3. dimension and depth
4. sketch
5. truncation
6. fill nos
7. other comments

Section No. 2

Same as:

Part of:

Co-Ordinates

Consists of:

Overlies: 23

Level

Butts:

MASONRY:

1. materials
2. size of bricks etc
3. finish of stones
4. coursing/bond
5. form
6. faces
7. bond
8. dimensions as found
9. other comments

Slide No.

Cuts:

Neg No.

Fill of: 24

Matrix location

Relationships uncertain

Description (See check lists):

STRATIGRAPHIC MATRIX

- 1) Red hand moulded brick
- 2) 0.228m x 0.105m x 0.065m
- 4) English stretcher bond
- 5) Vertical wall
- 7) Lime mortar
- 8) Height: > 1.5m

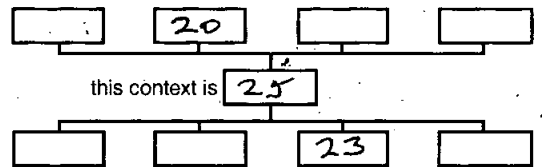

Interpretation/Discussion:

South wall of southern terrace.

Finds (tick): None  Pot  Bone  Flint  Stone  Burnt stone  Glass   
 Metal  CBM  Wood  Leather

Small Finds

Recorder MM

Samples

Date

Building Materials

Initials

EASTHAMPSTEAD BRACKNELL  
SOUTH HILL FARM  
BR50HP08

Box 1 FILE 4

B. CATALOGUE OF DRAWINGS

SCAN PDF

FILMING INSTRUCTIONS

Submitter OASouth

No. of CD copies: 2

Headings

Site information

Line 1: [OASouth] County:[Berkshire] Parish:[Easthampstead] Site:[Bracknell, South Hill Farm ]

Site code[BRSOHP08]

Line 2: Excavators name[D. Dodds]

Line 3:

Classification of material

Tick if present

|  |   |
|--|---|
| Index to archive                                   |   |
| Introduction                                       |   |
| A:Final Report                                     |   |
| A:Publication Report                               |   |
| B:Site Data – Text: Diary/Daybook/Fieldnotes       |   |
| B: Site Data – Text: General Summaries             |   |
| B: Site Data – Text: Primary Context Records       |   |
| B: Site Data – Text: Synthesised Context Records   |   |
| B: Site Data – Text: Survey Reports                |   |
| B: Site Data – Text: Catalogue of Drawings         | ✓ |
| B: Site Data – Text: Primary Drawings              |   |
| B: Site Data – Text: Synthesised Drawings          |   |
| C: Finds Data – Text: Primary Finds Data           |   |
| C: Finds Data – Text: Synthesised Finds Data       |   |
| C: Finds Data – Text: Specialist Reports           |   |
| C: Finds Data – Text: Box/Bag List                 |   |
| D: Catalogue of Photos/Slides/Videos/X--rays       |   |
| E: Environmental/Ecofact Data: Primary Records     |   |
| E: Environmental/Ecofact Data: Synthesised Records |   |
| E: Environmental/Ecofact Data: Specialist Reports  |   |
| F: Documentary                                     |   |
| F: Press and Publicity                             |   |
| G: Correspondence                                  |   |
| H: Miscellaneous                                   |   |



# SECTION RECORD SHEET

SITE CODE *BR501708*

SITE NAME *South Hill Park, Bracknell*

Section number

Context(s)

Scale

Drawn by

Size (A1, A4, etc.)

Plan (Sheet no.)

~~1~~ 1

*10:11:12:13:14:15:16*

*1:20*

*WJ*

*A4*

*A-*

~~2~~ 2

*20:21:22:23:24:25*

*1:20*

*WJ*

*A4*

*A-*

EASTHAMPSTEAD BRACKNELL  
SOUTH HILL FARM

BRSOHP 08

Box 1 FILES

B. PRIMARY DRAWINGS

**SCAN PDF**

**FILMING INSTRUCTIONS**

Submitter OASouth

No. of CD copies: 2

Headings

Site information

Line 1: [OASouth] County:[Berkshire] Parish:[Easthampstead] Site:[Bracknell, South Hill Farm ]

Site code[BRSOHP08]

Line 2: Excavators name[D. Dodds]

Line 3:

Classification of material

Tick if present

|  |   |
|--|---|
| Index to archive                                   |   |
| Introduction                                       |   |
| A:Final Report                                     |   |
| A:Publication Report                               |   |
| B:Site Data – Text: Diary/Daybook/Fieldnotes       |   |
| B: Site Data – Text: General Summaries             |   |
| B: Site Data – Text: Primary Context Records       |   |
| B: Site Data – Text: Synthesised Context Records   |   |
| B: Site Data – Text: Survey Reports                |   |
| B: Site Data – Text: Catalogue of Drawings         |   |
| B: Site Data – Text: Primary Drawings              | ✓ |
| B: Site Data – Text: Synthesised Drawings          |   |
| C: Finds Data – Text: Primary Finds Data           |   |
| C: Finds Data – Text: Synthesised Finds Data       |   |
| C: Finds Data – Text: Specialist Reports           |   |
| C: Finds Data – Text: Box/Bag List                 |   |
| D: Catalogue of Photos/Slides/Videos/X--rays       |   |
| E: Environmental/Ecofact Data: Primary Records     |   |
| E: Environmental/Ecofact Data: Synthesised Records |   |
| E: Environmental/Ecofact Data: Specialist Reports  |   |
| F: Documentary                                     |   |
| F: Press and Publicity                             |   |
| G: Correspondence                                  |   |
| H: Miscellaneous                                   |   |



Old Timber Yard House, 55 The Timber Yard  
Drysedale Street, London N1 6ND  
Tel: 020 7324 7270 Fax: 020 7729 1196  
email: london@themortonpartnership.co.uk  
www.themortonpartnership.co.uk

Leonardo House, 11 Market Place, Halesworth, Suffolk. IP19 8BA  
Tel: 01986 875651 Fax: 01986 875085  
email: halesworth@themortonpartnership.co.uk  
www.themortonpartnership.co.uk

8 Church Street, Coggeshall, Essex. CO6 1TU  
Tel: 01376 563883 Fax: 01376 563894  
email: coggeshall@themortonpartnership.co.uk  
www.themortonpartnership.co.uk



THE MORTON PARTNERSHIP LTD.  
CONSULTING CIVIL & STRUCTURAL ENGINEERS,  
HISTORIC BUILDING SPECIALISTS  
Registered in England No.2727193

JOB TITLE SOUTH HILL PARK - BRACKNELL

JOB No. 11478 DATE SEPT 2008

# FILE NOTE

## ART CENTRE TERRACE AND ITALIAN GARDENS

### - GENERAL LAYOUT AND INVESTIGATIONS

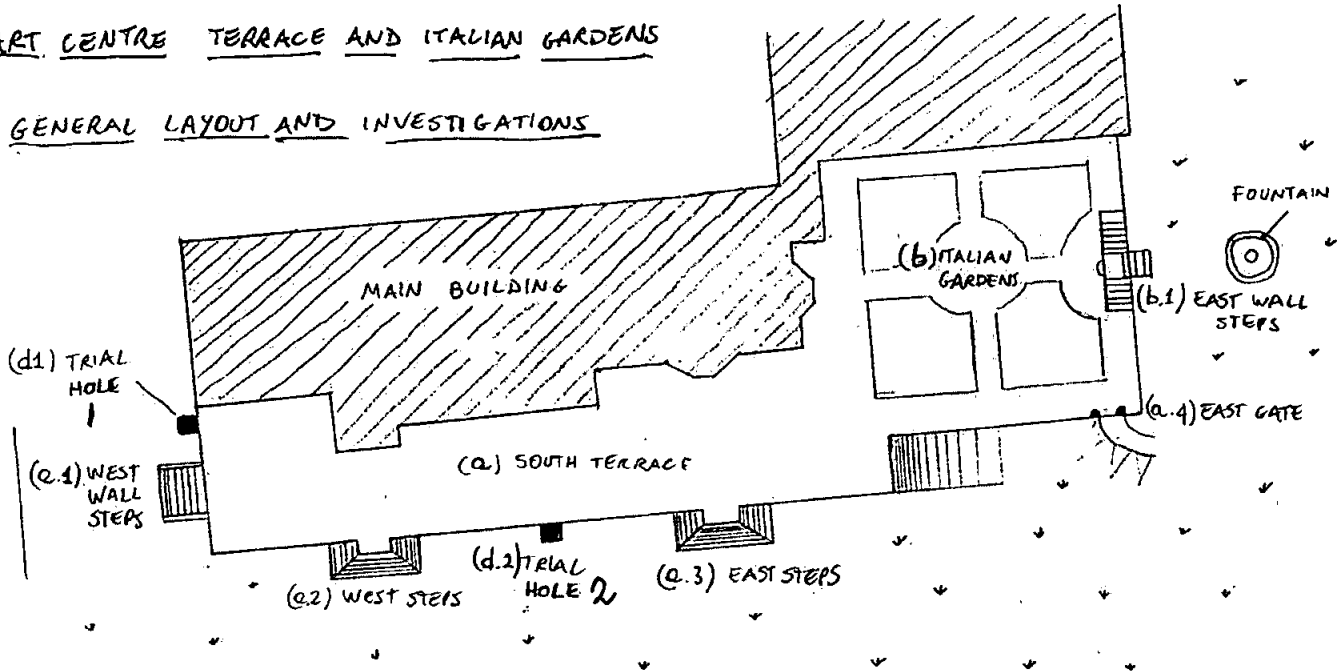

## SOUTHERN LAKE INLET

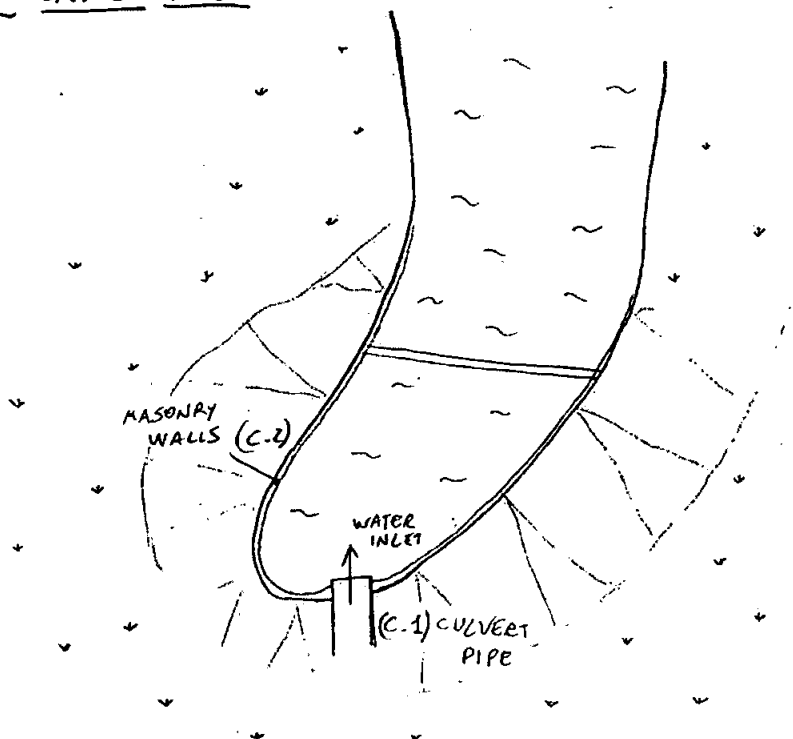

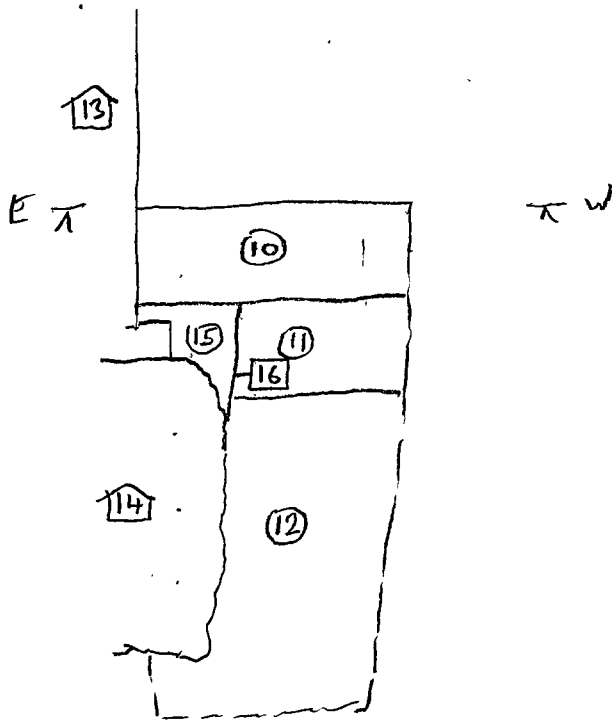

BRS OHP 00  
 Test P. 1  
 Section 1  
 Scale 1:20

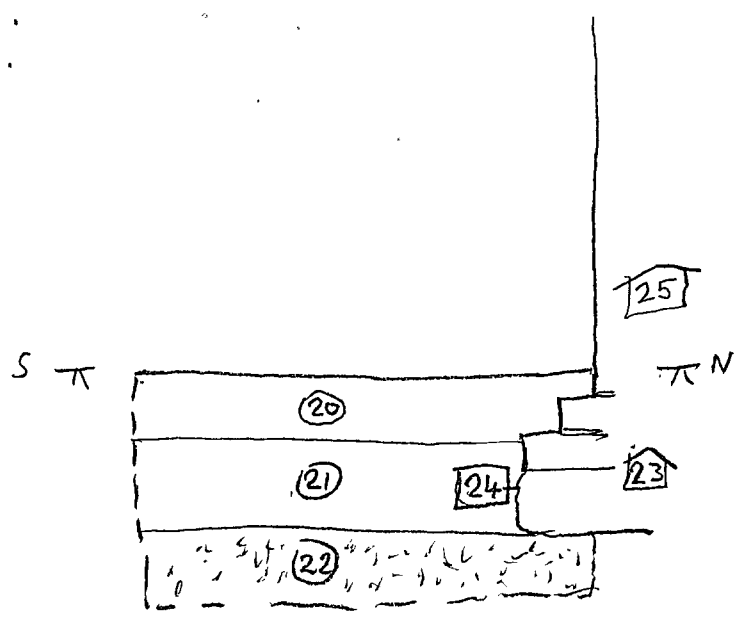

BRS OHP 00  
 Test P. 2  
 Section 2  
 Scale 1:20

EASTHAMSTEAD BRACKNELL  
SOUTH HILL FARM

BR50HP 08

Box 1 FILE 8.

D. CATALOGUE OF PHOTOGRAPHS

SCAN PDF

FILMING INSTRUCTIONS

Submitter OASouth

No. of CD copies: 2

Headings

Site information

Line 1: [OASouth] County:[Berkshire] Parish:[Easthampstead] Site:[Bracknell, South Hill Farm ]

Site code[BRSOHP08]

Line 2: Excavators name[D. Dodds]

Line 3:

Classification of material

Tick if present

|  |                                     |
|--|-------------------------------------|
| Index to archive                                   |                                     |
| Introduction                                       |                                     |
| A:Final Report                                     |                                     |
| A:Publication Report                               |                                     |
| B:Site Data – Text: Diary/Daybook/Fieldnotes       |                                     |
| B: Site Data – Text: General Summaries             |                                     |
| B: Site Data – Text: Primary Context Records       |                                     |
| B: Site Data – Text: Synthesised Context Records   |                                     |
| B: Site Data – Text: Survey Reports                |                                     |
| B: Site Data – Text: Catalogue of Drawings         |                                     |
| B: Site Data – Text: Primary Drawings              |                                     |
| B: Site Data – Text: Synthesised Drawings          |                                     |
| C: Finds Data – Text: Primary Finds Data           |                                     |
| C: Finds Data – Text: Synthesised Finds Data       |                                     |
| C: Finds Data – Text: Specialist Reports           |                                     |
| C: Finds Data – Text: Box/Bag List                 |                                     |
| D: Catalogue of Photos/Slides/Videos/X--rays       | <input checked="" type="checkbox"/> |
| E: Environmental/Ecofact Data: Primary Records     |                                     |
| E: Environmental/Ecofact Data: Synthesised Records |                                     |
| E: Environmental/Ecofact Data: Specialist Reports  |                                     |
| F: Documentary                                     |                                     |
| F: Press and Publicity                             |                                     |
| G: Correspondence                                  |                                     |
| H: Miscellaneous                                   |                                     |



# PHOTOGRAPHIC RECORD SHEET

SITE CODE **BRSOHP 08**

SITE NAME **South Park, Bracknell**

FILM NO. **1**

Camera number

Lens number

Black & white / ~~colour~~

| Date | Negative number | View      | Context(s)                         | Initials |
|------|-----------------|-----------|------------------------------------|----------|
|      | 0               |           |                                    |          |
|      | 1               |           | <b>BRSOHP 08 I.D. SHOT</b>         |          |
|      | 2               | <b>E</b>  | <b>Test P.41, Section 1</b>        |          |
|      | 3               | <b>E</b>  | " " "                              |          |
|      | 4               | <b>E</b>  | " " "                              |          |
|      | 5               | <b>W</b>  | <b>Test P.42, Section 2</b>        |          |
|      | 6               | <b>W</b>  | " " "                              |          |
|      | 7               | <b>W</b>  | " " "                              |          |
|      | 8               | <b>NW</b> | <b>Inlet of south lake</b>         |          |
|      | 9               | <b>NW</b> | " " "                              |          |
|      | 10              | <b>NW</b> | " " "                              |          |
|      | 11              | <b>W</b>  | <b>West wall, south lake inlet</b> |          |
|      | 12              | <b>W</b>  | " " "                              |          |
|      | 13              | <b>W</b>  | " " "                              |          |
|      | 14              | <b>E</b>  | <b>East wall, south lake inlet</b> |          |
|      | 15              | <b>E</b>  | " " "                              |          |
|      | 16              | <b>E</b>  | " " "                              |          |
|      | 17              | <b>SE</b> | <b>East wall, south lake inlet</b> |          |
|      | 18              | <b>SE</b> | " " "                              |          |
|      | 19              | <b>SE</b> | " " "                              |          |
|      | 20              |           |                                    |          |
|      | 21              |           |                                    |          |
|      | 22              |           |                                    |          |
|      | 23              |           |                                    |          |
|      | 24              |           |                                    |          |
|      | 25              |           |                                    |          |
|      | 26              |           |                                    |          |
|      | 27              |           |                                    |          |
|      | 28              |           |                                    |          |
|      | 29              |           |                                    |          |
|      | 30              |           |                                    |          |
|      | 31              |           |                                    |          |
|      | 32              |           |                                    |          |
|      | 33              |           |                                    |          |
|      | 34              |           |                                    |          |
|      | 35              |           |                                    |          |
|      | 36              |           |                                    |          |
|      | 37              |           |                                    |          |



# PHOTOGRAPHIC RECORD SHEET

SITE CODE **BR50MP 08**

SITE NAME **South Hill Park Bracknell**

FILM NO. **1**

Camera number

Lens number

Black & white / colour

| Date | Negative number | View | Context(s)             | Initials |
|------|-----------------|------|------------------------|----------|
|      | 0               |      |                        |          |
|      | 1               |      | BR50MP 08 I.D. shot.   |          |
|      | 2               | E    | Test Pit 1, Section 1  |          |
|      | 3               | E    | " " " " "              |          |
|      | 4               | E    | " " " " "              |          |
|      | 5               | W    | Test Pit 2, Section 2  |          |
|      | 6               | W    | " " " " "              |          |
|      | 7               | W    | " " " " "              |          |
|      | 8               | NW   | Inlet Pipe, South lake |          |
|      | 9               | NW   | " " " " "              |          |
|      | 10              | NW   | " " " " "              |          |
|      | 11              | W    | West wall, south lake  |          |
|      | 12              | W    | " " " " "              |          |
|      | 13              | W    | " " " " "              |          |
|      | 14              | E    | East wall south lake   |          |
|      | 15              | E    | " " " " "              |          |
|      | 16              | E    | " " " " "              |          |
|      | 17              | SE   | " " " " "              |          |
|      | 18              | SE   | " " " " "              |          |
|      | 19              | SE   | " " " " "              |          |
|      | 20              |      |                        |          |
|      | 21              |      |                        |          |
|      | 22              |      |                        |          |
|      | 23              |      |                        |          |
|      | 24              |      |                        |          |
|      | 25              |      |                        |          |
|      | 26              |      |                        |          |
|      | 27              |      |                        |          |
|      | 28              |      |                        |          |
|      | 29              |      |                        |          |
|      | 30              |      |                        |          |
|      | 31              |      |                        |          |
|      | 32              |      |                        |          |
|      | 33              |      |                        |          |
|      | 34              |      |                        |          |
|      | 35              |      |                        |          |
|      | 36              |      |                        |          |
|      | 37              |      |                        |          |

