



Land off Blidworth Lane Rainworth, Nottinghamshire

Archaeological Evaluation Report

January 2022

**Client: RPS Group/Barratt & David Wilson
Homes North Midlands**

Issue No: V1
OA Reference No: 8028
NGR: SK 579 586



Client Name: RPS group/Barratt & David Wilson Homes North Midlands
Document Title: Land off Blidworth Lane, Rainworth, Nottinghamshire
Document Type: Evaluation Report
Grid Reference: SK 579 586
Planning Reference: 2020/0182/OUT
Site Code: RABL21
Invoice Code: RABLEV
Receiving Body: National Civil War Centre - Newark Museum
Accession No.: TBC
OA Document File Location: X:\n\Nottinghamshire_Blidworth_Lane_Rainworth_EV\Report
OA Graphics File Location: X:\n\Nottinghamshire_Blidworth_Lane_Rainworth_EV\Report
Issue No: V1
Date: 17/01/22
Prepared by: Katherine Webster (Site Supervisor)
Checked by: Carl Champness (Senior Project Manager)
Edited by: Andrew Simmonds (Senior Project Manager)
Approved for Issue by: David Score (Head of Fieldwork OAS)
Signature:



Disclaimer:

This document has been prepared for the titled project or named part thereof and should not be relied upon or used for any other project without an independent check being carried out as to its suitability and prior written authority of Oxford Archaeology being obtained. Oxford Archaeology accepts no responsibility or liability for the consequences of this document being used for a purpose other than the purposes for which it was commissioned. Any person/party using or relying on the document for such other purposes agrees and will by such use or reliance be taken to confirm their agreement to indemnify Oxford Archaeology for all loss or damage resulting therefrom. Oxford Archaeology accepts no responsibility or liability for this document to any party other than the person/party by whom it was commissioned.

OA South

Janus House
Osney Mead
Oxford
OX2 0ES

t. +44 (0)1865 263 800

OA East

15 Trafalgar Way
Bar Hill
Cambridge
CB23 8SQ

t. +44 (0)1223 850 500

OA North

Mill 3
Moor Lane Mills
Moor Lane
Lancaster
LA1 1QD

t. +44 (0)1524 880 250

e. info@oxfordarch.co.uk

w. oxfordarchaeology.com

Oxford Archaeology is a registered Charity: No. 285627



Chief Executive Officer
Ken Welsh, BSc, MCIFA
Private Limited Company, No: 1618597
Registered Charity, No: 285627
Registered Office: Oxford Archaeology Ltd
Janus House, Osney Mead, Oxford OX2 0ES

Land off Blidworth Lane, Rainworth

Archaeological Evaluation Report

Written by Katherine Webster

With illustrations from Lucy Gane and Matt Bradley

Contents

1	INTRODUCTION.....	1
1.1	Scope of work.....	1
1.2	Location, topography and geology	1
1.3	Archaeological and historical background	1
2	AIMS AND METHODOLOGY.....	3
2.1	Aims.....	3
2.2	Methodology	3
3	RESULTS	5
3.1	Introduction and presentation of results.....	5
3.2	General soils and ground conditions.....	5
3.3	General distribution of archaeological deposits	5
3.4	North-west field – Trenches 1–4 (Plate 1)	5
3.5	North-east field – Trenches 5–23 (Plates 2–4).....	5
3.6	South field – Trenches 25–33 (Plates 5–6).....	6
3.7	Finds and environmental summary	6
4	DISCUSSION	7
4.1	Reliability of field investigation.....	7
4.2	Interpretation and conclusions.....	7
5	BIBLIOGRAPHY	8
APPENDIX A	TRENCH DESCRIPTIONS AND CONTEXT INVENTORY	9
APPENDIX B	SITE SUMMARY DETAILS	21

List of Figures

- | | |
|--------|--|
| Fig. 1 | Site location |
| Fig. 2 | Trench locations with geophysical survey results |
| Fig. 3 | Trench layout on Sanderson Map |
| Fig. 4 | Sections 500, 2000, 1800, 1801, 2900 and 2901 |

List of Plates

- | | |
|---------|--|
| Plate 1 | Trench 3, looking south-east (1m and 2m scales) |
| Plate 2 | Trench 7, looking south-west (1m and 2m scales) |
| Plate 3 | North-east-facing section 500 through modern pit within Trench 5 (1m scale) |
| Plate 4 | East-facing section 2000 through small ditches within Trench 20 (2m scale) |
| Plate 5 | South-east-facing section 2900 through boundary ditch 2902 within Trench 29 (2m scale) |
| Plate 6 | Trench 27 boundary 2702, looking north (1m and 2m scales) |

Summary

In November 2021 Oxford Archaeology was commissioned by the RPS Group on behalf of Barratt & David Wilson Homes North Midlands to undertake a trial-trench evaluation at a proposed residential development on Land off Blidworth Lane, Rainworth, Nottinghamshire. The fieldwork was undertaken over the course of two weeks and consisted of 33 trenches across a c 10.25ha site, representing a 3% sample of the proposed development area. The trenches were arranged to provide good coverage of the area and identify a possible medieval trackway identified on the geophysical survey.

No significant archaeological remains were identified during the evaluation, and little was found of the remains of the potential medieval trackway. Some undated boundary ditches were identified within the trenches; however, these were found to correspond with historical field boundaries. Other features that were investigated as part of the evaluation included natural variations in the geology, plough scars and two modern pits.

Acknowledgements

Oxford Archaeology would like to thank Simon Mortimer of the RPS Group for commissioning this project on behalf of Barratt & David Wilson Homes North Midlands. Thanks are also extended to Matthew Adams, who monitored the work on behalf of Newark and Sherwood & Mansfield District Council.

The project was managed for Oxford Archaeology by Carl Champness. The fieldwork was directed by Katherine Webster, who was supported by Daniel Pond, Domiziana Rossi, Mel Harvell and Rebecca Neilson. Survey and digitising were carried out by Matt Bradley. Thanks are also extended to the team of OA staff who prepared the archive under the supervision of Nicola Scott.

1 INTRODUCTION

1.1 Scope of work

- 1.1.1 Oxford Archaeology (OA) was commissioned by RPS Group acting on behalf of Barratt & David Wilson Homes North Midlands to undertake a trial-trench evaluation at the site of proposed residential development at Land off Blidworth Lane, Rainworth. A programme of 33 trial trenches were undertaken to provide good coverage of the site and identify a possible medieval trackway seen on the geophysical survey.
- 1.1.2 The work was undertaken to inform the Planning Authority in advance of a submission of a planning application (planning ref. 2020/0182/OUT). A proposal was put forward by RPS Group and a written scheme of investigation was produced and approved detailing the local authority's requirements for work necessary to inform the planning application (RPS 2021). This document outlines the results of the evaluation works.
- 1.1.3 All work was undertaken in accordance with local and national planning policies and Chartered Institute for Archaeologists guidance (CIfA 2014).

1.2 Location, topography and geology

- 1.2.1 The site lies to the south-west of Rainworth, a linear settlement approximately 6km south-east of Mansfield, Nottinghamshire. The area of proposed development consists of c 10.25ha of land (centered on NGR SK 579 586; Fig. 1), formed by two irregularly sized agricultural fields and an area of meadow.
- 1.2.2 The geology of the area is mapped as sandstone of the Chester formation (BGS 2022). The soils are freely draining slightly acid sandy soils (Soilscapes 2022).

1.3 Archaeological and historical background

- 1.3.1 The archaeological and historical background of the site was outlined in the Written Scheme of Investigation (RPS 2021) which refers to the desk-based assessment (DBA) undertaken by RPS group in 2019 with information obtained from the Nottinghamshire Historic Environment Record, Historic England's National Heritage List for England and historic maps for the site and surrounding area. The assessment identified known archaeological sites/assets within the development area and within a 1km radius search area. It was prepared following a geophysical survey of the site and the assessment included a review of the results.
- 1.3.2 The assessment noted one non-designated asset within the site – a former trackway of possible medieval date and depicted on George Sanderson's map of 1835. The Sherwood Archaeological Society had identified the trackway as being of possible Roman age rather than medieval/post-medieval, although this had never been tested before now. The trackway was thought to have aligned with an anomaly on the geophysical survey but was not picked up in the trial-trenching.

Prehistoric period (10,000 BC – AD 43)

- 1.3.3 No evidence for early prehistoric activity is known within the site or was identified in the DBA or geophysical survey. The prehistoric information in the HER within 1km

relates to possible former prehistoric burial mounds at Rainworth Water (HER M2586) and a small quantity of worked flint recovered from archaeological survey on the Mansfield Southern Relief Road (HER L12037). There were no anomalies of prehistoric date on the geophysical survey and a relatively low potential for prehistoric archaeological was suggested for the site.

Roman (AD 43 – 410)

- 1.3.4 The only recorded evidence for these periods within a 1km radius of the site is the possible 'Roman Camp' earthworks claimed at Rainworth Water in the 18th century (HER L9089). It is noted that no finds of Roman date are recorded from the 20th century archaeological surveys in advance of the A617 & Relief Road schemes or from the archaeological monitoring at Lindhurst Wind Farm. The trackway noted above and seen on the Sanderson map of 1835 may follow the route of a Roman trackway according to the Sherwood Archaeological Society. However, there was no evidence of this in the trenches.

Saxon and medieval (AD 410 – 1533)

- 1.3.5 There are no Saxon or medieval finds recorded on the HER or obvious anomalies identified on the geophysical survey within the development area or within a 1km radius of the site.

Post-medieval/modern (1533 – present)

- 1.3.6 The 1835 George Sanderson map (Fig. 3) shows little detail within the site other than a minor E–W road or trackway which divides the site in half. This forms a routeway from Rainworth village running towards Sutton in Ashfield. It was clearly in use in the first half of the 19th century, but its age is uncertain. To the north-west of the site is the junction of Blidworth Lane and Southwell Road, which is labelled 'Three Thrown Hollows', but no buildings are shown either within or immediately adjacent to the study site. An enclosure is shown to the west of the site and is probably the demarcation of Bishopshill Plantation as shown on later maps.

2 AIMS AND METHODOLOGY

2.1 Aims

2.1.1 The project aims and objectives were as follows:

- i.* Test the veracity of the 2019 geophysical survey;
- ii.* Determine the location, extent, date, character, condition and level of significance of any archaeological remains that are present.
- iii.* To Inform further measures as necessary to mitigate the impacts of the development on surviving archaeological remains
- iv.* Implement such further measures if required
- v.* Produce a site archive for deposition with an appropriate museum and to provide information for accession to the Nottinghamshire HER

2.1.2 Research aims;

- i.* Investigate the former trackway that crosses the site – if present.
- ii.* Establish whether the anomalies identified in the 2019 geophysical survey relate to archaeological remains;
- iii.* Confirm whether the archaeological remains are present which were not detected/identified in the geophysical survey results.
- iv.* Clarify the presence/absence, extent, condition, nature, character date and significance of any archaeological remains encountered.
- v.* Assess the artefactual and environmental potential of any archaeological deposits encountered
- vi.* Inform discussions with the local planning authority's archaeological advisors over any further works that are necessary.

2.2 Methodology

2.2.1 A total of 33 trenches measuring 50m x 1.8m were excavated across the site, representing a 3% sample of the development area and targeted on any geophysical anomalies (Fig. 2). A contingency of 1% was held in reserve should significant archaeology had been discovered but not utilised. The trenches were arranged to provide good coverage of the site and to investigate the geophysical anomalies and the potential trackway identified in the George Sanderson 1835 map. Only two trenches were moved slightly in the south due to the presence of a services pipe and high vegetation.

2.2.2 Each trench was excavated with a mechanical excavator fitted with an appropriate toothless bucket under the direct supervision of an archaeologist. Spoil was stored on the sides of the trenches, far enough away to maintain the safety of each trench according to its depth. Machining went down to the first archaeological horizon, or in its absence natural geology. Once archaeological deposits or natural variations were identified these were excavated and recorded or tested.

2.2.3 Recording and investigations of features were undertaken as outlined within the WSI (RPS 2021).

3 RESULTS

3.1 Introduction and presentation of results

- 3.1.1 The results of the evaluation are presented below and include a stratigraphic description of the trenches that contained features and anomalies that were investigated. The full details of all trenches with dimensions and depths of all deposits can be found in Appendix A.

3.2 General soils and ground conditions

- 3.2.1 The soil sequence in the trenches was mostly uniform. The natural geology of pinkish red sandstone was overlain by a ploughsoil of very dark greyish black sandy loam. The natural geology was encountered at depths of between 0.3m and 0.8m across the site.
- 3.2.2 Ground conditions throughout the evaluation were generally good, and the site remained relatively dry throughout. Archaeological or natural features, where present, were easy to identify against the underlying natural geology.

3.3 General distribution of archaeological deposits

- 3.3.1 Features were present in only a few of the trenches, and most were either of geological or natural origin. The few features identified were either modern pits or ditches that align with mapped historical field boundaries. Many of the geophysical features lined up with natural geology variations or plough scars. No significant archaeology was identified in the evaluation.

3.4 North-west field – Trenches 1–4 (Plate 1)

- 3.4.1 Four trenches were located to provide coverage of the north-west field, where few geophysical anomalies were identified. Trench 1 contained one undated pit (102) and Trench 3 contained a tree-throw hole (302). No other features were identified within the field.

3.5 North-east field – Trenches 5–23 (Plates 2–4)

- 3.5.1 Trenches 5–10 were situated along the northernmost edge of the field. Trench 5 contained a pit believed to be modern (502) due to the large pieces of semi-burnt wood deliberately deposited in the base (Fig. 4; Plate 3). Trench 7 contained a small natural feature (702) that was investigated. Trenches 6, 8, 9 and 10 contained no features.
- 3.5.2 Trenches 11–23 were placed to provide good coverage of the middle part of the field and to identify the medieval trackway previously identified from the Sanderson 1835 map. This was not identified in the evaluation. Trench 20 contained two parallel undated ditches (2002 and 2005; Fig. 4; Plate 4). Trenches 16, 17 and 18 contained a series of small ditches, which in Trench 18 produced a small piece of plastic within ditch 1804. This ditch appeared to form part of an old field boundary. The rest of the trenches in this section produced no features.

3.6 South field – Trenches 25–33 (Plates 5–6)

- 3.6.1 Trenches 25–33 were located across the southern half of the field in order to give good coverage of the area and contained the most features found in the evaluation. Trenches 24 and 26 contained multiple plough scars, some of which were tested and produced no finds. Trenches 27 and 29 produced parallel ditches that lined up with the historic field boundaries (Fig. 3; Plates 5 and 6). Both of these ditches were excavated in Trench 29 (Fig. 4). Ditch 2905 produced a small piece of plastic and no finds came from ditch 2902.
- 3.6.2 A hedgerow was identified in Trenches 27 and 32 that lined up with a modern field boundary on historical maps (Fig. 3), the hand-dug slots in both trenches produced no finds. The rest of the trenches contained no features.

3.7 Finds and environmental summary

- 3.7.1 The only artefactual material found on site was some modern pottery from the topsoil and some small pieces of plastic from two of field boundary ditches, none of which was retained. Due to the absence of archaeological features no environmental samples were taken.

4 DISCUSSION

4.1 Reliability of field investigation

- 4.1.1 The ground conditions throughout the two weeks of the evaluation were generally good. Features were easily identifiable against the natural geology. Only two of the trenches were moved slightly to stay away from the long grass on the southern outskirts of the field. The evaluation was therefore able to achieve good coverage of the proposed development area, and the results can therefore be considered to provide a reliable assessment of the archaeological potential of the site.
- 4.1.2 The evaluation successfully tested the veracity of the geophysical survey and any features identified were hand excavated to assess the archaeological potential. No significant archaeological remains were identified during the evaluation.

4.2 Interpretation and conclusions

- 4.2.1 Several undated features were investigated, most of which align with either known modern field boundaries, plough scarring or modern field boundaries identified on the 1st edition OS map (Fig. 3). Many of these former field boundaries were levelled in the 1990s.
- 4.2.2 The trackway from the Sanderson 1835 map was not identified in the evaluation, most likely due to modern ploughing, as suggested by the plough scarring that was identified in several of the trenches. No archaeological remains were identified associated with the mapped path of the medieval trackway.
- 4.2.3 No significant archaeological features were identified within the evaluation and no significant finds were found or retained. Based on the evaluation results the site is deemed to have no further archaeological interest.

5 BIBLIOGRAPHY

BGS, 2020 Geology of Britain viewer
<https://www.bgs.ac.uk/discoveringGeology/geologyOfBritain/viewer.html> (accessed April 2022)

ClfA, 2014 Standard and guidance for archaeological excavation

RPS 2021, Land off Blidworth Lane, Rainworth – Written Scheme of Investigation for Trial Trench Evaluation

RPS 2019, Land off Blidworth Lane, Rainworth – Desk-based Assessment Report

APPENDIX A TRENCH DESCRIPTIONS AND CONTEXT INVENTORY

Trench 1							
General description					Orientation	E-W	
x1 pit - no finds					Length (m)	50.6	
					Width (m)	1.8	
					Avg. depth (m)	0.59	
Context No.	Type	Fill Of	Width (m)	Depth (m)	Description	Finds	Date
100	Layer			0.59	Topsoil. Very dark greyish black sandy loam		
101	Layer				Natural. Mid pinkish red sand		
102	Cut		1	0.32	Pit		
103	Fill	102		0.32	Secondary Fill. No finds		
Trench 2							
General description					Orientation	NW-SE	
No archaeology					Length (m)	50	
					Width (m)	1.8	
					Avg. depth (m)	0.4	
Context No.	Type	Fill Of	Width (m)	Depth (m)	Description	Finds	Date
200	Layer			0.4	Topsoil. Very dark greyish black loamy sand		
201	Layer				Natural. Mid pinkish red sand		
Trench 3							
General description					Orientation	ESE-WNW	
One tree throw hole [302] no finds, Natural feature - also no finds					Length (m)	50	
					Width (m)	1.8	
					Avg. depth (m)	0.51	
Context No.	Type	Fill Of	Width (m)	Depth (m)	Description	Finds	Date
300	Layer			0.51	Topsoil. Very dark greyish black sandy loam		
301	Layer				Natural. Mid pinkish red sand		
302	Cut		1	0.25	Tree-Throw hole		
303	Fill	302	1	0.25	Secondary Fill. No finds		
Trench 4							

General description						Orientation	NNE-SSW
No archaeology						Length (m)	50
						Width (m)	1.8
						Avg. depth (m)	0.43
Context No.	Type	Fill Of	Width (m)	Depth (m)	Description	Finds	Date
400	Layer			0.43	Topsoil. Very dark greyish black sandy loam		
401	Layer				Natural. Mid pinkish red sand		
Trench 5							
General description						Orientation	N-S
x1 Modern pit [502] large pieces of burnt wood						Length (m)	50
						Width (m)	1.8
						Avg. depth (m)	0.35
Context No.	Type	Fill Of	Width (m)	Depth (m)	Description	Finds	Date
500	Layer			0.35	Topsoil. Very dark greyish black sandy loam		
501	Layer				Natural. Mid pinkish red sand		
502	Cut		0.7	0.68	Pit. Modern pit - No finds, contained large pieces of recently burnt material.		
503	Fill	502	0.6	0.17	Deliberate Backfill. Base fill of pit - deliberately dumped modern burnt material		
504	Fill	502	0.7	0.45	Secondary Fill. No finds		
505	Fill	502	0.7	0.17	Secondary Fill. No finds - disturbed by plough		
Trench 6							
General description						Orientation	SSW-NNE
No archaeology						Length (m)	50
						Width (m)	1.8
						Avg. depth (m)	0.37
Context No.	Type	Fill Of	Width (m)	Depth (m)	Description	Finds	Date
600	Layer			0.37	Topsoil. Very dark greyish black sandy loam		

601	Layer				Natural. Mid pinkish red sand		
Trench 7							
General description					Orientation	SSW-NNE	
x1 small animal disturbance investigated - no finds					Length (m)	50	
					Width (m)	1.8	
					Avg. depth (m)	0.36	
Context No.	Type	Fill Of	Width (m)	Depth (m)	Description	Finds	Date
700	Layer			0.36	Topsoil. Very dark greyish black sandy loam		
701	Layer				Natural. Mid pinkish red sand		
702	Cut				Natural Feature. Small animal disturbance - no finds		
703	Fill	702			Secondary Fill. No finds		
Trench 8							
General description					Orientation	NNW-SSE	
No archaeology					Length (m)	50	
					Width (m)	1.8	
					Avg. depth (m)	0.38	
Context No.	Type	Fill Of	Width (m)	Depth (m)	Description	Finds	Date
800	Layer			0.38	Topsoil. Very dark greyish sandy loam		
801	Layer				Natural. Mid pinkish red sand		
Trench 9							
General description					Orientation	SE-NW	
No archaeology					Length (m)	50	
					Width (m)	1.8	
					Avg. depth (m)	0.4	
Context No.	Type	Fill Of	Width (m)	Depth (m)	Description	Finds	Date
900	Layer			0.4	Topsoil. Very dark greyish black sandy loam		
901	Layer				Natural. Mid pinkish red sand		

Trench 10								
General description						Orientation		NNE-SSW
No archaeology						Length (m)		50
						Width (m)		1.8
						Avg. depth (m)		0.31
Context No.	Type	Fill Of	Width (m)	Depth (m)	Description		Finds	Date
1000	Layer			0.31	Topsoil. Very dark greyish black sandy loam			
1001	Layer				Natural. Mid pinkish red sand			
Trench 11								
General description						Orientation		ENE-WSW
No archaeology						Length (m)		50
						Width (m)		1.8
						Avg. depth (m)		0.32
Context No.	Type	Fill Of	Width (m)	Depth (m)	Description		Finds	Date
1100	Layer			0.32	Topsoil. Very dark greyish black sandy loam			
1101	Layer				Natural. Mid pinkish red sand			
Trench 12								
General description						Orientation		NW-SE
No archaeology						Length (m)		50
						Width (m)		1.8
						Avg. depth (m)		0.3
Context No.	Type	Fill Of	Width (m)	Depth (m)	Description		Finds	Date
1200	Layer			0.3	Topsoil. Very dark greyish black sandy loam			
1201	Layer				Natural. Mid pinkish red sand			
Trench 13								
General description						Orientation		E-W
No archaeology						Length (m)		50
						Width (m)		1.8
						Avg. depth (m)		0.32
Context No.	Type	Fill Of	Width (m)	Depth (m)	Description		Finds	Date

1300	Layer			0.32	Topsoil. Very dark greyish black sandy loam		
1301	Layer				Natural. Mid pinkish red sand		
Trench 14							
General description					Orientation	NW-SE	
No archaeology					Length (m)	50	
					Width (m)	1.8	
					Avg. depth (m)	0.33	
Context No.	Type	Fill Of	Width (m)	Depth (m)	Description	Finds	Date
1400	Layer			0.33	Topsoil. Very dark greyish black sandy loam		
1401	Layer				Natural. Mid pinkish red sand		
Trench 15							
General description					Orientation	NE-SW	
No archaeology					Length (m)	50	
					Width (m)	1.8	
					Avg. depth (m)	0.34	
Context No.	Type	Fill Of	Width (m)	Depth (m)	Description	Finds	Date
1500	Layer				Topsoil. Very dark greyish black sandy loam		
1501	Layer				Natural. Mid pinkish red sand		
Trench 16							
General description					Orientation	WNW-ESE	
x1 ditch [1602] lines up with modern field boundary on farmers map, no finds.					Length (m)	50	
					Width (m)	1.8	
					Avg. depth (m)	0.35	
Context No.	Type	Fill Of	Width (m)	Depth (m)	Description	Finds	Date
1600	Layer			0.35	Topsoil. Very dark greyish black sandy loam		
1601	Layer				Natural. Mid pinkish red sand		
1602	Cut			0.18	Ditch. Modern ditch - matches farmers map of 90's field boundaries		

1603	Fill	1602	0.84	0.18	Secondary Fill. No finds		
Trench 17							
General description					Orientation	E-W	
x1 ditch [1702] lines up with modern field boundary on farmers map, no finds.					Length (m)	50	
					Width (m)	1.8	
					Avg. depth (m)	0.36	
Context No.	Type	Fill Of	Width (m)	Depth (m)	Description	Finds	Date
1700	Layer			0.36	Topsoil. Very dark greyish black sandy loam		
1701	Layer				Natural. Mid pinkish red sand		
1702	Cut		1.1	0.14	Ditch. Modern - no finds		
1703	Fill	1702	1.1	0.14	Secondary Fill. No finds		
Trench 18							
General description					Orientation	SW-NE	
x1 ditch, lines up with geophysics for poss. track way - fill contained plastic. x1 plough scar also investigated - no finds					Length (m)	50	
					Width (m)	1.8	
					Avg. depth (m)	0.39	
Context No.	Type	Fill Of	Width (m)	Depth (m)	Description	Finds	Date
1800	Layer			0.39	Topsoil. Very dark greyish black sandy loam		
1801	Layer				Natural. Mid pinkish red sand		
1802	Cut		1.04	0.16	Plough Furrow. Plough scarring - no finds		
1803	Fill	1802	1.04	0.16	Secondary Fill. No finds		
1804	Cut		0.86	0.2	Ditch. Cut of ditch - small piece of plastic found	Plastic	modern
1805	Fill	1804	0.86	0.2	Secondary Fill		
Trench 19							
General description					Orientation	NE-SW	
No archaeology Change in geology in the hollow towards the NE end investigated.					Length (m)	50	
					Width (m)	1.8	
					Avg. depth (m)	0.35	
Context No.	Type	Fill Of	Width (m)	Depth (m)	Description	Finds	Date

1900	Layer			0.35	Topsoil. Very dark greyish black sandy loam		
1901	Layer				Natural. Mid pinkish red sand		
Trench 20							
General description					Orientation	N-S	
x2 ditches [2002] & [2005] - no finds					Length (m)	50	
					Width (m)	1.8	
					Avg. depth (m)	0.45	
Context No.	Type	Fill Of	Width (m)	Depth (m)	Description	Finds	Date
2000	Layer				Topsoil. Very dark greyish black sandy loam		
2001	Layer				Natural. Mid pinkish red sand		
2002	Cut		1.22	0.4	Ditch		
2003	Fill	2002	1.22	0.27	Secondary Fill		
2004	Fill	2002	0.92	0.12	Secondary Fill		
2005	Cut		0.96	0.21	Ditch		
2006	Fill	2005	0.96	0.21	Secondary Fill		
Trench 21							
General description					Orientation	NW-SE	
No archaeology					Length (m)	50	
					Width (m)	1.8	
					Avg. depth (m)	0.35	
Context No.	Type	Fill Of	Width (m)	Depth (m)	Description	Finds	Date
2100	Layer			0.35	Topsoil. Very dark greyish black sandy loam		
2101	Layer				Natural. Mid pinkish red sand		
Trench 22							
General description					Orientation	NNE-SSW	
No archaeology					Length (m)	50	
					Width (m)	1.8	
					Avg. depth (m)	0.32	
Context No.	Type	Fill Of	Width (m)	Depth (m)	Description	Finds	Date

2200	Layer			0.32	Topsoil. Very dark greyish black sandy loam		
2201	Layer				Natural. Mid pinkish red sand		
Trench 23							
General description					Orientation	ENE-WSW	
No archaeology					Length (m)	50	
					Width (m)	1.8	
					Avg. depth (m)	0.56	
Context No.	Type	Fill Of	Width (m)	Depth (m)	Description	Finds	Date
2300	Layer			0.56	Topsoil. Very dark greyish black sandy loam		
2301	Layer				Natural. Mid pinkish red sand		
Trench 24							
General description					Orientation	ESE-WNW	
x7 plough scars - x2 investigated and no finds					Length (m)	50	
					Width (m)	1.8	
					Avg. depth (m)	0.46	
Context No.	Type	Fill Of	Width (m)	Depth (m)	Description	Finds	Date
2400	Layer			0.46	Topsoil. Very dark greyish black sandy loam		
2401	Layer				Natural. Mid pinkish red sand		
2402	Cut		0.78		Plough Furrow. Plough scarring - poss furrow remnant - unexcavated		
2403	Fill	2402			Secondary Fill. unexcavated		
2404	Cut		0.45		Plough Furrow. Plough scarring - poss furrow - unexcavated		
2405	Fill	2404			Secondary Fill. No finds		
2406	Cut		0.56		Plough Furrow. Plough scarring - poss furrow - unexcavated		
2407	Fill	2406			Secondary Fill. No finds		

2408	Cut		0.6		Plough Furrow. Plough scarring - poss furrow - unexcavated		
2409	Fill	2408			Secondary Fill. No finds		
2410	Cut		0.5	0.2	Plough Furrow. Plough scarring - poss furrow - no finds		
2411	Fill	2410	0.5	0.2	Secondary Fill. No finds		
2412	Cut		0.58		Plough Furrow. Plough scarring/poss furrow - unexcavated		
2413	Fill	2412			Secondary Fill. No finds		
2414	Cut		0.5		Plough Furrow. Plough scarring/poss furrow - unexcavated		
2415	Fill	2414			Secondary Fill. No finds		
2416	Cut		0.5	0.22	Plough Furrow. Plough scarring/poss furrow - no finds		
2417	Fill	2416	0.5	0.22	Secondary Fill. No finds		
2418	Cut		0.34		Plough Furrow. Unexcavated		
2419	Fill	2418			Secondary Fill. Unexcavated		

Trench 25

General description					Orientation	NW-SE	
No archaeology					Length (m)	50	
					Width (m)	1.8	
					Avg. depth (m)	0.35	
Context No.	Type	Fill Of	Width (m)	Depth (m)	Description	Finds	Date
2500	Layer			0.35	Topsoil. Very dark greyish black sandy loam		
2501	Layer				Natural. Mixed mid brown orange and light brown pink sand		

Trench 26

General description					Orientation	NW-SE	
---------------------	--	--	--	--	-------------	-------	--

x4 plough scars/furrows x2 excavated [2602] & [2604] No finds						Length (m)	50
						Width (m)	1.8
						Avg. depth (m)	0.64
Context No.	Type	Fill Of	Width (m)	Depth (m)	Description	Finds	Date
Trench 27							
General description						Orientation	NE-SW
Modern ditch - lines up with modern hedgerow and farmers 90's field boundary map. No finds						Length (m)	50
						Width (m)	1.8
						Avg. depth (m)	0.38
Context No.	Type	Fill Of	Width (m)	Depth (m)	Description	Finds	Date
2700	Layer			0.38	Topsoil. Very dark greyish black sandy loam		
2701	Layer				Natural. Mixed light brown orange, bright yellow orange and light and mid brown pink sand		
2702	Cut				Hedgerow. Large modern field boundary - lines up with farmers 90's map - no finds		
2703	Fill	270 2			Secondary Fill. No finds		
2704	Fill	270 2			Secondary Fill		
Trench 28							
General description						Orientation	NW-SE
No archaeology						Length (m)	50
						Width (m)	1.8
						Avg. depth (m)	0.34
Context No.	Type	Fill Of	Width (m)	Depth (m)	Description	Finds	Date
2800	Layer			0.34	Topsoil. Very dark greyish black sandy loam		
2801	Layer				Natural. Mid pinkish red sand		
Trench 29							
General description						Orientation	NE-SW
x2 ditches [2902] & [2904] No finds - piece of plastic in [2902]						Length (m)	50
						Width (m)	1.8
						Avg. depth (m)	0.46

Context No.	Type	Fill Of	Width (m)	Depth (m)	Description	Finds	Date
2900	Layer			0.46	Topsoil. Very dark greyish black sandy loam		
2901	Layer				Natural. Mid pinkish red sand		
2902	Cut		2.1	0.48	Ditch		
2903	Fill	290 2	2.1	0.3	Secondary Fill		
2904	Fill	290 2	1.55	0.17	Secondary Fill		
2905	Cut		3.1	0.55	Ditch		
2906	Fill	290 5	3.1	0.32	Secondary Fill		
2907	Fill	290 5	2.15	0.22	Secondary Fill		
Trench 30							
General description					Orientation	WSW-ENE	
No archaeology					Length (m)	50	
					Width (m)	1.8	
					Avg. depth (m)	0.36	
Context No.	Type	Fill Of	Width (m)	Depth (m)	Description	Finds	Date
3000	Layer			0.36	Topsoil. Very dark greyish black sandy loam		
3001	Layer				Natural. Mid pinkish red sand		
Trench 31							
General description					Orientation	SSW-NNE	
No archaeology					Length (m)	50	
					Width (m)	1.8	
					Avg. depth (m)	0.3	
Context No.	Type	Fill Of	Width (m)	Depth (m)	Description	Finds	Date
3100	Layer			0.3	Topsoil. Very dark greyish black sandy loam		
3101	Layer				Natural. Mid pinkish red sand		
Trench 32							
General description					Orientation	NE-SW	

Modern ditch that lines up with farmers map - also seen in TR27. Machine slot put in to find depth - - no finds						Length (m)	50
						Width (m)	1.8
						Avg. depth (m)	0.8
Context No.	Type	Fill Of	Width (m)	Depth (m)	Description	Finds	Date
3200	Layer			0.5	Topsoil. Very dark greyish black sandy loam		
3201	Layer				Natural. Mid pinkish red sand		
Trench 33							
General description						Orientation	N-S
No archaeology present						Length (m)	50
						Width (m)	1.8
						Avg. depth (m)	0.46
Context No.	Type	Fill Of	Width (m)	Depth (m)	Description	Finds	Date
3300	Layer			0.46	Topsoil. Very dark greyish black sandy loam		
3301	Layer				Natural. Mid brownish orange sand		

APPENDIX B**SITE SUMMARY DETAILS**

Site name:	Land off Blidworth Lane, Rainworth
Site code:	RABL21
Grid reference	SK 579 586
Type:	Evaluation
Date and duration:	November 2021 (2 weeks)
Area of site	10.25ha
Location of archive:	The archive is currently held at OA, Janus House, and will be deposited with National Civil War Centre - Newark Museum in due course, under the following accession number: RABL21.
Summary of results:	<p>In November 2021 Oxford Archaeology was commissioned by the RPS Group on behalf of Barratt & David Wilson Homes North Midlands to undertake a trial-trench evaluation at a proposed residential development on Land off Blidworth Lane, Rainworth, Nottinghamshire. The fieldwork was undertaken over the course of two weeks and consisted of 33 trenches across a c 10.25ha site, representing a 3% sample of the proposed development area. The trenches were arranged to provide good coverage of the area and identify a possible medieval trackway identified from historical mapping.</p> <p>No significant archaeological remains were identified during the evaluation, and little was found of the remains of the potential medieval trackway. Some undated boundary ditches were identified within the trenches; however, these were found to correspond with historical field boundaries. Other features that were investigated as part of the evaluation included natural variations in the geology, plough scars and two modern pits.</p>

X:\nNottingham_Lane_Rainworth_EV\Geomatics02_GIS Projects\Figures\IABL21_Figure1_2022-01-21.mxd' caroline.souday'24/01/2022

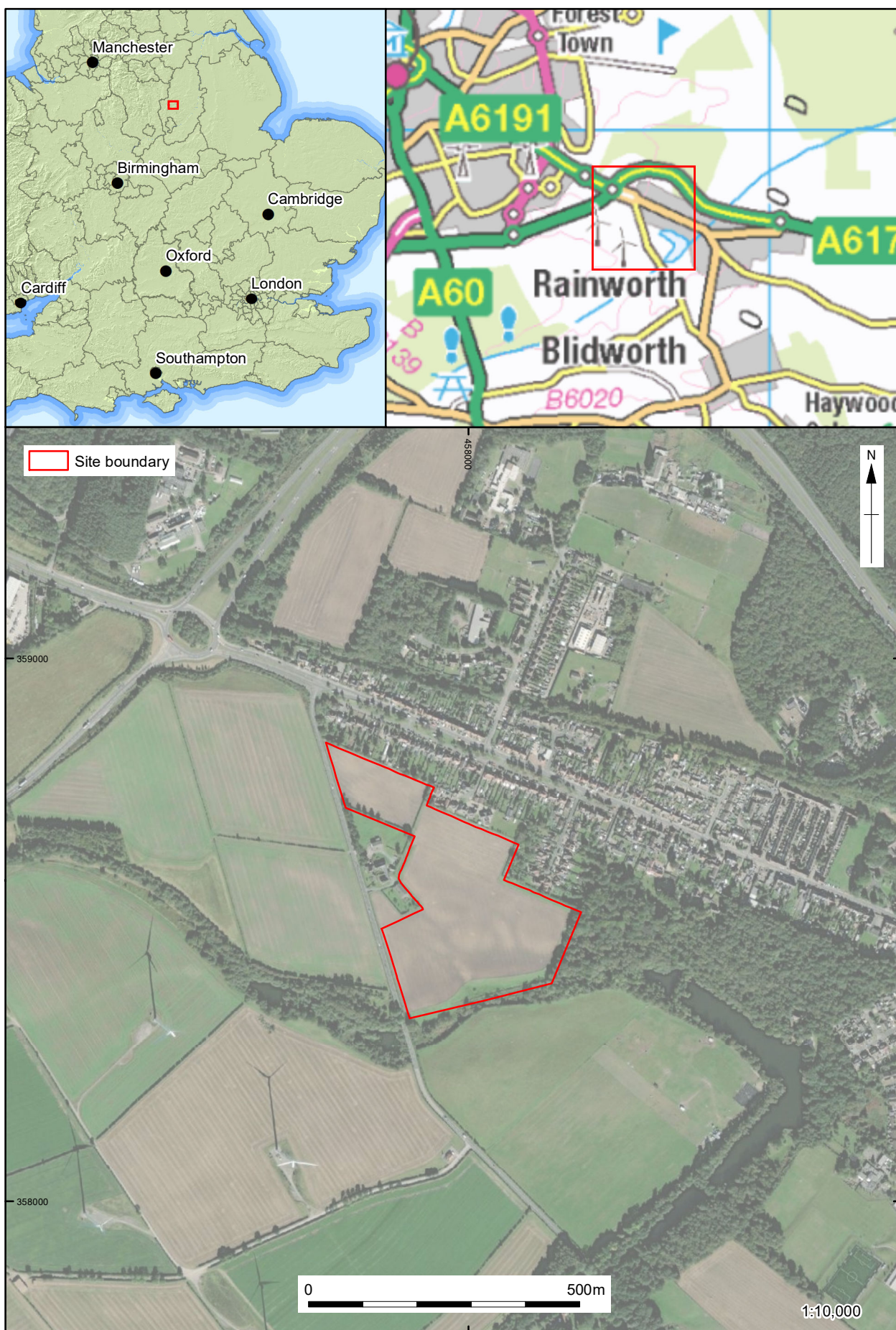

Source: Esri, Maxar, GeoEye, Earthstar Geographics, CNES/Airbus DS, USDA, USGS, AeroGRID, IGN, and the GIS User Community

Figure 1: Site location

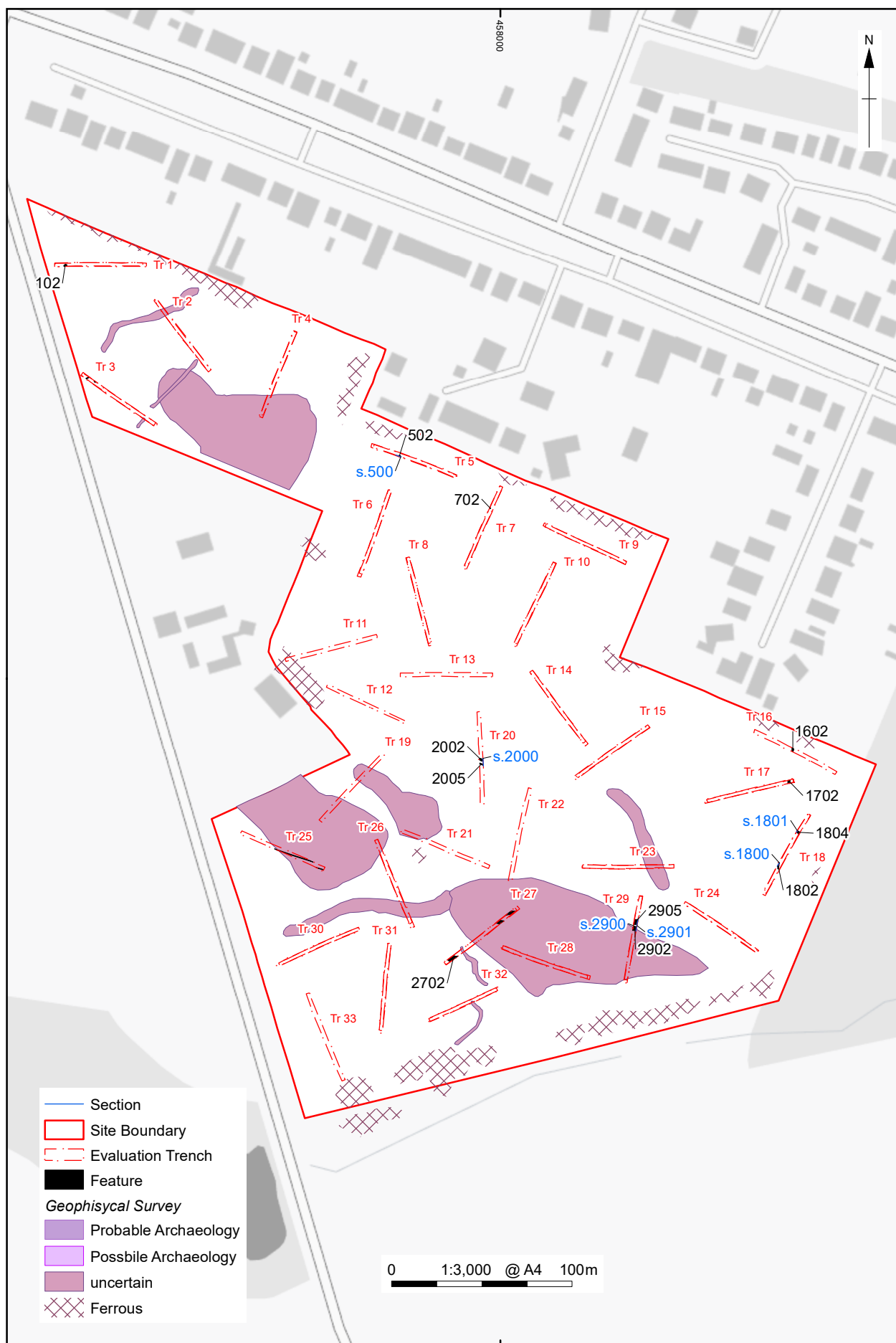

Figure 2: Trench locations with geophysics

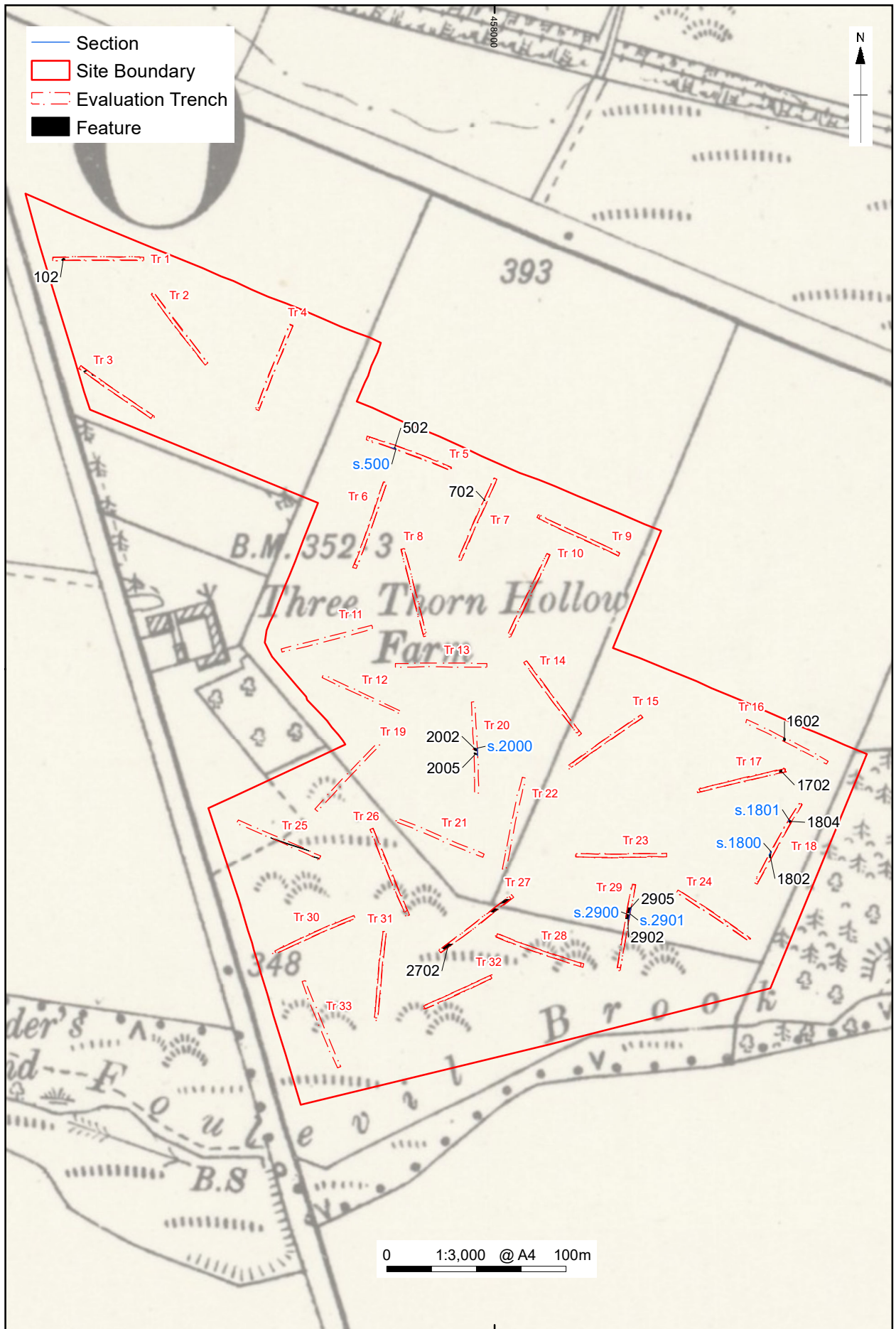

Figure 2: Trench locations with OS 1888 map

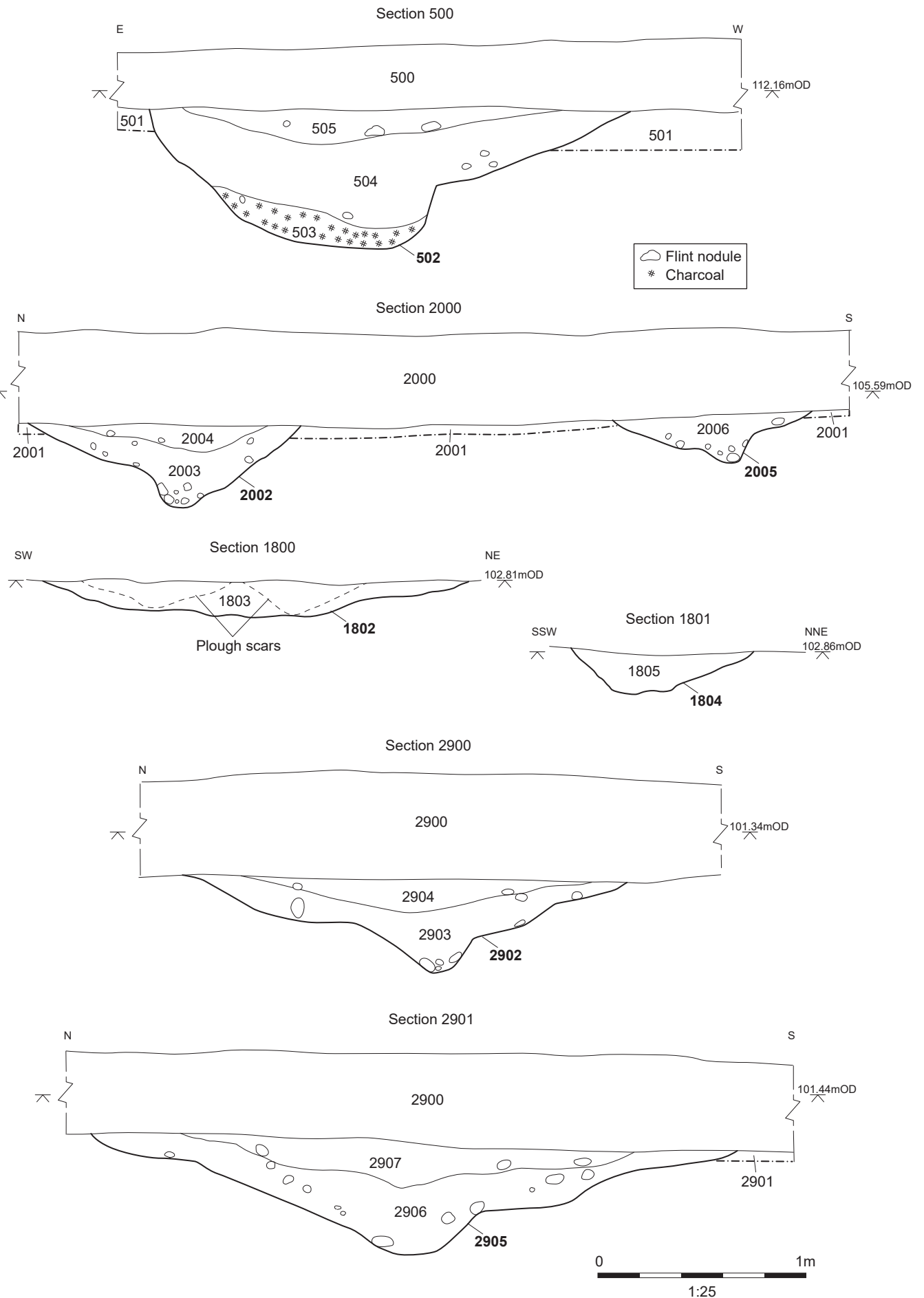

Figure 4: Sections 500, 2000, 1800, 1801, 2900 and 2901



Plate 1: Trench 3 looking south-east (1m and 2m scales)



Plate 2: Trench 7 looking south-west (1m and 2m scales)



Plate 3: North-east facing section 500 through modern pit within Trench 5 (1m scale)



Plate 4: East-facing section 2000 through small ditches within Trench 20 (2m scale)



Plate 5: South-east facing section 2900 through boundary ditch 2902 within Trench 29 (2m scale)



Plate 6: Trench 27 boundary 2702, looking north (1m and 2m scales)



**Head Office/Registered Office/
OASouth**

Janus House
Osney Mead
Oxford OX2 0ES

t: +44 (0) 1865 263 800
f: +44 (0) 1865 793 496
e: info@oxfordarchaeology.com
w: <http://oxfordarchaeology.com>

OANorth

Mill 3
Moor Lane
Lancaster LA1 1QD

t: +44 (0) 1524 541 000
f: +44 (0) 1524 848 606
e: [oanorth@oxfordarchaeology.com](mailto: oanorth@oxfordarchaeology.com)
w: <http://oxfordarchaeology.com>

OAEast

15 Trafalgar Way
Bar Hill
Cambridgeshire
CB23 8SQ

t: +44 (0) 1223 850500
e: [oaeast@oxfordarchaeology.com](mailto: oaeast@oxfordarchaeology.com)
w: <http://oxfordarchaeology.com>



Chief Executive Officer
Ken Welsh, BSc, MCIFA
Oxford Archaeology Ltd is a
Private Limited Company, N^o: 1618597
and a Registered Charity, N^o: 285627