

# Manor House Farm Duns Tew Oxfordshire



## Archaeological Watching Brief Report



**Oxford Archaeology**

August 2003

**Client: M.J. Brian Homes**

Issue N<sup>o</sup>: 1

OA Job N<sup>o</sup>: 1843

Planning Ref N<sup>o</sup>: 02/01315/F

NGR: SP 455 284

**Client Name:** M. J. Brian Homes

**Client Ref No:**

**Document Title:** Manor House Farm, Duns Tew, Oxfordshire

**Document Type:** Watching Brief

**Issue Number:** 1

National Grid Reference: NGR SP 455 284

Planning Reference: 02/01315/F

OA Job Number: 1843

Site Code: DUMHF 03

Invoice Code: DUMHFWB

Receiving Museum: Oxfordshire County Museum Service

Museum Accession No: OXCMS 2003.74

Prepared by: James Mumford

Position: Supervisor

Date: 15th July 2003

Checked by: Jon Hiller

Position: Senior Project Manager

Date: 15th July 2003

Approved by: Nick Shepherd

Position: Head of Fieldwork

Date: 11th August 2003

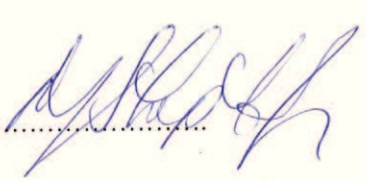
Signed.....

Document File Location U:/OAU/wbREPORTS/Oxfordshire/DUMHF.doc

Graphics File Location Server 10:/oapubs 1/ItoQ\*DUMHFWB\*Manor House  
Farm, Dun Tew\*AH\*10.07.03

Illustrated by Amy Tiffany Hemingway

**Disclaimer:**

*This document has been prepared for the titled project or named part thereof and should not be relied upon or used for any other project without an independent check being carried out as to its suitability and prior written authority of Oxford Archaeology being obtained. Oxford Archaeology accepts no responsibility or liability for the consequences of this document being used for a purpose other than the purposes for which it was commissioned. Any person/party using or relying on the document for such other purposes agrees, and will by such use or reliance be taken to confirm their agreement to indemnify Oxford Archaeology for all loss or damage resulting therefrom. Oxford Archaeology accepts no responsibility or liability for this document to any party other than the person/party by whom it was commissioned.*

**Oxford Archaeology**

© Oxford Archaeological Unit Ltd 2003

Janus House

Osney Mead

Oxford OX2 0ES

t: (0044) 01865 263800

f: (0044) 01865 793496

e: [info@oxfordarch.co.uk](mailto:info@oxfordarch.co.uk)

w: [www.oxfordarch.co.uk](http://www.oxfordarch.co.uk)

Oxford Archaeological Unit Limited is a Registered Charity No: 285627

**Manor House farm, Duns Tew, Oxfordshire*****ARCHAEOLOGICAL WATCHING BRIEF REPORT*****CONTENTS**

Summary.....	1
1 Introduction .....	1
1.1 Location and scope of work .....	1
1.2 Geology and topography .....	1
1.3 Archaeological and historical background .....	1
2 Project Aims and Methodology.....	2
2.1 Aims .....	2
2.2 Methodology.....	2
3 Results .....	2
3.1 Description of deposits .....	2
3.2 Finds .....	2
3.3 Palaeo-environmental remains .....	2
4 Discussion and Conclusions .....	3
Appendix 1 Archaeological Context Inventory .....	4
Appendix 2 Bibliography and References .....	4
Appendix 3 Summary of Site Details.....	4

**LIST OF FIGURES**

- Fig. 1 Site location  
Fig. 2 Site location showing development area  
Fig. 3 Area of reduction, demolished buildings and removed roadway

Cover Plate: Excavation of hole for new bungalow from the east.

## SUMMARY

*In June and July 2003 Oxford Archaeology (OA) carried out an archaeological watching brief at Manor House Farm, Duns Tew, Oxfordshire (NGR SP 455 284). The work was commissioned by M. J. Brian Homes in advance of a barn conversion to dwelling and garages and the construction of a new bungalow. The watching brief did not reveal any archaeological features or deposits, but did show that the site had been used for the dumping of rubbish from the farm from the late 19th century.*

## 1 INTRODUCTION

### 1.1 Location and scope of work

- 1.1.1 In June and July 2003 Oxford Archaeology (OA) carried out an archaeological watching brief at Manor House farm, Duns Tew, Oxfordshire (Fig. 1). The work was commissioned by M. J. Brian Homes in respect of a planning application for a barn conversion to dwelling and garages and the construction of a new bungalow (Planning Application No. 02/01315/F)
- 1.1.2 A project brief was set by Hannah Fluck, Planning Archaeologist for the Oxfordshire County Council.
- 1.1.3 OA prepared a Written Scheme of Investigation (WSI) detailing how it would meet the requirements of the brief, which was approved by Oxford County Council.

### 1.2 Geology and topography

- 1.2.1 The site is located at Manor Farm, Wroxton Lane, to the north of Main Street in the centre of Duns Tew (Fig. 2). Redundant farm buildings currently occupy the site. The site lies at 139 m OD at the junction between the north Oxfordshire claylands and the Limestone belt to the south.

### 1.3 Archaeological and historical background

- 1.3.1 The archaeological background to the watching brief was prepared for the WSI for the project (OA 2003) and is reproduced below.
- 1.3.2 The development is situated within the historic core of Duns Tew, a settlement that dates to at least the end of the Anglo-Saxon period when it was mentioned in the Domesday Survey of 1086. The development site lies adjacent to the site of the original medieval Manor House. Excavation for a pond at the proposed site revealed a quantity of medieval pottery, dressed stone and flagstones suggesting that further remains of that date may be encountered.

## 2 PROJECT AIMS AND METHODOLOGY

### 2.1 Aims

- 2.1.1 To identify and record the presence/absence, extent, condition, quality and date of archaeological remains in the areas affected by the development.
- 2.1.2 To make available the results of the archaeological investigation.

### 2.2 Methodology

- 2.2.1 The site was cleared and two of the outbuildings were demolished. The site was then excavated and landscaped from the centre of the site of the proposed bungalow outwards. The concrete roadway through the farmyard was lifted and crushed for hardcore (Fig. 3). All these works were archaeologically monitored.
- 2.2.2 All archaeological features were planned at a scale of 1:100 and where excavated their sections drawn at scales of 1:20. All excavated features were photographed using colour slide and black and white print film. A general photographic record of the work was made. Recording followed procedures detailed in the *OAU Fieldwork Manual* (ed.D Wilkinson, 1992).

## 3 RESULTS

### 3.1 Description of deposits

- 3.1.1 The excavation of the hollow for the bungalow cut into natural bands of light brown and yellowish sand with patches of silty clay (1). This was sealed below a 0.2-3 m thick dark reddish brown silty sand loam (2) sub soil. Towards the west and north-west side of the site this layer had been removed or overlain by a series of deposits. This was comprised of waste material from the farm and deposited from the late 19th century and consisted of patches of dark grey brown and grey black silty sand loam (3) containing ash, cinders, building debris and lots of glass bottles and jars. This was sealed below a 0.3 m thick layer of dark grey brown (4) topsoil, which had been cut by the 0.3 -4 m thick concrete roadway and hard standing area for the farmyard (Fig. 3).

### 3.2 Finds

- 3.2.1 No finds were recovered during the watching brief.

### 3.3 Palaeo-environmental remains

- 3.3.1 No deposits suitable for environmental sampling were identified during the watching brief.

#### 4 DISCUSSION AND CONCLUSIONS

- 4.1.1 The watching brief did not reveal any archaeological features or deposits within the area of development. However, evidence for the dumping and burning of modern farm rubbish was observed and recorded along the west and north-west side of the farmyard. The rest of the area appears to have been open ground around the manor house and farm.



## APPENDICES

## APPENDIX 1 ARCHAEOLOGICAL CONTEXT INVENTORY

<i>Context</i>	<i>Type</i>	<i>Depth</i>	<i>Width</i>	<i>Height</i>	<i>Comments</i>	<i>Finds</i>
1	Natural		Not revealed	Not revealed	Sand and silty clay	None
2	Layer	0.2 -3 m	Not revealed	Not revealed	Sub soil	None
3	Layer	0.7 -1.2 m	Not revealed	Not revealed	19th century onwards dumping	None
4	Layer	0.3 m	Not revealed	Not revealed	Topsoil	None

## APPENDIX 2 BIBLIOGRAPHY AND REFERENCES

OA 2003, Development at Manor House Farm, Duns Tew, Nr. Bicester, Oxfordshire Written Scheme of Investigation

D Wilkinson (ed), 1992, *OAU Fieldwork Manual*

## APPENDIX 3 SUMMARY OF SITE DETAILS

**Site name:** Manor House farm, Duns Tew, Oxfordshire

**Site code:** DUMHF 03

**Grid reference:** NGR SP 455 284

**Type of watching brief:** Ground works for the construction of new bungalow and barn conversion to a dwelling and garages.

**Date and duration of project:** A total of four site visits from 24/6/03 to the 4/7/03.

**Area of site:** 60 x 50 m

**Summary of results:** The watching brief did not reveal any archaeological features or deposits, but had been used for the dumping of rubbish from the farm from the late 19th century.

**Location of archive:** The archive is currently held at OA, Janus House, Osney Mead, Oxford, OX2 0ES, and will be deposited with Oxfordshire County Museums Service in due course, under the following accession number: OXCMS 2003.74

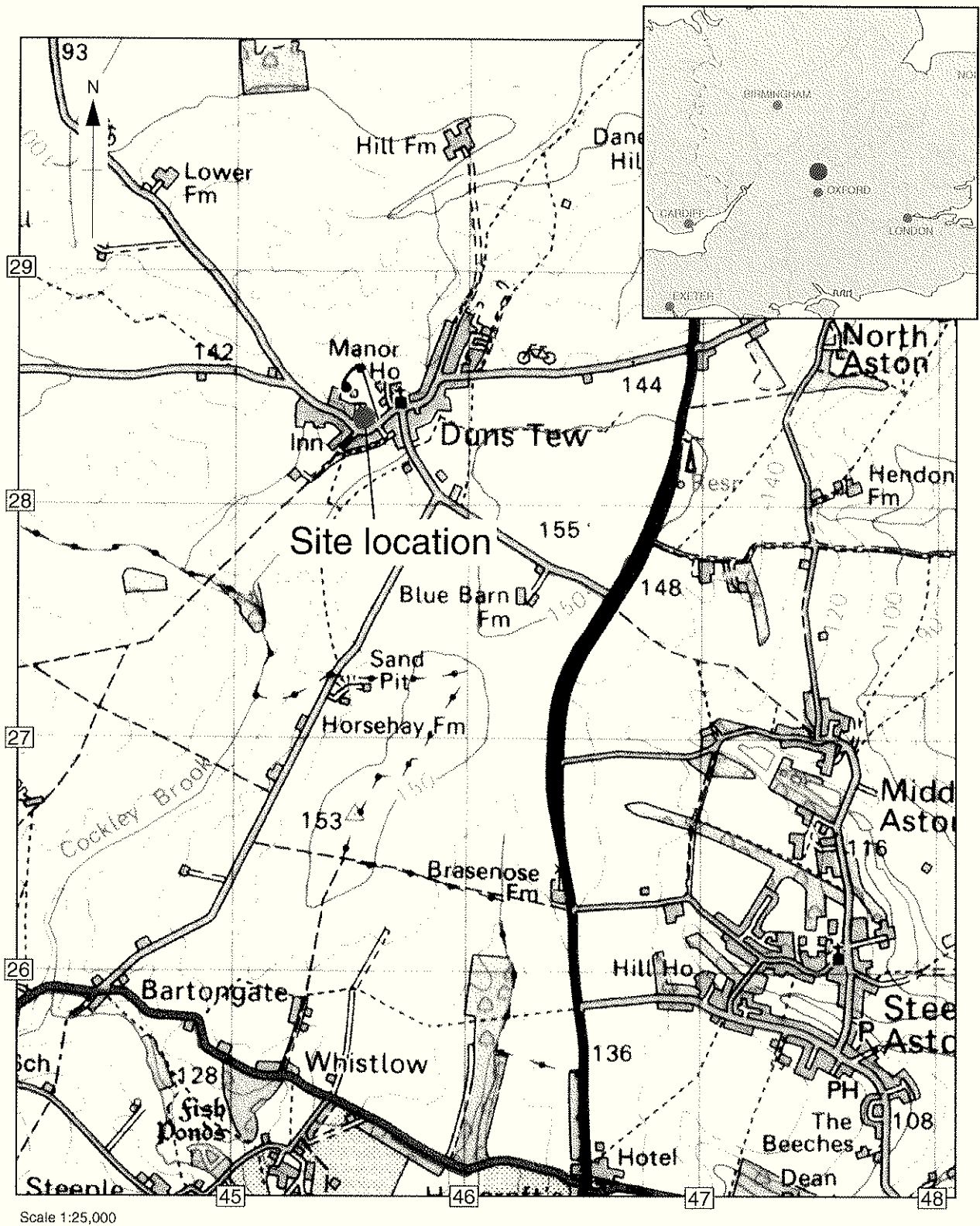

Reproduced from the Landranger 1:50,000 scale by permission of the Ordnance Survey on behalf of The Controller of Her Majesty's Stationery Office  
© Crown Copyright 1997. All rights reserved. Licence No. AL 100005569

Figure 1: Site location



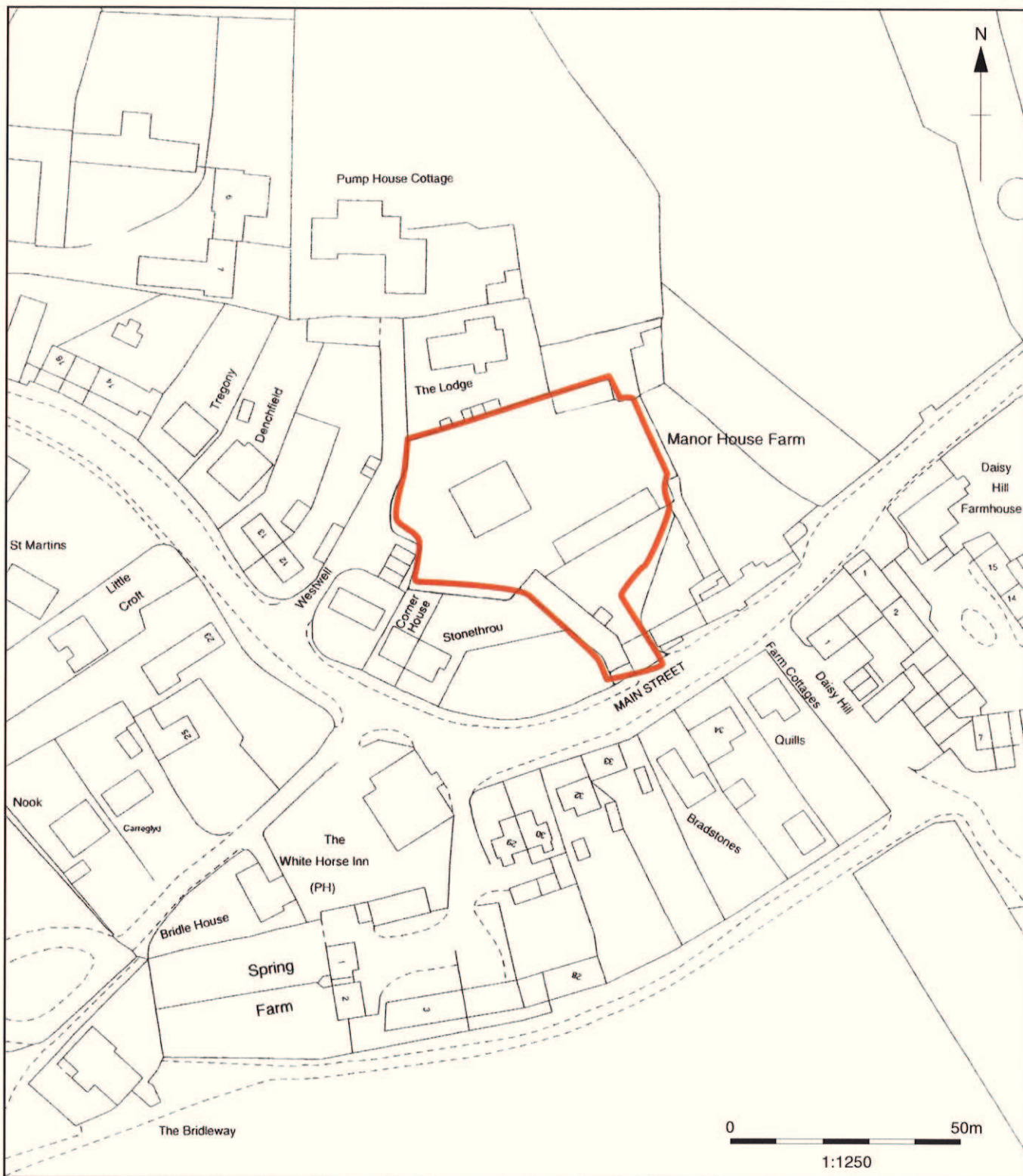

Reproduced from the 1:2500 scale by permission of the Ordnance Survey on behalf of The Controller of Her Majesty's Stationery Office © Crown Copyright 1999. All rights reserved. Licence No. AL 100005569

— Area of development

Figure 2: Site location showing development area

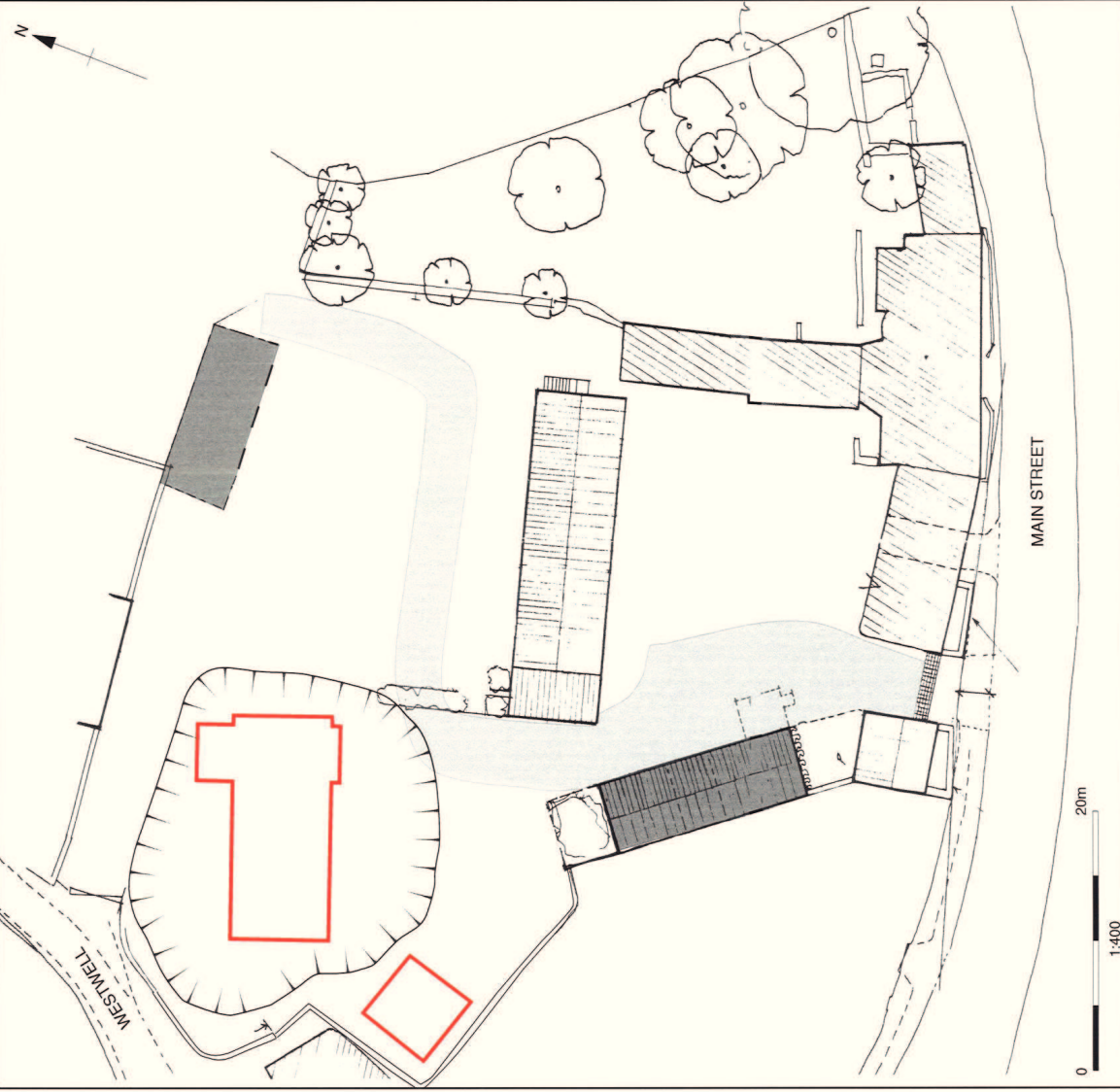

Figure 3: Area of reduction, demolished buildings and removed roadway



### **Oxford Archaeology**

Janus House  
Osney Mead  
Oxford OX2 0ES

t: (0044) 01865 263800  
f: (0044) 01865 793496  
e: [info@oxfordarch.co.uk](mailto:info@oxfordarch.co.uk)  
w: [www.oxfordarch.co.uk](http://www.oxfordarch.co.uk)

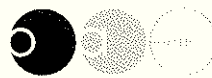

### **Oxford Archaeology North**

Storey Institute  
Meeting House Lane  
Lancaster LA1 1TF

t: (0044) 01524 541000  
f: (0044) 01524 848606  
e: [lancinfo@oxfordarch.co.uk](mailto:lancinfo@oxfordarch.co.uk)  
w: [www.oxfordarch.co.uk](http://www.oxfordarch.co.uk)



**Director:** David Jennings, BA MIFA FSA

Oxford Archaeological Unit is a  
Private Limited Company, N<sup>o</sup>: 1618597  
and a Registered Charity, N<sup>o</sup>: 285627

**Registered Office:**

Oxford Archaeological Unit  
Janus House, Osney Mead, Oxford OX2 0ES