

Four Winds Little Tew Oxfordshire



Archaeological Watching Brief Report



Oxford Archaeology

17th April 2003

Client Name: NJCT Architects

Issue N^o: 1

OA Job N^o: 1648

Planning Ref N^o: W2002/0832

NGR: SP 3833 2831

Client Name: NJCT Architects

Client Ref No:

Document Title: Four Winds, Little Tew, Oxfordshire

Document Type: Watching Brief

Issue Number: 1

National Grid Reference: NGR SP 3833 2831
Planning Reference: W2002/832

OA Job Number: 1648
Site Code: LITEFW02
Invoice Code: LITEFWWB
Museum Accession No: OXCMS 2003.12

Prepared by: James Mumford

Position: Supervisor
Date: 16th April 2003

Checked by: Jon Hiller
Position: Senior Project Manager
Date: 17th April 2003

Approved by: Paul Booth
Position: Senior Project Manager
Date: 24th April 2003

Document File Location U:/OAU/WSIreports/FourWinds, LittleTewWSI.doc
Graphics File Location Server10(W):/OAUpubs
1/ItoQ*LITEFWWB*Fourwinds, Little Tew,
Oxfordshire*RMS*17.4.03

Illustrated by Roz Smith

Signed...

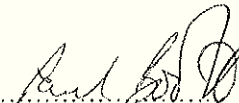

Disclaimer:

This document has been prepared for the titled project or named part thereof and should not be relied upon or used for any other project without an independent check being carried out as to its suitability and prior written authority of Oxford Archaeology being obtained. Oxford Archaeology accepts no responsibility or liability for the consequences of this document being used for a purpose other than the purposes for which it was commissioned. Any person/party using or relying on the document for such other purposes agrees, and will by such use or reliance be taken to confirm their agreement to indemnify Oxford Archaeology for all loss or damage resulting therefrom. Oxford Archaeology accepts no responsibility or liability for this document to any party other than the person/party by whom it was commissioned.

Oxford Archaeology

© Oxford Archaeological Unit Ltd 2003

Janus House

Osney Mead

Oxford OX2 0ES

t: (0044) 01865 263800

f: (0044) 01865 793496

e: info@oxfordarch.co.uk

w: www.oxfordarch.co.uk

Oxford Archaeological Unit Limited is a Registered Charity No: 285627

Four Winds, Little Tew, Oxfordshire***ARCHAEOLOGICAL WATCHING BRIEF REPORT*****CONTENTS**

Summary.....	1
1 Introduction	1
1.1 Location and scope of work	1
1.2 Geology and topography	1
1.3 Archaeological and historical background.....	1
2 Project Aims and Methodology.....	2
2.1 Aims	2
2.2 Methodology.....	2
3 Results	2
3.1 Description of deposits.....	2
3.2 Finds	2
3.3 Palaeo-environmental remains	2
4 Discussion and Conclusions	2
Appendix 1 Archaeological Context Inventory	3
Appendix 2 Bibliography and References	3
Appendix 3 Summary of Site Details.....	3

LIST OF FIGURES

- Fig. 1 Site location
 Fig. 2 Site plan of area of watching brief

SUMMARY

In January and April 2003 Oxford Archaeology (OA) carried out an archaeological watching brief at Four Winds, Little Tew, Oxfordshire (NGR SP 3833 2831). The work was commissioned by NJCT Architects in advance of the construction of a new house. The watching brief revealed no archaeological features or deposits.

1 INTRODUCTION

1.1 Location and scope of work

- 1.1.1 In January and April 2003 Oxford Archaeology (OA) carried out an archaeological watching brief at Four Winds, Little Tew, Oxfordshire (Fig. 1). The work was commissioned by NJCT Architects in respect of a planning application for new house (Planning Application No. W2002/0832).
- 1.1.2 A project brief was set by Hugh Coddington, Oxfordshire's Deputy County Archaeologist (OCAS 2003).
- 1.1.3 OA prepared a Written Scheme of Investigation detailing how it would meet the requirements of the brief.

1.2 Geology and topography

- 1.2.1 The development area is located to the south of Little Tew on the east side of the road leading to Church Enstone (NGR SP 3833 2831). The site of the development is within the private garden and is 0.8 hectares in area. The site lies at c. 176 m OD and the underlying geology is fine loam overlying Chipping Norton Limestone.

1.3 Archaeological and historical background

- 1.3.1 The archaeological background to the watching brief was prepared for the WSI for the project (OA 2003) and is reproduced below.
- 1.3.2 The village of Little Tew was listed in the Domesday Survey of 1086 suggesting that its origins lay at least in the later Anglo Saxon period. To the south of the site prehistoric pottery was collected. There is some evidence for a large enclosure encircling the crest of the hill. This feature has associated earthworks, which include house platforms and a rectangular mound. The southern part of this enclosure is thought to pass through the garden of the Four Winds. Within this enclosure, adjacent to the medieval manor that occupied the crest of the hill, fragments of Grass tempered ware was recovered from the surface along with medieval pottery and four post-medieval crucibles. This evidence suggests that the enclosure is medieval and relates to the manor, but may have had earlier origins. The previous owner of the Four Winds found pottery ranging in date from the Romano-British period to the 12th century whilst gardening.

2 PROJECT AIMS AND METHODOLOGY

2.1 Aims

- 2.1.1 To identify and record the presence/absence, extent, condition, quality and date of archaeological remains in the areas affected by the development.
- 2.1.2 To make available the results of the archaeological investigation.

2.2 Methodology

- 2.2.1 The site was first cleared of trees in the area of the development and the root holes were excavated by machine. The site was then levelled and the foundations trenches marked out. These were excavated in sections and filled with concrete (Fig. 2).
- 2.2.2 Archaeological observation of the ground work consisted of a number of visits and general photographic record of the work was made. Recording followed procedures detailed in the *OAU Fieldwork Manual* (ed D Wilkinson, 1992).

3 RESULTS

3.1 Description of deposits

- 3.1.1 The tree clearance and the following excavation of the foundations exposed a natural (1) of ironstone and orange brown sand, which was overlain by a 0.30 to 0.60 m layer of reddish brown silty sand subsoil (2) with ironstone fragments. This had been disturbed by tree roots and overlain by a 0.35 m thick layer of dark grey brown silty sand topsoil (3). No archaeological features or deposits were observed.

3.2 Finds

- 3.2.1 No finds were recovered during the watching brief.

3.3 Palaeo-environmental remains

- 3.3.1 No deposits suitable for environmental sampling were identified during the watching brief.

4 DISCUSSION AND CONCLUSIONS

- 4.1.1 The archaeological watching brief revealed no features, deposits, or finds of archaeological significance.

APPENDICES

APPENDIX 1 ARCHAEOLOGICAL CONTEXT INVENTORY

<i>Context</i>	<i>Type</i>	<i>Depth</i>	<i>Width</i>	<i>Height</i>	<i>Comments</i>	<i>Finds</i>
1	Natural				Natural	
2	Layer	0.30 - 0.60 m			Subsoil	
3	Layer	0.35 m			Topsoil	

APPENDIX 2 BIBLIOGRAPHY AND REFERENCES

OA 1992, *Fieldwork Manual* (ed. D Wilkinson, first edition, August 1992)

OA 2003, *Four Winds, Little Tew, Oxfordshire* Written Scheme of Investigation

OCAS 2003, *The Four Winds, Enstone Lane, Little Tew* Design Brief for Archaeological Watching Brief

APPENDIX 3 SUMMARY OF SITE DETAILS

Site name: Four Winds, Little Tew, Oxfordshire

Site code: LITEFW 03

Grid reference: NGR SP 3833 0821

Type of watching brief: Clearing of site and excavation of foundations for new house.

Date and duration of project: Six visits from the 15/1/03 to 16/4/03.

Area of site: 20 m x 28 m

Summary of results: The watching brief revealed no archaeological features or deposits

Location of archive: The archive is currently held at OA, Janus House, Osney Mead, Oxford, OX2 0ES, and will be deposited with Oxfordshire County Museums Service in due course, under the following accession number: OXCMS 2003.12

Server10\W1\OAL\pubs\l1re0\MICERCO\Milford_Old_Ekstead_Road_RMS*51_10.05.

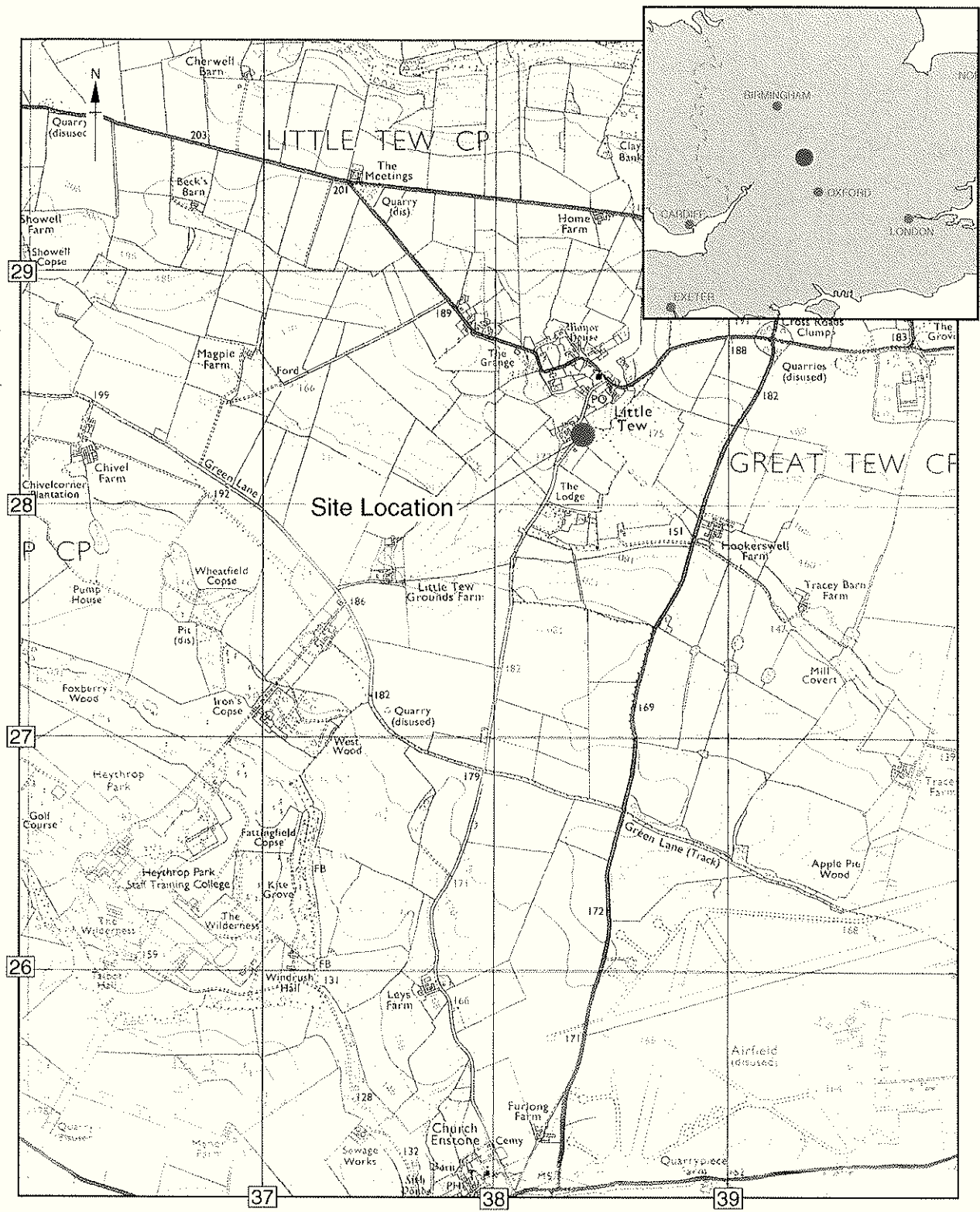

Scale 1:25,000

Reproduced from the Pathfinder 1:25000 scale by permission of the Ordnance Survey on behalf of The Controller of Her Majesty's Stationery Office © Crown Copyright 1982. All rights reserved. Licence No. AL 100005569

Figure 1: Site location

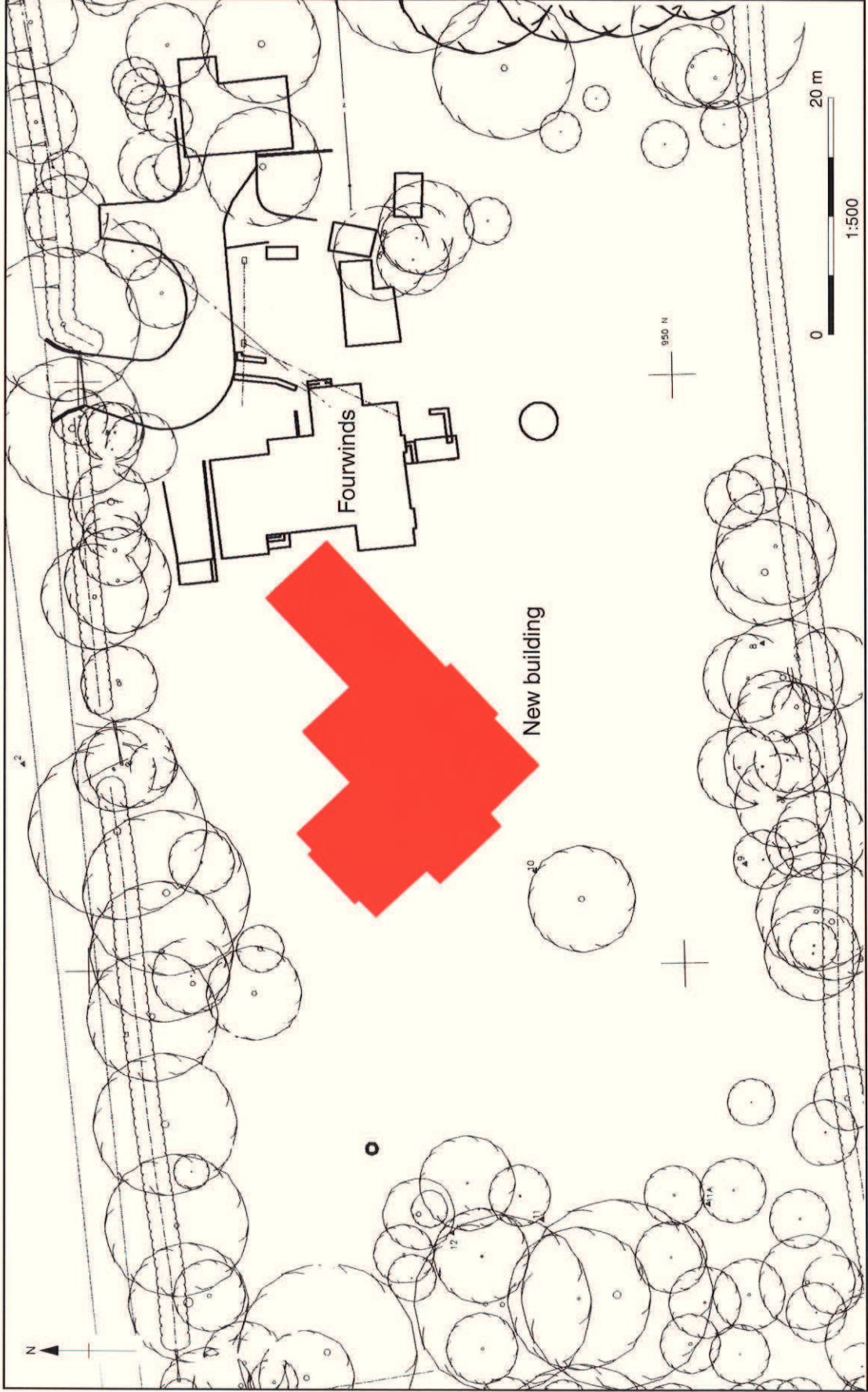

Figure 2: Site plan of area of watching brief

Registered Office:
Oxford Archaeological Unit
Janus House, Osney Mead, Oxford OX2 0ES

Oxford Archaeological Unit is a
Private Limited Company, No: 1618597
and a Registered Charity, No: 285627



Director: David Jennings, BA MFA FSA

t: (0044) 01524 848666
f: (0044) 01524 848606
e: lanclinfo@oxfordarch.co.uk
w: www.oxfordarch.co.uk

Storey Institute
Meeting House Lane
Lancaster LA1 1TF

Oxford Archaeology North



t: (0044) 01865 263800
f: (0044) 01865 793496
e: info@oxfordarch.co.uk
w: www.oxfordarch.co.uk

Janus House
Osney Mead
Oxford OX2 0ES

Oxford Archaeology

