

Site/Project Name: **Reading Ledger stone Minster St Mary Virgin**

Site Code: REMSM 06

Site/Project Type: Watching Brief

Year(s): 2006

Accession Number: REDMG:2006.924

Record Group	Contents	Comments	Box/File Number
	<b>INTRODUCTION</b> Method statement	2 double sided sheets	Box 1 file 1
A	<b>REPORT</b> Archaeological watching brief report OASIS report printout	1 bound copy 2 sheets	Box 1 file 2
B	<b>PRIMARY CONTEXT DATA</b> Context record sheet	1 sheet	Box 1 file 3
B	<b>PRIMARY DRAWINGS</b> Plan and section drawings	1 A4 sheet	Box 1 file 4
D	<b>CATALOGUE OF PHOTOGRAPHS</b> Black and white photographic record sheet Colour slides record sheet	1 sheet 1 sheet	Box 1 file 5

**SCAN PDF**

**FILMING INSTRUCTIONS**

Submitter OASouth

No. of CD copies: 2

**Headings**

**Site information**

Line 1: [OASouth] County:[Berkshire] Parish:[Reading] Site:[Ledger Stone, Minster St Mary the Virgin]

Site code[REMSM06]

Line 2: Excavators name[J. Hiller]

Line 3:

Classification of material

Tick if  
present

Index to archive	<input checked="" type="checkbox"/>
Introduction	<input type="checkbox"/>
A:Final Report	<input type="checkbox"/>
A:Publication Report	<input type="checkbox"/>
B:Site Data – Text: Diary/Daybook/Fieldnotes	<input type="checkbox"/>
B: Site Data – Text: General Summaries	<input type="checkbox"/>
B: Site Data – Text: Primary Context Records	<input type="checkbox"/>
B: Site Data – Text: Synthesised Context Records	<input type="checkbox"/>
B: Site Data – Text: Survey Reports	<input type="checkbox"/>
B: Site Data – Text: Catalogue of Drawings	<input type="checkbox"/>
B: Site Data – Text: Primary Drawings	<input type="checkbox"/>
B: Site Data – Text: Synthesised Drawings	<input type="checkbox"/>
C: Finds Data – Text: Primary Finds Data	<input type="checkbox"/>
C: Finds Data – Text: Synthesised Finds Data	<input type="checkbox"/>
C: Finds Data – Text: Specialist Reports	<input type="checkbox"/>
C: Finds Data – Text: Box/Bag List	<input type="checkbox"/>
D: Catalogue of Photos/Slides/Videos/X--rays	<input type="checkbox"/>
E: Environmental/Ecofact Data: Primary Records	<input type="checkbox"/>
E: Environmental/Ecofact Data: Synthesised Records	<input type="checkbox"/>
E: Environmental/Ecofact Data: Specialist Reports	<input type="checkbox"/>
F: Documentary	<input type="checkbox"/>
F: Press and Publicity	<input type="checkbox"/>
G: Correspondence	<input type="checkbox"/>
H: Miscellaneous	<input type="checkbox"/>

READING LEDGER STONE MINSTER  
ST. MARY VIRGIN  
REMSM06

Box 1 FILE 1

INTRODUCTION

--	--	--	--	--	--

No.978033 Buff



**SCAN PDF**

**FILMING INSTRUCTIONS**

Submitter OASouth

No. of CD copies: 2

Headings

Site information

Line 1: [OASouth] County:[Berkshire] Parish:[Reading] Site:[Ledger Stone, Minster St Mary the Virgin]

Site code[REMSM06]

Line 2: Excavators name[J. Hiller]

Line 3:

Classification of material

Tick if  
present

Index to archive	
Introduction	<input checked="" type="checkbox"/>
A:Final Report	
A:Publication Report	
B:Site Data – Text: Diary/Daybook/Fieldnotes	
B: Site Data – Text: General Summaries	
B: Site Data – Text: Primary Context Records	
B: Site Data – Text: Synthesised Context Records	
B: Site Data – Text: Survey Reports	
B: Site Data – Text: Catalogue of Drawings	
B: Site Data – Text: Primary Drawings	
B: Site Data – Text: Synthesised Drawings	
C: Finds Data – Text: Primary Finds Data	
C: Finds Data – Text: Synthesised Finds Data	
C: Finds Data – Text: Specialist Reports	
C: Finds Data – Text: Box/Bag List	
D: Catalogue of Photos/Slides/Videos/X--rays	
E: Environmental/Ecofact Data: Primary Records	
E: Environmental/Ecofact Data: Synthesised Records	
E: Environmental/Ecofact Data: Specialist Reports	
F: Documentary	
F: Press and Publicity	
G: Correspondence	
H: Miscellaneous	

## **METHOD STATEMENT**

Paye Stonework & Restoration Ltd.  
Stationmasters House  
Mottingham Station Approach  
LONDON SE9 4EL.  
Tel: 020 8857 9111 Fax: 020 8857 9222

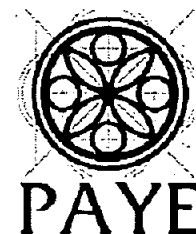

**CONTRACT TITLE** : St Mary the Virgin  
**CLIENT** : Broadway Maylan  
**PAYE CONTRACT No.** : 25186  
**METHOD STATEMENT** : Inspection Works to Ledger Stone

ms file

---

### **1.0 GENERAL**

Inspect substrate to internal ledger stone to assess reason for cracking and movement. R. Nugent to advise of remedial action following these works.

### **2.0. METHODOLOGY**

- 2.1. Ensure that access to the ledger stone is closed at all times during the works.
- 2.2. Remove 2 Nr pews to the West of the ledger stone, and store within the West entrance behind the Jacobean screen. The seats currently sit on pegs fixed to the ground, and require only lifting for their removal. Care must be taken to not damage the pews.
- 2.3. Carefully remove timber floor boards from around the ledger stone using a crowbar to remove any nails. Where it is not possible to remove the entire board, cut back to nearest joist. Set aside for reinstatement at a later time.
- 2.4. Carefully remove Victorian tiles using hand tools only. Set aside for reinstatement at a later time.
- 2.5. Erect small tent around area of works to contain dust/dirt. Task lighting will be required to assist the works.
- 2.6. Carefully remove brickwork from underneath the wooden floor joist across the entire length of the ledger stone using hand tools only. Set aside for reinstatement at a later time. No further works can be carried out until the archaeologist is on site to inspect the works.
- 2.7. Carefully remove substrate beneath ledger stone to a depth defined as per the Archaeologists instructions. Erect timber batons where possible

to prevent the stone from moving/collapsing. Hand tools only to be used, and waste is to be bagged up ready for disposal at regular intervals.

- 2.9 Once enough of the substrate has been removed, await inspection and instruction from R Nugent to remediate the cracking in the ledger stone.

### 3.0 **RESOURCES**

- 3.1. **Personnel** - 1 Nr Stone Mason
- 3.2. **Supervision** - 1 Nr. Visiting Contracts Manager  
1 Nr. Archaeologist
- 3.3. **Plant / Equipment** - Hand tools  
Crowbar
- 3.4 **Materials** N/A

### 4.0 **RISK ASSESSMENTS**

See attached specific risk assessments for this work..

### 5.0. **ADDITIONAL CONTROL MEASURES**

- 5.1. **Permits** None Required
- 5.2. **Security** Ensure barriers around area to prevent access
- 5.3. **Special Training** All operatives are to be trained and experienced in this type of work.

### 6.0 **PERSONAL PROTECTION EQUIPMENT**

- 6.1. All operatives are to wear as a minimum.
- Safety Helmets
  - Safety Footwear
  - High Visibility Vests
  - Gloves

### 7.0. **EMERGENCY ARRANGEMENTS**

- 7.1. As H & S Plan
- 7.2. **Rescue** See above

### **7.3.     Special First Aid Requirements**

- None envisaged.

### **8.0.     TEMPORARY AMENDED SYSTEMS**

- None envisaged

**9.0**     This Method Statement will be given to all of the operatives involved in the operation by way of a site briefing by the Supervisor or Project Manager. Operatives will sign to acknowledge receipt of this briefing. Once the operation has commenced the Method Statement will be reviewed and amended as necessary. If there are any changes in specification the Method Statement will be amended to reflect the changes.

### **10.0    ISSUED TO:**

- Client x 2
- Site Operatives
- PAYE Stonework & Restoration Ltd. (Job File)

# RISK ASSESSMENT

HAZARD IDENTIFICATION					
	YES	NO		YES	NO
Slips & Trips	✓		Electrical		✓
Manual handling		✓	COSHH		✓
Hand tools	✓		Noise		✓
Excavations		✓	Work at Height		✓
Machinery/Lifting equipment		✓	Dust/Fumes	✓	
Fire		✓	Lighting	✓	
Fall of material		✓	3rd party (Contractor)		✓

Who might be harmed?					
	YES	NO		YES	NO
Own Personnel	✓		Office Staff or Visitors		✓
Other Contractors		✓	Members of the Public	✓	

OVERALL ASSESSMENT OF RISK PRIOR TO THE IMPLEMENTATION OF CONTROL MEASURES (Tick one)			
LOW	MODERATE	SUBSTANTIAL	HIGH
✓			

**PROPOSED CONTROL MEASURES TO REDUCE THE RISKS** (Use additional sheet if necessary)

Tent to prevent damage from dust to church interior.  
 Halogen lighting to be provided to increase visibility within the tented area.  
 Barriers erected to prevent access by unauthorised personnel.  
 Should there be movement of the stone seek further advice

Equipment To Be Used					
	YES	NO		YES	NO
Lifting		✓	Cradle		✓
Mechanical hoist		✓	Excavation shoring		✓
Mobile elevating working platform		✓	Mechanical tools		✓
Ladder		✓	Compressor		✓
Hoist		✓	CAT		✓
Test Equipment		✓	Ventilation/Extraction Equipment		✓
Task Lighting	✓		Excavation shoring		✓
Scaffolding		✓	Lifting slings/chains		✓
Mobile scaffolds		✓	Mechanical plant (State)		✓

Personal Protective Equipment Needed					
	YES	NO		YES	NO
Safety Helmet	✓		Gloves	✓	
Protective Footwear	✓		Hearing Protection		✓
High Visibility Clothing	✓		Overalls	✓	
Eye protection		✓	Body Harness		✓
Face Respirator		✓	Other?		✓

OVERALL ASSESSMENT OF RISK (Circle one)				
<u>LOW</u> ✓	<u>MODERATE</u>	<u>SUBSTANTIAL</u>	<u>HIGH</u>	ESP (Extra Special Precautions)
SIGNATURE OF CONTRACTOR:		PRINT: DOMINIC PEACHEY		DATE: 26/07/2006



READING LEDGER STONE MINSTER  
ST. MARY VIRGIN  
REMSM06

Box 1 FILE 2

A0REPORT

--	--	--	--	--

No.978033 Buff



**SCAN PDF**

**FILMING INSTRUCTIONS**

Submitter OASouth

No. of CD copies: 2

Headings

Site information

Line 1: [OASouth] County:[Berkshire] Parish:[Reading] Site:[Ledger Stone, Minster St Mary the Virgin]

Site code[REMSM06]

Line 2: Excavators name[J. Hiller]

Line 3:

Classification of material

Tick if  
present

Index to archive	
Introduction	
A:Final Report	<input checked="" type="checkbox"/>
A:Publication Report	
B:Site Data – Text: Diary/Daybook/Fieldnotes	
B: Site Data – Text: General Summaries	
B: Site Data – Text: Primary Context Records	
B: Site Data – Text: Synthesised Context Records	
B: Site Data – Text: Survey Reports	
B: Site Data – Text: Catalogue of Drawings	
B: Site Data – Text: Primary Drawings	
B: Site Data – Text: Synthesised Drawings	
C: Finds Data – Text: Primary Finds Data	
C: Finds Data – Text: Synthesised Finds Data	
C: Finds Data – Text: Specialist Reports	
C: Finds Data – Text: Box/Bag List	
D: Catalogue of Photos/Slides/Videos/X--rays	
E: Environmental/Ecofact Data: Primary Records	
E: Environmental/Ecofact Data: Synthesised Records	
E: Environmental/Ecofact Data: Specialist Reports	
F: Documentary	
F: Press and Publicity	
G: Correspondence	
H: Miscellaneous	

# Minster of St Mary-the-Virgin Reading Berkshire



## Archaeological Watching Brief Report



December 2006

**Client: Minster of  
St Mary the Virgin**

Issue N<sup>o</sup>: 1  
OA Job N<sup>o</sup>: 7264  
NGR: SU 714 733

**Client Name:** Minster of St Mary the Virgin  
**Client Ref No:** 25186  
**Document Title:** Minster of St Mary-the-Virgin, Reading, Berkshire

**Document Type:** Watching Brief

**Issue Number:** 1

National Grid Reference: SU 714 733  
Planning Reference:

OA Job Number: 7264  
Site Code: REMSM06  
Invoice Code: REMSMWB  
Receiving Museum: tba  
Museum Accession No: REDMG:2006.924

Prepared by: Robin Bashford  
Position: Site Supervisor  
Date: 5th December 2006

Checked by: Dan Dodds  
Position: Senior Project Manager  
Date: 5th December 2006

Approved by: Jon Hiller  
Position: Senior Project Manager  
Date: 22nd November 2006

Signed.....

Document File Location X:\Oxford, Magdalen college school\Report\REPORT  
I.doc

Graphics File Location Servergo:\invoice codes IthruQ\*O  
codes\*OXMCSEV\*Magdalen college  
School\*HRB\*3.11.06

Illustrated by Georgina Slater

**Disclaimer:**

*This document has been prepared for the titled project or named part thereof and should not be relied upon or used for any other project without an independent check being carried out as to its suitability and prior written authority of Oxford Archaeology being obtained. Oxford Archaeology accepts no responsibility or liability for the consequences of this document being used for a purpose other than the purposes for which it was commissioned. Any person/party using or relying on the document for such other purposes agrees, and will by such use or reliance be taken to confirm their agreement to indemnify Oxford Archaeology for all loss or damage resulting therefrom. Oxford Archaeology accepts no responsibility or liability for this document to any party other than the person/party by whom it was commissioned.*

**Oxford Archaeology**

© Oxford Archaeological Unit Ltd 2006

Janus House  
Osney Mead  
Oxford OX2 0ES  
t: (0044) 01865 263800  
f: (0044) 01865 793496

e: info@oxfordarch.co.uk  
w: www.oxfordarch.co.uk

Oxford Archaeological Unit Limited is a Registered Charity No: 285627

# Minster of St Mary-the-Virgin, Reading, Berkshire

## ARCHAEOLOGICAL WATCHING BRIEF REPORT

### CONTENTS

Summary.....	1
1 Introduction .....	1
1.1 Scope of work.....	1
1.2 Location, geology and topography .....	1
1.3 Archaeological and historical background.....	1
2 Project Aims and Methodology.....	3
2.1 Aims .....	3
2.2 Methodology .....	3
3 Results .....	4
3.1 Description of deposits.....	4
3.2 Finds .....	4
3.3 Palaeo-environmental remains .....	4
4 Discussion and Conclusions.....	5
Appendix 1 Archaeological Context Inventory .....	7
Appendix 2 Bibliography and References .....	8
Appendix 3 Summary of Site Details.....	8

### LIST OF FIGURES

- Fig. 1 Site location  
Fig. 2 Location of ledger stone  
Fig. 3 Plan of area monitored and section

## SUMMARY

*On 2nd October 2006 Oxford Archaeology (OA) carried out an archaeological watching brief at the Minster of St Mary-the-Virgin, Reading, Berkshire (NGR: SU 714 733). The work was commissioned as part of the consulting process prior to the consolidation of a cracked ledger stone in the vicinity of the south porch. The watching brief revealed evidence of 19th century made ground which contained charnel, presumably originating from burials disturbed during restoration work.*

### 1 INTRODUCTION

#### 1.1 Scope of work

- 1.1.1 On 2nd October 2006 Oxford Archaeology (OA) carried out an archaeological watching brief at the Minster of St Mary-the-Virgin, Reading, Berkshire (NGR: SU 714 733). The work was commissioned as part of the ongoing site investigations during renovation work.
- 1.1.2 OA agreed a specification for the watching brief with the architects, engineers and the Church Commissioners following consultation with the Diocesan Archaeological Advisor, Julian Mumby.

#### 1.2 Location, geology and topography

- 1.2.1 The site lies within the central area of Reading, south of the River Thames and the railway station (Fig. 1). The site itself is on a very gentle south facing slope running down towards Holy Brook and is located at approximately 44 m above OD. The underlying geology is valley gravels over alluvium (Geological Survey of Great Britain sheet no. 268).

#### 1.3 Archaeological and historical background

- 1.3.1 Historic Reading straddles the gap in a gravel ridge through which the River Kennet flows. With the supplanting of the Roman road system based on Silchester, Reading became an important communications centre during the medieval period. The roads from Oxford to Southampton and from London to Bristol passed through or close to the town and, although the town does not lie on the banks of the River Thames, it was sufficiently near to the river to provide easy access to London, Wallingford and Oxford. The ease of access from the capital and the major provincial towns has ensured that Reading has retained an important place in the country's communications.
- 1.3.2 Reading is first documented by the Anglo-Saxon Chronicle in 870-1 AD when the Danes wintered there and repulsed the attacks of King Ethelred and his brother Alfred. Although the Danes wintered again in 1006, no further mention is made of the settlement here until the later 11<sup>th</sup> century. A reference to Reading in Domesday

indicates that it had become a town by 1066. A royal borough, separately mentioned, which included 29 *hagae*, a pasture called “portmansbrook” and land held for official guests, points to an urban community.

- 1.3.3 The post-Conquest history of Reading is dominated by the presence of the abbey and its effect on the town. Henry 1's foundation of the abbey in 1121 AD gave the town an increased impetus to urban development. Construction of a new bridge over the Kennet by 1186 and the creation of another wide street, London Street, with burgage plots either side were part of this phase of urban expansion. London Street runs to the south-east of St Mary's.
- 1.3.4 The major industry for this period came to be cloth working, with its attendant trades, weaving and fulling. By the mid 13th century fulling mills along the Kennet are documented as well as the town wharf with its wool beam. By the 14th century Reading had become established as the major town in Berkshire, having long outstripped Wallingford. In the 15th and 16th centuries the population had probably tripled, and there was a corresponding increase in manufactories and commerce.
- 1.3.5 The town's prosperity was, however, severely dislocated during the Civil War, with the alternate occupations by the Parliamentary and Royalist forces between October 1642 and July 1644. These occupations hastened the decline in the old industries of cloth and leather working, and contributed to a reorientation of the town's economy. This reorientation was finally achieved with the completion of the Kennet and Avon canal, linking Reading with Bristol in 1810. The decline in the clothing industry was offset by the manufacture of gauze, silk and sailcloth, whilst the brick and tile making and tanning had expanded considerably. The success of the town's economy is reflected in the virtual rebuilding of the town centre in the late 18th and early 19th centuries.
- 1.3.6 The site itself is situated on the south-eastern extent of the medieval town of Reading. To the south-east of the site is the 12<sup>th</sup> century church of Saint Giles, whilst to the south west are the preserved remains of a medieval tile kiln.
- 1.3.7 Pevsner describes the building as having a Norman doorway, possibly reset, within the north wall and a southern arcade c 1200. At the east end of the north aisle an arch c 1300 must once have connected to a north transept with an eastern chapel. The west tower, built of chequer flint and stone with polygonal buttresses dates between 1550-3. The chancel dates to 1864 and the north aisle to 1872.
- 1.3.8 The ledger stone is located in the aisle leading from the south porch to the nave. The inscription reads as follows (north is at the top):

Here lyeth the Body  
of W<sup>m</sup> ARMSTRONG Gent  
who departed this Life  
July <sup>v</sup>c 19<sup>th</sup> 1748  
Aged 67 Years

Also lyeth the Body of  
W<sup>m</sup> the son of the above  
WILLIAM ARMSTRONG  
who departed this Life  
Jan \ 19<sup>th</sup> 17(?)56  
Aged 29 Years

Also lyeth the Body of  
Sarah the wife of the above  
William Armstrong Gent.  
who departed this Life  
March \ ?1<sup>th</sup> 1769  
Aged 71 Years

- 1.3.9 It seems unlikely that the stone is in-situ as the floor was almost certainly laid in the 19th century. The fact that the stone is aligned north-south may also suggest that it does not lie directly over the grave.

## 2 PROJECT AIMS AND METHODOLOGY

### 2.1 Aims

- 2.1.1 To advise on the archaeological implications of the proposed method of consolidation of the cracked ledger stone.
- 2.1.2 To identify and record the presence or absence, extent, condition, quality and date of archaeological remains in the areas affected by the development.
- 2.1.3 To provide information in order to develop a mitigation strategy for future work in the area.
- 2.1.4 To make available the results of the archaeological investigation.

### 2.2 Methodology

- 2.2.1 The watching brief was undertaken to assess the potential for the disturbance of archaeological deposits during the consolidation of the cracked ledger stone. The initial visit monitored the removal of wooden floor boards and a small area of tiled



floor to the west of the ledger stone, and the subsequent excavation of a sondage underneath the stone. A second sondage was excavated beneath the timber floor to establish the nature of the ground over which it lay.

- 2.2.2 A plan showing the location of the excavated area in relation to the ledger stone was drawn at a scale of 1:20. All excavations were photographed using colour slide and black and white print film. A general photographic record of the work was also made. Recording followed procedures detailed in the *OA Field Manual* (ed. D Wilkinson, 1992).

### 3 RESULTS

#### 3.1 Description of deposits

- 3.1.1 The floor timbers to the west of the ledger stone were supported on wooden beams, some of which were supported on stepped brick footings (see Fig. 3). This created a c 0.3 m deep void beneath the timber floor. A 0.32 m x 0.52 m sondage was excavated through the deposits exposed beneath the timber floor, which appeared to comprise a mixed, very loose sandy silt deposit with chalk, flint, charnal, ceramic building material and coffin furniture throughout (100). This was interpreted as made ground, possibly associated with the 1872 phase of renovation. A north-south aligned ceramic pipe, approximately 0.2 m in diameter, was encountered within the sondage, although no obvious trench was observed within deposit 100, and it is likely that this was installed prior to the deposition of the made ground and is therefore contemporary with the same phase of renovation. The brick supports for the timber beams also appeared to pre-date the deposition of the made ground as no construction cuts were observed and the deposit appeared to overlie the lower stepped courses of the brick footings.
- 3.1.2 To the east of the timber floor, the made ground was overlain by a bedding deposit for the tiled floor which comprised compacted chalk and flint (101) and was approximately 0.16 m thick. The ledger stone appeared to truncate this deposit and was laid directly over the made ground. A 0.30 m x 0.65 m sondage was excavated underneath the stone to a maximum of 0.43 m below ground level, and the base of the made ground deposit was not encountered.

#### 3.2 Finds

- 3.2.1 Fragments of brick, tile, clay pipe and charnal were observed within deposit 100. These appeared to be of 19th century origin and were noted, but not retained.

#### 3.3 Palaeo-environmental remains

- 3.3.1 No deposits suitable for palaeo-environmental sampling were encountered during the course of the watching brief.

#### 4 DISCUSSION AND CONCLUSIONS

- 4.1.1 It seems likely that the ceramic pipe and the brick footings for the timber beams had been laid prior to the deposition of the made ground. The bedding deposit for the tiled floor had then been laid over the made ground to the east of the timber floor. The relationship between the ledger stone and the bedding deposit was unclear, although it seems likely that the laying of the stone had truncated the bedding deposit, almost certainly as it is considerably thicker than the tiles to the east and west of it.
- 4.1.2 The initial monitoring visit established that it was highly unlikely that significant archaeological deposits would be compromised during consolidation of the cracked ledger stone. It seems likely that the reason the stone had cracked was that it had been placed directly over the rubble rich made ground deposit (100), as opposed to the tiled floor which was laid over the compacted chalk (101), or the timber floor which was supported on the wooden beams.
- 4.1.3 As the lifting and repair of the stone was impractical given the fragmentary nature of the cracking, it was decided to excavate further sondages under the stone and fill the resulting voids with sandbags to provide a stable base. As this would not impact below the projected extent of the made ground deposit, no further archaeological monitoring visits were considered necessary.

## APPENDICES

## APPENDIX 1 ARCHAEOLOGICAL CONTEXT INVENTORY

Ctxt No	Type	Length (m)	Thick. Depth (m)	Colour	Composition	Inclusions	Comment	Finds	Date
100	deposit		0.28 +	mixed	sandy silt	mortar, chalk, flint, charnal, cbm, coffin furniture	?19thC made ground		
101	deposit		0.16	white	chalk and flint		bedding deposit for tiled floor		

**APPENDIX 2 BIBLIOGRAPHY AND REFERENCES**

IFA 2001 *Standards and Guidelines for Archaeological Watching Briefs*

OA 1992 *Field Manual* (1st edition, ed. D Wilkinson)

Pevsner, N. 1966 *The Buildings of England, Berkshire*. Penguin.

Astill, G. 1978 *Historic towns in Berkshire; An archaeological appraisal*

**APPENDIX 3 SUMMARY OF SITE DETAILS**

**Site name:** Minster of St Mary-the-Virgin, Reading, Berkshire

**Site code:** REMSM 06

**Grid reference:** SU 714 733

**Type of watching brief:** consolidation of cracked ledger stone

**Date and duration of project:** 3 hours

**Area of site:**

**Summary of results:** The watching brief exposed evidence of 19th century made ground probably associated with the 1872 renovation.

**Location of archive:** The archive is currently held at OA, Janus House, Osney Mead, Oxford, OX2 0ES, and will be deposited with Reading Museum Service in due course.







Figure 1: Site location



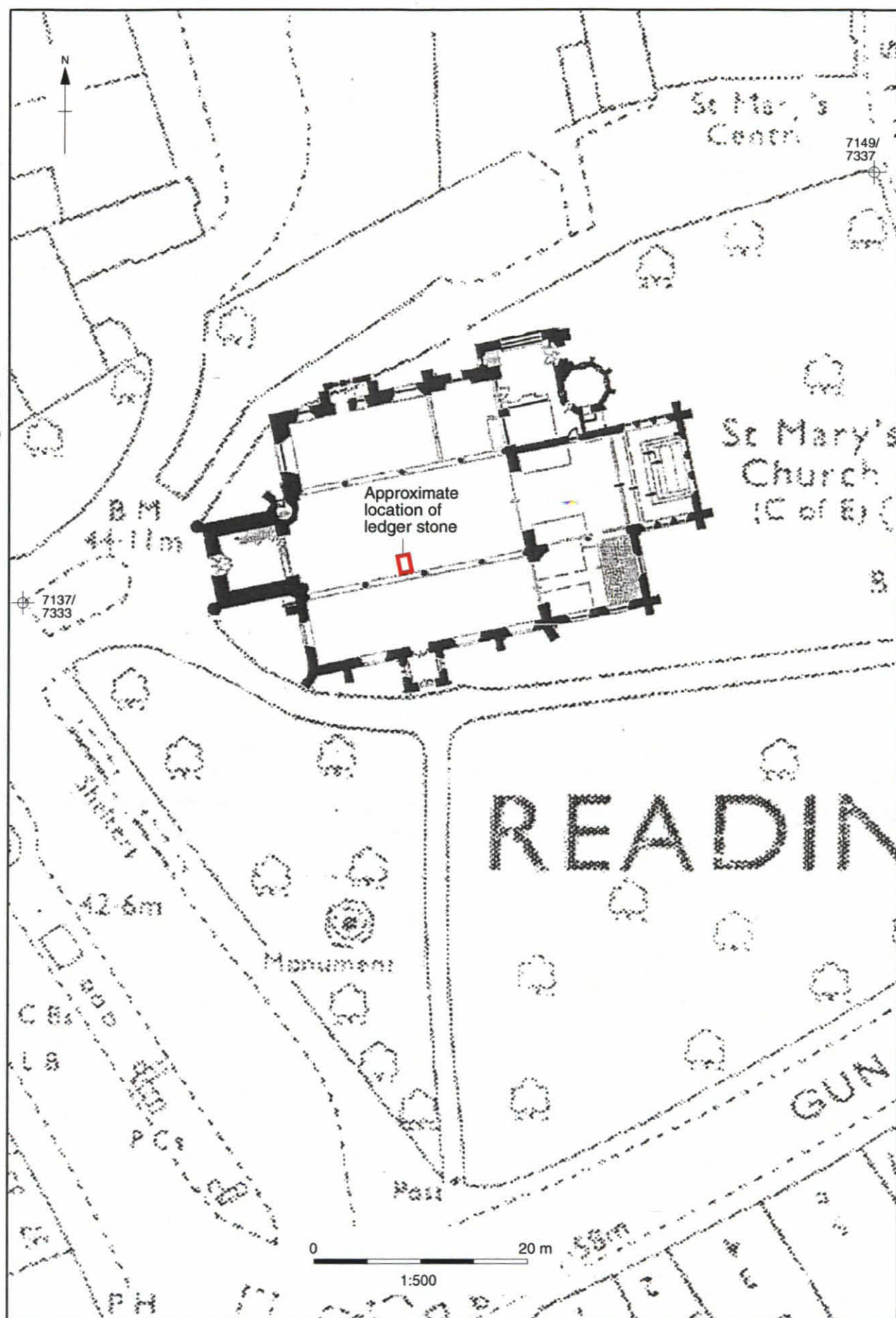

Figure 2: Approximate location of ledger stone

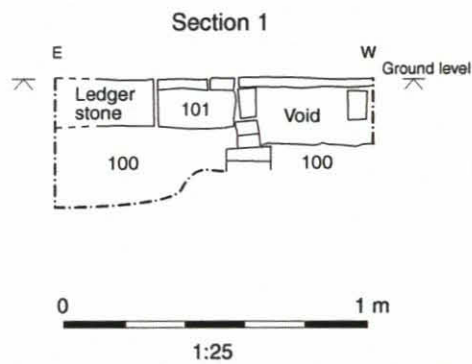
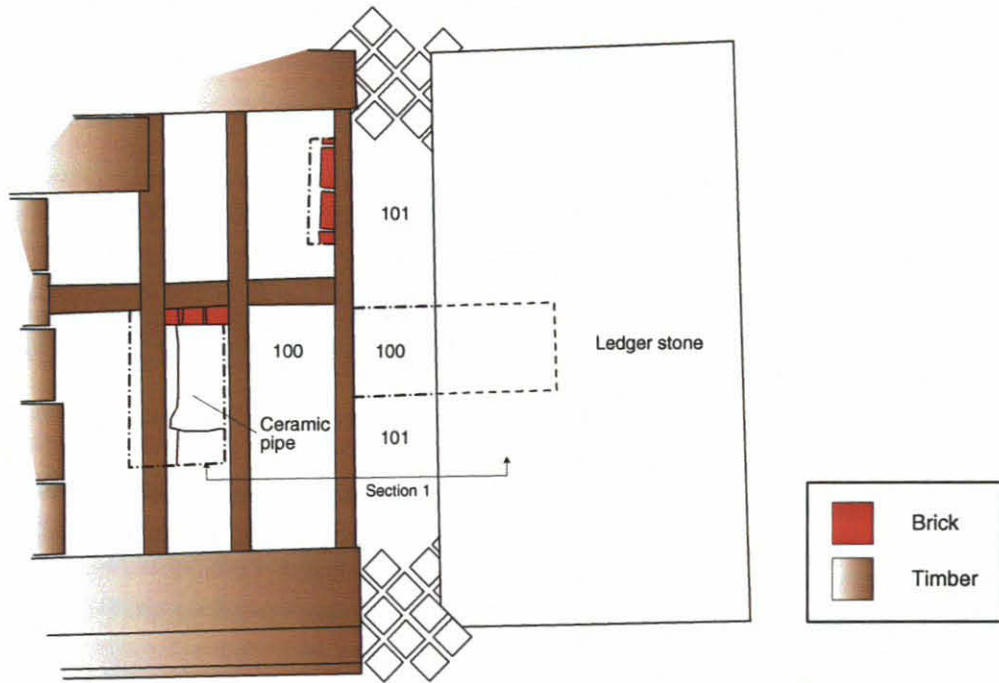

Figure 3: Plan of area monitored and sample section





#### **OA South**

Janus House  
Osney Mead  
Oxford OX2 0ES

t: +44 (0) 1865 263 800  
f: +44 (0) 1865 793 496  
e: [info@oxfordarch.co.uk](mailto:info@oxfordarch.co.uk)  
w: <http://thehumanjourney.net>

#### **OA North**

Mill 3  
Moor Lane Mills  
Moor Lane  
Lancaster LA1 1GF

t: +44 (0) 1524 541 000  
f: +44 (0) 1524 848 606  
e: [oanorth@thehumanjourney.net](mailto: oanorth@thehumanjourney.net)  
w: <http://thehumanjourney.net>

#### **OA East**

15 Trafalgar Way  
Bar Hill  
Cambridgeshire  
CB23 8SQ

t: +44 (0) 1223 850 500  
f: +44 (0) 1223 850 599  
e: [oaeast@thehumanjourney.net](mailto: oaeast@thehumanjourney.net)  
w: <http://thehumanjourney.net>

#### **OA Méditerranée**

115 Rue Merlot  
ZAC La Louvade  
34 130 Mauguio  
France

t: +33 (0) 4.67.57.86.92  
f: +33 (0) 4.67.42.65.93  
e: [oamed@thehumanjourney.net](mailto: oamed@thehumanjourney.net)  
w: <http://oamed.fr/>

**Director:** David Jennings, BA MIFA FSA



*The Oxford Archaeological Unit Ltd is a  
Private Limited Company, N°: 1618597  
and a Registered Charity, No: 285627  
Registered Office: Janus House,  
Osney Mead, Oxford, OX2 0ES*

# OASIS DATA COLLECTION FORM:

## England

[List of Projects](#) | [Search Projects](#) | [New project](#) | [Change your details](#) | [HER coverage](#) | [Change country](#) | [Log out](#)

**Printable version**

**OASIS ID: oxfordar1-73806**

### Project details

Project name	Reading Ledger stone Minster St Mary Virgin
Short description of the project	On 2nd October 2006 Oxford Archaeology (OA) carried out an archaeological watching brief at the Minster of St Mary-the-Virgin, Reading, Berkshire (NGR: SU 714 733). The work was commissioned as part of the consulting process prior to the consolidation of a cracked ledger stone in the vicinity of the south porch. The watching brief revealed evidence of 19th century made ground which contained charnel, presumably originating from burials disturbed during restoration work.
Project dates	Start: 02-10-2006 End: 02-10-2006
Previous/future work	Yes / Not known
Any associated project reference codes	REMSM06 - Sitecode
Any associated project reference codes	REDMG:2006.924 - Museum accession ID
Type of project	Recording project
Site status	None
Current Land use	Other 2 - In use as a building
Monument type	NONE None
Significant Finds	NONE None
Investigation type	'Watching Brief'
Prompt	Planning condition

### Project location

Country	England
Site location	BERKSHIRE READING READING Reading Ledger stone Minster St Mary Virgin
Study area	4.00 Square metres
Site coordinates	SU 714 733 51.4536839231 -0.972300614664 51 27 13 N 000 58 20 W Point

**Project creators**

Name of Organisation	Oxford Archaeology
Project brief originator	verbal brief
Project design originator	Oxford Archaeology
Project director/manager	J. Hiller
Project supervisor	R Bashford

**Project archives**

Physical Archive Exists?	No
Digital Archive recipient	Oxford Archaeology
Digital Archive ID	REMSM06/REMSMWB
Digital Contents	'Stratigraphic'
Digital Media available	'Text'
Paper Archive recipient	Reading Museum
Paper Archive ID	REDMG:2006.924
Paper Contents	'Stratigraphic'
Paper Media available	'Microfilm','Photograph','Plan','Report','Section','Unpublished Text'

**Project bibliography 1**

Publication type	Grey literature (unpublished document/manuscript)
Title	Minster of St Mary-the-Virgin Reading Berkshire
Author(s)/Editor(s)	R. Bashford
Date	2006
Issuer or publisher	OXFORD ARCHAEOLOGY
Place of issue or publication	OXFORD
Description	A4 plastic bound client report
Entered by	wajdan.majeed (wajdan.majeed@oxfordarch.co.uk)
Entered on	11 March 2010

READING LEDGER STONE MINSTER  
ST. MARY VIRGIN  
REMSM06  
Box 1 FILE 3  
B. PRIMARY CONTEXT RECORDS

--	--	--	--	--	--

No.978033 Buff



**SCAN PDF**

**FILMING INSTRUCTIONS**

Submitter OASouth

No. of CD copies: 2

**Headings**

**Site information**

Line 1: [OASouth] County:[Berkshire] Parish:[Reading] Site:[Ledger Stone, Minster St Mary the Virgin]

Site code[REMSM06]

Line 2: Excavators name[J. Hiller]

Line 3:

**Classification of material**

Tick if  
present

Index to archive	
Introduction	
A:Final Report	
A:Publication Report	
B:Site Data – Text: Diary/Daybook/Fieldnotes	
B: Site Data – Text: General Summaries	
B: Site Data – Text: Primary Context Records	<input checked="" type="checkbox"/>
B: Site Data – Text: Synthesised Context Records	
B: Site Data – Text: Survey Reports	
B: Site Data – Text: Catalogue of Drawings	
B: Site Data – Text: Primary Drawings	
B: Site Data – Text: Synthesised Drawings	
C: Finds Data – Text: Primary Finds Data	
C: Finds Data – Text: Synthesised Finds Data	
C: Finds Data – Text: Specialist Reports	
C: Finds Data – Text: Box/Bag List	
D: Catalogue of Photos/Slides/Videos/X--rays	
E: Environmental/Ecofact Data: Primary Records	
E: Environmental/Ecofact Data: Synthesised Records	
E: Environmental/Ecofact Data: Specialist Reports	
F: Documentary	
F: Press and Publicity	
G: Correspondence	
H: Miscellaneous	

- 
- 100 - v. loose sandy silt with chalk, flint, clam, chert, coffin furniture (studs) -  
MADE GROUND  
skull fragment at base of sandage (X') probably chert
- (101) - compacted chalk + flint c. 0.16m thick - bedding for tiled floor

Here lieth the Body  
of W<sup>m</sup> ARMSTRONG Gent  
who departed this Life

July 8<sup>th</sup> 1748

Aged 67 Years

Also lieth the Body of  
W<sup>m</sup> the son of the above

WILLIAM ARMSTRONG  
who departed this Life

Jan 1<sup>st</sup> 1756

Also lieth the Body of  
Sarah the wife of the above  
William Armstrong Gent.  
who departed this Life  
March 1<sup>st</sup> 1769

Aged 71 years

READING LEDGER STONE MINSTER  
ST. MARY VIRGIN  
REMSM06

Box 1 FILE 4

B. PRIMARY DRAWINGS

--	--	--	--	--

No. 978033 Buff



SCAN PDF

FILMING INSTRUCTIONS

Submitter OASouth

No. of CD copies: 2

Headings

Site information

Line 1: [OASouth] County:[Berkshire] Parish:[Reading] Site:[Ledger Stone, Minster St Mary the Virgin]

Site code[REMSM06]

Line 2: Excavators name[J. Hiller]

Line 3:

Classification of material

Tick if  
present

Index to archive	
Introduction	
A:Final Report	
A:Publication Report	
B:Site Data – Text: Diary/Daybook/Fieldnotes	
B: Site Data – Text: General Summaries	
B: Site Data – Text: Primary Context Records	
B: Site Data – Text: Synthesised Context Records	
B: Site Data – Text: Survey Reports	
B: Site Data – Text: Catalogue of Drawings	
B: Site Data – Text: Primary Drawings	<input checked="" type="checkbox"/>
B: Site Data – Text: Synthesised Drawings	
C: Finds Data – Text: Primary Finds Data	
C: Finds Data – Text: Synthesised Finds Data	
C: Finds Data – Text: Specialist Reports	
C: Finds Data – Text: Box/Bag List	
D: Catalogue of Photos/Slides/Videos/X--rays	
E: Environmental/Ecofact Data: Primary Records	
E: Environmental/Ecofact Data: Synthesised Records	
E: Environmental/Ecofact Data: Specialist Reports	
F: Documentary	
F: Press and Publicity	
G: Correspondence	
H: Miscellaneous	



FIG. 2

TN 7264  
PLAN 1  
1:20 RB

h.h. - TIMBER

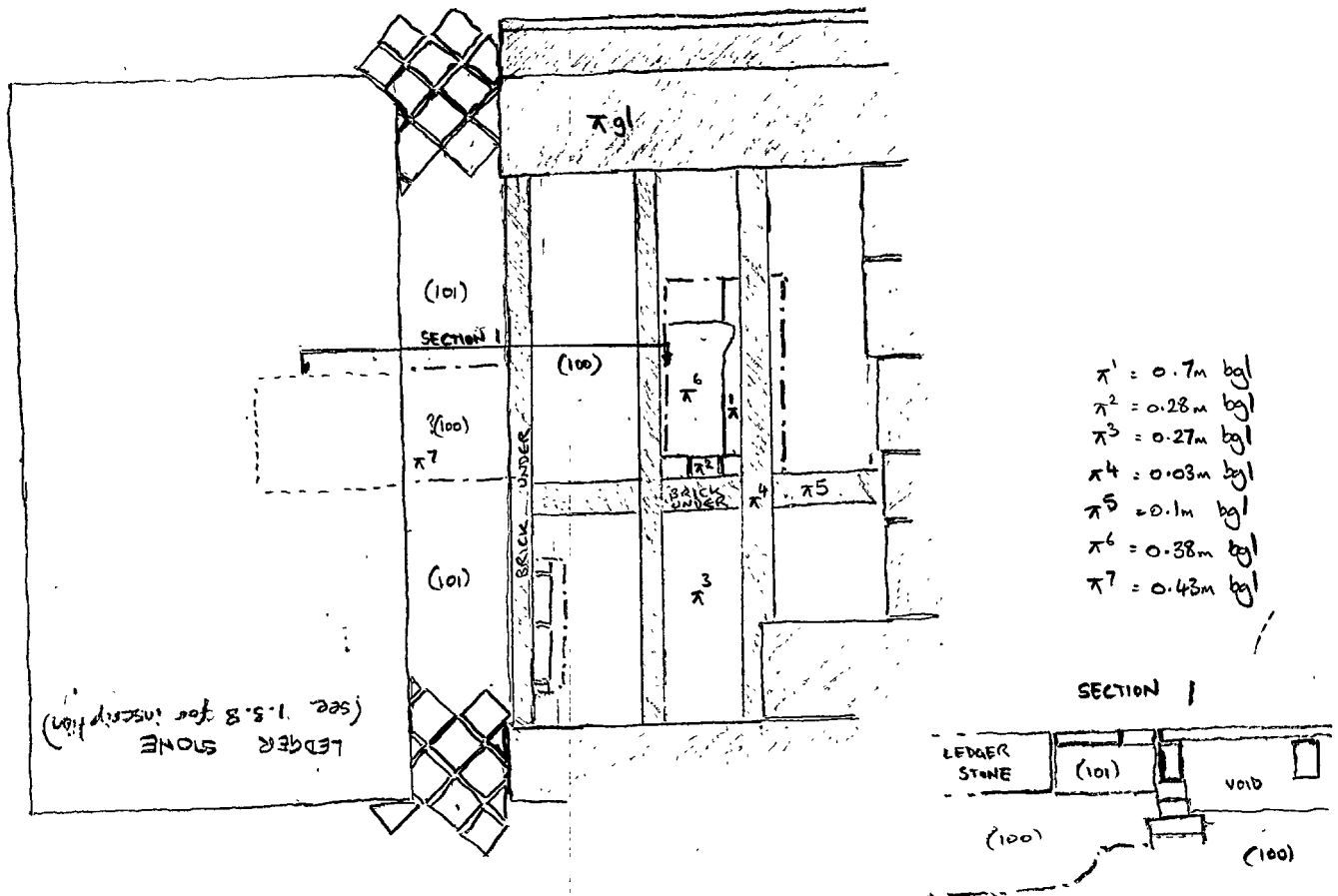

100 - v. loose sandy silt with chalk, flint, cbm, chornal, coffin furniture (studs)  
MADE GROUND  
skull fragment at base of sandlage (π 1) probably chornal

(101) - compacted chalk + flint c. 0.16m thick - bedding for tiled floor

Here lieth the Body  
of WM ARMSTRONG Gent  
who departed this Life  
July 9<sup>th</sup> 1748  
Aged 67 Years

Also lieth the Body of  
WM. the son of the above  
WILLIAM ARMSTRONG  
who departed this Life  
Jan 1<sup>st</sup> 1756  
Aged 29 Years

Also lieth the Body of  
Sarah the wife of the above  
William Armstrong Gent.  
who departed this Life  
March 1<sup>st</sup> 1769  
Aged 71 years



READING LEDGER STONE MINSTER

ST. MARY VIRGIN

REMSM06

Box 1 FILE 5

D. CATALOGUE of PHOTOGRAPHS

**SCAN PDF**

**FILMING INSTRUCTIONS**

Submitter OASouth

No. of CD copies: 2

Headings

Site information

Line 1: [OASouth] County:[Berkshire] Parish:[Reading] Site:[Ledger Stone, Minster St Mary the Virgin]

Site code[REMSM06]

Line 2: Excavators name[J. Hiller]

Line 3:

Classification of material

Tick if  
present

Index to archive	
Introduction	
A:Final Report	
A:Publication Report	
B:Site Data – Text: Diary/Daybook/Fieldnotes	
B: Site Data – Text: General Summaries	
B: Site Data – Text: Primary Context Records	
B: Site Data – Text: Synthesised Context Records	
B: Site Data – Text: Survey Reports	
B: Site Data – Text: Catalogue of Drawings	
B: Site Data – Text: Primary Drawings	
B: Site Data – Text: Synthesised Drawings	
C: Finds Data – Text: Primary Finds Data	
C: Finds Data – Text: Synthesised Finds Data	
C: Finds Data – Text: Specialist Reports	
C: Finds Data – Text: Box/Bag List	
D: Catalogue of Photos/Slides/Videos/X--rays	<input checked="" type="checkbox"/>
E: Environmental/Ecofact Data: Primary Records	
E: Environmental/Ecofact Data: Synthesised Records	
E: Environmental/Ecofact Data: Specialist Reports	
F: Documentary	
F: Press and Publicity	
G: Correspondence	
H: Miscellaneous	



# PHOTOGRAPHIC RECORD SHEET

SITE CODE **REMSM'06**

SITE NAME **ST MARY THE VIRGIN, READING**

FILM NO. **1**

Camera number

Lens number

~~Black & white~~ / colour

Date	Negative number	View	Context(s)	Initials
	<b>0</b>	<b>→SW</b>	<b>GENERAL SHOTS</b>	
	<b>1</b>	<b>"</b>	<b>— " —</b>	
	<b>2</b>	<b>→SW</b>	<b>— " —</b>	
	<b>3</b>	<b>"</b>	<b>— " —</b>	
	<b>4</b>	<b>"</b>	<b>— " —</b>	
	<b>5</b>	<b>"</b>	<b>— " —</b>	
	<b>6</b>	<b>"</b>	<b>— " —</b>	
	<b>7</b>	<b>"</b>	<b>— " —</b>	
	<b>8</b>	<b>"</b>	<b>— " —</b>	
	<b>9</b>	<b>"</b>	<b>— " —</b>	
	<b>10</b>	<b>"</b>	<b>— " —</b>	
	<b>11</b>	<b>→S</b>	<b>— " —</b>	
	<b>12</b>	<b>"</b>	<b>— " —</b>	
	<b>13</b>			
	<b>14</b>			
	<b>15</b>			
	<b>16</b>			
	<b>17</b>			
	<b>18</b>			
	<b>19</b>			
	<b>20</b>			
	<b>21</b>			
	<b>22</b>			
	<b>23</b>			
	<b>24</b>			
	<b>25</b>			
	<b>26</b>			
	<b>27</b>			
	<b>28</b>			
	<b>29</b>			
	<b>30</b>			
	<b>31</b>			
	<b>32</b>			
	<b>33</b>			
	<b>34</b>			
	<b>35</b>			
	<b>36</b>			
	<b>37</b>			



# PHOTOGRAPHIC RECORD SHEET

SITE CODE **REMSM'06**

SITE NAME **ST MARY THE VIRGIN, READING**

FILM NO. **1**

Camera number

Lens number

Black & white / colour

Date	Negative number	View	Context(s)	Initials
	<b>0</b>	<b>→ S</b>	<b>GENERAL SHOTS</b>	
	<b>1</b>	<b>"</b>	<b>— " —</b>	
	<b>2</b>	<b>"</b>	<b>— " —</b>	
	<b>3</b>	<b>"</b>	<b>— " —</b>	
	<b>4</b>	<b>→ W</b>	<b>— " —</b>	
	<b>5</b>	<b>"</b>	<b>— " —</b>	
	<b>6</b>	<b>"</b>	<b>— " —</b>	
	<b>7</b>	<b>→ S</b>	<b>— " —</b>	
	<b>8</b>			
	<b>9</b>			
	<b>10</b>			
	<b>11</b>			
	<b>12</b>			
	<b>13</b>			
	<b>14</b>			
	<b>15</b>			
	<b>16</b>			
	<b>17</b>			
	<b>18</b>			
	<b>19</b>			
	<b>20</b>			
	<b>21</b>			
	<b>22</b>			
	<b>23</b>			
	<b>24</b>			
	<b>25</b>			
	<b>26</b>			
	<b>27</b>			
	<b>28</b>			
	<b>29</b>			
	<b>30</b>			
	<b>31</b>			
	<b>32</b>			
	<b>33</b>			
	<b>34</b>			
	<b>35</b>			
	<b>36</b>			
	<b>37</b>			